

Yale SensCheck Door Sensor Manual

IA-301 and AC-DSM



The Yale SensCheck Door Sensor monitors your door lock status and the opening / closing of the door.

What's in the box

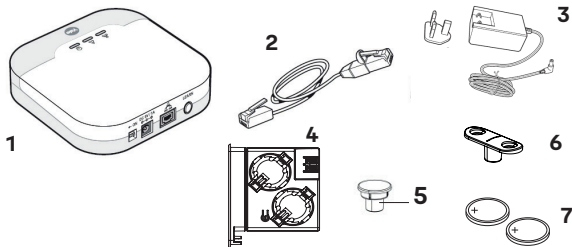

		IA-301	AC-DSM
1.	1 x Yale Sync Hub	✓	
2.	1 x Ethernet cable	✓	
3.	1 x Power supply	✓	
4.	1 x Smart Module	✓	✓
5.	1 x PVCu Door Frame Magnet Sensor (If not pre-fitted)	✓	✓
6.	1 x Composite/ Timber Door Frame Magnet Sensor (If not pre-fitted)	✓	✓
7.	2 x CR2032 3V Lithium batteries	✓	✓

Identifying the Parts

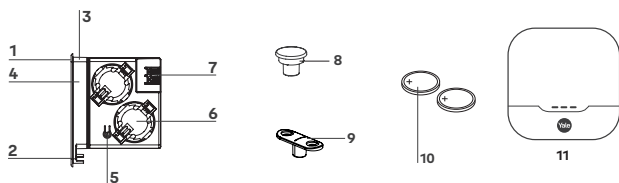

1. Smart Module
2. Module retaining screw
3. Magnet sensor
4. Red/Green LED Indicator
5. Learn Button
6. Battery location
7. Lock Sensor Cable connector
8. PVCu Door Frame Magnet Sensor
9. Composite / Timber Door Frame Magnet Sensor
10. 2 x CR2032 3V Lithium batteries
11. Yale Sync Hub

Tools required



Pozi screwdriver



Flat blade
screwdriver

Important Information

1. We may need to update your firmware during set up. Please click **'confirm'** if prompted.
2. Your Yale App may want to send notifications to your mobile phone. If requested, please click **'allow'**.

Getting Started

Step 1

If you already have a Yale Sync Hub installed in your home, please go to the top left Menu button on your Yale Smart Living Alarm App and select **'Add Device'**. You can now proceed to Step 4.

If you do not have a Yale Sync Hub currently installed, download the **Yale Smart Living Alarm App** from the App Store or Google Play Store.

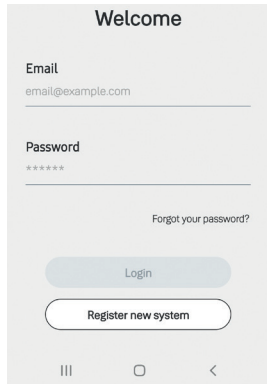

Click **'Register new system'** and continue to the **'Start Installation Wizard'**.

A screenshot of the Yale Smart Living Alarm App login screen. The screen has a light gray background and is titled "Welcome" at the top. Below the title, there are two input fields: "Email" with the placeholder text "email@example.com" and "Password" with the placeholder text "*****". Below the password field, there is a link that says "Forgot your password?". At the bottom of the form, there are two buttons: a light blue button labeled "Login" and a white button with a black border labeled "Register new system". At the very bottom of the screen, there are three navigation icons: a hamburger menu icon, a square home icon, and a left-pointing arrow icon.

Getting Started

Step 2

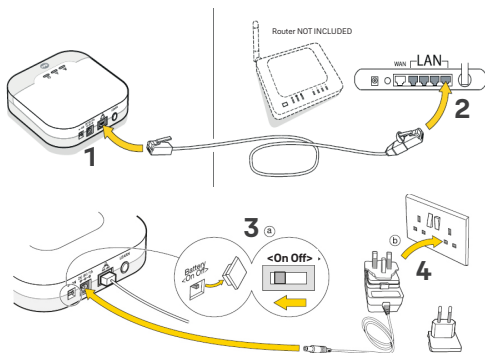

Connect Yale Sync Hub

1. Connect the Ethernet cable to the Yale Sync Hub.
2. Insert the other end into an available internet port in your home router.
3. Remove the small rubber battery switch cover, move the switch to ON, then replace the rubber cover.
4. Connect the power cable and switch to power on.

After approx. 30 seconds you will see a solid green LED light on top of the Yale Sync Hub.

* Your Yale Sync Hub is pre-fitted with an integrated battery back up pack.



Important note: Please register the Yale Sync Hub within one hour of power up, otherwise you may receive an app "authentication error". If this happens, switch the Hub on/off following the steps below and continue with your installation. Please also enable location services on your mobile phone.

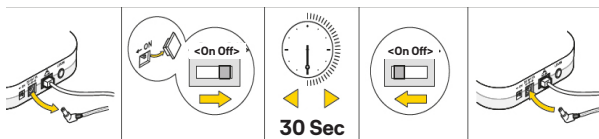

Account set up

Step 3

Follow the step by step guide on your smartphone to create your account.

Hints and tips:

Your password must be between 12 and 255 characters long and include:

- 1 Uppercase character
- 1 Lowercase character
- 1 Digit or special character

Your Master PIN code must be 4 digits.

Step 4: Select '**I am adding an alarm device**'.

Step 5: Select '**Activate learning mode**'.

Step 6: Your Yale Smart Living Alarm App will now search for your Door Sensor.

Inserting the batteries

Step 7: Whilst the Yale Smart Living Alarm App is searching for your door sensor, insert the two batteries into the Smart Module ('+' facing up). Press and release the Learn Button on the Smart Module, this will send a learning signal to the Yale Sync Hub.

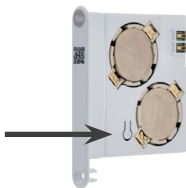

Complete pairing process

Step 8: If the Yale Sync Hub successfully received the signal, it will double-beep and the Yale Smart Living Alarm App will list the sensor as shown below. At this stage, you can name your sensors - i.e. Front Door.

If the Hub does not beep, make sure the batteries are fitted correctly and that the LED on the module flashes when you press the Learn button. If this still doesn't work, try moving the Hub closer to the door.

Once renamed click **'Add this device'**.



Smart Module Installation

Step 9: After the Smart Module is paired, remove the lock faceplate cover by removing the retaining screw.

Discard the cover and insert the paired Smart Module into the door, ensuring correct orientation (Yale logo positioned at the top).

Insert the retaining screw and re-tighten. The Smart Module will flash once fully inserted. Select **'Home'** button in the Yale Smart Living Alarm App to return to the Main



Important note: If your door has been supplied with the door frame sensor pre-fitted, please continue to App alerts.

Door Frame Sensor

Step 10: Fit the frame side magnet to the keep fitted in your door frame. The frame side magnet detects the open/closed position of the door. Remove black dummy cover from door frame keep with a screwdriver and replace with corresponding white magnet sensor.



App alerts

Following successful installation, you can now check the Door Sensor notifications. To validate these steps, please open your door and follow the sequence seen below:

Action: Open door

Action: Close door

Action: Lift handle and secure with turn of key

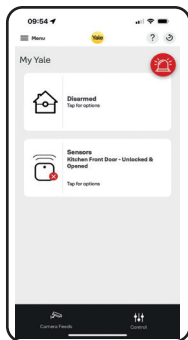

Red **X** indicates the door is unlocked and open.

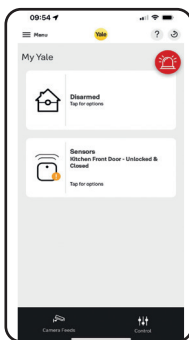

Amber **!** indicates the door is unlocked and closed.



Green **✓** indicates all doors are closed and locked.

Congratulations your Yale SensCheck Door Sensor is now installed.

Now you have successfully completed your installation, let's personalise your sensors.

Personalisation

Geofencing

To receive notifications regarding the status of your Yale Smart Sensors when leaving your property, go to the top left menu button on your Yale Smart Living Alarm App:

Settings > Users > Notifications > Geo-notifications

Move the yellow circle to position your geo-boundary and click '**Save**'.

Important note: Please enable location services on your mobile phone.

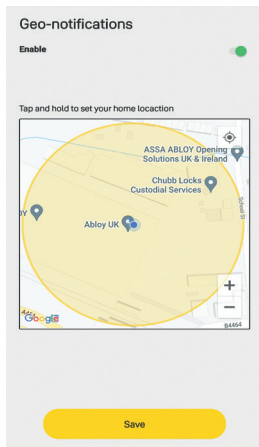

Personalisation

Chime notifications

To turn an audible chime on/off every time your door is opened, go to the top left menu button on your Yale Smart Living Alarm App:

Settings > Alarm Settings > Devices > Select named sensor > Panel Chime (on/off) > Save

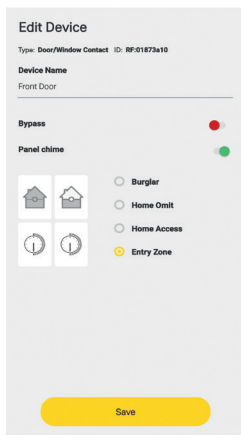

Personalisation

Chime notifications

To set the volume of your audible chime every time your door is opened, go to the top left menu button on your Yale Smart Living Alarm App:

Settings > Alarm settings > System settings > General configuration > Door/ window chime sounds > Save

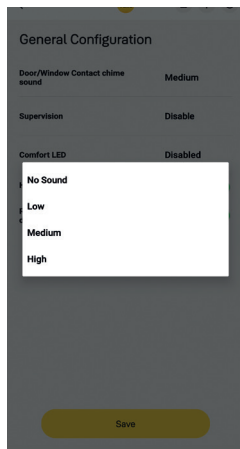

Useful information

Batteries

The Yale SensCheck Door Sensor uses two CR2032 3V Lithium batteries as its power source. When the battery is low, a low battery signal will be sent to the app and displayed as a warning on the app dashboard.

The Red LED will light up when the Door Sensor is activated under low battery status.

When it is time to change the batteries in the module, the app will show you a warning. Go to:

Menu > Settings > Alarm Settings > Devices > Battery Change.

This will handle bypassing the device so you don't set off the alarm. The app will link you to instruction for changing the batteries.

When the battery is exhausted, the Door Sensor will stop all function and the Red LED will flash every 4 seconds.

Useful information

Changing the Batteries

Unscrew the module retaining screw and remove the Smart Module. Remove the batteries and press the Learn button 5-6 times to fully discharge before inserting the new batteries. Once the new batteries are installed, re-insert the Smart Module and secure with the retaining screw.

Any time you want to change the batteries you can see a simple guide at any time by going to the device settings in

Menu > Settings > Alarm Settings > Devices click '**Help (?)**' at the top of the screen.



Useful information







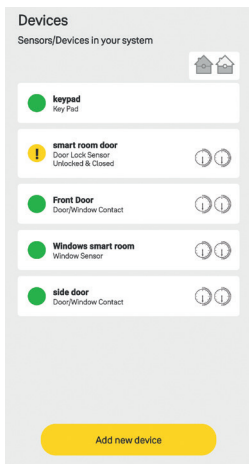





Sensor Status

To view the status of your sensors, go to the top left menu button on your Yale Smart Living Alarm App:

Settings > Alarm Settings > Devices



Trouble Shooting

<p>Fault Status </p> <p>Shows fault status and AC failure warning</p>	<p>  Check app history log to see fault details.</p> <p> </p> <p> System normal</p>
<p>Alarm Mode </p> <p>Shows arming status</p>	<p>  Fully Armed</p> <p>  Part Armed</p> <p>  Disarmed</p>

If you continue to have issues please visit <https://help.yale.co.uk>

Smart Together

Intelligently connected, our Sync Smart Home Alarm works with Google Assistant and Amazon Alexa, combining sound and voice to create the ultimate security deterrent.



Google and Google Play are trademarks of Google LLC.

Amazon, Alexa and all related logos are trademarks of Amazon.com, Inc. or its affiliates.

** For information on Amazon Alexa skills and country compatibility please refer to Amazon's website.



Scan QR tag for help and support and to view additional products within the Yale range

www.yalehome.co.uk

ASSA ABLOY Nederland B.V.
Postbus 40
4940 AA Raamsdonksveer
Nederland

ASSA ABLOY Opening Solutions
UK & Ireland
School Street, Willenhall
West Midlands, WV13 3PW UK

Version 2B

**Trusted
every day**

