

EN ORIGINAL INSTRUCTIONS

IMPORTANT - These instructions are for your safety.
Please read through them thoroughly prior to handling
the product and retain them for future reference.



ERI1022GGT

5059340904795

5059340904429

5063022544483

EN Parts

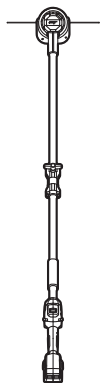

01. x1

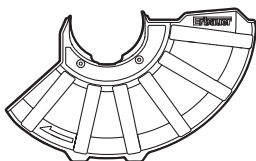

02. x1



03. x2



04. x1

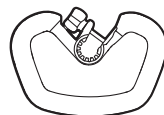

05. x1

EN You will need

x1



EN Contents

EN	
Product description	3
Safety	4
Technical specification	19
Before you start	20
Functions & Settings	25
Operation	27
Care and maintenance	32
Guarantee	37

EN Product Description

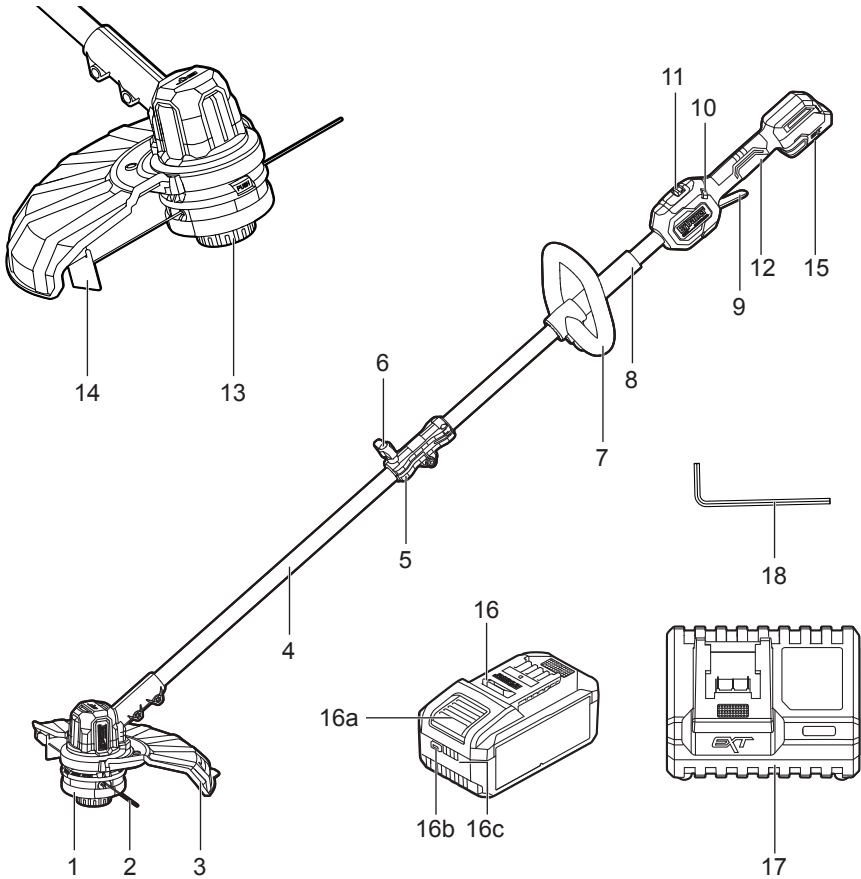

- | | | | |
|-----|--------------------|------|------------------------|
| 1. | Trimmer head | 12. | Rear handle |
| 2. | Cutting line | 13. | Bump knob |
| 3. | Safety guard | 14. | Line-cutting blade |
| 4. | Lower shaft | 15. | Battery docking port |
| 5. | Hinge and coupler | 16*. | Battery pack |
| 6. | Coupler lock screw | a. | Battery release button |
| 7. | Front handle | b. | Power bar button |
| 8. | Front handle stop | c. | Power bar |
| 9. | Trigger switch | 17*. | Charger |
| 10. | Lock-off button | 18. | Hex key |
| 11. | Two-speed switch | | |

NOTE: * This may not be included in the supply scope.



General power machine safety warnings



WARNING! Read all safety warnings, instructions, illustrations and specifications provided with this machine. *Failure to follow all instructions listed below may result in electric shock, fire and/or serious injury.* **Save all warnings and instructions for future reference.**

The term “machine” in the warnings refers to your mains-operated (corded) machine or battery-operated (cordless) machine.

Work area safety

- a) **Keep work area clean and well lit.** *Cluttered or dark areas invite accidents.*
- b) **Do not operate machines in explosive atmospheres, such as in the presence of flammable liquids, gases or dust.** *Machines create sparks which may ignite the dust or fumes.*
- c) **Keep children and bystanders away while operating a machine.** *Distractions can cause you to lose control.*

Electrical safety

- a) **Machine plugs must match the outlet. Never modify the plug in any way. Do not use any adapter plugs with earthed (grounded) machines.** *Unmodified plugs and matching outlets will reduce risk of electric shock.*

- b) Avoid body contact with earthed or grounded surfaces such as pipes, radiators, ranges and refrigerators.** *There is an increased risk of electric shock if your body is earthed or grounded.*
- c) Do not expose machines to rain or wet conditions.** *Water entering a machine will increase the risk of electric shock.*
- d) Do not abuse the cord. Never use the cord for carrying, pulling or unplugging the machine. Keep cord away from heat, oil, sharp edges or moving parts.** *Damaged or entangled cords increase the risk of electric shock.*
- e) When operating a machine outdoors, use an extension cord suitable for outdoor use.** *Use of a cord suitable for outdoor use reduces the risk of electric shock.*
- f) If operating a machine in a damp location is unavoidable, use a residual current device (RCD) protected supply.** *Use of an RCD reduces the risk of electric shock.*

Personal safety

- a) Stay alert, watch what you are doing and use common sense when operating a machine. Do not use a machine while you are tired or under the influence of drugs, alcohol or medication.** *A moment of inattention while operating machines may result in serious personal injury.*

- b) Use personal protective equipment. Always wear eye protection.** *Protective equipment such as a dust mask, non-skid safety shoes, hard hat, or hearing protection used for appropriate conditions will reduce personal injuries.*
- c) Prevent unintentional starting. Ensure the switch is in the off-position before connecting to power source and/or battery pack, picking up or carrying the machine.** *Carrying machines with your finger on the switch or energising machines that have the switch on invites accidents.*
- d) Remove any adjusting key or wrench before turning the machine on.** *A wrench or a key left attached to a rotating part of the machine may result in personal injury.*
- e) Do not overreach. Keep proper footing and balance at all times.** *This enables better control of the machine in unexpected situations.*
- f) Dress properly. Do not wear loose clothing or jewellery.** *Keep your hair and clothing away from moving parts. Loose clothes, jewellery or long hair can be caught in moving parts.*
- g) If devices are provided for the connection of dust extraction and collection facilities, ensure these are connected and properly used.** *Use of dust collection can reduce dust-related hazards.*
- h) Do not let familiarity gained from frequent use of machines allow you to become complacent and ignore machine safety principles.** *A careless action can cause severe injury within a fraction of a second.*

Machine use and care

- a) **Do not force the machine. Use the correct machine for your application. *The correct machine will do the job better and safer at the rate for which it was designed.***
- b) **Do not use the machine if the switch does not turn it on and off. *Any machine that cannot be controlled with the switch is dangerous and must be repaired.***
- c) **Disconnect the plug from the power source and/ or remove the battery pack, if detachable, from the machine before making any adjustments, changing accessories, or storing machines. *Such preventive safety measures reduce the risk of starting the machine accidentally.***
- d) **Store idle machines out of the reach of children and do not allow persons unfamiliar with the machine or these instructions to operate the machine. *Machines are dangerous in the hands of untrained users.***
- e) **Maintain machines and accessories. Check for misalignment or binding of moving parts, breakage of parts and any other condition that may affect the machine's operation. If damaged, have the machine repaired before use. *Many accidents are caused by poorly maintained machines.***
- f) **Keep cutting tools sharp and clean. *Properly maintained cutting tools with sharp cutting edges are less likely to bind and are easier to control.***
- g) **Use the machine, accessories and tool bits etc., in accordance with these instructions, taking into account the working conditions and the work to be performed. *Use of the machine for operations different from those intended could result in a hazardous situation.***

- h) Keep handles and grasping surfaces dry, clean and free from oil and grease. *Slippery handles and grasping surfaces do not allow for safe handling and control of the machine in unexpected situations.***

Battery machine use and care

- a) Recharge only with the charger specified by the manufacturer. *A charger that is suitable for one type of battery pack may create a risk of fire when used with another battery pack.***
- b) Use machines only with specifically designated battery packs. *Use of any other battery packs may create a risk of injury and fire.***
- c) When battery pack is not in use, keep it away from other metal objects, like paper clips, coins, keys, nails, screws, or other small metal objects, that can make a connection from one terminal to another. *Shorting the battery terminals together may cause burns or a fire.***
- d) Under abusive conditions, liquid may be ejected from the battery; avoid contact. If contact accidentally occurs, flush with water. If liquid contacts eyes, additionally seek medical help. *Liquid ejected from the battery may cause irritation or burns.***
- e) Do not use a battery pack or machine that is damaged or modified. *Damaged or modified batteries may exhibit unpredictable behaviour resulting in fire, explosion or risk of injury.***
- f) Do not expose a battery pack or machine to fire or excessive temperature. *Exposure to fire or temperature above 130°C may cause explosion.***
- g) Follow all charging instructions and do not charge the battery pack or machine outside the temperature range specified in**

the instructions. *Charging improperly or at temperatures outside the specified range may damage the battery and increase the risk of fire.*

Service

- a) **Have your machine serviced by a qualified repair person using only identical replacement parts. *This will ensure that the safety of the machine is maintained.***
- b) **Never service damaged battery packs. *Service of battery packs should only be performed by the manufacturer or authorized service providers.***

Grass trimmer safety warnings

- a) **Do not use the machine in bad weather conditions, especially when there is a risk of lightning. *This decreases the risk of being struck by lightning.***
- b) **Thoroughly inspect the area for wildlife where the machine is to be used. *Wildlife may be injured by the machine during operation.***
- c) **Thoroughly inspect the area where the machine is to be used and remove all stones, sticks, wires, bones, and other foreign objects. *Thrown objects can cause personal injury.***
- d) **Before using the machine, always visually inspect to see that the cutter or blade and the cutter or blade assembly are not damaged. *Damaged parts increase the risk of injury.***
- e) **Follow instructions for changing accessories. *Improperly tightened blade securing nuts or bolts may either damage the blade or result in it becoming detached.***

- f) Wear eye, head and hand protection.** *Adequate protective equipment will reduce personal injury by flying debris or accidental contact with the cutting line or blade.*
- g) While operating the machine, always wear non-slip and protective footwear. Do not operate the machine when barefoot or wearing open sandals.** *This reduces the chance of injury to the feet from contact with the moving cutters or lines.*
- h) While operating the machine, always wear long trousers.** *Exposed skin increases the likelihood of injury from thrown objects.*
- i) Keep bystanders away while operating the machine.** *Thrown debris can result in serious personal injury.*
- j) Always use two hands when operating the machine.** *Holding the machine with both hands will avoid loss of control.*
- k) Hold the machine by the insulated gripping surfaces only, because the cutting line or blade may contact hidden wiring.** *Cutting line or blades contacting a “live” wire may make exposed metal parts of the machine “live” and could give the operator an electric shock.*
- l) Always keep proper footing and operate the machine only when standing on the ground.** *Slippery or unstable surfaces may cause a loss of balance or control of the machine.*
- m) Do not operate the machine on excessively steep slopes.** *This reduces the risk of loss of control, slipping and falling which may result in personal injury.*

- n) When working on slopes, always be sure of your footing, always work across the face of slopes, never up or down and exercise extreme caution when changing direction. *This reduces the risk of loss of control, slipping and falling which may result in personal injury.***
- o) Keep all parts of the body away from the cutter, line or blade when the machine is operating. Before you start the machine, make sure the cutter, line or blade is not contacting anything. *A moment of inattention while operating the machine may result in injury to yourself or others.***
- p) Do not operate the machine above waist height. *This helps prevent unintended cutter or blade contact and enables better control of the machine in unexpected situations.***
- q) When cutting brush or saplings that are under tension, be alert for spring back. *When the tension in the wood fibres is released, the brush or sapling may strike the operator and/or throw the machine out of control.***
- r) Use extreme caution when cutting brush and saplings. *The slender material may catch the blade and be whipped toward you or pull you off balance.***
- s) Maintain control of the machine and do not touch cutters, lines or blades and other hazardous moving parts while they are still in motion. *This reduces the risk of injury from moving parts.***

- t) **Carry the machine with the machine switched off and away from your body.** *Proper handling of the machine will reduce the likelihood of accidental contact with a moving cutter, line or blade.*
- u) **Only use replacement cutters, lines, cutting heads and blades specified by the manufacturer.** *Incorrect replacement parts may increase the risk of breakage and injury.*
- v) **When clearing jammed material or servicing the machine, make sure the switch is off and the battery pack is removed.** *Unexpected starting of the machine while clearing jammed material or servicing may result in serious personal injury.*

Additional safety warnings for battery pack

- a) **Battery pack needs to be charged before use.** Always refer to the charger's instruction and charge it properly.
- b) **Remove the battery pack from the product when not in use.**
- c) **Don't maintain the battery pack on the charger when not in use.**
- d) **After extended periods of storage, it may be necessary to charge and discharge the battery pack several times to obtain the maximum performance.**
- e) **Longer life and better performance can be obtained if the battery is charged when the air temperature is between 18°C and 24°C.** *Do not charge the battery in air temperature below 5°C or above 40°C. This is important as it can prevent serious damage to the battery.*

- f) **Do not charge battery in a damp or wet location.**
Following this rule will reduce the risk of electric shock.
- g) **Do not disassemble the battery and avoid mechanical damage to the battery. Risk of short circuit and fumes may be emitted.** *Ensure fresh air and seek medical assistance in the event of discomfort.*
- h) **When disposing of battery pack, keep the battery pack of different electrochemical systems separate from each other.**

Vibration and noise reduction

To reduce the impact of noise and vibration emission, limit the time of operation, use low-vibration and low- noise operating modes as well as wear personal protective equipment.

Take the following points into account to minimize the vibration and noise exposure risks:

1. Only use the product as intended by its design and these instructions.
2. Ensure that the product is in good condition and well maintained.
3. Use correct application tools for the product and ensure they in good condition.
4. Keep tight grip on the handles/grip surface.
5. Maintain this product in accordance with these instructions and keep it well lubricated (where appropriate).
6. Plan your work schedule to spread any high vibration tool use across a longer period of time.

7. Prolonged use of the product exposes the user to vibrations that can cause a range of conditions collectively known as hand-arm vibration syndrome (HAVS) e.g. fingers going white; as well as specific diseases such as carpal tunnel syndrome. To reduce this risk when using the product, always wear protective gloves and keep your hands warm.

Emergency

Familiarise yourself with the use of this product by means of this instruction manual. Memorise the safety directions and follow them to the letter. This will help to prevent risks and hazards.

- 1. Always be alert when using this product, so that you can recognise and handle risks early.** *Fast intervention can prevent serious injury and damage to property.*
- 2. Switch off and disconnect from the power supply if there are malfunctions.** *Have the product checked by a qualified professional and repaired, if necessary, before you operate it again.*

Residual risks

Even if you are operating this product in accordance with all the safety requirements, potential risks of injury and damage remain. The following dangers can arise in connection with the structure and design of this product:

1. Health defects resulting from vibration emission if the product is being used over long periods of time or not adequately managed and properly maintained.
2. Injuries and damage to property due to broken accessories or the sudden impact of hidden objects during use.
3. Danger of injury and property damage caused by flying objects.



WARNING! This product produces an electromagnetic field during operation! This field may under some circumstances interfere with active or passive medical implants! To reduce the risk of serious or fatal injury, we recommend persons with medical implants to consult their doctor and the medical implant manufacturer before operating this product!

Symbols

On the product, the rating label and within these instructions you will find among others the following symbols and abbreviations. Familiarise yourself with them to reduce hazards like personal injuries and damage to property.

V 	Volt, (direct current voltage)	/min or min ⁻¹	Per minute
mAh	Milliampere per hour	mm	Millimetre
m	Metre	kg	Kilogram
l	Litre	m/s ²	Metres per second squared
cm ³	Cubic centimetre	dB(A)	Decibel (A-rated)

yyWxx Manufacturing date code: year of manufacturing (20yy) and week of manufacturing (Wxx).



Read the instruction manual.



Caution / Warning.



Note / Remark.



Wear eye protection



Wear ear protection



Wear protective gloves



Wear safety footwear



Wear protective clothing



Use appropriate protection for foot-leg and hand-arm.



Wear a mask



Do not install round cutting blades.



Do not use metal blades.



WARNING – Disconnect battery before maintenance



Switch the product off before assembly, cleaning, adjustments, maintenance, storage and transportation.



Objects thrown by the product could hit the user or other bystanders. Always ensure that other people and pets remain at a safe distance from the product when it is in operation. In general, children must not come near the area where the product is. Minimum distance 15m.



Do not use in rain or wet conditions.

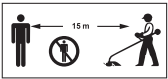

WARNING – The distance between the machine and bystanders shall be at least 15 m.



The cutting width of the grass trimmer is 33 cm.



Guaranteed sound power level value in xx dB(A).



WEEE symbol. Waste electrical products should not be disposed of with household waste. Please recycle where facilities exist. Check with your Local Authority or local store for recycling advice.



Crossed out dust bin. Batteries and battery packs should not be disposed of with household waste. Please recycle where facilities exist. Check with your Local Authority or local store for recycling advice



Do not dispose of battery packs in rivers or immerse in water.



Do not dispose of battery packs in fire. They will explode and cause injury.



Do not expose battery packs to heat in excess of 40 °C.

Do not charge or store the battery pack in temperatures below 5 °C (41 °F) and above 40 °C (104°F).



Li-Ion

This battery is recyclable. Please follow enforced recycling regulations.



The product complies with the applicable European directives and an evaluation method of conformity for these directives was done.



UK Conformity Assessed.

Rating label explanation

Cordless Grass Trimmer: ERI1022GGT

ER = Brand name (Erbauer)

I = 18V Lithium-Ion

1022 = Serial number

GGT =Garden Grass trimmer

EN Technical specifications

General:

- > **Rated voltage** 18V ---
- > **Maximum speed n_0** 5000 / 6000 /min
(two-speed switch):
- > **Cutting mechanism** Bump head
- > **Weight (without battery pack, without cutting head and safety guard)** approx. 1.8kg
- > **Weight(cutting head and safety guard)** approx.0.54kg
- > **Ambient temperature range for machine and battery use** 0°C to 40°C

Cutting line:

- > **Line diameter** 2 mm nylon twist line
- > **Cutting width** 33cm

Battery pack (may not be included)

- | | | |
|--------------------|---------------------------------------|---------------------------------------|
| > Model no. | ERT1044BAT | ERT1045BAT |
| > Type | Li-Ion | Li-Ion |
| > Voltage | 18 V --- / 36 V --- | 18 V --- / 36 V --- |
| > Capacity | 8 Ah / 4Ah | 6 Ah / 3 Ah |
| > Weight | approx. 1.2 kg | approx. 1.2 kg |



NOTE: This equipment is compatible with the Erbauer EXT 18V/36V dual-voltage lithium-ion battery range, and Erbauer EXT 18V lithium-ion battery range. For optimal performance, use 1X 18V/36V 6.0Ah/3.0Ah battery, or 1X 18V 5.0Ah battery.

Charger for battery pack (may not be included)

- | | | |
|---|------------------------|---------------------------|
| > Model no. | ERT1047CHR | ERT1046CHR |
| > Rated input | 220-240 V~ 50 Hz | 220-240 V~ 50 Hz |
| > Rated output | 21 V --- 12 A | 21 V --- x2 12 A |
| > Ambient temperature range for, charger and battery use | 5°C to 40°C | 5°C to 40°C |

Sound values:

- | | |
|--|---|
| > Sound pressure level L_{pA} | 74 dB(A) |
| > Uncertainty K_{pA} | 3 dB(A) |
| > Measured sound power level L_{WA} | 86 dB(A) |
| > Uncertainty K_{WA} | 1,6 dB(A) |
| > Guaranteed sound power level L_{WA}
(according to 2000/14/EC) | 88 dB(A) |
| > Vibration value a_h | Front Grip 2,1 m/s ² |
| | Rear Handle 1,0 m/s ² |
| > Uncertainty K | 1,5 m/s ² |

The sound value(s) have been determined according to noise test code given in EN IEC 62841-1 and EN ISO 11806-1 using the basic standards EN ISO 22868 and EN ISO 3744. The sound intensity level for the operator may exceed 80 dB(A) and ear protection measures are necessary. The declared total vibration value(s) and the declared noise emission value(s) have been measured in accordance with a standard test method and may be used for comparing one tool with another;

The declared total vibration value(s) and the declared noise emission value(s) may also be used in a preliminary assessment of exposure.



WARNING! The vibration and noise emission during actual use of the power tool can differ from the declared total value depending on the ways in which the tool is used especially what kind of workpiece is processed;

The need to identify safety measures to protect the operator that are based on an estimation of exposure in the actual conditions of use (taking account of all parts of the operating cycle such as the times when the tool is switched off and when it is running idle in addition to the trigger time).



EN Before you start

Unpacking

1. Unpack all parts and lay them on a flat, stable surface.
2. Remove all packing materials and shipping devices if applicable.
3. Make sure the delivery contents are complete and free of any damage. If you find that parts are missing or show damage do not use the product but contact your dealer. Using an incomplete or damaged product represents a hazard to people and property.
4. Ensure that you have all the accessories and tools needed for assembly and operation. This also includes suitable personal protective equipment.



WARNING! The product and the packaging are not children's toys! Children must not play with plastic bags, sheets and small parts! There is a danger of choking and suffocation!

You will need

(items not supplied)

Suitable personal protective equipment

(items supplied)

3mm hex key (18)

Safety guard (3) and screws

Front handle (7)



NOTE: The accessories required depend on the intended application. Ask your dealer for advice.

EN Assembly



WARNING! The product must be fully assembled before operation! Do not use a product that is only partly assembled or assembled with damaged parts!



WARNING! Disconnect the battery pack from the machine before making any assembly, adjustments, changing accessories, cleaning, or storing machine. Such preventive safety measures reduce the risk of starting the machine accidentally.



Follow the assembly instructions step-by-step and use the pictures provided as a visual guide to easily assemble the product!

Before using the product, familiarise yourself with the operating features read the entire instruction manual paying particular attention to the safety rules and operating procedures.

Do not connect the product to battery pack before it is completely assembled!

Unfolding the shaft



WARNING! In order to avoid pinching your hands or fingers, do not hold the shaft at the joints.



WARNING! Do not attempt to start the trimmer until the shaft has been locked.

1. Put your trimmer on the ground and carefully unfold the lower shaft (1). Make sure that the cable is inside the shaft so that it will not be pinched when closing the joints (Fig. 1).
2. Rotate the coupler lock screw (6) to lock the shaft (Fig. 2).

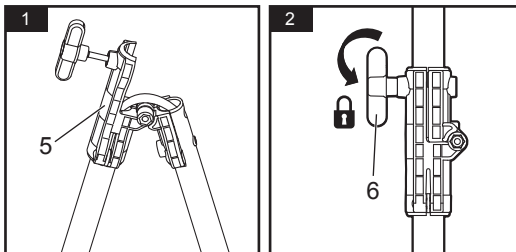

Mounting and adjusting the front handle

1. Push the front handle (7) onto the shaft, mount the lock bolt, and tighten it by using the wing nut (Fig. 3).
2. Adjust the front handle position to make sure your front arm is straight when using the trimmer before you fix the handle firmly.

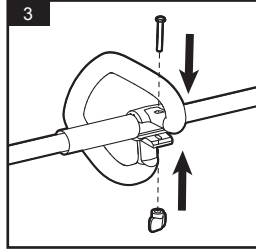

NOTE: The front handle should be turned upwards to point toward the top of the handle.



WARNING! The tool cannot be used without the front handle reliably fixed.

Mounting the guard



WARNING! Always wear gloves when mounting or replacing the guard. Be careful of the blade on the guard and protect your hands from being injured by the blade.

1. Lift the trimmer head (1) and face it downward; slide the guard into the channels on the trimmer head ensuring that the mounting holes align. Make sure that the internal surface of the guard faces towards the trimmer head (Fig. 4).

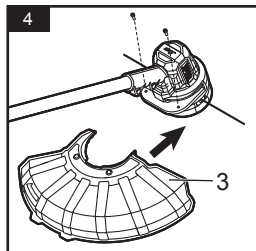

2. Lock the guard in place with the M4 hex screws supplied using the provided 3mm hex key (18).

Battery pack

Attaching / releasing the battery pack

1. Slide the battery pack into the battery docking port (15) until it is securely locked in position.
2. Depress the battery pack release button (16a) to release and slide the battery pack out from your tool. (Fig. 5)

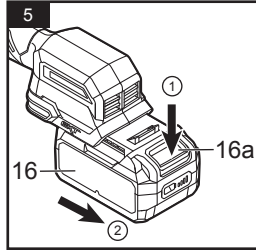

3. After recharge, slide the battery pack back into your tool. A simple push and slight pressure will be sufficient.

Charging the battery pack

The battery pack for this product has been shipped in a low charge condition. Charge it fully before first use.

Refer to the charger's instruction manual for the details.

Battery pack power bar

The Li-Ion battery pack is equipped with a power bar which is used to give an indication of the battery pack's remaining charge. Press the power bar button (11) to check battery charge as below. The LED will stay lit for approximately 5 seconds.

<p>11</p> <p>■ On □ Off</p>	76-100% Charge	
	51-75% Charge	
	26-50% Charge	
	0-25% Charge	

Battery storage



WARNING! Always charge the battery pack before storage! Please charge the battery pack to 3 bars on the battery light indicator. If the tool will not be used for long periods of time, charge the battery pack every 3-6 months. It is important to disconnect the charger from the power supply after charging has finished. Cool down battery pack from a just-operated product for approximately 20 minutes before attempting to recharge!

EN Functions & settings

Intended use

This grass trimmer ERI1022GGT is designated with a rated voltage of 18 V $\overline{\text{---}}$. It is designed only to be used with the battery pack which is listed in the chapter of “**Technical specifications**”.

The product is intended for cutting weed, grass, or similar soft vegetation in areas that are hard to reach, e.g. under bushes, on slopes and edges. It may not be used to work on unusual thick, dry or wet grass, e.g. pasture grass, or to shred leaves.

Do not use this product in wet or humid conditions.

For safety reasons it is essential to read the entire instruction manual before first operation and to observe all the instructions therein.

This product is intended for private domestic use only, not for any commercial trade use. It must not be used for any purposes other than those described.

Before each use, inspect the entire product for damaged, missing, or loose parts such as screws, nuts, bolts, caps, etc. Tighten securely all fasteners and caps and do not operate this product until all missing or damaged parts are replaced.

Switching on/off and changing rotation speed

1. Ensure the battery pack is assembled on the battery docking port (15).
2. To start the tool, press the lock-off button (10) then depress the trigger switch (9) (Fig. 6). Different pressure on the switch results in variable rotating speed of the cutting line. More pressure, higher speed.

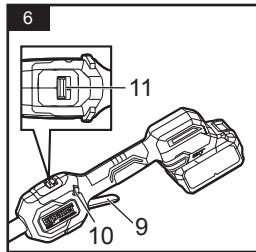

3. To stop the tool, release the lock-off button and the trigger switch.
4. The two-speed switch (11) is a slide switch. Slide the switch to change between low rotation speed 1 and high rotation speed 2.



NOTE: The motor runs only when the lock-off button and trigger switch are both pressed.



WARNING! Do not start the product while handling it with one hand.



WARNING! The product will continue to work for some time even after the motor has been switched off! Wait until it comes to a complete stop before you put the product down!



WARNING! Always remove the battery pack from the grass trimmer during work breaks and after finishing work.

EN Operation

General operation

1. Check the product, its battery pack and charger as well as accessories for damage before each use. Do not use the product if it is damaged or shows wear.
2. Double check that accessories or attachments are properly fixed.
3. Always hold the product by its handles. Keep the handles dry to ensure safe support.
4. Ensure that the air vents are always unobstructed and clear. Clean them if necessary with a soft brush. Blocked air vents may lead to overheating and damage the product.
5. Switch the product off immediately if you are disturbed while working by other people entering the working area. Always let the product come to complete stop before putting it down.
6. Do not overwork yourself. Take regular breaks and change working positions to ensure you can concentrate on the work and have full control over the product.
7. The guard and handle adjustments should be made with the motor stopped and battery removed.
8. Inspect machine for damage upon striking a hard object or if there appears to be excessive vibration.
9. Keep hands away from any sharp device intended to limit the length of the filament line.
10. Before using the machine, always visually inspect to see that the trimmer head is not blocked by foreign objects to avoid bad situation.
11. Notice that national regulation can restrict the use of the machine.
12. Inspect the tool for defects before use and after any impact to the tool.

Trimming

1. Hold the product with one hand on the rear handle and your other hand on the front handle. Keep a firm grip with both hands while operating the tool (Fig. 7).



2. Hold the product with a gap between the product and your body.
3. Stand upright, do not lean forward and pay attention to posture. Keep both feet apart to help retain your balance.
4. Hold the trimmer head (1) just above the ground.

5. Take regular rest periods during operation.



NOTE: The trimmer head is parallel to the ground at a proper cutting distance without operator bending over.

6. Avoid pressing it against the ground as this can ruin the lawn and damage the product. Move the product with a slow regular arc from left to right before moving it back to the starting position and trimming the next area (Fig. 8).

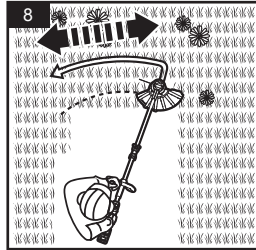

NOTE: Let the cutting device do the work. Let it work at its own pace, never press it into the area to be cut.

7. Ensure the cutting device remains clean and free from off-cuts that may cause it to jam. Check regularly. Release the trigger switch (9) and remove the battery pack before checking.
8. Trim longer grass in stages; do not cut long grass in one cut (Fig. 9a). For the best results, cut longer grass in steps (Fig. 9b).

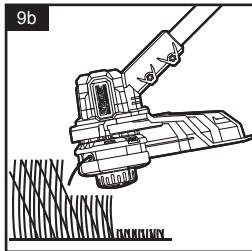
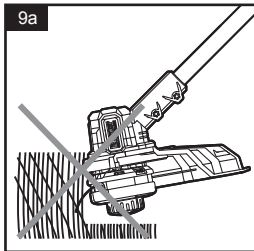

9. Wait until the product has come to a standstill before placing it down.

Tip

1. For best results, do not cut wet grass because it tends to stick to the trimmer head (1) and guard, prevents proper discharge of grass trimmings, and could cause you to slip and fall.
2. Pay special attention when performing the work close to trees and bushes. The trimmer head (1) could damage sensitive bark, and damage fence posts.
3. Carefully manoeuvre the product around objects, such as trees and bushes, ensuring it does not come into contact with them.

Adjusting cutting line length

The grass trimmer allows the operator to release more cutting line (2) without stopping the motor. As line becomes frayed or worn, additional line can be released by lightly tapping the bump knob (13) on the ground while operating the trimmer (Fig. 10).

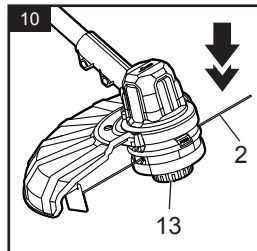

WARNING! Do not remove or alter the line-cutting blade assembly. Excessive line length will cause the motor to overheat and may result in serious personal injury.

For best results, tap the trimmer head on bare ground or hard soil. If line release is attempted in tall grass, the motor may overheat. Always keep the trimming line fully extended. Line release becomes more difficult as the cutting line becomes shorter.

Replacing the cutting line



NOTE: Always use the recommended cutting line with a diameter that does not exceed 2 mm. Using line other than that specified may cause the brush cutter to overheat or become damaged.

1. Remove the battery pack.
2. Cut one piece of cutting line 5 m long.
3. Press, while rotating the bump knob (13) to align the triangular marks on the bump knob and the cover (Fig. 11a).
4. Insert the line into the eyelet (Fig. 11b) and push the line until the end of the line comes out of the opposite eyelet.

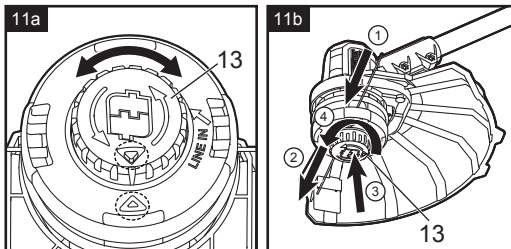

5. Pull the line from the other side until equal lengths of line appear on both sides.
6. Press, while rotating the bump knob (13) in the direction indicated by the arrow to wind the cutting line onto the spool that until approximately 15 cm of line is showing on each side.

7. Push the bump knob (13) down while pulling on both ends of the line to manually advance the line and to check for proper assembly of the trimmer head.

Cutting line maintenance

Should the cutting line break from the eyelet or the cutting line is not released when the trimmer head is tapped, you will need to remove the remaining cutting line from the trimmer head and follow the steps below to reload the line.

1. Remove the battery pack.
2. Press the release tabs and remove the cover of the trimmer head by pulling it straight out (Fig. 12).

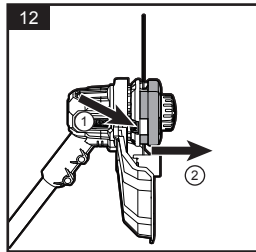

3. Remove the cutting line from the trimmer head.
4. With one hand holding the trimmer, use another hand to grasp the cover and align the slots in the trimmer head case with the release tabs. Press the cover until it snaps into place, at which time you will hear a distinct click sound (Fig. 13).

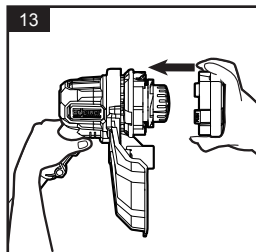

5. Follow the instructions in the “**Replacing the cutting line**” section to reload the cutting line.

Operating hours

Only operate the product at reasonable hours - not early in the morning, late at night or on weekends/public holidays when people might be disturbed. Inform yourself about local restrictions.

After use

1. Switch the product off and move the grass trimmer away from cutting area.
2. Remove the battery pack and let the product cool down.
3. Check, clean and store the product as described below.

EN Care and maintenance

The golden rules for care



WARNING! Always switch the product off, remove the battery pack and let the product cool down before performing inspection, maintenance and cleaning work!

1. Keep the product clean. Remove debris from it after each use and before storage.
2. Regular and proper cleaning will help ensure safe use and prolong the life of the product.
3. Inspect the product before each use for worn and damaged parts. Do not operate it if you find broken and worn parts.



WARNING! Only perform repairs and maintenance work according to these instructions! All further works must be performed by a qualified specialist! Improper maintenance may cause serious injuries.

General cleaning

1. Make sure the product is switched off, cooled down and the battery pack is removed.
2. Clean the product with a slightly damp cloth and mild soap. Use a brush for areas that are hard to reach.
3. In particular clean the air vents after every use with a cloth and brush.
4. Remove stubborn dust with high pressure air (max. 3 bar).
5. Cleaning and maintenance before storage.



NOTE: Do not use chemical, alkaline, abrasive or other aggressive detergents or disinfectants to clean this product as they might be harmful to its surfaces.

6. Check for loose fasteners, damage and worn parts. Repair damages in accordance with this instruction manual or take it to an authorised service centre before using the product again.

Replacing the line spool



WARNING! Always use original spare parts for replacement. Do not attach any other type of cutting device!

1. Remove the battery pack.
2. Press the release tabs and remove the cover of the trimmer head by pulling it straight out (Fig. 14).

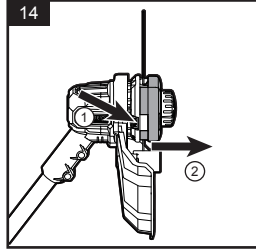

3. Remove the cutting line from the trimmer head.
4. Remove the bump knob (13) and the line spool by pulling them straight out (Fig. 15).

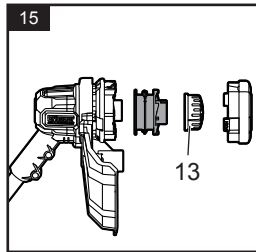

5. Align the triangular marks on the bump knob (13) and line spool before installing the bump knob onto the line spool (Fig. 16).

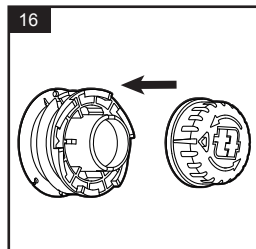

6. Mount the line spool with the bump knob (13) onto the trimmer head.

7. With one hand holding the trimmer, use another hand to grasp the cover and align the slots in the trimmer head case with the release tabs. Press the cover until it snaps into place, at which time you will hear a distinct click sound (Fig. 17).

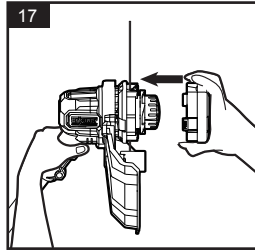

8. Follow the instructions in the “Replacing the cutting line” section to reload the cutting line.

Spare parts / Replacement parts

The following parts of this product may be replaced by the consumer. Spare parts are available at an authorised dealer or through our customer service.

Description	Model no. or Specification
Trimmer head	Tecomec EW102

Repair

This product does not contain any parts that can be repaired by the consumer. Contact an authorized service centre or a similarly qualified person to have it checked and repaired.

Storage

1. Switch the product off and remove the battery pack.
2. Clean the product as described above.
3. Store the product and its accessories in a dry, frost-free, well- ventilated place.
4. Always store the product in a place that is inaccessible to children. The ideal storage temperature is between 10 and 30°C.
5. We recommend using the original package for storage to protect it against dust.
6.  **WARNING!** Always charge the battery pack before storage! Please charge the battery pack to 3 bars on the battery light indicator. If the tool will not be used for long periods of time, charge the battery pack every 3-6 months. It is important to disconnect the charger from the power supply after charging has finished. Cool down battery pack from a just-operated product for approximately 20 minutes before attempting to recharge!

Transportation

1. Switch the product off and remove the battery pack.
2. Protect the product from any heavy impact or strong vibrations which may occur during transportation in vehicles.
3. Secure the product to prevent it from slipping or falling over.

Troubleshooting

Suspected malfunctions are often due to causes that the users can fix themselves. Therefore check the product using this section. In most cases the problem can be solved quickly.



WARNING! Only perform the steps described within these instructions! All further inspection, maintenance and repair work must be performed by an authorised service centre or a similarly qualified specialist if you cannot solve the problem yourself!

Problem	Possible cause	Solution
1. Product does not start	1.1. Battery pack is not properly attached	1.1. Attach properly
	1.2. Battery pack is discharged	1.2. Remove and charge battery pack
	1.3. Battery pack is damaged	1.3. Check by a specialist electrician
	1.4. Other electrical defect to the product	1.4. Check by a specialist electrician
2. Product does not reach full power	2.1. Battery pack capacity too low.	2.1. Charge battery pack
3. Excessive vibration or noise	3.1. Line spool is damaged	3.1. Replace with a new one
	3.2. Bolts/nuts are loose.	3.2. Tighten bolts/nuts
	3.3. Cutting line is worn/ damaged	3.3. Replace with a new one

Recycling and disposal



This symbol is known as the 'Crossed-out Wheelie Bin Symbol'. When this symbol is marked on a product or battery, it means that it should not be disposed of with your general household waste. Some chemicals contained within electrical/electronic products or batteries can be harmful to health and the environment. Only dispose of electrical/ electronic/battery items in separate collection schemes, which cater for the recovery and recycling of materials contained within. Your co-operation is vital to ensure the success of these schemes and for the protection of the environment.

For further information visit www.recycle-more.co.uk

Disposal of an exhausted battery pack



The battery is Li-Ion type. To preserve natural resources, please recycle or dispose of the battery pack properly. Consult your local waste authority for information regarding available recycling and / or disposal options.

Discharge your battery pack by operating your tool, then remove the battery pack from the tool and cover the battery pack connections with heavy duty adhesive tape to prevent short circuit and energy discharge.

Do not attempt to open or remove any of the components.

EN Guarantee

At **Erbauer** we take special care to select high quality materials and use manufacturing techniques that allow us to create ranges of products incorporating design and durability.

We carry out stringent testing procedures on all our tools and are confident that they can provide regular, sustained daily use during the period covered.

This power tool is guaranteed for 3 years from the date of purchase, if bought in store, delivered or bought online. You may only make a claim under this guarantee upon presentation of your sales receipt or purchase invoice. Please keep your proof of purchase in a safe place.

This guarantee covers product failures and malfunctions provided the **Erbauer** power tool was used for the purpose for which it is intended and subject to installation, cleaning, care and maintenance in accordance with standard practice and with the information contained above and in the user manual. This guarantee does not cover defects and damage caused by or resulting from:

- Normal wear and tear
- Overload, misuse or neglect
- Repairs attempted by anyone other than an authorized agent
- Cosmetic damage
- Damage caused by foreign objects, substances or accidents
- Accidental damage or modification
- Failure to follow manufacturer's guidelines
- Loss of use of the goods

This guarantee is limited to parts recognised as defective. It does not, in any case, cover ancillary costs (movement, labour) and direct and indirect damage. If the **Erbauer** power tool is defective during the guarantee period, then we reserve the right, at our discretion, to replace the item with a product of equivalent quality and functionality or to provide a refund.

This guarantee only applies to the country of purchase or delivery and is not transferrable to any other countries. This guarantee is non-transferrable to any other person or product. Relevant local law will apply to this guarantee.

Guarantee related queries should be addressed to a store affiliated with the distributor from where you purchased the **Erbauer** power tool.

Erbauer battery and charger are guaranteed for 2 years and covered by all others terms within the above guarantee.

This guarantee is in addition to and does not affect your statutory rights relating to faulty goods as a consumer.

Manufacturer:

Kingfisher International Products Limited
1 Paddington Square, London, W2 1GG, United Kingdom www.kingfisher.com/products

Distributor:

B&Q plc
Chandlers Ford, Hants, SO53 3LE, United Kingdom
www.diy.com

Screwfix Direct Limited
Trade House, Mead Avenue, Yeovil, BA22 8RT, United Kingdom
www.screwfix.com

**IMPORTANT - RETAIN THIS
INFORMATION FOR FUTURE
REFERENCE: READ CAREFULLY**

EN Customer care and technical helpline

A better way to repair your tools

Kingfisher takes special care in creating high-quality garden power tools that are designed to last. But if a fault develops with your garden power tool and you need to claim under the guarantee, the Customer Care and Technical Helpline can support with technical assistance or if required, arrange a free courier collection from your home, assess your garden power tool for fault, repair it, and return it.

Deciding to repair your product rather than buying a replacement and adding to the mountain of waste is a more sustainable choice and you will be doing your bit for the environment.

How does it work?



NOTE: Before collection, all fuel must be removed from petrol powered machines.

Get in touch

If you need help or more information, please contact the Customer Care and Technical Helpline:

UK 0330 678 3077

ROI 1 800 365 800

Opening hours are Monday – Friday, 8am-5pm

Availability of spare parts

Contact the customer service helpline for assistance or visit www.kingfishersparses.com

For assistance contact the customer services helpline:

UK 0800 0789647 uk@kingfisherservice.com

EIRE 1800 932226 eire@kingfisherservice.com

Further information about this product can also be found at:

www.kingfisher.com/products



EN Declaration of conformity



(EN) EU DECLARATION OF CONFORMITY
(FR) DÉCLARATION UE DE CONFORMITÉ
(PL) DEKLARACJA ZGODNOŚCI UE
(RO) DECLARAȚIA DE CONFORMITATE UE
(ES) DECLARACIÓN UE DE CONFORMIDAD
(PT) DECLARAÇÃO DE CONFORMIDADE UE

Product/ Produit/ Produkt/Produsul/Producto/Producto

- Cordless Grass Trimmer/ Coupe-bordure Sans Fil/ Bezprzewodowe Nożyce Do Trawy/ Trimer Pentru Iarbă Fără Fir/ Cortacésped De Filamento Inalámbrico/ Aparador De Relva Sem Fios
- 81002.1/ERI1022GGT
- Serial number 00001-99999

Name and address of the manufacturer or his authorised representative:

Nom et adresse du fabricant ou de son mandataire:

Nazwa i adres producenta lub jego upoważnionego przedstawiciela:

Denumirea și adresa producătorului sau a reprezentantului său autorizat:

Nombre y dirección del fabricante o de su representante autorizado:

Nome e endereço do fabricante ou do respetivo mandatário:

Kingfisher International Products B.V.,
Rapenburgerstraat 175E,
1011 VM Amsterdam,
The Netherlands

This declaration of conformity is issued under the sole responsibility of the manufacturer.

La présente déclaration de conformité est établie sous la seule responsabilité du fabricant. Niniejsza deklaracja zgodności wydana zostaje na wyłączną odpowiedzialność producenta. Prezenta declarație de conformitate este emisă pe răspunderea exclusivă a producătorului.

La presente declaración de conformidad se expide bajo la exclusiva responsabilidad del fabricante.

A presente declaração de conformidade é emitida sob a exclusiva responsabilidade do fabricante.

Object of the declaration/ Objet de la déclaration/ Przedmiot deklaracji/ Obiectul declarației/ Objeto de la declaración/ Objeto da declaração

Product/ Produit/ Produkt/Produsul/ Producto/
Producto

Cordless Grass Trimmer/ Coupe-bordure Sans
Fil/ Bezprzewodowe Nożyce Do Trawy/ Trimer
Pentru Iarbă Fără Fir/ Cortacésped De Filamento
Inalámbrico/ Aparador De Relva Sem Fios

Model/ Modèle/ Model/ Modelul/ Modelo/ Modelo

81002.1/ERI1022GGT

The object of the declaration described above is in conformity with the relevant Union harmonisation legislation:

L'objet de la déclaration décrit ci-dessus est conforme à la législation d'harmonisation de l'Union applicable:

Wymieniony powyżej przedmiot niniejszej deklaracji jest zgodny z odpowiednimi wymaganiami unijnego prawodawstwa harmonizacyjnego:

Obiectul declarației descris mai sus este în conformitate cu legislația relevantă de armonizare a Uniunii:
El objeto de la declaración descrita anteriormente es conforme con la legislación de armonización pertinente de la Unión:

O objeto da declaração acima descrito está em conformidade com a legislação de harmonização da União aplicável:

<p>2006/42/EC as amended Machinery Directive 2014/30/EU as amended Directive Electromagnetic compatibility 2000/14/EC as amended Outdoor Noise Directive 2011/65/EU as amended Directive Restriction of the use of certain hazardous substances in electrical and electronic equipment Directive 2006/42/CE relative aux machines 2014/30 / UE telle que modifiée Directive Compatibilité électromagnétique Directive 2000/14/CE relative aux émissions sonores extérieures Directive 2011/65/UE relative à la limitation de l'utilisation de certaines substances dangereuses dans les équipements électriques et électroniques 2006/42/WE w zmienionej dyrektywie maszynowej 2014/30 / UE ze zmianami Dyrektywa Kompatybilność elektromagnetyczna 2000/14/WE w zmienionej dyrektywie w sprawie hałasu na zewnątrz 2011/65 / UE ze zmianami Dyrektywa Ograniczenie stosowania niektórych niebezpiecznych substancji w sprzęcie elektrycznym i elektronicznym 2006/42/CE, astfel a fost modificată Directiva privind echipamentele 2014/30/UE, astfel a fost modificată Directiva privind compatibilitatea electromagnetică 2000/14/CE, astfel a fost modificată Directiva privind zgomotul în aer liber 2011/65/UE, astfel a fost modificată Directiva privind limitarea utilizării anumitor substanțe periculoase în echipamentele electrice și electronice Directiva sobre maquinaria modificada 2006/42/CE 2014/30/UE modificada Directiva Compatibilidad electromagnética 2000/14/CE modificada Directiva sobre ruido al aire libre 2011/65/UE modificada Directiva Restricción del uso de determinadas sustancias peligrosas en equipos eléctricos y electrónicos 2006/42/CE como diretiva de máquinas alteradas 2014/30/UE como alteração da compatibilidade eletromagnético 2000/14/CE como diretiva de ruído exterior alterada 2011/65/UE como restrição diretiva alterada da utilização de certas substâncias perigosas em equipamentos elétricos e eletrônicos</p>	<p>2006/42/EC as amended Machinery Directive 2014/30/EU as amended Directive Electromagnetic compatibility 2000/14/EC as amended Outdoor Noise Directive 2011/65/EU as amended Directive Restriction of the use of certain hazardous substances in electrical and electronic equipment Directive 2006/42/CE relative aux machines 2014/30 / UE telle que modifiée Directive Compatibilité électromagnétique Directive 2000/14/CE relative aux émissions sonores extérieures Directive 2011/65/UE relative à la limitation de l'utilisation de certaines substances dangereuses dans les équipements électriques et électroniques 2006/42/WE w zmienionej dyrektywie maszynowej 2014/30 / UE ze zmianami Dyrektywa Kompatybilność elektromagnetyczna 2000/14/WE w zmienionej dyrektywie w sprawie hałasu na zewnątrz 2011/65 / UE ze zmianami Dyrektywa Ograniczenie stosowania niektórych niebezpiecznych substancji w sprzęcie elektrycznym i elektronicznym 2006/42/CE, astfel a fost modificată Directiva privind echipamentele 2014/30/UE, astfel a fost modificată Directiva privind compatibilitatea electromagnetică 2000/14/CE, astfel a fost modificată Directiva privind zgomotul în aer liber 2011/65/UE, astfel a fost modificată Directiva privind limitarea utilizării anumitor substanțe periculoase în echipamentele electrice și electronice Directiva sobre maquinaria modificada 2006/42/CE 2014/30/UE modificada Directiva Compatibilidad electromagnética 2000/14/CE modificada Directiva sobre ruido al aire libre 2011/65/UE modificada Directiva Restricción del uso de determinadas sustancias peligrosas en equipos eléctricos y electrónicos 2006/42/CE como diretiva de máquinas alteradas 2014/30/UE como alteração da compatibilidade eletromagnético 2000/14/CE como diretiva de ruído exterior alterada 2011/65/UE como restrição diretiva alterada da utilização de certas substâncias perigosas em equipamentos elétricos e eletrônicos</p>
<p>Measured Sound Power Level Le niveau de puissance acoustique mesuré Zmierzony poziom mocy akustycznej Nivel de putere acustică măsurat Nível de potencia sonora medido Nível de potência sonora medido : 85 dB(A)</p>	<p>Guaranteed Sound Power Level Le niveau de puissance acoustique garant Gwarantowany poziom mocy akustycznej Nivel de putere acustică garantat Nível de potencia sonora garantizado Nível de potência sonora garantido : 88 dB(A)</p>

References to the relevant harmonised standards used or references to the other technical specifications in relation to which conformity is declared:
Références des normes harmonisées pertinentes appliquées, y compris la date de celles-ci, ou des autres spécifications techniques, y compris la date de celles-ci, par rapport auxquelles la conformité est déclarée:
Odwolania do odnośnych norm zharmonizowanych, które zastosowano, wraz z datą normy, lub do innych specyfikacji technicznych, wraz z datą specyfikacji, w odniesieniu do których deklarowana jest zgodność:
Trimiteri la standardele armonizate relevante folosite, inclusiv data standardului, sau trimeri la celelalte specificații tehnice, inclusiv data specificațiilor, în legătură cu care se declară conformitatea:
Referencias a las normas armonizadas pertinentes utilizadas, incluidas las fechas de las normas, o referencias a las otras especificaciones técnicas, incluidas las fechas de las especificaciones, respecto a las cuales se declara la conformidad:
Referências às normas harmonizadas aplicáveis utilizadas, incluindo a data da norma, ou às outras especificações técnicas, incluindo a data da especificação, em relação às quais é declarada a conformidade:

EN 62841-1:2015+A11:2022
EN ISO 11806-1:2011
EN IEC 55014-1:2021
EN IEC 55014-2:2021

Where applicable, the notified body **DEKRA Testing and Certification GmbH, Handwerkstraße 15, 70565 Stuttgart, Germany, 0158** performed performed **Outdoor Noise Directive** and issued the certificate: 4421069.24007

Le cas échéant, l'organisme notifié **DEKRA Testing and Certification GmbH, Handwerkstraße 15, 70565 Stuttgart, Germany, 0158** a effectué **Outdoor Noise Directive** et a établi le certificate: 4421069.24007

W stosownych przypadkach jednostka notyfikowana **DEKRA Testing and Certification GmbH, Handwerkstraße 15, 70565 Stuttgart, Germany, 0158** przeprowadziła **Outdoor Noise Directive** i wydała certyfikat: 4421069.24007

După caz, organismul notificat **DEKRA Testing and Certification GmbH, Handwerkstraße 15, 70565 Stuttgart, Germany, 0158** a efectuat **Outdoor Noise Directive** și a emis certificatul: 4421069.24007

Si procede, el organismo notificado **DEKRA Testing and Certification GmbH, Handwerkstraße 15, 70565 Stuttgart, Germany, 0158** ha efectuado **Outdoor Noise Directive** y expide el certificado: 4421069.24007

Se for esse o caso, o organismo notificado: **DEKRA Testing and Certification GmbH, Handwerkstraße 15, 70565 Stuttgart, Germany, 0158** efetuou **Outdoor Noise Directive** e emitiu o certificado: 4421069.24007

Authorised signatory and technical file holder/signataire et responsable de la documentation technique
authorisé/ podmiot uprawniony do wystawienia i adres prezechowywania dokumentacji technicznej/
semnatar autorizat și deținător al dosarului tehnic/firmante autorizado y titular del expediente técnico/
signatário autorizado e detentor da ficha técnica

Kingfisher International Products B.V.,
Rapenburgerstraat 175E,
1011 VM Amsterdam,
The Netherlands

A handwritten signature in black ink, appearing to read 'David Awe', with a long horizontal stroke extending to the right.

David Awe
Group Quality Director

30/07/2024



(UK) DECLARATION OF CONFORMITY

Product

- Grass Trimmer
- 81002.1/ERI1022GGT
- Serial number 00001-99999

Name and address of the manufacturer or his authorised representative:

Kingfisher International Products Limited
1 Paddington Square
London
W2 1GG
United Kingdom

This declaration of conformity is issued under the sole responsibility of the manufacturer.

Object of the declaration

Product

Grass Trimmer

Model

81002.1/ERI1022GGT

The object of the declaration described above is in conformity with the relevant legislation:

2006/42/EC as amended Machinery Directive

2014/30/EU as amended Directive Electromagnetic compatibility

2000/14/EC as amended Outdoor Noise Directive

2011/65/EU as amended Directive Restriction of the use of certain hazardous substances in electrical and electronic equipment

Measured Sound Power Level: 86 dB(A)

Guaranteed Sound Power Level: 88 dB(A)

References to the relevant designated standards used or references to the other technical specifications in relation to which conformity is declared:

EN 62841-1:2015+A11:2022

EN ISO 11806-1:2011

BS EN 62841-1:2015+A11:2022

BS EN ISO 11806-1:2011

EN IEC 55014-1:2021

EN IEC 55014-2:2021

BS EN IEC 55014-1:2021

BS EN IEC 55014-2:2021

Where applicable, the approved body **Intertek Testing and Certification Limited (Approved Body 0359)** performed **Outdoor Noise Directive** and issued the certificate: 24K-ONR-0012-R01

Authorised signatory and technical file holder:

Kingfisher International Products Limited
1 Paddington Square
London
W2 1GG
United Kingdom

A handwritten signature in black ink, appearing to read 'David Awe', with a horizontal line extending to the right from the end of the signature.

David Awe
Group Quality Director

On:30/07/2024

Manufacturer :

UK Manufacturer:

Kingfisher International Products Limited,
1 Paddington Square, London, W2 1GG,
United Kingdom

EU Manufacturer:

Kingfisher International Products B.V.
Rapenburgerstraat 175E
1011 VM Amsterdam
The Netherlands

EN www.diy.com

www.screwfix.com

www.screwfix.ie

**To view instruction manuals online,
visit www.kingfisher.com/products**