

EN Electric Towel Warmer Flomasta

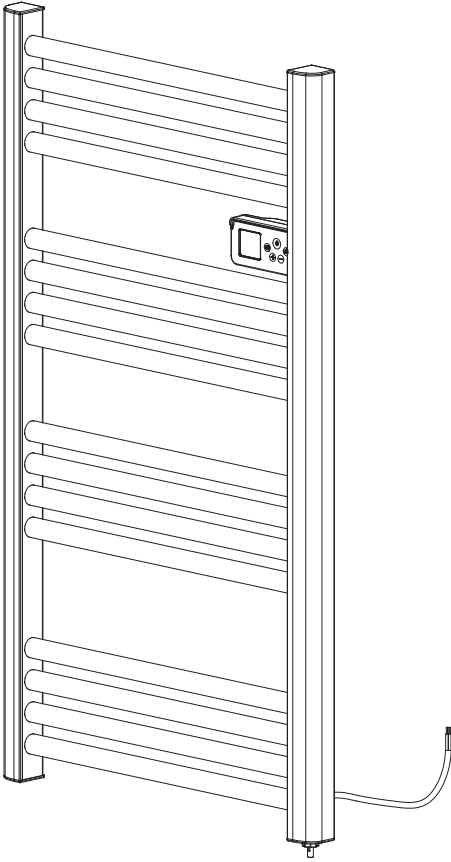

EN IMPORTANT - These instructions are for your safety. Please read through them thoroughly prior to handling the product and retain them for future reference. This product is only suitable for well insulated spaces or occasional use.

V10724_5059340987132_MAND2_2324

5059340987132
5059340987163

EN Parts

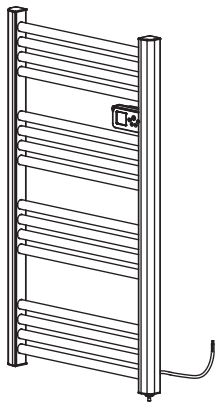

01. x1

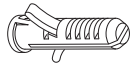

02. x4
Ø8 x 64 mm



03. x4
ST4.8 x 60 mm

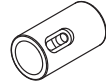

04. x4



05. x4

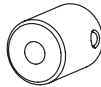

06. x4



07. x4
M5 x 12 mm



08. x4
M6 x 20 mm

EN You will need

x1



8 mm

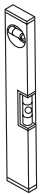
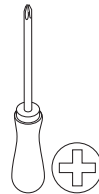
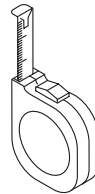
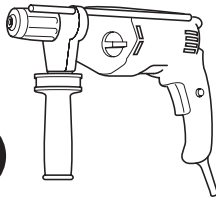

EN Contents

Safety	3
Guarantee	10
Preparation	11
Installation	11
Use	15
Care & maintenance	22



EN

Before you start

- Read these important instructions carefully before using the appliance.
- Keep these instructions during all the appliance's lifespan for future reference.
- Always give these instructions to anyone who will use the appliance, even if it's transferred to a third party.

Safety

- Failure to observe safety instructions can cause potential injuries or property damage (Electric shock, burns, fire, ...).
- Instructions are intended to protect your health and health of others, but also prevent potential damage to the appliance.
- This appliance is only intended to hold, warm and dry water-soaked textile towels in a domestic application and under no circumstances in a commercial or industrial professional setting.
- An appliance with a rating power ≥ 300 W can be considered as sufficient for a room heating provided the appliance rated power is adapted to the room volume, its insulation quality and your home location for an optimal performance.
- Please always refer to instructions for precautions intended to user cleaning, maintenance, installation and fixing the appliance to its support.



DANGER: PARTICULAR ATTENTION SHALL BE GIVEN FOR THE APPLIANCE INSTALLATION REGARDING TO WATER PROJECTION PROTECTION AS SPECIFIED IN THE INSTALLATION CHAPTER AND TECHNICAL SPECIFICATIONS.

- Please refer to appliance symbols explanations inside this instruction manual.



WARNING: IN ORDER TO AVOID A HAZARD FOR VERY YOUNG CHILDREN, THIS APPLIANCE SHOULD BE INSTALLED SO THAT THE LOWEST HEATED RAIL IS AT LEAST 600 MM ABOVE THE FLOOR.

- The appliance is to be installed so that switches and other controls cannot be touched by a person in the bath or shower.
- This appliance is designed to be vertically wall mounted on a flat wall using fixing parts supplied.
- Minimum spaces between the appliance and surrounding structures shall be observed, please refer to the installation schemes.



WARNING: THE WALL SHALL BE STRUCTURALLY SOUND WITH A MATERIAL CAPABLE OF WITHSTANDING APPLIANCE WEIGHT AND MODERATE HEAT LIKE:

- Finished plaster
- Dry-lined plaster board
- Conventional wallpaper
- Brick wall, etc ...
- Always check wall or wall coating thermal resistance before installation.
- Some wall materials are sensitive to heat and shall be avoided:
 - Flocking
 - Blown vinyl
 - Embossed paper
 - Cloth wall covering, etc ...
- Some discoloration may occur in time according to wall materials, air impurities and appliance use frequency.
- Please contact a qualified professional electrician if assistance is needed about the installation.
- The heater must not be located immediately below a socket outlet.
- Using of adhesives as fixing method is prohibited as they are not considered to be a reliable fixing means.



WARNING: TO REDUCE THE RISK OF FIRE, KEEP TEXTILES, CURTAINS, OR ANY OTHER FLAMMABLE MATERIAL A MINIMUM DISTANCE OF 1 M FROM THE AIR OUTLET.

- The appliance is to be supplied through a residual current device (RCD) having a rated residual operating current not exceeding 30 mA.



CAUTION: DO NOT BEND, CRUSH OR PINCH THE ELECTRIC SUPPLY CORD BEHIND THE APPLIANCE. LEAVE ENOUGH SPACE BEHIND THE APPLIANCE SO THAT IT IS NOT IN DIRECT CONTACT WITH THE FIXED ELECTRIC WIRING SYSTEM.

- When installing the appliance, make sure the appliance is positioned in a way that ensures its heated parts are not in direct contact with the fixed electric wiring system. If it does, the fixed wiring insulation must be protected, for example, by an insulating sleeving having an appropriate temperature rating. Please contact a qualified professional electrician if assistance is needed about the fixed electric wiring insulation.
- The appliance must not be connected via an extension cable or a power strip.



DANGER: NEVER CONNECT / DISCONNECT THE APPLIANCE WITH WET HANDS, RISK OF ELECTRIC SHOCK.

- If the appliance is fitted with an electric supply cord with a power plug, this one must remain accessible or a switch must be installed in the fixed electric wiring system in accordance with the national electric installation rules so that the appliance can be disconnected from the electric power supply network whatever the circumstances.
- If the appliance is not fitted with an electric supply cord with a power plug, only the above second solution must be applied.



CAUTION: BEFORE ACCESSING THE CONNECTION TERMINALS, ALL ELECTRIC SUPPLY CIRCUITS MUST BE DISCONNECTED.

- Please ensure that the appliance rated power is lower than the power managed by your home installation socket outlet.



WARNING: IF THE POWER CABLE BECOMES VERY HOT, IT MEANS YOUR HOME INSTALLATION IS NOT ABLE TO MANAGE THE APPLIANCE RATED POWER. PUT THE APPLIANCE TO STAND-BY MODE, UNPLUG IT AND CHECK YOUR ELECTRIC INSTALLATION WITH A QUALIFIED ELECTRICIAN BEFORE TO RE-USE THE APPLIANCE.

- If the appliance has a power plug with earthing included or an electric power cord including earthing with yellow / green colour, the fixed electrical installation must also have an earth connection to ensure the minimum protection level.



CAUTION: IN ORDER TO AVOID A HAZARD DUE TO INADVERTENT RESETTING OF THE THERMAL CUT-OUT, THIS APPLIANCE MUST NOT BE SUPPLIED THROUGH AN EXTERNAL SWITCHING DEVICE, SUCH AS A TIMER, OR CONNECTED TO A CIRCUIT THAT IS REGULARLY SWITCHED ON AND OFF BY THE UTILITY.



DANGER: NEVER USE THIS APPLIANCE OUTSIDE.



WARNING: KEEP PACKAGING MATERIALS AND ACCESSORIES OUT OF THE REACH OF CHILDREN. NEVER ALLOW CHILDREN TO PLAY WITH PACKAGING OR ACCESSORIES.

- Children of less than 3 years should be kept away unless continuously supervised.

- Children aged from 3 years and less than 8 years shall only switch on/off the appliance provided that it has been placed or installed in its intended normal operating position and they have been given supervision or instruction concerning use of the appliance in a safe way and understand the hazards involved.
- Children aged from 3 years and less than 8 years shall not plug in, regulate and clean the appliance or perform user maintenance.
- This appliance can be used by children aged from 8 years and above and persons with reduced physical, sensory or mental capabilities or lack of experience and knowledge if they have been given supervision or instruction concerning use of the appliance in a safe way and understand the hazards involved.
- Children shall not play with the appliance.
- Cleaning and user maintenance shall not be made by children without supervision.



WARNING: DO NOT USE THIS HEATER IN SMALL ROOMS WHEN THEY ARE OCCUPIED BY PERSONS NOT CAPABLE OF LEAVING THE ROOM ON THEIR OWN, UNLESS CONSTANT SUPERVISION IS PROVIDED.



CAUTION: SOME PARTS OF THIS PRODUCT CAN BECOME VERY HOT AND CAUSE BURNS. PARTICULAR ATTENTION HAS TO BE GIVEN WHERE CHILDREN AND VULNERABLE PEOPLE ARE PRESENT.

- Do not use this heater if it has been dropped.
- Do not use if there are visible signs of damage to the heater.
- If the supply cord is damaged, it must be replaced by the manufacturer, its service agent or similarly qualified persons in order to avoid a hazard.



CAUTION: ANY PRODUCT INTERVENTION AND / OR REPAIR BY THE USER OR A NON-PROFESSIONAL THIRD PARTY MAY JEOPARDIZE THE SAFETY OF PERSONS AND PROPERTY. SO, DO NOT ATTEMPT TO DISASSEMBLE THIS APPLIANCE, REPAIR IT OR PERFORM ANY MODIFICATIONS BY YOURSELF.



WARNING: DEFECTS AND THEIR CONSEQUENCES RESULTING FROM PRODUCT INTERVENTIONS AND / OR REPAIRS CARRIED OUT BY THE USER OR A NON-PROFESSIONAL THIRD PARTY CANNOT GIVE RISE TO THE APPLICATION OF THE LEGAL OR COMMERCIAL WARRANTY.



CAUTION: THE MANUFACTURER CANNOT BE HELD RESPONSIBLE FOR DAMAGE OCCURRING DURING SELF-REPAIR INSOFAR AS THIS DAMAGE IS LINKED IN PARTICULAR TO USER ERROR OR NON-COMPLIANCE BY THE LATTER WITH THE PRODUCT REPAIR INSTRUCTIONS.

Only for France, United Kingdom & Ireland



WARNING: RISK OF ELECTRIC SHOCK AND FIRE ! THE FOLLOWING OPERATIONS SHALL BE PROCEEDED BY A QUALIFIED PROFESSIONAL ELECTRICIAN IF YOU HAVE NO SUFFICIENT ELECTRICAL KNOWLEDGE.

- The supply cord shall be safely connected to the supply mains terminals with the help of a quick lever electrical connection terminal block (not supplied).



CAUTION: THE USE OF AN ELECTRIC CONNECTION TERMINAL BLOCK TO SCREW (DOMINO) IS NOT CONSIDERED AS A SAFE CONNECTION METHOD ANYMORE.

- These indicative codes and colours have to correspond to the supply mains terminals and wires in your electric supply mains.
- The appliance is equipped with a supply cord including these colours codifications:
 - Blue wire = Neutral = N
 - Brown wire = Live = L
 - Yellow-green wire = Earth = ⊕ or E or PE





DANGER: ALWAYS ENSURE THE CORRESPONDENCE BETWEEN THE APPLIANCE SUPPLY CORD ELECTRIC WIRES AND YOUR ELECTRIC SUPPLY MAINS TERMINALS AND WIRES, COLOURS CODES MAY DIFFER ACCORDING TO COUNTRIES AND THE BUILDING CONSTRUCTION YEAR.

Technical specifications

Model	GD960540WH	GD960540BH
EAN	5059340987163	5059340987132
Finish	White	Black
Electric specifications	220-240 V ~ 50 Hz	
Electric protection class	Class I (Must be connected to a socket with grounding)	
Ingress protection code (IP)	IP24 (Protection against splashing / sprays of waters on the casing)	
Overall dimension (mm)	H 960 x W 540	
Rated power	500 W	
Operating range in °C	0-50 °C	
Manufacturing country	P.R.C.	

	This product complies with conformity requirements of the applicable European Regulations or Directives.
	This product complies with conformity requirements of the applicable UK Regulations.

	<p>This symbol is known as the 'Crossed-out Wheellie Bin Symbol'. When this symbol is marked on a product or battery, it means that it should not be disposed of with your general household waste. Some chemicals contained within electrical / electronic products or batteries can be harmful to health and the environment. Only dispose of electrical/electronic/battery items in separate collection schemes, which cater for the recovery and recycling of materials contained within. Your co-operation is vital to ensure the success of these schemes and for the protection of the environment.</p>
	<p>The appliance power supply current is alternating type.</p>
	<p>Read the instructions</p>

Recycling and disposal

Please respect national and local regulations to reduce the environmental impact of your purchase.

An electric and electronic appliance shall not be sorted or recycled with other household waste.

You are legally responsible for sorting the product (Including any accessories), its instructions(s) and its packaging elements with a view to recycling.

Observe markings on the different packaging materials for waste separation.

There are abbreviations and numbers for the nature of content.

- a: Abbreviations
- b: Numbers: 1 to 7: Plastics / 20 to 22: Papers and fibreboards / 80 to 98: Composite materials

Information on collection points and their opening hours can be obtained from your local authority.

Never leave used products and packaging elements available to children as they represent a danger.

Guarantee

We take special care to select high quality materials and use manufacturing techniques that allow us to create products incorporating design and durability. This product has a manufacturer's guarantee of 2 years against manufacturing defects, from the date of purchase (if bought in store) or date of delivery (if bought online), at no additional cost for normal (non-professional or commercial) household use.

To make a claim under this guarantee, you must present your proof of purchase (such as a sales receipt, purchase invoice or other evidence admissible under applicable law), please keep your proof of purchase in a safe place. For this guarantee to apply, the product you purchased must be new, it will not apply to second hand or display products. Unless stated otherwise by applicable law, any replacement product issued under this guarantee will only be guaranteed until expiry of the original period guarantee period.

This guarantee covers product failures and malfunctions provided the product was used for the purpose for which it is intended and subject to installation, cleaning, care and maintenance in accordance with the information contained in these terms and conditions, in the user manual and standard practice, provided that standard practice does not conflict with the user manual.

This guarantee does not cover defects and damage caused by normal wear and tear or damage that could be the result of improper use, faulty installation or assembly, neglect, accident, misuse, or modification of the product. Unless stated otherwise by applicable law, this guarantee will not cover, in any case, ancillary costs (shipping, movement, costs of uninstalling and reinstalling, labour etc), or direct and indirect damage.

If the product is defective, we will, within a reasonable time, refund.

Rights under this guarantee are enforceable in the country in which you purchased this product. Guarantee related queries should be addressed to the store you purchased this product from.

The guarantee is in addition to and does not affect your statutory rights.

EN Preparation

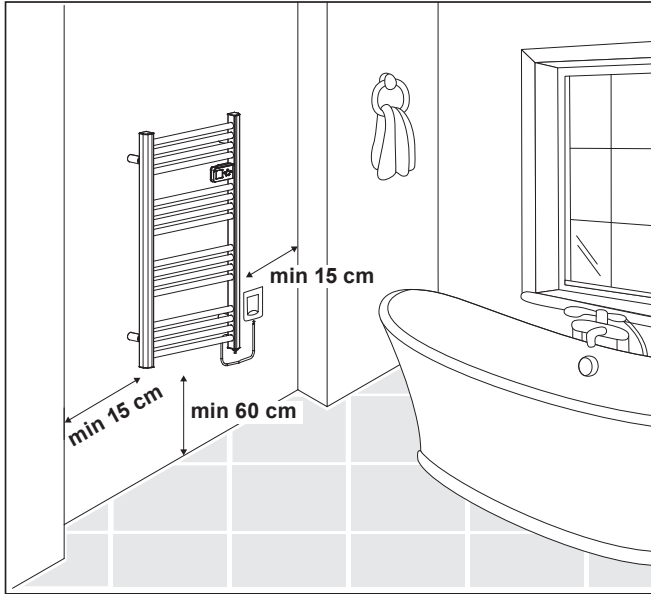

EN Installation

01



01. x1

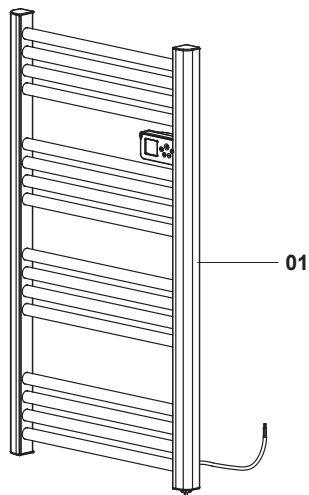

02



06. x4



08. x4
M6 x 20 mm

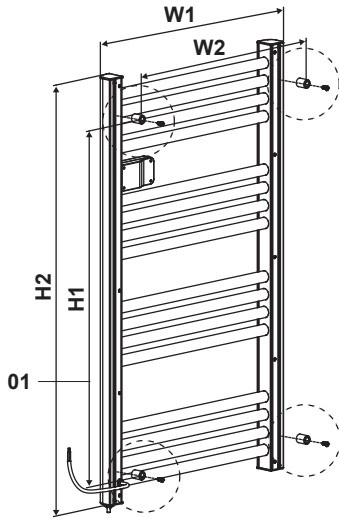

W1 (mm)	W2 (mm)
540	512

H1 (mm)	H2 (mm)
960	830

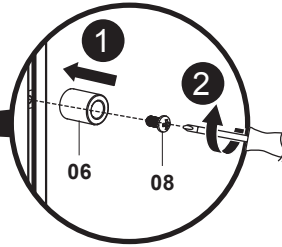

03



02. x4
Ø8 x 64 mm



03. x4
ST4.8 x 60 mm



04. x4



05. x4

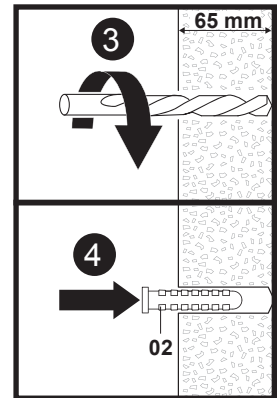
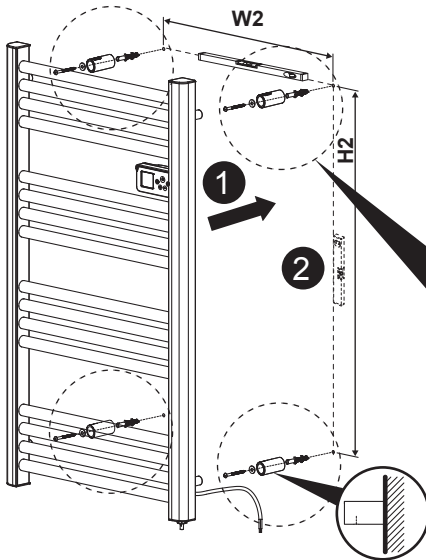

04

07. x4
M5 x 12 mm

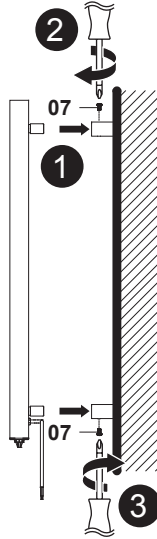

DANGER: Risk of appliance unhooking! The wall mount fasteners (Plastic plugs and metal screws) included with the appliance are only scheduled for an installation on a concrete wall.



WARNING: For wood walls, cinder blocks, plasterboard or other wall types, consult a professional to know what is the best attachment method as the supplied wall mount fasteners will not be suitable.

NOTE: A sheet or equivalent soft textile can be placed under the appliance to avoid scratching or damaging it during assembly.



WARNING: Risk of screws heads damage! The use of an electric screwdriver is not recommended.



CAUTION: Always check the appliance will be correctly installed using a level.

When using the appliance for the first time or after a long period of inactivity, there may be trace of odour during few minutes that will quickly disappear, that's not an abnormal situation.

Installation area in protection volumes



CAUTION: Risk of electric shock! Always check the appliance technical specifications before wall mounting installation and use.

In a bathroom or a water room, different areas depending on the quantity of water or steam present are distinguished.

These areas determine the installation of wall mounted electrical appliances. Volumes are divided between:

- Volume 0: Water receiving area
- Volume 1: Volume 0 + Up to a height of 2.25 m above the ground. For Italian showers: 1.2 m radius length from the showerhead.
- Volume 2: Volume 1 + Add 0 to 60 cm length out of the receiver. No height change. For Italian showers: Add 60 cm to the radius length.
- Out of volume / Volume 3: Length above volume 2. Height above volume 1.

Only for France & Spain:

This appliance shall be fully installed only in out of protection area, scheme: 3 / X

The appliance is not equipped with an electric plug and must not be connected through an electric plug.

Only for Ireland & United Kingdom:

This appliance shall be fully installed only in out of protection area, scheme: 3 / X

The appliance is not equipped with an electric plug and must not be connected through an electric plug for a bathroom installation.

Only for Poland, Portugal, Romania, Spain, Turkey:

This appliance shall be installed only in volume 2 or out of protection area areas, scheme: 2 + 3 / X

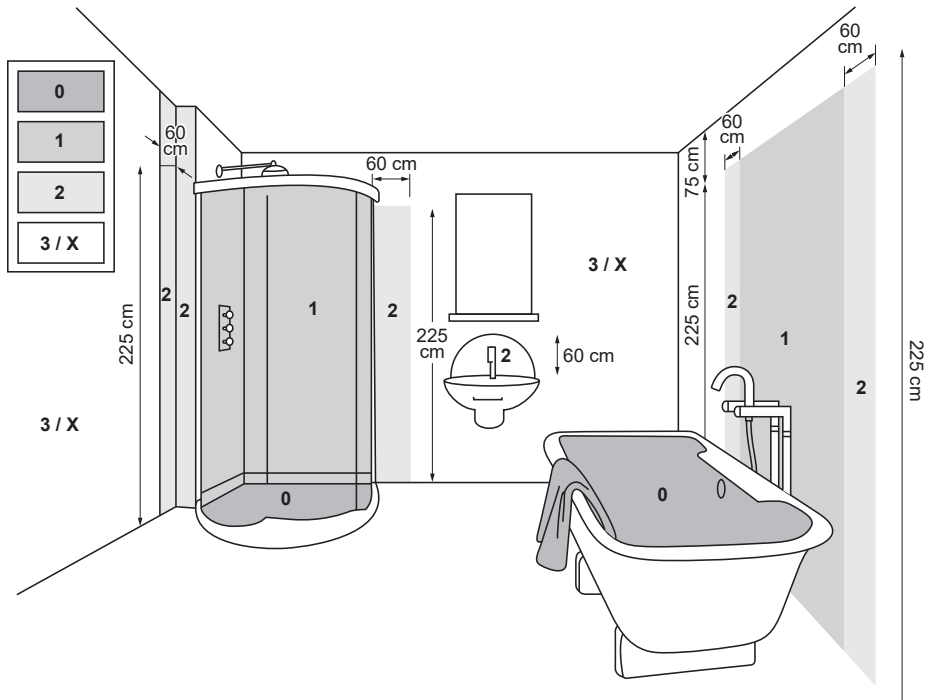

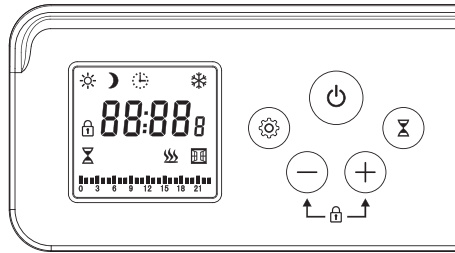

Symbol	Function
	Power button
	Menu
	Boost
	Up
	Down

Symbol	Function
	Comfort mode
	Economy mode
	Programming mode
	Anti-freeze detection
	Child lock
	Boost mode
	Heating
	Open window detection
	Daily program

	<p>On / Stand-by mode</p> <p>Short press: Select on or stand-by mode</p> <p>Press and hold 6 seconds: Reset and restore the appliance to initial factory setting for all settings made and saved. All the display will be highlighted 2 seconds to specify the reset is made.</p> <p>Note: Out of the clock and day, all settings made will be saved even when the appliance is disconnected from the electric mains.</p>
	<p>In stand- by mode:</p> <p>Press and hold 3 seconds: Set the clock and day.</p> <ul style="list-style-type: none"> • Short press or press and hold on or to set the hours from 00 to 23 h, hour by hour. • When the hours are correct, press on the key to access to minutes setting. • Short press or press and hold on or to set the minutes from 00 to 59 mins, minutes by minute. When the minutes are correct, press on the key to access to the weekday setting. • Short press or press and hold on or to set the weekday from 1 (Monday) to 7 (Sunday), day by day. When the day is correct, press on the key to validate and return back to stand-by mode.

The default clock and day are 12:00, Monday noon.

In on mode:

Short press: Change the heating modes or access to the 24/7 programming mode.

- Comfort mode, icon ☀️: Short press or press and hold on (+) or (-) to set the room temperature from 07 to 30 °C, 0,5 °C by 0,5 °C. Default temperature is 19 °C.
- Eco mode, icon 🌙: Short press or press and hold on (+) or (-) to set the room temperature from 07 to 30 °C. Default temperature is 15 °C. The Eco mode temperature cannot overreach the comfort temperature.
- Anti-freeze mode, icon ❄️: No setting possible. Default temperature is 07 °C

When the room temperature is 2 °C lower than the temperature set, the appliance start to heat, icon 🔥. The appliance surface temperature will not exceed 75 °C (without coverage) for safety.

- 24/7 programming mode, icon ⌚ + time slots 📅: 24/7 programming proposals are:

1. Use the factory preset 24/7 manual programming.

There are 6 x factory preset programs as below table. Default programs run P1 from Monday to Friday and P2 from Saturday to Sunday.

Program	P1		P2		P3		P4		P5		P6	
Use type	Week morning		Weekend morning		Week evening		Weekend evening		Week day		Weekend day	
Time	C	E	C	E	C	E	C	E	C	E	C	E
00:00												
01:00												
02:00												
03:00												
04:00												
05:00												
06:00												
07:00												
08:00												
09:00												
10:00												
11:00												
12:00												
13:00												
14:00												
15:00												
16:00												
17:00												
18:00												
19:00												
20:00												
21:00												
22:00												
23:00												

If no action is made, the appliance launch the 24/7 programming with factory preset programs.

The Comfort ☀️ and Eco 🌙 room temperatures are alternatively used in the 24/7 programming.

Always ensure Comfort and Eco temperatures are correct according to your preference prior to use the 24/7 programming.

2. Personalise the factory 24/7 manual programming preset.

Set the week day program:

- Press and hold ⏸️ 3 seconds to select each program for each weekday from monday to sunday. P1 is flashing with 1 for Program No 1 and day No 1 (Monday), short press ⏩ or ⏪ to scroll each program from P1 to P6 dedicated to Monday.
- Short press ⏸️ to confirm the program for Monday and set program for day No 2 (Tuesday).

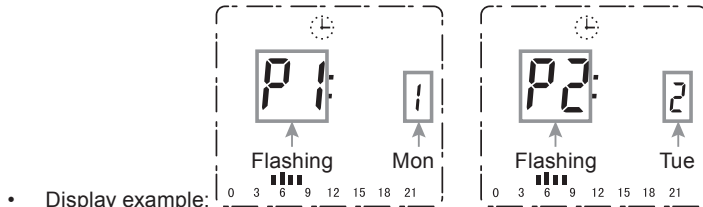

• Display example:

Modify programs:



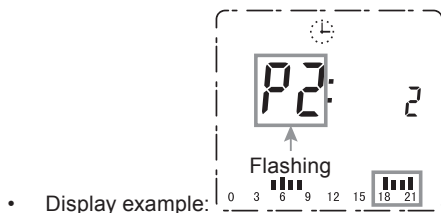



- Instead of a short press on ⏸️ as specified previously, press and hold ⏸️ 3 seconds on the program when flashing on the display.
- The Comfort or Eco modes can be selected for each hour of the day.
- The setting start at 0 for 00:00 to 01:00 hour slot and can be made until 23 for 23:00 to 24:00 hour slot:



• Display example:

- Press on ⏩ to select Comfort temperature heating mode ☀️ for the dedicated hour slot. = The hour slot █ is displayed = Comfort
- Note: For 0, 3, 6, 9, 12, 15, 18 and 21 the icon will be bigger to help you to check easier the full day setting
- OR
- Press on ⏪ to select Eco temperature heating mode 🌙 for the dedicated hour slot. = No hour slot is displayed = Eco
- When all hour slots are completed with the correct heating mode, press ⏸️ to change the program/day selected.
- Another day can be selected still by pressing and holding ⏸️ 3 seconds on the program selection menu.
- When settings are done for the last day of the week, sunday, the menu will return back to the 24/7 weekly programming and launch the 24/7 weekly programming.

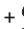

In stand-by or on mode:

- Short press  to activate the timer mode. The default timer time is 00:30 hour.
- Short press or press and hold  or  to set the timer time from 00:00 to 24:00, settings possibilities every 15 mins. In this mode, the thermostat temperature is automatically set at 30 °C. Do not touch any key during 3 seconds to validate and launch the time selected.
- The icons  +  are visible on the display, icon  is only visible when the heating is active and the countdown is launched min by min until the end. At the end of the countdown, the appliance auto returns to stand-by mode.





- Display example:

In stand-by mode:

- Press and hold  3 seconds to activate the delay start mode. The default delay start time is 08:00 hour.
- Short press or press and hold  or  to set the delay start time from 00:00 to 24:00, settings possibilities every 30 mins. In this mode, the thermostat temperature is automatically set at 30 °C. Do not touch any key during 3 seconds to validate and launch the time selected.

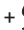







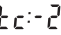

IMPORTANT: The last timer mode time set will automatically start after the delay start countdown (00:30 hour by default). The thermostat temperature is automatically set at 30 °C. At the end of this second countdown, the appliance auto returns to stand-by mode.

- The icons  +  are visible on the display but the icon  is only visible when the heating is active in the auto timer mode.
- Delay start countdown is launched min by min until the end. At the end of this first countdown, the second countdown for the auto timer mode is launched also min by min until the end, then the appliance auto returns to stand-by mode.



- Display example:



<p style="text-align: center;">+</p>	<p>In stand- by mode:</p> <p>Press and hold 3 seconds: Access to the temperature compensation setting</p> <p>Short press or press and hold on  or  to adjust the temperature compensation from -8 to 8 °C. Setting °C by °C. The default temperature compensation is -2 °C.</p> <p>Then temperature compensation setting is useful to calibrate the appliance according to your room if you notice the appliance temperature set in the different heating modes is not coherent compared to the real room temperature.</p> <p>Display example: </p> <p>Press any other touch keys to exit the temperature compensation setting</p> <p>In on mode:</p> <p>Short press: Increase settings (time, temperature, select Comfort mode in 24/7 manual weekly programming)</p> <p>Press and hold 3 seconds: Fast scrolling</p>
<p style="text-align: center;">-</p>	<p>In stand- by mode:</p> <p>Press and hold  for 3 seconds to set the open window detection mode between: "oF" (Off) by default, "60" (Period of 60 mins) or "90" (Period of 90 mins).</p> <p>Short press  or  to change the setting. Example with "60" (Period of 60 mins), screen will show as below. Do not touch any key during 3 seconds to validate and launch the mode selected.</p> <div style="text-align: center; border: 1px dashed black; padding: 10px; width: fit-content; margin: 10px auto;">  </div> <p>Display example: </p> <p>When the mode is active for 60 or 90 mins, if the ambient temperature drops 5 °C within 5 minutes, meaning a window is open, heating stops and the appliance switches to anti-freeze mode at 7 °C during the period selected, then the appliance returns back to the previous heating mode. Each time the temperature drops 5 °C within 5 minutes, the open window detection restart the cycle for 60 or 90 mins.</p> <p>The icon  is visible on the display when the open window detection mode is activated.</p> <p>In on mode:</p> <p>Short press: Decrease settings (time, temperature, select Comfort mode in 24/7 manual weekly programming)</p> <p>Press and hold 3 seconds: Fast scrolling</p>
<p style="text-align: center;">+ + -</p>	<p>In stand- by and on mode:</p> <p>Press and hold 3 seconds: Activate / Deactivate the control panel locking (Child lock) function.</p> <p>When activated, the control panel will be locked out of on / stand-by touch key for safety reason.</p> <p>The icon  is visible when the control panel locking (Child lock) is activated.</p>

Information requirements for electric local space heaters

Model identifier(s)	GDFL500-03B / GDFL500-03W		
<i>Item</i>	<i>Symbol</i>	<i>Value</i>	<i>Unit</i>
Heat output			
Nominal heat output	P_{nom}	0.300	kW
Minimum heat output (indicative)	P_{min}	N.A.	kW
Maximum continuous heat output	$P_{max, c}$	0.300	kW
Auxiliary electricity consumption			
At nominal heat output	el_{max}	/	kW
At minimum heat output	el_{min}	/	kW
In standby mode	el_{SB}	/	kW
<i>Item</i>	<i>Unit</i>		
Type of heat input, for electric storage local space heaters only			
Manual heat charge control, with integrated thermostat	/		
Manual heat charge control with room and/or outdoor temperature feedback	/		
Electronic heat charge control with room and/or outdoor temperature feedback	/		
Fan assisted heat output	/		
Type of heat output/room temperature control			
Single stage heat output and no room temperature control	□		
Two or more manual stages, no room temperature control	□		
With mechanic thermostat room temperature control	□		
With electronic room temperature control	□		
Electronic room temperature control plus day timer	□		
Electronic room temperature control plus week timer	■		
Other control options			
Room temperature control, with presence detection	□		
Room temperature control, with open window detection	■		
With distance control option	□		
With adaptive start control	□		
With working time limitation	■		
With black bulb sensor	□		
Contact details	<p>Kingfisher International Products Limited, 1 Paddington Square, London, W2 1GG, United Kingdom</p> <p>Kingfisher International Products B.V., Rapenburgerstraat 175E, 1011 VM Amsterdam, The Netherlands</p> <p>www.kingfisher.com/products</p>		

■: Yes / □: No

Troubleshooting

Operation of your appliance can lead to errors and malfunctions. The following tables contain possible causes and tips to resolve them. Please consult this table before to contact after sales service.

Trouble	Possible causes	Solution
The appliance is not powered on.	The appliance is not correctly connected to the electric mains.	Connect the appliance to the electric mains including a earth connection.
		Check the connection is firmly made.
	Check the power cord is not trapped, bended, crushed, pinched or damaged.	
	Overheat protection has been triggered.	An overheat safety is included inside the appliance. Ensure installation and use are correctly respected, then disconnect the appliance, let it cool down at least half of an hour before to connect it again.
The appliance suddenly stops during heating.	The appliance stops heating after reaching the heating temperature set.	No abnormal situation. If the heating stops too frequently according to your heating needs, set the temperature thermostat higher.

Error codes

Error code	Meaning	Solution
Er1	The ambient temperature sensor is in open circuit voltage.	The ambient temperature sensor is out of order and need to be replaced, please check after sales service chapter.
	The ambient temperature sensor is in short circuit.	
Er2	The rail temperature is in open circuit voltage.	The rail temperature sensor is out of order and need to be replaced, please check after sales service chapter.
	The rail temperature sensor is in short circuit.	

EN Care & maintenance

- Any intervention linked to the appliance cleaning, servicing or maintenance must be carried out with the appliance disconnected from the electric mains and cool down.
- Clean regularly the appliance, every quarter maximum, with a soft non-abrasive dust cloth microfiber type.
- If stains are visible, the cloth can be slightly humidified.
- Do not put the appliance in contact with water and do not wash it.



WARNING: Never use abrasive or corrosive detergent, chemical agents or solvents as they could damage the materials and coatings, especially plastic parts.

- Do not use a steam cleaner when cleaning the appliance.

Manufacturer:

UK Manufacturer:

Kingfisher International Products Limited,
1 Paddington Square, London, W2 1GG,
United Kingdom

EU Manufacturer:

Kingfisher International Products B.V.,
Rapenburgerstraat 175E,
1011 VM Amsterdam,
The Netherlands

EN www.diy.com

www.screwfix.com

www.screwfix.ie

**To view instruction manuals online,
visit www.kingfisher.com/products**