

EN Electric lawn mower
1200 W, 32 cm

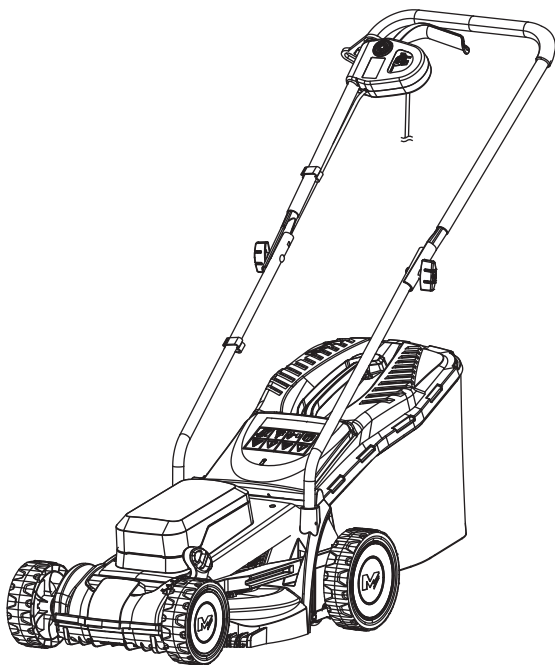

EN ORIGINAL INSTRUCTIONS

IMPORTANT - These instructions are for your safety.
Please read through them thoroughly prior to handling
the product and retain them for future reference.



V11024_5063022567604_MAND2_2324

MCB1136LWM
5063022567604
MCB1137LWM
5063022567635

EN Parts

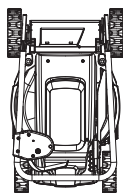

01. x1

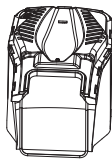

02. x1



03. x1



04. x2



05 . x2



06 . x2



07 . x2

EN You will need



EN Contents

EN	
Product description	3
Safety	4
Guarantee	17
Preparation	18
Assembly	19
Functions & Settings	23
Use	26
Care and maintenance	29
Declaration of conformity	34

EN Product description

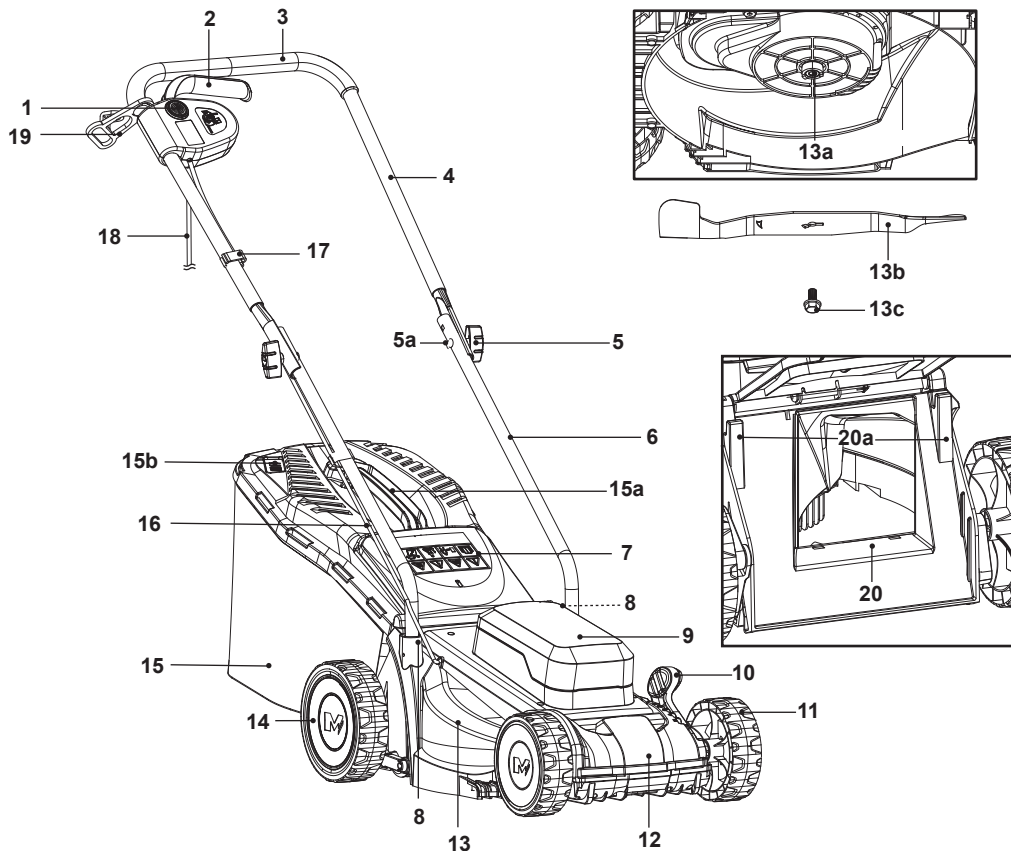

- | | | |
|-------------------------|---|--------------------------|
| 1. Safety switch button | 9. Motor housing | 15. Grass catcher |
| 2. Start lever | 10. Lever for cutting height adjustment | a. Carry handle |
| 3. Grip handle | 11. Front wheel (x2) | b. Hatch |
| 4. Upper handle bar | 12. Front transport handle | c. Rubber clip* (x3) |
| 5. Lock knob (x2) | 13. Cutting blade compartment | d. Supporting rod* |
| a. Mounting bolt* | a. Blade holder | e. Catcher hook* (x2) |
| 6. Lower handle bar | b. Cutting blade | 16. Control cord |
| 7. Rear deflector guard | c. Hex bolt with washer | 17. Cord clip (x2) |
| 8. Handle support (x2) | 14. Rear wheel (x2) | 18. Power cord with plug |
| a. Screw* | | 19. Cord retainer |
| | | 20. Rear discharge chute |
| | | a. Slot (x2) |



NOTE: Parts marked with * are not shown in this overview. Please refer to the respective part in the instruction manual.



General Machine Safety Warnings



WARNING! READ ALL SAFETY WARNINGS, INSTRUCTIONS, ILLUSTRATIONS AND SPECIFICATIONS PROVIDED WITH THIS MACHINE. FAILURE TO FOLLOW ALL INSTRUCTIONS LISTED BELOW MAY RESULT IN ELECTRIC SHOCK, FIRE AND/OR SERIOUS INJURY.

SAVE ALL WARNINGS AND INSTRUCTIONS FOR FUTURE REFERENCE.

THE TERM “MACHINE” IN THE WARNINGS REFERS TO YOUR MAINS-OPERATED (CORDED) MACHINE OR BATTERY-OPERATED (CORDLESS) MACHINE.

Work area safety

- **Keep work area clean and well lit.** Cluttered or dark areas invite accidents.
- **Do not operate machines in explosive atmospheres, such as in the presence of flammable liquids, gases or dust.** Machines create sparks which may ignite the dust or fumes.
- **Keep children and bystanders away while operating a machine.** Distractions can cause you to lose control.

Electrical safety

- **Machine plugs must match the outlet. Never modify the plug in any way. Do not use any adapter plugs with earthed (grounded) machines.** Unmodified plugs and matching outlets will reduce risk of electric shock.
- **Avoid body contact with earthed or grounded surfaces, such as pipes, radiators, ranges and refrigerators.** There is an increased risk of electric shock if your body is earthed or grounded.

- **Do not operate the lawnmower in rain or wet conditions.** This may increase the risk of electric shock.
- **Do not abuse the cord. Never use the cord for carrying, pulling or unplugging the machine. Keep cord away from heat, oil, sharp edges or moving parts.** Damaged or entangled cords increase the risk of electric shock.
- **When operating a machine outdoors, use an extension cord suitable for outdoor use.** Use of a cord suitable for outdoor use reduces the risk of electric shock.
- **If operating a machine in a damp location is unavoidable, use a residual current device (RCD) protected supply.** Use of an RCD reduces the risk of electric shock.

Personal safety

- **Stay alert, watch what you are doing and use common sense when operating a machine. Do not use a machine while you are tired or under the influence of drugs, alcohol or medication.** A moment of inattention while operating machines may result in serious personal injury.
- **Use personal protective equipment. Always wear eye protection.** Protective equipment such as dust mask, non-skid safety shoes, hard hat, or hearing protection used for appropriate conditions will reduce personal injuries.
- **Prevent unintentional starting. Ensure the switch is in the off-position before connecting to power source and/or battery pack, picking up or carrying the machine.** Carrying machines with your finger on the switch or energising machines that have the switch on invites accidents.
- **Remove any adjusting key or wrench before turning the machine on.** A wrench or a key left attached to a rotating part of the machine may result in personal injury.
- **Do not overreach. Keep proper footing and balance at all times.** This enables better control of the machine in unexpected situations.
- **Dress properly. Do not wear loose clothing or jewellery. Keep your hair and clothing away from moving parts.** Loose clothes, jewellery or long hair can be caught in moving parts.

- **If devices are provided for the connection of dust extraction and collection facilities, ensure these are connected and properly used.** Use of dust collection can reduce dust-related hazards.
- **Do not let familiarity gained from frequent use of machines allow you to become complacent and ignore machine safety principles.** A careless action can cause severe injury within a fraction of a second.

Machine use and care

- **Do not force the machine. Use the correct machine for your application.** The correct machine will do the job better and safer at the rate for which it was designed.
- **Do not use the machine if the switch does not turn it on and off.** Any machine that cannot be controlled with the switch is dangerous and must be repaired.
- **Disconnect the plug from the power source and/or remove the battery pack, if detachable, from the machine before making any adjustments, changing accessories, or storing machines.** Such preventive safety measures reduce the risk of starting the machine accidentally.
- **Store idle machines out of the reach of children and do not allow persons unfamiliar with the machine or these instructions to operate the machine.** Machines are dangerous in the hands of untrained users.
- **Maintain machines and accessories. Check for misalignment or binding of moving parts, breakage of parts and any other condition that may affect the machine's operation. If damaged, have the machine repaired before use.** Many accidents are caused by poorly maintained machines.
- **Keep cutting machines sharp and clean.** Properly maintained cutting machines with sharp cutting edges are less likely to bind and are easier to control.

- **Use the machine, accessories and machine bits etc. in accordance with these instructions, taking into account the working conditions and the work to be performed.** Use of the machine for operations different from those intended could result in a hazardous situation.
- **Keep handles and grasping surfaces dry, clean and free from oil and grease.** Slippery handles and grasping surfaces do not allow for safe handling and control of the machine in unexpected situations.

Service

- **Have your machine serviced by a qualified repair person using only identical replacement parts.** This will ensure that safety of the machine is maintained.

Lawnmower Safety Warnings

- **Do not use the lawnmower in bad weather conditions, especially when there is a risk of lightning.** This decreases the risk of being struck by lightning.
- **Thoroughly inspect the area for wildlife where the lawnmower is to be used.** Wildlife may be injured by the lawnmower during operation.
- **Thoroughly inspect the area where the lawnmower is to be used and remove all stones, sticks, wires, bones, and other foreign objects.** Thrown objects can cause personal injury.
- **Before using the lawnmower, always visually inspect to see that the blade and the blade assembly are not worn or damaged.** Worn or damaged parts increase the risk of injury.
- **Before use, check the supply cord and any extension cord for signs of damage or aging. Do not use the lawnmower if the cord is damaged or worn. If the cord is damaged or worn during use, switch off the lawnmower and do not touch the cord before disconnecting it from the supply.** A damaged supply cord or extension cord may result in electric shock, fire and/or serious injury.

- **Check the grass catcher frequently for wear or deterioration.** A worn or damaged grass catcher may increase the risk of personal injury.
- **Keep guards in place. Guards must be in working order and be properly mounted.** A guard that is loose, damaged, or is not functioning correctly may result in personal injury.
- **Keep all cooling air inlets clear of debris.** Blocked air inlets and debris may result in overheating or risk of fire.
- **While operating the lawnmower, always wear non-slip and protective footwear. Do not operate the lawnmower when barefoot or wearing open sandals.** This reduces the chance of injury to the feet from contact with the moving blade.
- **While operating the lawnmower, always wear long trousers.** Exposed skin increases the likelihood of injury from thrown objects.
- **Do not operate the lawnmower in wet grass.** Walk, never run. This reduces the risk of slipping and falling which may result in personal injury.
- **Do not operate the lawnmower on excessively steep slopes.** This reduces the risk of loss of control, slipping and falling which may result in personal injury.
- **When working on slopes, always be sure of your footing, always work across the face of slopes, never up or down and exercise extreme caution when changing direction.** This reduces the risk of loss of control, slipping and falling which may result in personal injury.
- **Use extreme caution when reversing or pulling the lawnmower towards you. Always be aware of your surroundings.** This reduces the risk of tripping during operation.
- **Keep the supply cord away from the cutting blades.** A damaged supply cord may result in electric shock, fire and/or serious injury.
- **Switch off and remove plug from mains if the cord is entangled or damaged.** Entangled or damaged cords can increase the risk of electric shock.

- **Do not touch blades and other hazardous moving parts while they are still in motion.** This reduces the risk of injury from moving parts.
- **When clearing jammed material or cleaning the lawnmower, make sure all power switches are off and the battery pack is disconnected.** Unexpected operation of the lawnmower may result in serious personal injury.

Additional safety instructions for lawn mower Training

- Read the instructions carefully. Be familiar with the controls and the proper use of the product.
- Never allow children, persons with reduced physical, sensory or mental capabilities or lack of experience and knowledge or people unfamiliar with these instructions to use the product. Local regulations may restrict the age of the operator.
- Children should be supervised to ensure that they do not play with the product.
- Cleaning and user maintenance shall not be made by children without supervision.
- Never mow while people, especially children, or pets are nearby.
- Keep in mind that the operator or user is responsible for accidents or hazards occurring to other people or their property.

Preparation

- The product should be supplied via a residual current device (RCD) with a tripping current of not more than 30 mA.
- Before use check the supply and extension cord for signs of damage or aging. If the cord becomes damaged during use, disconnect the cord from the supply immediately. **DO NOT TOUCH THE CORD BEFORE DISCONNECTING THE SUPPLY.** Do not use the product if the cord is damaged or worn.
- While mowing, always wear substantial footwear and long trousers. Do not operate the product when barefoot or wearing open sandals. Avoid wearing clothing that is loose fitting or that has hanging cords or ties.

- Thoroughly inspect the area where the product is to be used and remove all objects which can be thrown by the product.
- Before using, always visually inspect to see that the cutting blade, cutting blade bolts and cutting blade assembly are not worn or damaged. Replace worn or damaged cutting blades and bolts in sets to preserve balance. Replace damaged or unreadable labels.
- **CAUTION!** Do not touch a rotating cutting blade.

Operation

- Keep supply and extension cords away from cutting means.
- Operate the product only in daylight or in good artificial light.
- Avoid operating the product in wet grass, where feasible.
- Always be sure of your footing on slopes.
- Walk, never run.
- Mow across the face of slopes, never up and down.
- Exercise extreme caution when changing direction on slopes.
- Do not mow excessively steep slopes.
- Use extreme caution when reversing or pulling the product towards you.
- Stop the cutting blade(s) if the product has to be tilted for transportation when crossing surfaces other than grass, and when transporting the product to and from the area to be mowed.
- Never operate the product with defective guards or shields, or without safety devices, for example deflectors and/or grass catchers, in place.
- Start the product or switch on the product carefully according to instructions and with feet well away from the cutting blade(s).
- Do not tilt the product when switching on the motor, except if the product has to be tilted for starting. In this case, do not tilt it more than absolutely necessary and lift only the part, which is away from the operator.
- Do not start the product when standing in front of the discharge chute.
- Do not put hands or feet near or under rotating parts. Keep clear of the discharge opening at all times.

- Do not transport the product while the product is running.
- Stop the product. Make sure that all moving parts have come to a complete stop:
 - whenever you leave the product,
 - before clearing blockages or unclogging chute,
 - before checking, cleaning or working on the product,
 - after striking a foreign object. Inspect the product for damage and make repairs before restarting and operating the product.
- If the product starts to vibrate abnormally (check immediately)
 - inspect for damage,
 - replace or repair any damaged parts,
 - check for and tighten any loose parts.

Maintenance and storage

- Improper maintenance will lead to malfunction/failure of the product.
- Inspect and maintain the product regularly. Keep all nuts, bolts and screws tight to be sure the product is in safe working condition.
- Check the grass catcher frequently for wear or deterioration.
- Be careful during adjustment of the product to prevent entrapment of the fingers between moving blades and fixed parts of the product.
- Always allow the product to cool down before storing in any enclosure.
- When servicing the blades be aware that, even though the power source is switched off, the blades can still be moved.
- Replace worn or damaged parts for safety. Use only genuine replacement parts and accessories.
- Wear strong work gloves when removing and re-assembling the cutting blade.
- Have the product repaired only by an authorised service centre or similar qualified specialist.
- When not in use, store the product out of the reach of children.

- If the replacement of the supply cord is necessary, this has to be done by the manufacturer or his agent in order to avoid a safety hazard.

Health surveillance

All employees should be part of an employer's health surveillance scheme to help identify any vibration related diseases at an early stage, prevent disease progression and help employees stay in work.

Vibration and noise reduction

To reduce the impact of noise and vibration emission, limit the time of operation, use low-vibration and low-noise operating modes as well as wear personal protective equipment.

Take the following points into account to minimise the vibration and noise exposure risks:

- Only use the product as intended by its design and these instructions.
- Ensure that the product is in good condition and well maintained.
- Use correct attachments for the product and ensure they are in good condition.
- Keep tight grip on the handles/grip surface.
- Maintain this product in accordance with these instructions and keep it well lubricated (where appropriate).
- Plan your work schedule to spread any high vibration machine use across a longer period of time.
- Prolonged use of the product exposes the user to vibrations that can cause a range of conditions collectively known as hand-arm vibration syndrome (HAVS) e.g. fingers going white; as well as specific diseases such as carpal tunnel syndrome. To reduce this risk when using the product, always wear protective gloves and keep your hands warm.

Emergency

Familiarise yourself with the use of this product by means of this instruction manual. Memorise the safety directions and follow them to the letter. This will help to prevent risks and hazards.

- **Always be alert when using this product, so that you can recognise and handle risks early.** Fast intervention can prevent serious injury and damage to property.
- **Switch the product off if there are malfunctions.** Have the product checked by a qualified professional and repaired, if necessary, before you operate it again.

RESIDUAL RISKS

Even if you are operating this product in accordance with all the safety requirements, potential risks of injury and damage remain. The following dangers can arise in connection with the structure and design of this product:

- Health defects resulting from vibration emission if the product is being used over long periods of time or not adequately managed and properly maintained.
- Injuries and damage to property due to broken attachments or the sudden impact of hidden objects during use.
- Danger of injury and property damage caused by flying objects or poor machine accessories.



WARNING! THIS PRODUCT PRODUCES AN ELECTROMAGNETIC FIELD DURING OPERATION! THIS FIELD MAY UNDER SOME CIRCUMSTANCES INTERFERE WITH ACTIVE OR PASSIVE MEDICAL IMPLANTS! TO REDUCE THE RISK OF SERIOUS OR FATAL INJURY, WE RECOMMEND PERSONS WITH MEDICAL IMPLANTS TO CONSULT THEIR DOCTOR AND THE MEDICAL IMPLANT MANUFACTURER BEFORE OPERATING THIS PRODUCT!

Symbols

On the product, the rating label and within these instructions you will find among others the following symbols and abbreviations. Familiarise yourself with them to reduce hazards like personal injuries and damage to property.

V ~	Volt, (alternating voltage)	Hz	Hertz
W	Watt	°C	Degree Celsius
n ₀	No-load speed	L	Litre
g	Gram	kg	Kilogram
/min or min ⁻¹	Per minute	mm	Millimetre
cm	Centimeter	m	Metre
dB(A)	Decibel (A-rated)	m/s ²	Metres per seconds squared



Lock / to tighten or secure.



Unlock / to loosen.



Read the instruction manual.



Note / Remark.



Caution / Warning.

yyWxx Manufacturing date code; year of manufacturing (20yy) and week of manufacturing (Wxx).

IPX4 Protection against splashed water from all directions.



Always wear ear protection.



Always wear eye protection.



Wear a dust mask.



Wear protective gloves.



Wear protective, slip-resistant footwear.



Wear tight-fitted protective clothes.



Switch the product off and disconnect it from the power supply before assembly, cleaning, adjustments, maintenance, storage and transportation.



This product is of protection class II. That means it is equipped with enhanced or double insulation.



Do not expose the product to rain or wet conditions (moisture).



Mow across the face of slopes, never up and down.



Inspect the area where the product is to be used and remove all objects which can be thrown by the product. If objects are hidden while operating stop the motor and remove the object.



WARNING – Beware of thrown objects – keep bystanders away!

Objects thrown by the product could hit the user or other bystanders. Always ensure that other people and pets remain at a safe distance from the product when it is in operation. In general, children must not come near the area where the product is.



WARNING – Keep the supply cord away from the blades!



WARNING– Remove plug from mains before maintenance or if cord is damaged!



WARNING – Keep hands and feet away from the blades!

Danger of injury! When cleaning, repairing, or inspecting, make certain the cutting blade and all mowing parts have stopped.



DANGER – Keep hands and feet away!



Cutting blade continues to rotate after the product is switched off. Wait until all machine components have completely stopped before touching the product.



Pay special attention when working on the cutting blade!



Grass catcher is ready for grass collection.



Grass catcher is full, empty it.

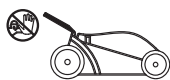

Don't open the rear deflector guard when the motor is running.

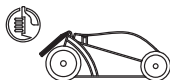

Always keep the rear deflect guard closed when the motor is running.



Guaranteed sound power level value in 96 dB(A).



WEEE symbol. Waste electrical products should not be disposed of with household waste. Please recycle where facilities exist. Check with your Local Authority or local store for recycling advice.



The product complies with the applicable European directives and an evaluation method of conformity for these directives was done.

UK Conformity Assessed.

Rating label explanation

MCB1136LWM, MCB1137LWM = Model number

MC = MAC Allister (brand name)

B = Voltage (230-240 V~)

1136 / 1137 = Sequential Code

LWM = Lawn Mower

Technical specifications

General

> Rated voltage, frequency	: 230-240 V ~, 50 Hz
> Rated power input	: 1200 W
> No load speed	: 3500 min ⁻¹
> Cutting width	: 32 cm
> Cutting height range	: 20 - 60 mm, 5 levels
> Grass catcher volume	: 30 L
> Protection class	: II □
> Degree of protection	: IPX4
> Wheel size	: Ø 140 x 43.5 mm (Front wheel) Ø 165 x 43.5 mm (Rear wheel)
> Weight	: approx. 9.85 kg
> Dimensions	: approx. 118.5 x 38.5 x 98 cm

Sound values

> Sound pressure level L_{pA}	: 83.6 dB(A)
> Uncertainty K_{pA}	: 3 dB(A)
> Measured sound power level L_{WA}	: 92.3 dB(A)
> Uncertainty K_{WA}	: 1.1 dB(A)
> Guaranteed sound power level L_{WA} acc. to 2000/14/EC amended by 2005/88/EC	: 96 dB(A)

Vibration values

> Hand arm vibration $a_{h,w}$	
Left handle	: 1.874 m/s ²
Right handle	: 1.895 m/s ²
> Uncertainty K	: 1.5 m/s ²

The sound value(s) have been determined according to noise test code given in EN 62841-1, EN IEC 62841-4-3, using the basic standards ISO 11094 and EN ISO 3744.

The sound intensity level for the operator may exceed 80 dB(A) and ear protection measures are necessary.

The declared vibration total values and the declared noise emission values have been measured in accordance with a standard test method (EN 62841-1, EN IEC 62841-4-3) and may be used for comparing one machine with another; they may also be used in a preliminary assessment of exposure.



WARNING! THE VIBRATION AND NOISE EMISSION DURING ACTUAL USE OF THE MACHINE CAN DIFFER FROM THE DECLARED TOTAL VALUE DEPENDING ON THE WAYS IN WHICH THE MACHINE IS USED ESPECIALLY WHAT KIND OF WORKPIECE IS PROCESSED.

THE NEED TO IDENTIFY SAFETY MEASURES TO PROTECT THE OPERATOR THAT ARE BASED ON AN ESTIMATION OF EXPOSURE IN THE ACTUAL CONDITIONS OF USE (TAKING ACCOUNT OF ALL PARTS OF THE OPERATING CYCLE SUCH AS THE TIMES WHEN THE MACHINE IS SWITCHED OFF AND WHEN IT IS RUNNING IDLE IN ADDITION TO THE TRIGGER TIME).

Recycling and disposal



Waste electrical products should not be disposed of with household waste. Please recycle where facilities exist.

Check with your Local Authority or local store for recycling advice.

For further information visit www.recycle-more.co.uk.

The product comes in a package that protects it against damage during shipping. Keep the package until you are sure that all parts have been delivered and the product is working properly. Recycle the package afterwards.

Guarantee

We take special care to select high quality materials and use manufacturing techniques that allow us to create products incorporating design and durability. This product has a manufacturer's guarantee of 2 years against manufacturing defects, from the date of purchase (if bought in store) or date of delivery (if bought online), at no additional cost for normal (non-professional or commercial) household use.

To make a claim under this guarantee, you must present your proof of purchase (such as a sales receipt, purchase invoice or other evidence admissible under applicable law), please keep your proof of purchase in a safe place. For this guarantee to apply, the product you purchased must be new, it will not apply to second hand or display products. Unless stated otherwise by applicable law, any replacement product issued under this guarantee will only be guaranteed until expiry of the original period guarantee period.

This guarantee covers product failures and malfunctions provided the product was used for the purpose for which it is intended and subject to installation, cleaning, care and maintenance in accordance with the information contained in these terms and conditions, in the user manual and standard practice, provided that standard practice does not conflict with the user manual.

This guarantee does not cover defects and damage caused by normal wear and tear or damage that could be the result of improper use, faulty installation or assembly, neglect, accident, misuse, or modification of the product. Unless stated otherwise by applicable law, this guarantee will not cover, in any case, ancillary costs (shipping, movement, costs of uninstalling and reinstalling, labour etc), or direct and indirect damage.

This guarantee does not cover defects and damage caused by or resulting from:

- Normal wear and tear
- Overload, misuse or neglect
- Repairs attempted by anyone other than an authorised agent
- Cosmetic damage
- Damage caused by foreign objects, substances or accidents

- Accidental damage or modification
- Failure to follow manufacturer's guidelines
- Loss of use of the goods

If this product is defective, we will, within a reasonable time, repair, replace, refund, service, or provide spare parts.

Rights under this guarantee are enforceable in the country in which you purchased this product. Guarantee related queries should be addressed to the store you purchased this product from.

The guarantee is in addition to and does not affect your statutory rights.

IMPORTANT - RETAIN THIS INFORMATION FOR FUTURE REFERENCE: READ CAREFULLY

EN Preparation

Unpacking



NOTE: The product is heavy, ask another person for assistance if required.

1. Unpack all parts and lay them on a flat, stable surface.
2. Remove all packing materials and shipping devices if applicable.
3. Make sure the delivery contents are complete and free of any damage. If you find that parts are missing or show damage do not use the machine but contact your dealer. Using an incomplete or damaged machine represents a hazard to people and property.
4. Ensure that you have all the accessories and tools needed for assembly and operation. This also includes suitable personal protective equipment.



WARNING! THE PRODUCT AND THE PACKAGING ARE NOT CHILDREN'S TOYS! CHILDREN MUST NOT PLAY WITH PLASTIC BAGS, SHEETS AND SMALL PARTS! THERE IS A DANGER OF CHOKING AND SUFFOCATION!

You will need

(items not supplied)

Suitable personal protective
Suitable extension cord
Suitable crosshead screwdriver
Suitable wrench
Suitable lubricating oil

(items supplied)

Cutting blade (13b)
Grass catcher (15)



NOTE: The accessories required depend on the intended application. Ask your dealer for advice.



WARNING! THE PRODUCT MUST BE FULLY ASSEMBLED BEFORE OPERATION!



DO NOT USE A PRODUCT THAT IS ONLY PARTLY ASSEMBLED OR ASSEMBLED WITH DAMAGED PARTS!



WEAR PROTECTIVE GLOVES FOR THIS ASSEMBLY WORK AND ALWAYS LAY THE PRODUCT ON A FLAT AND STABLE SURFACE WHILE ASSEMBLING.



FOLLOW THE ASSEMBLY INSTRUCTIONS STEP-BY-STEP AND USE THE PICTURES PROVIDED AS A VISUAL GUIDE TO EASILY ASSEMBLE THE PRODUCT!

BEFORE USING THE PRODUCT, FAMILIARISE YOURSELF WITH THE OPERATING FEATURES READ THE ENTIRE INSTRUCTION MANUAL PAYING PARTICULAR ATTENTION TO THE SAFETY RULES AND OPERATING PROCEDURES.

DO NOT CONNECT THE PRODUCT TO POWER SUPPLY BEFORE IT IS COMPLETELY ASSEMBLED.



NOTE: Take care of small parts that are removed during assembly or when making adjustments. Keep them secure to avoid loss.

If necessary, ask another person for assistance when assembling the product.

Lower handle bar

1. Put the machine on the flat and even ground.
2. Align and insert the bend part of the lower handle bar (6) into the slot of the handle support (8) all the way until stop (Fig. 1, step 1).
3. Align the screw holes of the lower handle bar (6) and the handle support (8), then secure the connections by turning the screw (8a) clockwise (Fig. 1, steps 2, 3).
4. Repeat the above assembly on the other lower handle bar (6).

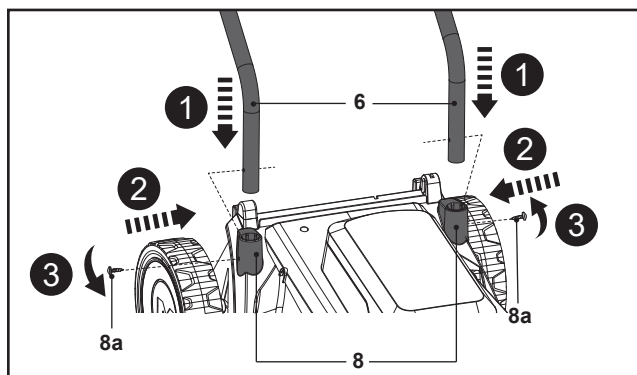

Fig. 1

Upper handle bar

1. Guide the cord retainer (19) onto the upper handle bar (4) and slide it all the way until stop (Fig. 2).
2. Place the cord retainer (19) above the safety switch box (Fig. 3).
3. Hold the upper handle bar (4) with the safety switch button (1) facing upwards. Align the mounting holes of the upper handle bar (4) and the lower handle bars (6).

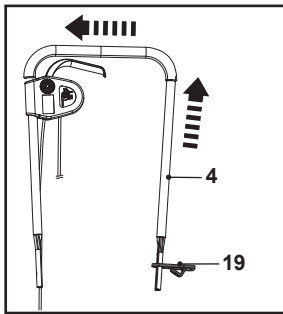

Fig. 2

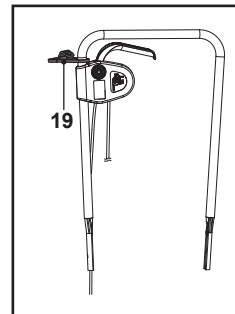

Fig. 3

i NOTE: There are two handle height positions in the lower handle bars (6). Ensure the upper handle bar (4) is assembled on the same height level on both side of lower handle bars (6).

4. Pass the mounting bolt (5a) through the mounting holes to the end (Fig. 4, step 1).
5. Secure the upper handle bar (4) with the lower handle bars (6) by turning the lock knob (5) clockwise on the thread of the mounting bolt (5a) for tightening (Fig. 4, step 2).
6. Make sure the control cord (16) run on the upper side of the upper handle bar (4) and the lower handle bar (6).

! WARNING! MAKE SURE THE TWO LOCK KNOBS (5) ARE PROPERLY SECURED BEFORE USING THE PRODUCT.

7. Attach the control cord (16) with the two cord clips (17) on the right-hand side of the upper handle bar (4) and the lower handle bar (6) (when viewed from operator's position) (Fig. 5).
8. Check the condition of control cord (16) and keep it away from the rear wheel (14).

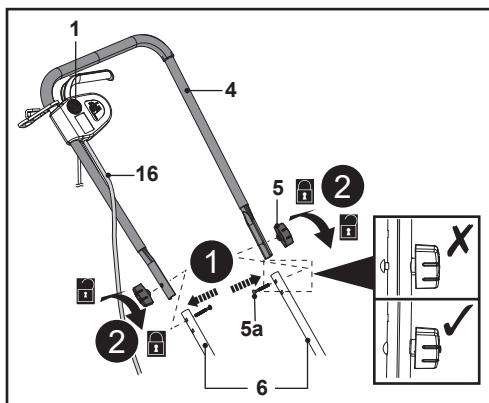

Fig. 4

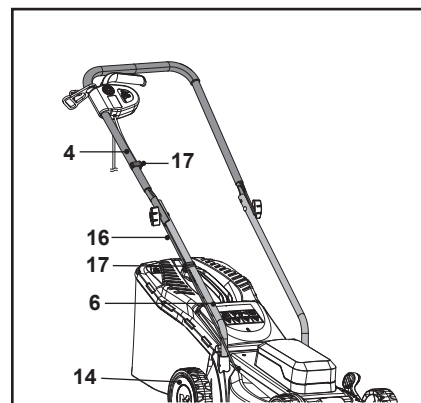

Fig. 5

Grass catcher

1. Insert the carry handle (15a) into the two assembling slots and make sure that the carry handle (15a) is firmly in place (Fig. 6, step 1).
2. Clip the three rubber clips (15c) onto the supporting rod (15d) of the grass catcher (15) (Fig. 6, step 2).
3. The grass catcher (15) is ready for use.

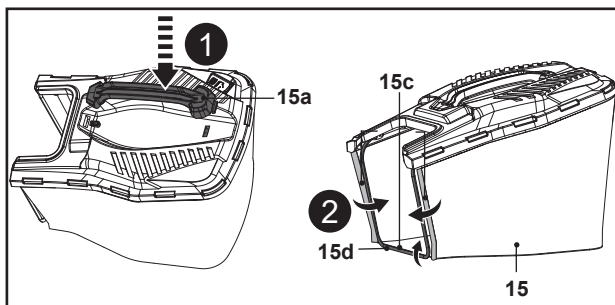

Fig 6

4. Open the rear deflector guard (7) and hold it in position (Fig. 7, step 1).
5. Carry the grass catcher (15) by its carry handle (15a).
6. Align the two catcher hooks (15e) with the slots (20a) and hang the grass catcher (15) onto it (Fig. 7, step 2).
7. Carefully release the rear deflector guard (7) afterward.

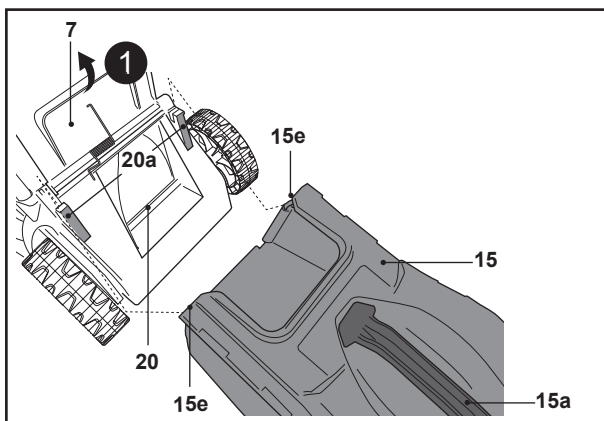

Fig 7



NOTE: Always carry the grass catcher (15) by its carry handle (15a). Before hooking the grass catcher (15), check if the mulching insert is in the rear discharge chute (20). Take away the mulching insert before hooking the grass catcher (15).

Connection to power supply



NOTE: The machine is equipped with a power cord with the length of 10 m. If an additional extension cord is required for operation, observe the technical requirements for this product when purchasing an extension cord.

Always use a residual current supply (RCD, ≤ 30 mA) protected supply.

1. Double the power cord (18) back, about 40 cm from the power guard and lead the loop through the hole of the cord retainer (19) and hang the loop over the loop.
2. Pull the power cord (18) over the cord retainer (19) and gently tug on the power cord (18) to ensure that it is firmly secured (Fig. 8, steps 1, 2).

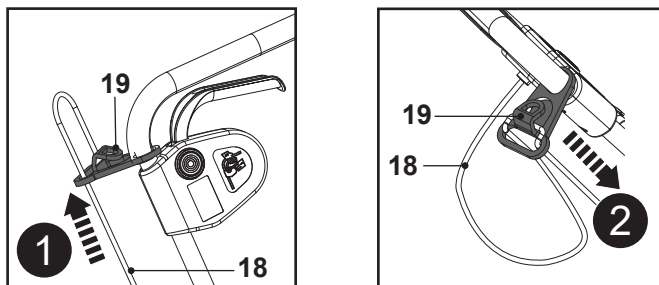

Fig 8

3. Connect the plug of power cord (14) with a suitable socket.



WARNING! CHECK THE VOLTAGE! THE VOLTAGE MUST COMPLY WITH THE INFORMATION ON THE RATING LABEL!

IF USING AN EXTENSION CORD IT MUST BE SUITABLE FOR OUTDOOR USE WITH SOCKETS PROTECTED AGAINST WATER SPLASHING.

ENSURE THE EXTENSION CORD IS OF THE PROPER SIZE AND TYPE FOR YOUR PRODUCT:

- 1.5 mm² for up to 60 m in length.
- 2.5 mm² for up to 100 m in length.

4. Your product is now ready to be used.

Intended use

This electric lawn mower MCB1136LWM / MCB1137LWM is designated with a rated power input of 1200 Watts.

The product is intended for mowing grass in domestic gardens only. It must not be used to mow unusually high, dry or wet grass, e.g. pasture grass, or to shred leaves.

The use of this product in case of rain or humid environment is prohibited.

For safety reasons it is essential to read the entire instruction manual before first operation and to observe all the instructions therein.

This machine is intended for private domestic use only, not for any commercial trade use. It must not be used for any purposes other than those described.

Handle height adjustment



WARNING! SWITCH THE PRODUCT OFF AND DISCONNECT IT FROM THE POWER SUPPLY, WAIT THAT THE CUTTING BLADE (13B) HAS COME TO A COMPLETE STOP BEFORE ADJUSTING THE HANDLE HEIGHT!

Adjust the handle assembly to a suitable height according to your needs. There are two handle heights to choose.

1. Hold the upper handle bar (4) with one hand.
2. Unscrew the lock knob (5) in an anti-clockwise direction, then take off the lock knob (5) and mounting bolt (5a) afterwards (Fig. 9, steps 1, 2).
3. Choose the other mounting hole of the lower hand bar (6) to assemble the upper handle bar (4) for desired handle height (Fig. 9, step 3).
4. Ensure the handle assembly is assembled on the same height level on both sides.
5. Repeat the assembling steps as described in "Assembly-Upper handle bar" to lock the hand bars (4, 6) firmly.

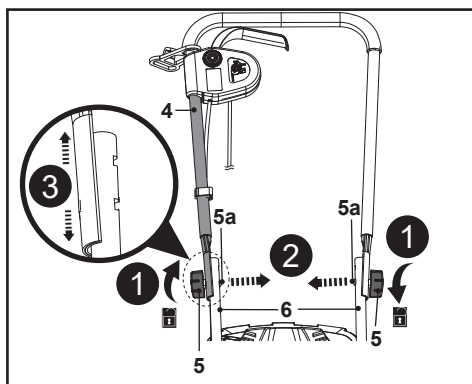

Fig 9

Cutting height adjustment



WARNING! SWITCH THE PRODUCT OFF AND DISCONNECT IT FROM THE POWER SUPPLY, WAIT THAT THE CUTTING BLADE (13B) HAD COME TO A COMPLETE STOP BEFORE ADJUSTING THE CUTTING HEIGHT!



ENSURE THAT THE LEVER ENGAGES BETWEEN TWO OF THE PRONGS!

FOR THE FIRST CUT OF THE SEASON, A SUITABLE CUTTING HEIGHT SHOULD BE CHOSEN. DO NOT CHOOSE A LOW CUTTING HEIGHT IF THE GRASS IS LONG AND GREASY, THE MOTOR MAY NOT BE ABLE TO BOOT PROPERLY.

WHEN STARTING THE MOWER DO AN AUDIT OF THE HEIGHT OF THE GRASS. IF THE GRASS IS TOO TALL, THE MOWER WILL NOT START. IT WILL THEN INCREASE THE CUTTING HEIGHT. THIS FEATURE ALLOWS YOU TO SAVE THE ENGINE AND IMPROVE THE LIFE OF BATTERIES.

Adjust the cutting height according to the needs of your lawn. The cutting height depends on the kind of lawn and its actual height. When mowing high grass, start with the maximum cutting height and make a second cut with a lower cutting height.

1. Pull the lever for cutting height adjustment (10) towards the rear wheel (14) (Fig. 10, step 1).
2. Move the lever (10) forward or backward to adjust the cutting height (Fig. 10, step 2).
3. Release the lever (10) and ensure it engages in the slot properly (Fig. 10, step 3).

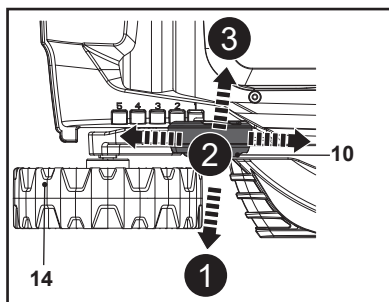

Fig. 10



WARNING! ENSURE THAT THE LEVER (10) ENGAGES IN THE SLOT AFTER EACH ADJUSTMENT.



NOTE: There are 5 cutting height levels available. The adjustable heights are 20 / 30 / 40 / 50 / 60 mm.

Grass catcher



WARNING! DO NOT ATTEMPT TO USE THE PRODUCT WITHOUT THE GRASS CATCHER (15) ATTACHED WHEN COLLECTING GRASS – DANGER OF FLYING OBJECTS!

SWITCH THE PRODUCT OFF AND DISCONNECT IT FROM THE POWER SUPPLY, WAIT THAT THE CUTTING BLADE (13B) HAD COME TO A COMPLETE STOP BEFORE REMOVING THE GRASS CATCHER (15)!

Attach the grass catcher (15). Always carry the grass catcher (15) by its carry handle (15a).

Indicator

The grass catcher (15) is equipped with a hatch (15b) that indicates the filling during operation.

1. When the hatch (15b) is opened the grass catcher (15) has sufficient volume left to collect grass (Fig. 11).
2. When the hatch (15b) is closed, the grass catcher (15) is full and must be emptied (Fig. 12).

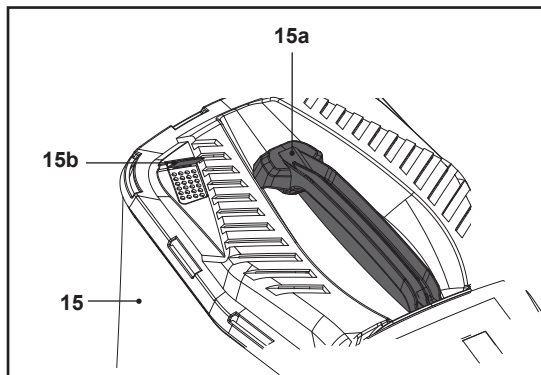

Fig. 11

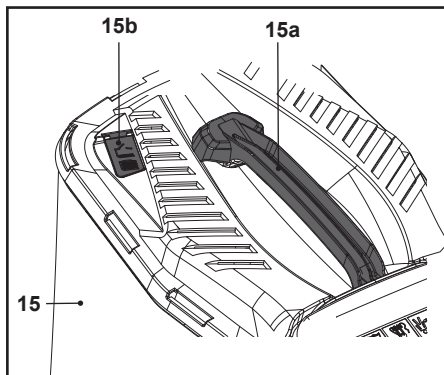

Fig. 12

Emptying

Empty the grass catcher (15) frequently during use. Do not wait until it is completely full. We recommend emptying it when it is half full.



NOTE: full grass catcher (15) will reduce the performance of this product.

1. Switch the product off and disconnect it from the power supply. Make sure that the cutting blade (13b) has stopped rotating.
2. Lift the rear deflector guard (7) and hold it in place.
3. Lift the grass catcher hooks (15e) off the slots (20a) and remove the grass catcher (15).
4. Remove the grass clippings from the rear discharge chute (20) into the grass catcher (15). Use a proper tool such as a brush.
5. Remove the grass catcher (15) by its carry handle (15a).
6. Empty the grass clippings onto a compost heap.
7. Re-fit the grass catcher (15) to the product and ensure the grass catcher hooks (15e) to stay correctly onto the slots (20a) as described in the "Assembly - grass catcher" section.



WARNING! NEVER USE YOUR HANDS OR FEET TO REMOVE GRASS CLIPPINGS FROM THE REAR DISCHARGE CHUTE (20)!

General operation

1. Check the product, its power cord and plug as well as accessories for damage before each use. Do not use the product if it is damaged or shows wear. Take care of any problem you find or have the product checked by qualified specialist.
2. Double check that the accessories and attachments are properly secured.
3. Always push the product using the grip handle (3). Keep the handles dry to ensure safe support.
4. Ensure that the air vents are always unobstructed and clear. Clean them if necessary with a soft brush. Blocked air vents may lead to overheating and damage the product.
5. Switch the product off immediately and disconnect it from the power supply if you are disturbed while working by other people entering the working area. Always let the product come to complete stop before leaving it unattended.
6. Do not overwork yourself. Take regular breaks to ensure you can concentrate on the work and have full control over the product.

Starting/Stopping



WARNING! BEFORE STARTING, PUT THE PRODUCT ON A FLAT SURFACE FREE OF HIGH GRASS! CLEAN THE UNDERSIDE OF THE DECK!



START THE MOTOR CAREFULLY ACCORDING TO INSTRUCTIONS. KEEP YOUR FEET WELL AWAY FROM THE CUTTING BLADE (13B)!

DO NOT TILT THE PRODUCT WHEN STARTING THE MOTOR.

Starting



NOTE: The product can only be started by pressing the safety switch button (1) followed by squeezing the start lever (2). Reverse operation cannot start the product.

1. Stand behind the grip handle (3).
2. While holding the safety switch button (1) pressed (Fig. 13, step 1), pull the start levers (2) towards the grip handle (3) and hold it in position (Fig. 13, step 2).
3. After the lawn mower starts, release the safety switch button (1).
4. The lawn mower is ready for use.

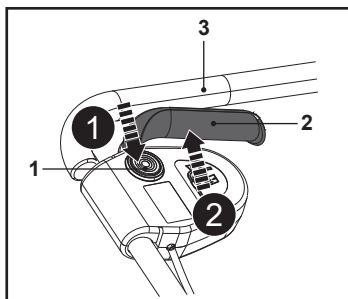

Fig. 13

Stopping

1. Release the start lever (2) to stop the lawn mower (Fig. 14).

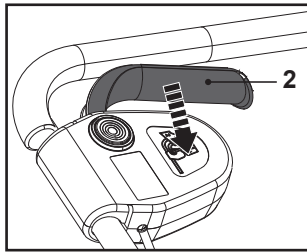

Fig. 14

Mowing

1. Make sure that the lawn is clear of stones, sticks, wire or other objects that could damage the product or its product.
2. Do not cut wet grass because it tends to stick to the underbody of the product, preventing the proper discharge of grass clippings, and it could also cause you to slip and fall.
3. Never cut off more than one-third of the total length of the grass for a healthy lawn. In the autumn, lawns should only be cut as long as there is growth.
4. Slowly push the product forward.
5. Mow in slight overlapping rows. The most effective pattern for mowing lawns is straight lines along one of the sides. This will keep the rows even and ensures that all the lawn is cut without missing any spots (Fig. 15).
6. Circle around flower beds. When reaching a flower bed in the middle of the lawn, cut a row or two around the circumference of the bed.
7. Pay special attention when changing direction.
8. Empty the grass catcher (15) regularly.

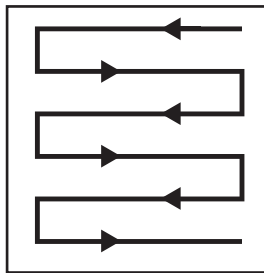

Fig. 15



WARNING! IF THE PRODUCT STRIKES A FOREIGN OBJECT STOP IMMEDIATELY! LET THE PRODUCT COOL DOWN AND THOROUGHLY INSPECT THE PRODUCT FOR DAMAGE! HAVE ANY DAMAGE REPAIRED BEFORE RESTARTING!

EXTENSIVE VIBRATION OF THE PRODUCT DURING OPERATION IS AN INDICATION OF DAMAGE! THE PRODUCT SHOULD BE PROMPTLY INSPECTED AND REPAIRED!

After use

1. Switch the product off, disconnect it from the power supply and let it cool down.
2. Check, clean and store the product as described below.

Troubleshooting

Suspected malfunctions are often due to causes that the users can fix themselves. Therefore check the product using this section. In most cases the problem can be solved quickly.



WARNING! ONLY PERFORM THE STEPS DESCRIBED WITHIN THESE INSTRUCTIONS! ALL FURTHER INSPECTION, MAINTENANCE AND REPAIR WORK MUST BE PERFORMED BY AN AUTHORISED SERVICE CENTRE OR A SIMILARLY QUALIFIED SPECIALIST IF YOU CANNOT SOLVE THE PROBLEM YOURSELF!

Problem	Possible cause	Solution
1. Product does not start	1.1. Not connected to power supply 1.2. Power cord or plug is defective 1.3. Overload protection is activated 1.4. Incorrect methods to start the product 1.5. Other electrical defect to the product	1.1. Connect to power supply 1.2. Check by a specialist electrician 1.3. Refer to section "Overload protection" 1.4. Press the safety switch button and hold it in position, then pull the start lever to start the product 1.5. Check by a specialist electrician
2. Product does not reach full power	2.1. Extension cord not suitable for operation with this product 2.2. Power source (e. g. generator) has too low voltage 2.3. Air vents are blocked	2.1. Use a proper extension cord 2.2. Connect to another power source 2.2. Clean the air vents
3. Unsatisfactory cutting result	3.1. Cutting blade is dull / damaged 3.2. Cutting material exceeds capacity 3.3. Cutting height is incorrect	3.1. Replace with a new one 3.2. Only cut materials according to the product capacity 3.3. Adjust the cutting height
4. Product suddenly stops	4.1. Cutting blade is blocked 4.2. Cutting height is too big	4.1. Remove blockage 4.2. Reduce the cutting height
5. Excessive vibration or noise	5.1. Cutting blade is dull/damaged 5.2. Cutting material exceeds capacity 5.3. Cutting height is incorrect 5.4. Bolts/knobs are loose	5.1. Replace with new one 5.2. Only cut materials according to the product capacity 5.3. Adjust the cutting height 5.4. Tighten the bolts/knobs

The golden rules for care



WARNING! ALWAYS SWITCH THE PRODUCT OFF, DISCONNECT IT FROM THE POWER SUPPLY AND LET THE PRODUCT COOL DOWN BEFORE PERFORMING INSPECTION, MAINTENANCE AND CLEANING WORK!

ONLY PERFORM CARE AND MAINTENANCE WORK ACCORDING TO THESE INSTRUCTIONS! ALL FURTHER WORKS MUST BE PERFORMED BY A QUALIFIED SPECIALIST!

- 1. Keep the product clean. Remove debris from it after each use and before storage.
- 2. Regular and proper cleaning will help ensure safe use and prolong the life of the appliance.
- 3. Inspect the product before each use for worn and damaged parts. Do not operate it if you find broken and worn parts.



WARNING! ONLY PERFORM REPAIRS AND MAINTENANCE WORK ACCORDING TO THESE INSTRUCTIONS! ALL FURTHER WORKS MUST BE PERFORMED BY A QUALIFIED SPECIALIST!

General cleaning

- 1. Clean the product with a damp cloth and pH-neutral soap. Use a brush for areas that are hard to reach.
- 2. In particular clean the air vents after every use with a cloth and brush.
- 3. Remove stubborn dust with high pressure air (max. 3 bar).



NOTE: Do not use chemical, alkaline, abrasive or other aggressive detergents or disinfectants to clean this product as they might be harmful to its surfaces.

- 4. Check for any damage and wear. Repair damages in accordance with this instruction manual or take it to an authorised service centre before using the product again.

Spare parts / Replacement parts

The following parts of this product may be replaced by the consumer. Spare parts are available at an authorized dealer or through our customer service.

Description	Model number / part code
Cutting blade (13b)	CY32

Maintenance

Before and after each use, check the machine and accessories (or attachments) for wear and damage. If required, exchange them for new ones as described in this instruction manual. Observe the technical requirements.

Underbody and cutting blade



WARNING! WEAR SAFETY GLOVES WHEN WORKING ON THE CUTTING BLADE (13B) AND CLOSE TO IT! USE PROPER MACHINES TO REMOVE DEBRIS, E. G. A WOODEN STICK! NEVER USE YOUR BARE HANDS!



ALWAYS USE ORIGINAL SPARE PARTS FOR REPLACEMENT. THE CUTTING BLADE MUST BE REPLACED BY AN IDENTIFICATION NO. CY32. DO NOT ATTACH ANY OTHER TYPE OF CUTTING BLADE!

THE REPLACEMENT OF THE CUTTING BLADE SHOULD BE DONE BY A QUALIFIED SPECIALIST! REWORK OR SHARPENING BLADES IS NOT RECOMMENDED UNLESS IT IS DONE BY A REPAIR SERVICE OR A SIMILARLY QUALIFIED SPECIALIST!

1. Keep the underbody and cutting blade (13b) clean and free of debris. Remove clippings from the rear discharge chute (20).
2. Check all fasteners, such as nuts and bolts, periodically for tightness before operation. After prolonged use, especially in sandy soil conditions, the cutting blade will become worn and lose some of the original shape. The cutting efficiency will be reduced and the cutting blade should be replaced.
3. Keep the cutting blade (13b) sharp to ensure a good cutting performance. Replace a worn or damaged cutting blade with a new one of the same type or have it sharpened by a qualified specialist.
4. Loosen the hex bolt with washer (13c) anti-clockwise using a suitable wrench (Size 13 mm) and remove it together with the cutting blade (13b).
5. Replace the cutting blade (13b) with a new one of the same type. Check the status of blade holder (13a) onto the spindle firstly, then attach the cutting blade (13b) to the blade holder (13a) by aligning it with the patterns on the blade holder (13a), fit the hex bolt with washers (13c) properly to secure the connection. Tighten the hex bolt (13c) clockwise with 25 Nm min, 30 Nm max. to ensure safe operation of your product (Fig. 16).

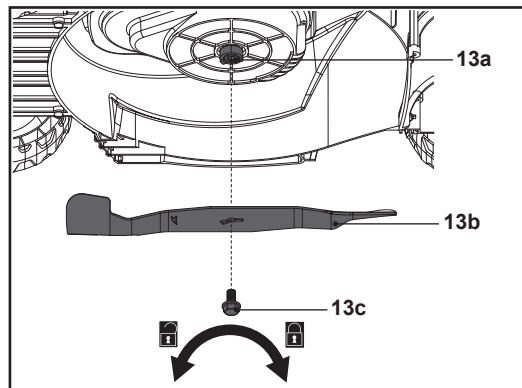

Fig. 16



DANGER! IF THE CUTTING BLADE (13B) ARE NOT TORQUED PROPERLY, THEY COULD BECOME LOOSE AND BE THROWN FROM THE MACHINE AND SERIOUSLY HURT OR KILL THE OPERATOR OR BYSTANDERS.

6. Replace this cutting blade (13b) after 50 hours mowing or 2 years whichever is sooner regardless of condition. If the cutting blade (13b) is cracked or damaged, you must immediately replace it with a new one.
7. Lubricate the cutting blade (13b) after each use to prolong the life span of cutting blade (13b) and product. Apply light machine oil along the edge of the cutting blade (13b).

Grass catcher

1. Inspect the grass catcher (15) before each use. Do not use it if you find any damage.
2. Clean the grass catcher (15) after operation using water and mild soap.
3. Let the grass catcher (15) dry thoroughly before storing to avoid mildew.

Control cord

Check the control cord (16) before each use.



WARNING! DO NOT USE THE PRODUCT WITH A DEFECTIVE OR A LOOSE CONTROL CORD (16)!

Repair

This product does not contain any parts that can be repaired by the consumer. Contact an authorised service centre or a similarly qualified person to have it checked and repaired.

Power cord

If the power cord is damaged, it must be replaced by the manufacturer, its service agent or similarly qualified persons in order to avoid a safety hazard.

UK plug (for UK only)

If you need to replace the fitted plug, then follow the instructions below.

IMPORTANT: The wires in the mains lead are coloured in accordance with the following code:

Blue – Neutral

Brown – Live

As the colours of the wire in the mains lead of this product may not correspond with the coloured marking identifying the terminals in your plug, proceed as follows. The wire, which is coloured blue, must be connected to the terminal, which is marked with N or coloured black. The wire, which is coloured brown, must be connected to the terminal, which is marked L or coloured red.

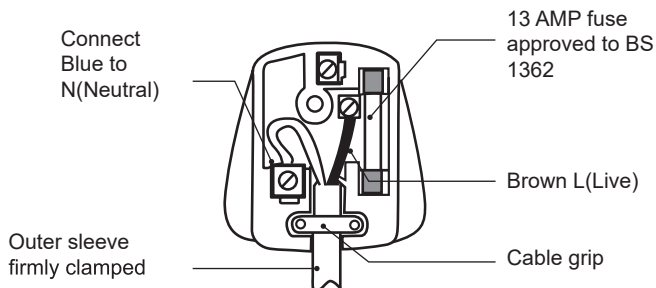



WARNING! NEVER CONNECT LIVE OR NEUTRAL WIRES TO THE EARTH TERMINAL OF THE PLUG, WHICH IS MARKED WITH E.

Only fit an approved 13 Amp BS 1363 or BS 1363/A plug and correctly rated 13 Amp BS 1362 fuse. If in doubt, consult a qualified electrician.



NOTE: If a moulded plug is fitted and has to be removed take great care in disposing of the plug and severed cable, it must be destroyed to prevent engaging into a socket.

Storage

1. Switch the product off and disconnect it from the power supply.
2. Clean the product as described above.
3. Fold the handle assembly and store the product to save space (Fig. 17, steps 1, 2, 3).

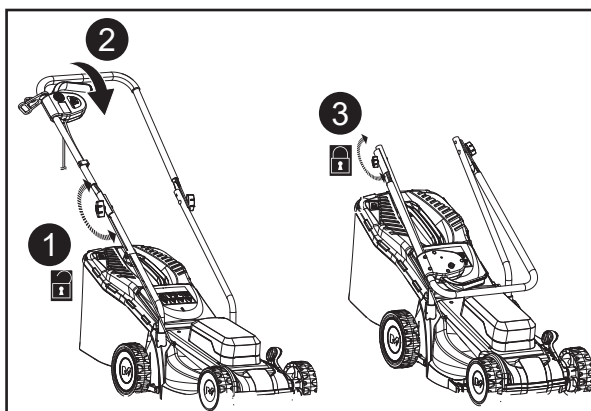

Fig. 17

4. Store the product and its accessories in a dark, dry, frost-free, well-ventilated place.
5. Always store the product in a place that is inaccessible to children. The ideal storage temperature is between 10 °C and 30 °C.
6. We recommend using the original package for storage or covering the product with a suitable cloth or enclosure to protect it against dust.

Transportation

1. Switch the product off and disconnect it from the power supply.
2. Attach transportation guards, if applicable.
3. Always transport the product by its transport handles (3, 12).
4. Protect the product from any heavy impact or strong vibrations which may occur during transportation in vehicles.
5. Secure the product to prevent it from slipping or falling over, damage and injury.

Customer care and technical helpline

A better way to repair your tools

Kingfisher takes special care in creating high-quality garden power tools that are designed to last. But if a fault develops with your garden power tool and you need to claim under the guarantee, the Customer Care and Technical Helpline can support with technical assistance or if required, arrange a free courier collection from your home, assess your garden power tool for fault, repair it, and return it.

Deciding to repair your product rather than buying a replacement and adding to the mountain of waste is a more sustainable choice and you will be doing your bit for the environment.

How does it work?



*** NOTE:** Before collection, all fuel must be removed from petrol powered machines.

Get in touch

If you need help or more information, please contact the Customer Care and Technical Helpline:

UK 0330 678 3077

ROI 1 800 365 800

Opening hours are Monday – Friday, 8 am - 5 pm

Availability of spare parts

Contact the customer service helpline for assistance or visit www.kingfisherspares.com

For assistance contact the customer services helpline:

UK 0330 678 3077 uk@Kingfisherservice.com

ROI 1 800 365 800 eire@kingfisherservice.com

Further information about this product can also be found at:

www.kingfisher.com/products





(UK) DECLARATION OF CONFORMITY

Product

- Lawnmower 1200 W 32 cm
- MCB1137LWM
- 0000001 - 999999

Name and address of the manufacturer or his authorised representative:

Kingfisher International Products Limited
1 Paddington Square
London
W2 1GG
United Kingdom

This declaration of conformity is issued under the sole responsibility of the manufacturer.

Object of the declaration

Product	Model	EAN
Lawnmower 1200 W 32 cm	MCB1137LWM	5063022567635

The object of the declaration described above is in conformity with the relevant legislation:

Supply of Machinery (Safety) Regulations 2008 as amended
Noise Emission in the Environment by Equipment for Use Outdoors Regulations 2001 as amended
Electromagnetic Compatibility Regulations 2016 as amended
The Restriction of the use of Certain Hazardous Substances in Electrical and Electronic Equipment Regulations 2012 as amended
Electrical Equipment (Safety) Regulation 2016 as amended

Measured Sound Power Level: 92.3 dB(A)

Guaranteed Sound Power Level: 96 dB(A)

Type Approval No: JO 60177871 0001

1200 W, 32 cm Lawnmower

References to the relevant designated standards used or references to the other technical specifications in relation to which conformity is declared:

EN 62841-1:2015 + A11
EN IEC 62841-4-3: 2021+A11
EN IEC 55014-1:2021
EN IEC 55014-2:2021
EN IEC 61000-3-2:2019 +A1
EN 61000-3-3:2013+A1+A2
EN ISO 3744:1995

The notified body TÜV Rheinland LGA Products GmbH, Tillystraße 2, 90431 Nürnberg, Germany, 0197 performed Outdoor Noise Directive and issued the certificate: JO 60177871 0001.

Authorised signatory and technical file holder:

Kingfisher International Products Limited,
1 Paddington Square,
London, W2 1GG,
United Kingdom

David Awe
Group Quality Director

date of issue 15/10/2024



(EN) EU DECLARATION OF CONFORMITY
(FR) DÉCLARATION UE DE CONFORMITÉ
(PL) DEKLARACJA ZGODNOŚCI UE
(RO) DECLARAȚIA DE CONFORMITATE UE
(ES) DECLARACIÓN UE DE CONFORMIDAD
(PT) DECLARAÇÃO DE CONFORMIDADE UE

Product/ Produit/ Produkt/ Produsul/ Producto/ Produto

- Lawnmower 1200 W 32 cm/ Tondeuse 1200 W 32 cm/ Kosiarka 1200 W 32 cm/ Mașină pentru tuns gazonul 1200 W 32 cm/ Cortacésped 1200 W 32 cm/ Corta-relva 1200 W 32 cm
- MCB1137LWM
- 000001 - 999999

Name and address of the manufacturer or his authorised representative:

Nom et adresse du fabricant ou de son mandataire:

Nazwa i adres producenta lub jego upoważnionego przedstawiciela:

Denumirea și adresa producătorului sau a reprezentantului său autorizat:

Nombre y dirección del fabricante o de su representante autorizado:

Nome e endereço do fabricante ou do respetivo mandatário:

Kingfisher International Products B.V.,
Rapenburgerstraat 175E,
1011 VM Amsterdam,
The Netherlands

This declaration of conformity is issued under the sole responsibility of the manufacturer.

La présente déclaration de conformité est établie sous la seule responsabilité du fabricant.

Niniejsza deklaracja zgodności wydana zostaje na wyłączną odpowiedzialność producenta.

Prezenta declarație de conformitate este emisă pe răspunderea exclusivă a producătorului.

La presente declaración de conformidad se expide bajo la exclusiva responsabilidad del fabricante.

A presente declaração de conformidade é emitida sob a exclusiva responsabilidade do fabricante.

Object of the declaration/Objet de la declaration/Przedmiot deklaracji/Obiectul declarației/Objeto de la declaración/Objeto da declaração

Product/Produit/Produkt/Produsul/
Producto/ Produto

Model/Modèle/Model/Modelul/
Modelo/ Modelo

EAN

Lawnmower 1200 W 32 cm/
Tondeuse 1200 W 32 cm/ Kosiarka
1200 W 32 cm/ Mașină pentru
tuns gazonul 1200 W 32 cm/
Cortacésped 1200 W 32 cm/
Corta-relva 1200 W 32 cm

MCB1137LWM

5063022567635

The object of the declaration described above is in conformity with the relevant Union harmonisation legislation:

L'objet de la déclaration décrit ci-dessus est conforme à la législation d'harmonisation de l'Union applicable:

Wymieniony powyżej przedmiot niniejszej deklaracji jest zgodny z odpowiednimi wymaganiami unijnego prawodawstwa harmonizacyjnego:

Obiectul declarației descris mai sus este în conformitate cu legislația relevantă de armonizare a Uniunii:

El objeto de la declaración descrita anteriormente es conforme con la legislación de armonización pertinente de la Unión:

O objeto da declaração acima descrito está em conformidade com a legislação de harmonização da União aplicável:

2006/42/EC as amended	Machinery Directive
2014/30/EU as amended	Directive Electromagnetic compatibility
2000/14/EC as amended	Outdoor Noise Directive
2011/65/EU as amended	Directive on the restriction of the use of certain hazardous substances in electrical and electronic equipment
Directive 2006/42/CE	relative aux machines
2014/30 / UE	telle que modifiée Directive Compatibilité électromagnétique
Directive 2000/14/CE	relative aux émissions sonores extérieures
Directive 2011/65/UE	relative à la limitation de l'utilisation de certaines substances dangereuses dans les équipements électriques et électroniques
2006/42/WE	w zmienionej dyrektywie maszynowej
2014/30 / UE	ze zmianami Dyrektywa Kompatybilność elektromagnetyczna
2000/14/WE	w zmienionej dyrektywie w sprawie hałasu na zewnątrz
2011/65/UE	zgodnie z wprowadzonymi poprawkami Dyrektywa w sprawie ograniczenia stosowania niektórych niebezpiecznych substancji w sprzęcie elektrycznym i elektronicznym
2006/42/CE,	astfel a fost modificată Directiva privind echipamentele
2014/30/UE,	astfel a fost modificată Directiva privind compatibilitatea electromagnetică
2000/14/CE,	astfel a fost modificată Directiva privind zgomotul în aer liber
2011/65/UE	cum a fost modificată Directiva Restricțiile de utilizare a anumitor substanțe periculoase în echipamentele electrice și electronice
Directiva sobre	maquinaria modificada 2006/42/CE
2014/30/UE	modificada Directiva Compatibilidad electromagnética
2000/14/CE	modificada Directiva sobre ruido al aire libre
2011/65/UE	según enmendado Directiva sobre restricciones a la utilización de determinadas sustancias peligrosas en aparatos eléctricos y electrónicos
2006/42/CE	como diretiva de máquinas alteradas
2014/30/UE	como alteração da compatibilidade eletromagnética
2000/14/CE	como diretiva de ruído exterior alterada
2011/65/UE	conforme alterado Directiva Restrição do uso de determinadas substâncias perigosas em equipamentos eléctricos e electrónicos
2014/35/EU	Directive Electrical Safety: Low-voltage electrical equipment
2014/35/EU	Directive Sécurité électrique: matériel électrique à basse tension
2014/35/EU	Dyrektywa Bezpieczeństwo elektryczne: sprzęt elektryczny niskiego napięcia
Directiva 2014/35/UE	siguranța electrică: echipamente electrice de joasă tensiune
2014/35/EU	Directiva Seguridad Eléctrica: Equipos eléctricos de baja tensión
2014/35/Diretiva UE	Segurança Elétrica: Equipamento elétrico de baixa tensão
Measured Sound Power Level	Guaranteed Sound Power Level
Le niveau de puissance acoustique mesuré	Le niveau de puissance acoustique garant
Zmierzony poziom mocy akustycznej	Gwarantowany poziom mocy akustycznej
Nível de putere acustică măsurat	Nível de putere acustică garantat
Nível de potencia sonora medido	Nível de potencia sonora garantizado
Nível de potência sonora medido	Nível de potência sonora garantido
: 92.3 dB(A)	: 96 dB(A)

The notified body TÜV Rheinland LGA Products GmbH, Tillystraße 2, 90431 Nürnberg, Germany, 0197 performed Outdoor Noise Directive and issued the certificate: JO 60177871 0001.
 L'organisme notifié TÜV Rheinland LGA Products GmbH, Tillystraße 2, 90431 Nürnberg, Germany, 0197 a effectué Directive 2000/14/CE relative aux émissions sonores extérieures et a établi le certificate: JO 60177871 0001.
 W stosownych przypadkach jednostka TÜV Rheinland LGA Products GmbH, Tillystraße 2, 90431 Nürnberg, Germany, 0197 notyfikowana przeprowadziła 2000/14/WE w zmienionej dyrektywie w sprawie hałasu na zewnątrz i wydała certyfikat: JO 60177871 0001.
 Organismul notificat TÜV Rheinland LGA Products GmbH, Tillystraße 2, 90431 Nürnberg, Germany, 0197 a efectuat 2000/14/CE, astfel a fost modificată Directiva privind zgomotul în aer liber și a emis certificatul: JO 60177871 0001.
 El organismo notificado TÜV Rheinland LGA Products GmbH, Tillystraße 2, 90431 Nürnberg, Germany, 0197 ha efectuado 2000/14/CE modificada Directiva sobre ruido al aire libre y expide el certificado: JO 60177871 0001.
 O organismo notificado TÜV Rheinland LGA Products GmbH, Tillystraße 2, 90431 Nürnberg, Germany, 0197 efetuou 2000/14/CE como diretiva de ruído exterior alterada e emitiu o certificado: JO 60177871 0001.

References to the relevant harmonised standards used or references to the other technical specifications in relation to which conformity is declared:

Références des normes harmonisées pertinentes appliquées, y compris la date de celles-ci, ou des autres spécifications techniques, y compris la date de celles-ci, par rapport auxquelles la conformité est déclarée:

Odwolania do odnośnych norm zharmonizowanych, które zastosowano, wraz z datą normy, lub do innych specyfikacji technicznych, wraz z datą specyfikacji, w odniesieniu do których deklarowana jest zgodność:

Trimiteri la standardele armonizate relevante folosite, inclusiv data standardului, sau trimiteri la celelalte specificații tehnice, inclusiv data specificațiilor, în legătură cu care se declară conformitatea:

Referencias a las normas armonizadas pertinentes utilizadas, incluidas las fechas de las normas, o referencias a las otras especificaciones técnicas, incluidas las fechas de las especificaciones, respecto a las cuales se declara la conformidad:

Referências às normas harmonizadas aplicáveis utilizadas, incluindo a data da norma, ou às outras especificações técnicas, incluindo a data da especificação, em relação às quais é declarada a conformidade:

EN 62841-1:2015 + A11
 EN IEC 62841-4-3: 2021+A11
 EN IEC 55014-1:2021
 EN IEC 55014-2:2021
 EN IEC 61000-3-2:2019 +A1
 EN 61000-3-3:2013+A1+A2
 EN ISO 3744:1995

Authorised signatory and technical file holder/signataire et responsable de la documentation technique
 autorisé/ podmiot uprawniony do wystawienia i adres przechowujący dokumentację techniczną/
 semnatar autorizat și deținător al dosarului tehnic/firmante autorizado y titular del expediente técnico/
 signatário autorizado e detentor da ficha técnica:

Kingfisher International Products B.V.,
 Rapenburgerstraat 175E,
 1011 VM Amsterdam,
 The Netherlands



David Awe
 Group Quality Director

: date of issue 15/10/2024

Manufacturer:

UK Manufacturer:

Kingfisher International Products Limited,
1 Paddington Square, London, W2 1GG,
United Kingdom

EU Manufacturer:

Kingfisher International Products B.V.,
Rapenburgerstraat 175E,
1011 VM Amsterdam,
The Netherlands

EN www.diy.com

www.screwfix.com

www.screwfix.ie

**To view instruction manuals online,
visit www.kingfisher.com/products**