

**EN IMPORTANT** - These instructions are for your safety. Please read through them thoroughly prior to handling the product and retain them for future reference. This product is only suitable for well insulated spaces or occasional use.

**V10425\_5063022651136\_MAND2\_2324**

## EN Electric curved towel warmer

- 5063022651136
- 5063022651082
- 5063022650955
- 5063022650924
- 5063022651174
- 5063022651006
- 5063022651020
- 5063022650993

## EN Parts

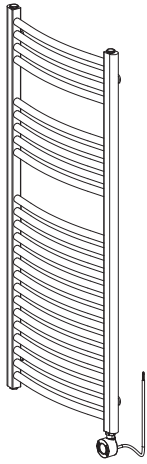

01. x1

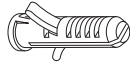

02. x4  
(Ø8 x 64 mm)



03. x4  
(ST4.8 x 60 mm)



04. x4



05. x4

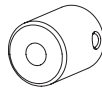

06. x4



07. x4  
(M5 x 12 mm)



08. x4  
(M6 x 20 mm)

## EN You will need

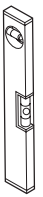
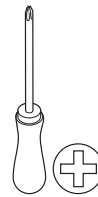
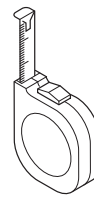
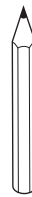
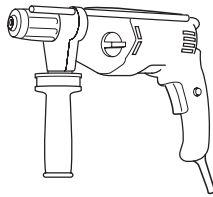

## EN Contents

EN	
Safety	3
Guarantee	13
Preparation	14
Installation	15
Use	18
Care & maintenance	29



## EN

### Before you start

- Read these important instructions carefully before using the appliance.
  - Keep these instructions during all the appliance's lifespan for future reference.
  - Always give these instructions to anyone who will use the appliance, even if it's transferred to a third party.
  - Failure to observe safety instructions can cause potential injuries or property damage (Electric shock, burns, fire, ...).
  - Instructions are intended to protect your health and health of others, but also prevent potential damage to the appliance.
  - This appliance is only intended to hold, warm and dry water-soaked textile towels in a domestic application and under no circumstances in a commercial or industrial professional setting.
- A room heating is possible provided the appliance rated power is  $\geq 300$  W and is adapted to the room volume, its insulation quality and your home geographical and climatic location for an optimal performance.
  - This appliance is in conformance with European Union, United Kingdom and Ireland regulations.
  - Please contact a qualified electrician or a professional installer if you need assistance for the appliance installation including aspects regarding electric part.

### Safety

- Before use, always refer to the instructions and precautions intended to the assembly, installation, cleaning and maintenance as well as symbols explanations.
- Remove all packaging parts before installation and use.



**WARNING: KEEP PACKAGING MATERIALS AND ACCESSORIES OUT OF THE REACH OF CHILDREN. NEVER ALLOW CHILDREN TO PLAY WITH PACKAGING OR ACCESSORIES. POTENTIAL BAGS IN PLASTIC OR EQUIVALENT MATERIAL INCLUDED WITH PACKAGING ELEMENTS SHALL BE KEPT AWAY FROM CHILDREN.**



**DANGER: RISK OF SUFFOCATION. BAGS ARE NOT TOYS.**

- Children of less than 3 years should be kept away unless continuously supervised.
- Children aged from 3 years and less than 8 years shall only switch on / off the appliance provided that it has been placed or installed in its intended normal operating position and they have been given supervision or instruction concerning use of the appliance

in a safe way and understand the hazards involved.

- Children aged from 3 years and less than 8 years shall not plug in, regulate and clean the appliance or perform user maintenance.
- This appliance can be used by children aged from 8 years and above and persons with reduced physical, sensory or mental capabilities or lack of experience and knowledge if they have been given supervision or instruction concerning use of the appliance in a safe way and understand the hazards involved.
- Children should be supervised to ensure that they do not play with the appliance.
- Cleaning and user maintenance shall not be made by children without supervision.



**CAUTION: SOME PARTS OF THIS PRODUCT CAN BECOME VERY HOT AND CAUSE BURNS. PARTICULAR ATTENTION HAS TO BE GIVEN WHERE CHILDREN AND VULNERABLE PEOPLE ARE PRESENT.**

- This appliance can be used at a maximum altitude of 2000 m.
- The heater must not be located immediately below a socket outlet.
- Do not use this heater if it has been dropped.
- Do not use if there are visible signs of damage to the heater.
- This heater is filled with a precise quantity of special oil. Repairs requiring opening of the oil container are only to be made by the manufacturer or his service agent who should be contacted if there is an oil leak.
- When scrapping the heater, follow the regulations concerning the disposal of oil.

 **WARNING:** RISK OF DAMAGE. DO NOT LEAN AGAINST THE APPLIANCE OR SIT ON IT.

 **DANGER:** NEVER PLACE LIQUIDS OR SOLIDS OBJECTS, EXCEPT TEXTILE TOWELS, ON THE APPLIANCE WHEN IN USE OR STORED.

## Installation

 **CAUTION:** FOR A SECURE WALL MOUNTED INSTALLATION, THIS APPLIANCE MUST BE FIXED ON A STRUCTURALLY SOUND WALL WITH A MATERIAL CAPABLE OF WITHSTANDING APPLIANCE WEIGHT AND MODERATE HEAT.

 **DANGER:** RISK OF APPLIANCE UNHOOKING AND FALLING!

- The wall fixings included with the appliance (Wall plugs and metal screws) are only intended for an installation on a solid wall such as concrete, solid bricks and blocks or natural stone but not for an installation on a hollow or friable wall such as a plasterboard, hollow bricks and blocks, cellular concrete or cob and rammed earth.
- Please obtain suitable fixings if the kit provided does not match the installation wall materials.



**WARNING:**  
ALWAYS CHECK  
THE WALL OR ITS  
COATING THERMAL  
RESISTANCE  
BEFORE  
INSTALLATION  
BECAUSE SOME  
MATERIALS ARE  
SENSITIVE TO  
HEAT AND SHALL  
BE AVOIDED (NON-  
EXHAUSTIVE LIST):

- FLOCKING
- BLOWN VINYL
- EMBOSSSED PAPER
- SOME  
WALLPAPERS  
TYPES
- CLOTH WALL  
COVERING

- Some discoloration may occur in time according to wall materials, air impurities and appliance use frequency. Avoid direct exposition of the appliance and its potential accessories to sunlight.



**WARNING:** ALWAYS  
RESPECT THE  
INSTALLATION  
DIRECTION.

- The wall shall be flat, dry and shall not obstruct any possible appliance ventilation slots.
- Before drilling into the walls, check for hidden pipes and cables.
- Minimum spaces between the appliance and surrounding structures shall be observed, please refer to the installation schemes.



**WARNING:** IN  
ORDER TO AVOID  
A HAZARD FOR  
VERY YOUNG  
CHILDREN, THIS  
APPLIANCE SHOULD  
BE INSTALLED SO  
THAT THE LOWEST  
HEATED RAIL IS  
AT LEAST 600 MM  
ABOVE THE FLOOR.

- Using of adhesives as fixing method is proscribed as they are not considered to be a reliable fixing means.



**DANGER:** NEVER  
INSTALL OR USE  
THIS APPLIANCE  
OUTSIDE, INDOOR  
USE ONLY.

## Electric connection

- Whether or not the appliance is fitted with an electrical plug, included or not according to national installation rules, the plug must remain accessible or a means for disconnection having a contact separation in all poles must be incorporated in the fixed wiring in accordance with the wiring rules, in order to allow the appliance disconnection from the electric supply in all circumstances.



**DANGER: BEFORE ACCESSING THE CONNECTION TERMINALS, ALL ELECTRIC SUPPLY CIRCUITS MUST BE DISCONNECTED.**

- The appliance is to be supplied through a residual current device (RCD) having a rated residual operating current not exceeding 30 mA.
- The appliance electrical protection is only ensured with a ground connection. Always check the protective earth is connected for a full electric protection.
- The appliance power supply current is alternating type.

- When installing the appliance, make sure the appliance is positioned in a way that ensures its heated parts are not in direct contact with the fixed electric wiring system. If it does, the fixed wiring insulation must be protected, for example, by an insulating sleeving having an appropriate temperature rating.
- Unwind the supply cord completely and check there is no damage on it.
- If the supply cord is damaged, it must be replaced by the manufacturer, its service agent or similarly qualified persons in order to avoid a hazard.



**CAUTION: IN ORDER TO AVOID A HAZARD DUE TO INADVERTENT RESETTING OF THE THERMAL CUT-OUT, THIS APPLIANCE MUST NOT BE SUPPLIED THROUGH AN EXTERNAL SWITCHING DEVICE, SUCH AS A TIMER, OR CONNECTED TO A CIRCUIT THAT IS REGULARLY SWITCHED ON AND OFF BY THE UTILITY.**

- The appliance must not be connected via an extension cable or a power strip.



**DANGER:** NEVER CONNECT / DISCONNECT THE APPLIANCE ELECTRIC SUPPLY WITH WET HANDS, RISK OF ELECTRIC SHOCK.



**CAUTION:** DO NOT BEND, CRUSH OR PINCH THE ELECTRIC SUPPLY CORD BEHIND THE APPLIANCE.



**WARNING:** ALWAYS ENSURE YOUR FIXED ELECTRIC WIRING SYSTEM CAN MANAGE THE APPLIANCE'S RATED POWER.

IF THE POWER CORD BECOMES VERY HOT, IT MEANS YOUR ELECTRIC INSTALLATION IS NOT ABLE TO MANAGE THE APPLIANCE RATED POWER.



**DANGER:** THE COMPLIANCE TO THE NATIONAL ELECTRICAL INSTALLATION RULES MUST BE COMPLIED PRIOR TO THE APPLIANCE'S INSTALLATION (STANDARDS EXAMPLES: BS 7671 FOR THE UNITED KINGDOM, NF C15-100 FOR FRANCE, DIN VDE 0100-100, IEC 60364-7-701, ...).



**WARNING:** FOR AN INSTALLATION INSIDE A WATER ROOM SUCH AS A BATHROOM OR A SHOWER ROOM, THE APPLIANCE MUST COMPLY TO STRICT INSTALLATION LOCATIONS DEPENDING ON THE ROOM PROTECTION VOLUMES, THE APPLIANCE'S

ELECTRIC  
PROTECTION CLASS,  
ITS LIQUID INGRESS  
PROTECTION CODE  
AND THE NATIONAL  
ELECTRICAL  
INSTALLATION  
RULES.



**CAUTION:** WHERE  
AN ELECTRIC  
HEATER, INCLUDING  
ITS ELECTRICAL  
CONNECTION TO THE  
MAINS, EXTENDS  
IN SEVERAL  
PROTECTION  
VOLUMES, THE  
TECHNICAL  
SPECIFICATIONS  
APPLY TO THE  
CLOSEST VOLUME  
OF THE WATER  
ZONE.

- Please contact a qualified electrician for other countries.
- Protection volumes description:
  - Volume 0: Water receiving areas.
  - Volume 1: Up to a height of 2.25 m above the ground near the water receiving area. Until the edge of the shower tray if the shower is closed and has shower screens (Or an equivalent closure) or 1.2 m radius length from the showerhead if the shower is opened.
  - Volume 2: ≤60 cm after volume 1. No height modification.
  - Volume 3, also called Outside volume (X): >60 cm after volume 1. No height modification.
- According to its technical specifications ≥IPX4 / Class I, the appliance can be installed only in volume 3 / X and in volume 2 for the following countries: United Kingdom, Ireland, Poland, Romania, Portugal & Türkiye. Installation is only possible in volume 3 / X for France & Spain.

## Protection volumes diagram

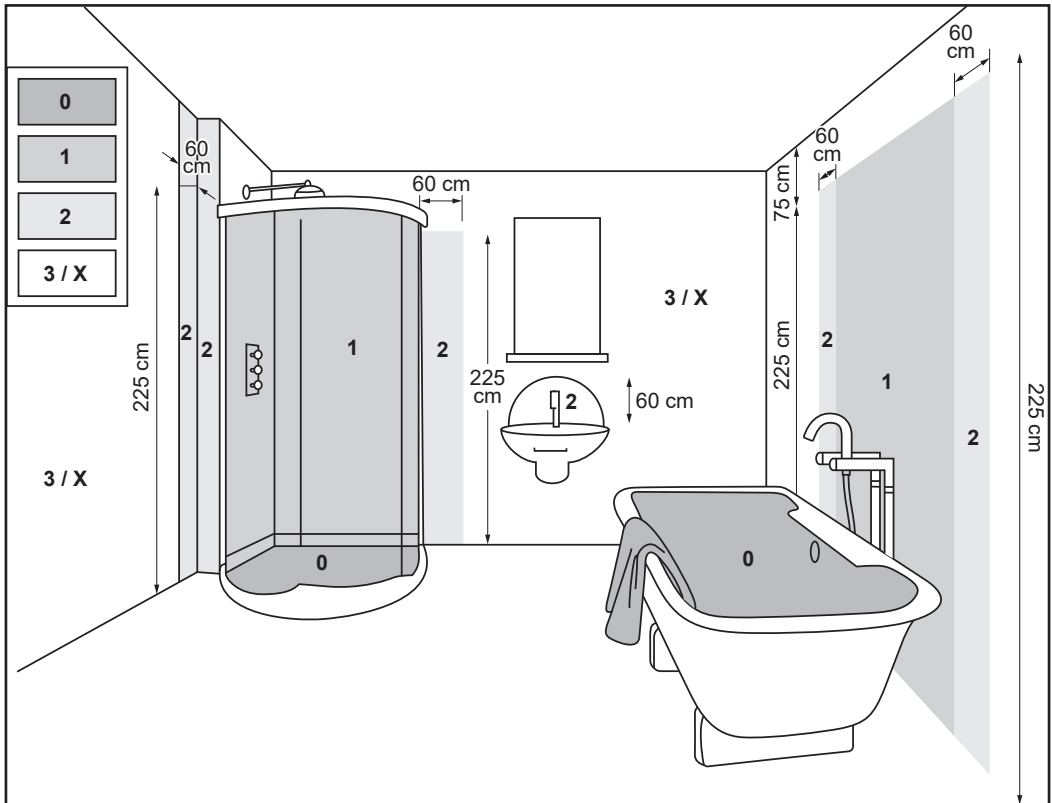

### Only for France, United Kingdom and Ireland:



**WARNING:** RISK OF ELECTRIC SHOCK AND FIRE ! THE FOLLOWING OPERATIONS SHALL BE PROCEEDED BY A QUALIFIED ELECTRICIAN IF YOU ARE UNFAMILIAR WITH NATIONAL ELECTRIC RULES OR HAVE NO SUFFICIENT TECHNICAL KNOWLEDGE.



**DANGER:** ALWAYS ENSURE THE ELECTRIC SUPPLY CIRCUITS ARE DISCONNECTED.

- The power cord must be securely connected to the supply mains through a terminal block (Not supplied).



**DANGER:** ALWAYS ENSURE THE CORRESPONDENCE BETWEEN THE APPLIANCE SUPPLY CORD ELECTRIC WIRES AND YOUR FIXED WIRING.

- Wires colours codes may differ according to countries and the housing or building construction year. In case of doubts, especially for old installations, please contact a qualified electrician.
- Indicative wires colours codification:
  - Neutral = Marked “N” = Blue but may be Black in old installation
  - Live / Phase = Marked “L” = Brown but may be Red in old installation
  - Earth / Ground  = Marked “PE” or “E” or = Green and Yellow



**WARNING:** INSULATE THE BARE END OF THE POTENTIAL NOT USED WIRE(S) TO PREVENT ELECTRICAL CONTACT WITH OTHER WIRES.

## Only for United Kingdom and Ireland





- The appliance must be electrically connected to a fused fixed spur, which is fitted with a 6 A (Ampere) fuse adapted to the appliance rating power.

## Technical Data

Item	Model no.	EAN	Power	Color	Dimensions
1	UK700400C	5063022651136	150 W	Chrome	H 700 x W 400 x D 54 mm
2	UK800500C	5063022650955	250 W	Chrome	H 800 x W 500 x D 62 mm
3	UK800600C	5063022651006	250 W	Chrome	H 800 x W 600 x D 66 mm
4	UK1100500C	5063022651082	250 W	Chrome	H 1100 x W 500 x D 62 mm
5	UK1200500C	5063022650924	300 W	Chrome	H 1200 x W 500 x D 62 mm
6	UK1200600C	5063022651020	400 W	Chrome	H 1200 x W 600 x D 66 mm
7	UK1600500C	5063022651174	500 W	Chrome	H 1600 x W 500 x D 62 mm
8	UK1600600C	5063022650993	500 W	Chrome	H 1600 x W 600 x D 66 mm

Electric specifications	220-240 V ~ 50Hz
Electric protection class	Class I (Must be connected to a socket with grounding)
Ingress protection code (IP)	IP24 (Protection against splashing / sprays of waters on the casing)
Operating range in °C	0-50 °C
Manufacturing country	P.R.C.

## Product Symbols

	This product complies with conformity requirements of the applicable European Regulations or Directives.
	This product complies with conformity requirements of the applicable UK Regulations.
	This symbol is known as the 'Crossed-out Wheelee Bin Symbol'. When this symbol is marked on a product or battery, it means that it should not be disposed of with your general household waste. Some chemicals contained within electrical/electronic products or batteries can be harmful to health and the environment. Only dispose of electrical/electronic/battery items in separate collection schemes, which cater for the recovery and recycling of materials contained within. Your co-operation is vital to ensure the success of these schemes and for the protection of the environment.
	The appliance power supply current is alternating type.
	Read the instructions.

## Recycling and disposal



When scrapping the heater, follow the regulations concerning the disposal of oil.

At the end of its life, the product must not be sorted or recycled with other domestic waste.



You are legally responsible for sorting the appliance and its potential accessories, as well as packaging elements and the instructions manual.

Separate collection schemes are scheduled for the collection and recycling to avoid the dispersion of harmful substances for the health and the environment.

Please always observe national and local regulations to reduce the environmental impact of your purchase.

## Guarantee

We take special care to select high quality materials and use manufacturing techniques that allow us to create products incorporating design and durability. This product has a manufacturer's guarantee of 2 years against manufacturing defects, from the date of purchase (if bought in store) or date of delivery (if bought online), at no additional cost for normal (non-professional or commercial) household use.

To make a claim under this guarantee, you must present your proof of purchase (such as a sales receipt, purchase invoice or other evidence admissible under applicable law), please keep your proof of purchase in a safe place. For this guarantee to apply, the product you purchased must be new, it will not apply to second hand or display products. Unless stated otherwise by applicable law, any replacement product issued under this guarantee will only be guaranteed until expiry of the original period guarantee period.

This guarantee covers product failures and malfunctions provided the product was used for the purpose for which it is intended and subject to installation, cleaning, care and maintenance in accordance with the information contained in these terms and conditions, in the user manual and standard practice, provided that standard practice does not conflict with the user manual.

This guarantee does not cover defects and damage caused by normal wear and tear or damage that could be the result of improper use, faulty installation or assembly, neglect, accident, misuse, or modification of the product. Unless stated otherwise by applicable law, this guarantee will not cover, in any case, ancillary costs (shipping, movement, costs of uninstalling and reinstalling, labour etc), or direct and indirect damage.

If the product is defective, we will, within a reasonable time, provide spare parts.

Rights under this guarantee are enforceable in the country in which you purchased this product. Guarantee related queries should be addressed to the store you purchased this product from.

The guarantee is in addition to and does not affect your statutory rights.

**IMPORTANT - RETAIN THIS INFORMATION  
FOR FUTURE REFERENCE:  
READ CAREFULLY**

---

## EN Preparation

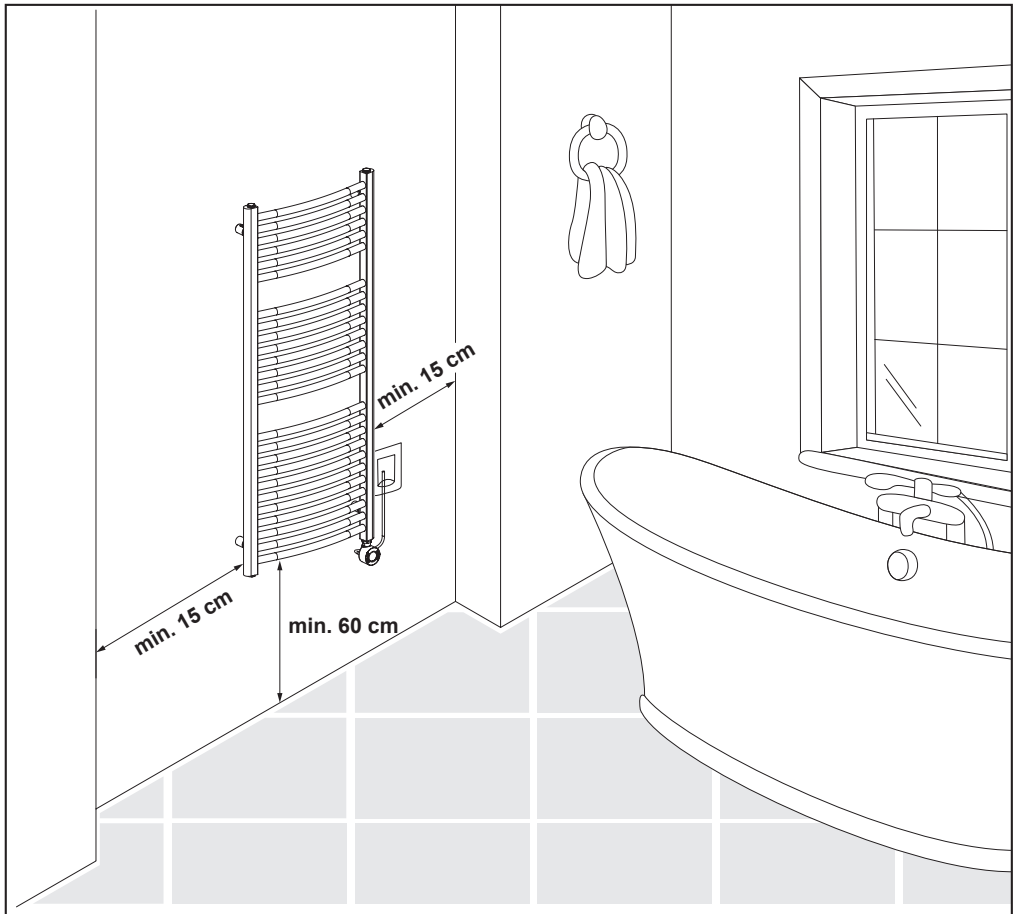

# 01

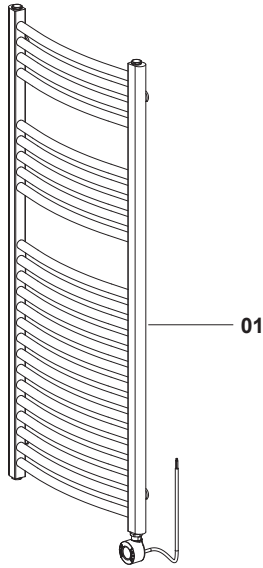

# 02

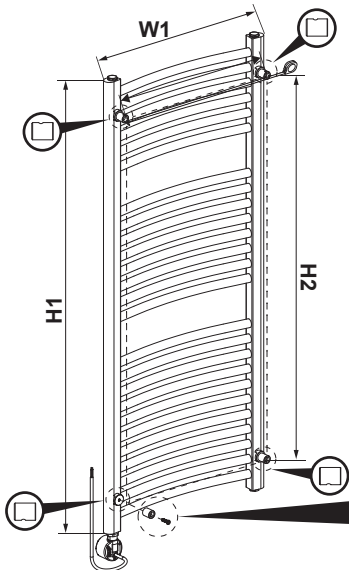

W1 (mm)	W2 (mm)
400	350
500	450
600	550

H1 (mm)	H2 (mm)
700	520
800	620
1100	920
1200	1020
1600	1420

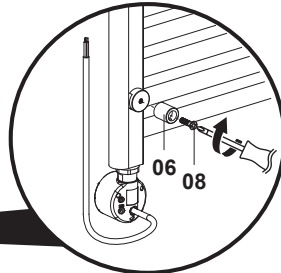

# 03

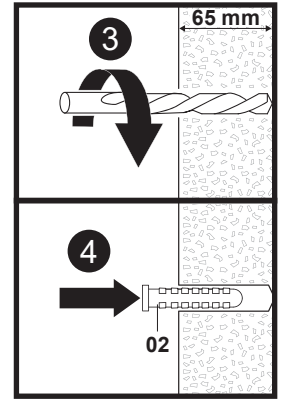
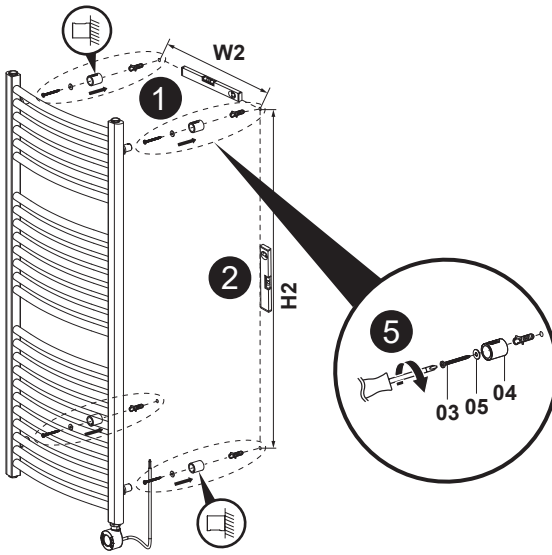

# 04

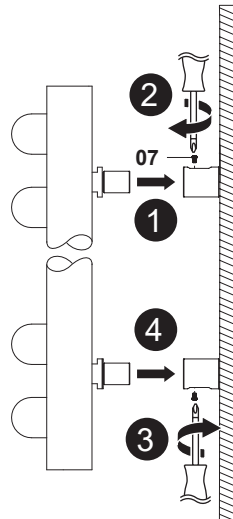

EN



**DANGER:** RISK OF APPLIANCE UNHOOKING! THE WALL MOUNT FASTENERS (PLASTIC PLUGS AND METAL SCREWS) INCLUDED WITH THE APPLIANCE ARE ONLY SCHEDULED FOR AN INSTALLATION ON A CONCRETE WALL.



**WARNING:** FOR WOOD WALLS, CINDER BLOCKS, PLASTERBOARD OR OTHER WALL TYPES, CONSULT A PROFESSIONAL TO KNOW WHAT IS THE BEST ATTACHMENT METHOD AS THE SUPPLIED WALL MOUNT FASTENERS WILL NOT BE SUITABLE.

**NOTE:** A sheet or equivalent soft textile can be placed under the appliance to avoid scratching or damaging it during assembly.



**WARNING:** RISK OF SCREWS HEADS DAMAGE! THE USE OF AN ELECTRIC SCREWDRIVER IS NOT RECOMMENDED.



**CAUTION:** ALWAYS CHECK THE APPLIANCE WILL BE CORRECTLY INSTALLED USING A LEVEL.

---

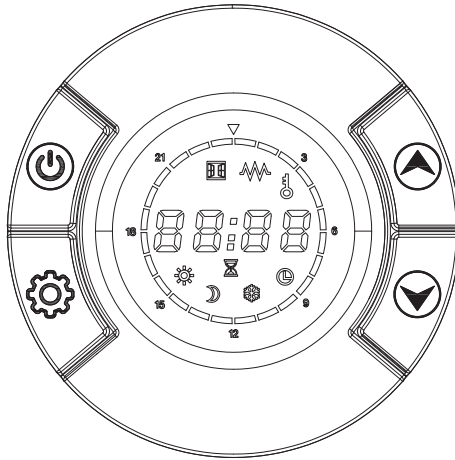

Symbol	Function
	Power button
	Timer / temperature up button
	Timer / temperature down button
	Setting
	Comfort mode
	Economy Mode

Symbol	Function
	Defrost mode
	Program mode
	Timer mode
	Open window detection
	Heating
	Child lock

### Control Panel Operation

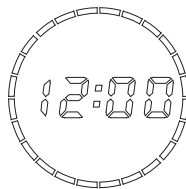

- Turn on the appliance or put it on standby with a short press on , short press twice when the display is not illuminated.



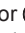

- Selecting operating modes: Short press on , and press it again to switch to different modes: Comfort / Economy / Defrost / Program / Timer:



1. **Comfort Mode:** Default temperature is 19 °C. Press  or  to adjust the temperature. In Comfort mode, the adjustable temperature range is between 7 and 30 °C.

**NOTE:** Long press  or  to keys to quickly raise or lower the temperature.



2. **Economy Mode:** Default temperature is 15 °C. Press  or  to adjust the temperature. In Economy mode, the adjustable temperature range is between 7 and 30 °C.

**NOTE:** Temperature in Economy Mode cannot be higher than in Comfort mode.



3. **Defrost Mode:** Default temperature is 7 °C. The temperature cannot be adjusted in Defrost mode.

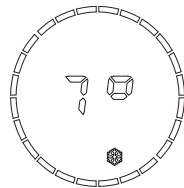

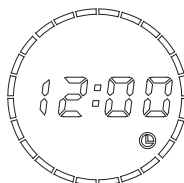

4. **Program Mode:** When using the appliance for the first time or after a long period of non-use (or power failure), the user has to set the current time and week.



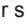

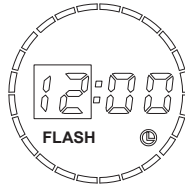

From the Program mode, you have first to set the clock and week day (Steps 4.1 to 4.3), and then you can modify the preset weekly programming (Step 4.4).

- 4.1. Long press  until hour set flashes; press  and  to set hour (If no operation for 30s, it will switch to minute setting);

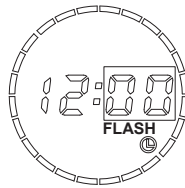



- 4.2. Short press  until minute flashes, then press  and  to adjust it (if there is no input for 30 seconds, it will switch to the day setting).

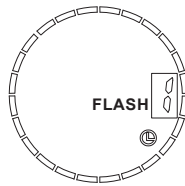

- 4.3. Short press  until the day flashes, then press  and  to adjust it. 1 = Monday, 2 = Tuesday, 3 = Wednesday, 4 = Thursday, 5 = Friday, 6 = Saturday, 7 = Sunday (If there is no input for 30 seconds, it will jump to P mode).





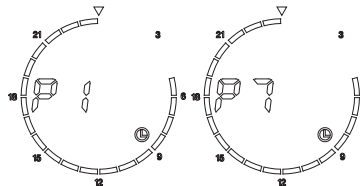

- 4.4. Short press , and P1 will be displayed. Short press  to select day to program (P1-P7). Move from P1 to P7 to adjust the settings for each day of the week (P1 = Monday and P7 = Sunday).

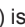

The default setting from Monday to Sunday is from 5:00 to 23:59 in Comfort mode and from 24:00 to 04:59 in Economy mode. And you can adjust the default settings by yourself.

Long press icon  until (00) is displayed. Press  to adjust the Comfort mode hour range and  to adjust the Economy mode hour range.

For example, if you only want Comfort mode from 06:00:00 to 07:59:59 in the morning, and Economy mode from 08:00:00 to 05:59:59 on Wednesday.



- Select P3, and press  few seconds so that P3:00 is displayed.
- Press  x 6 times to activate Economy mode from midnight to 05:59:59.
- Then press  x 2 times to activate Comfort mode from 06:00:00 to 07:59:59.
- Then press  until P3:23 is displayed to activate Economy mode from 08:00:00 to 23:59:59.

**NOTE:** A long press on  or  will change hour range quickly.

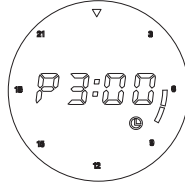
**The result will be on display:**



After Comfort and Economy modes made for range hours of a day, press  again to go back to program mode.

Then press  again to reach another days P1 to P7 to adjust programs by days. After P7, when you press again  you will go back to program mode.





5. **Timer mode:** Working time limitation that automatically deactivates the appliance after a pre-set period of time.

Operation at maximum power — there is no default temperature and the temperature cannot be adjusted. This mode does not work if the ambient temperature is higher than 40 °C.

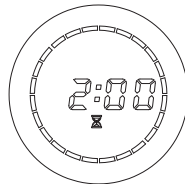

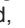

The heating time can be set by the user. Short press  or  to increase or reduce the heating time from 1 to 8 h. Default setting is 2 h.

Once the time has passed, the appliance will return to Standby mode.

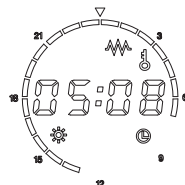

- **Child lock:** To avoid incorrect use, the user can enable the child lock to lock the current mode. Press  and  at same time 3 seconds until Child lock icon  appears. Other operations cannot be performed, except when the user presses the on / standby icon . To disable child lock, press  and  at same time 3 seconds in "on" mode until Child lock lights off.



- **Internal setting and description:** Press  10 seconds when the appliance is standby, enter the internal settings, then short press  to switch modes: Temperature compensation setting (F0) or Open window detection (F1) by pressing 2 times.
1. **Temperature compensation setting (F0):** if the appliance cannot sense the temperature correctly, you can adjust the temperature manually. The range is from 5 °C to -5 °C. Short press  and  to adjust it.

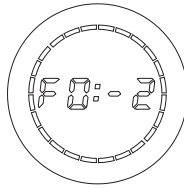

2. **Open window detection (F1):** Short press  and  to adjust (0)/(60)/(90).

(0) means that Open window detection is off.

(60)/(90) means that Open window detection is activated for a period of 60 or 90 minutes.

When it is active, if the ambient temperature drops 5 °C within 5 minutes, indicating that a window is open, heating stops and the appliance switches to Defrost mode.

The appliance stops heating for 60 or 90 minutes when the temperature is 10 °C, then returns to the previous mode. If the ambient temperature drops 5 °C within 5 minutes again, Open window detection starts again and heating stops for 60 or 90 minutes again. This cycle will continue. 5 mins. again, Window open detection starts again and heating stops for 60 or 90 mins. again. The appliance will run in this cycle.

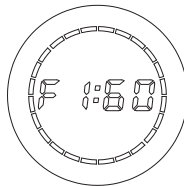

**Power failure memory function:** If there is sudden power failure, the working state at the time of the power failure is remembered; when the power supply returns, the appliance automatically enters the previous mode, unless timing mode needs to be reset.

**Restore factory settings:** The system will be restored to default factory settings automatically and powered standby when  is pressed for 10 seconds.



**WARNING:** ALL SETTINGS INCLUDING TEMPERATURE SETTINGS, PROGRAMMING MADE, ADDITIONAL FUNCTIONS SETTINGS WILL BE RESTORED TO DEFAULT FACTORY SETTINGS.

# Information requirements for electric local space heaters

Contact details	Kingfisher International Products Limited 1 Paddington Square, London, W2 1GG, United Kingdom www.kingfisher.com/products		
Model identifier(s)	UK700400C		
Item	Symbol	Value	Unit
<b>Heat output</b>			
Nominal heat output	$P_{nom}$	0.150	kW
Minimum heat output (indicative)	$P_{min}$	/	kW
Maximum continuous heat output	$P_{max,c}$	0.150	kW
<b>Power consumption</b>			
In off mode	$P_o$	/	W
In standby mode	$P_{sm}$	0.16	W
In idle mode	$P_{idle}$	0.17	W
In network standby	$P_{nsm}$	/	W
Standby mode with display of information or status	<input type="checkbox"/>		
Seasonal space heating energy efficiency in active mode	$N_{s,on}$	94.0	%
<b>Type of heat output/room temperature control</b>			
Single stage heat output and no room temperature control	<input type="checkbox"/>		
Two or more manual stages, no room temperature control	<input type="checkbox"/>		
With mechanic thermostat room temperature control	<input type="checkbox"/>		
With electronic room temperature control	<input type="checkbox"/>		
Electronic room temperature control plus day timer	<input type="checkbox"/>		
Electronic room temperature control plus week timer	<input checked="" type="checkbox"/>		
<b>Other control options</b>			
Room temperature control, with presence detection	<input type="checkbox"/>		
Room temperature control, with open window detection	<input checked="" type="checkbox"/>		
Distance control option	<input type="checkbox"/>		
Adaptive start control	<input type="checkbox"/>		
Working time limitation	<input checked="" type="checkbox"/>		
Black bulb sensor	<input type="checkbox"/>		
Self-learning functionality	<input type="checkbox"/>		
Control accuracy	<input type="checkbox"/>		
■ : Yes / □ : No			

Contact details	Kingfisher International Products Limited 1 Paddington Square, London, W2 1GG, United Kingdom www.kingfisher.com/products		
Model identifier(s)	UK800500C / UK800600C / UK1100500C		
Item	Symbol	Value	Unit
<b>Heat output</b>			
Nominal heat output	$P_{nom}$	0.250	kW
Minimum heat output (indicative)	$P_{min}$	/	kW
Maximum continuous heat output	$P_{max,c}$	0.250	kW
<b>Power consumption</b>			
In off mode	$P_o$	/	W
In standby mode	$P_{sm}$	0.16	W
In idle mode	$P_{idle}$	0.17	W
In network standby	$P_{nsm}$	/	W
Standby mode with display of information or status	<input type="checkbox"/>		
Seasonal space heating energy efficiency in active mode	$N_{s,on}$	94.0	%
<b>Type of heat output/room temperature control</b>			
Single stage heat output and no room temperature control	<input type="checkbox"/>		
Two or more manual stages, no room temperature control	<input type="checkbox"/>		
With mechanic thermostat room temperature control	<input type="checkbox"/>		
With electronic room temperature control	<input type="checkbox"/>		
Electronic room temperature control plus day timer	<input type="checkbox"/>		
Electronic room temperature control plus week timer	<input checked="" type="checkbox"/>		
<b>Other control options</b>			
Room temperature control, with presence detection	<input type="checkbox"/>		
Room temperature control, with open window detection	<input checked="" type="checkbox"/>		
Distance control option	<input type="checkbox"/>		
Adaptive start control	<input type="checkbox"/>		
Working time limitation	<input checked="" type="checkbox"/>		
Black bulb sensor	<input type="checkbox"/>		
Self-learning functionality	<input type="checkbox"/>		
Control accuracy	<input type="checkbox"/>		
■ : Yes / □ : No			

Contact details	Kingfisher International Products Limited 1 Paddington Square, London, W2 1GG, United Kingdom www.kingfisher.com/products		
Model identifier(s)	UK1200500C		
Item	Symbol	Value	Unit
<b>Heat output</b>			
Nominal heat output	$P_{nom}$	0.300	kW
Minimum heat output (indicative)	$P_{min}$	/	kW
Maximum continuous heat output	$P_{max,c}$	0.300	kW
<b>Power consumption</b>			
In off mode	$P_o$	/	W
In standby mode	$P_{sm}$	0.16	W
In idle mode	$P_{idle}$	0.17	W
In network standby	$P_{nsm}$	/	W
Standby mode with display of information or status	□		
Seasonal space heating energy efficiency in active mode	$N_{s,on}$	94.0	%
<b>Type of heat output/room temperature control</b>			
Single stage heat output and no room temperature control	□		
Two or more manual stages, no room temperature control	□		
With mechanic thermostat room temperature control	□		
With electronic room temperature control	□		
Electronic room temperature control plus day timer	□		
Electronic room temperature control plus week timer	■		
<b>Other control options</b>			
Room temperature control, with presence detection	□		
Room temperature control, with open window detection	■		
Distance control option	□		
Adaptive start control	□		
Working time limitation	■		
Black bulb sensor	□		
Self-learning functionality	□		
Control accuracy	□		
■ : Yes / □ : No			

Contact details	Kingfisher International Products Limited 1 Paddington Square, London, W2 1GG, United Kingdom www.kingfisher.com/products		
Model identifier(s)	UK1200600C		
Item	Symbol	Value	Unit
<b>Heat output</b>			
Nominal heat output	$P_{nom}$	0.400	kW
Minimum heat output (indicative)	$P_{min}$	/	kW
Maximum continuous heat output	$P_{max,c}$	0.400	kW
<b>Power consumption</b>			
In off mode	$P_o$	/	W
In standby mode	$P_{sm}$	0.16	W
In idle mode	$P_{idle}$	0.17	W
In network standby	$P_{nsm}$	/	W
Standby mode with display of information or status	□		
Seasonal space heating energy efficiency in active mode	$N_{s,on}$	94.0	%
<b>Type of heat output/room temperature control</b>			
Single stage heat output and no room temperature control	□		
Two or more manual stages, no room temperature control	□		
With mechanic thermostat room temperature control	□		
With electronic room temperature control	□		
Electronic room temperature control plus day timer	□		
Electronic room temperature control plus week timer	■		
<b>Other control options</b>			
Room temperature control, with presence detection	□		
Room temperature control, with open window detection	■		
Distance control option	□		
Adaptive start control	□		
Working time limitation	■		
Black bulb sensor	□		
Self-learning functionality	□		
Control accuracy	□		
■ : Yes / □ : No			

Contact details	Kingfisher International Products Limited 1 Paddington Square, London, W2 1GG, United Kingdom www.kingfisher.com/products		
Model identifier(s)	UK1600500C / UK1600600C		
Item	Symbol	Value	Unit
<b>Heat output</b>			
Nominal heat output	$P_{nom}$	0.500	kW
Minimum heat output (indicative)	$P_{min}$	/	kW
Maximum continuous heat output	$P_{max,c}$	0.500	kW
<b>Power consumption</b>			
In off mode	$P_o$	/	W
In standby mode	$P_{sm}$	0.16	W
In idle mode	$P_{idle}$	0.17	W
In network standby	$P_{nsm}$	/	W
Standby mode with display of information or status	<input type="checkbox"/>		
Seasonal space heating energy efficiency in active mode	$N_{s,on}$	94.0	%
<b>Type of heat output/room temperature control</b>			
Single stage heat output and no room temperature control	<input type="checkbox"/>		
Two or more manual stages, no room temperature control	<input type="checkbox"/>		
With mechanic thermostat room temperature control	<input type="checkbox"/>		
With electronic room temperature control	<input type="checkbox"/>		
Electronic room temperature control plus day timer	<input type="checkbox"/>		
Electronic room temperature control plus week timer	<input checked="" type="checkbox"/>		
<b>Other control options</b>			
Room temperature control, with presence detection	<input type="checkbox"/>		
Room temperature control, with open window detection	<input checked="" type="checkbox"/>		
Distance control option	<input type="checkbox"/>		
Adaptive start control	<input type="checkbox"/>		
Working time limitation	<input checked="" type="checkbox"/>		
Black bulb sensor	<input type="checkbox"/>		
Self-learning functionality	<input type="checkbox"/>		
Control accuracy	<input type="checkbox"/>		
■ : Yes / □ : No			

## Troubleshooting

Operation of your appliance can lead to errors and malfunctions. The following tables contain possible causes and tips to resolve them. Please consult this table before to contact after sales service.

Trouble	Possible causes	Solution
The appliance is not powered on.	The appliance is not correctly connected to the electric mains.	Connect the appliance to the electric mains including a earth connection.
		Check the connection is firmly made.
	Overheat protection has been triggered.	Check the power cord is not trapped, bended, crushed, pinched or damaged.
		An overheat safety is included inside the appliance. Ensure installation and use are correctly respected, then disconnect the appliance, let it cool down at least half of an hour before to connect it again.
The appliance suddenly stops during heating.	The appliance stops heating after reaching the heating temperature set.	No abnormal situation. If the heating stops too frequently according to your heating needs, set the temperature thermostat higher.

If you encounter a problem using your appliance, make sure to follow the instruction manual including chapters relating to cleaning, servicing and maintenance.

Check the possible error codes descriptions according to the appliance.

If the problem is not resolved despite these steps, we invite you to contact the after-sales service of the place of your purchase through the retail banner store or its website.



**CAUTION:** ANY PRODUCT INTERVENTION AND / OR REPAIR BY THE USER OR A NON-PROFESSIONAL THIRD PARTY MAY JEOPARDIZE THE SAFETY OF PERSONS AND PROPERTY.

SO, DO NOT ATTEMPT TO DISASSEMBLE THIS APPLIANCE, REPAIR IT OR PERFORM ANY MODIFICATIONS BY YOURSELF.



**WARNING:** DEFECTS AND THEIR CONSEQUENCES RESULTING FROM PRODUCT INTERVENTIONS AND / OR REPAIRS CARRIED OUT BY THE USER, OR A NON-PROFESSIONAL THIRD PARTY CANNOT GIVE RISE TO THE APPLICATION OF THE LEGAL OR COMMERCIAL WARRANTY.



**CAUTION:** THE MANUFACTURER CANNOT BE HELD RESPONSIBLE FOR DAMAGE OCCURRING DURING SELF-REPAIR INSOFAR AS THIS DAMAGE IS LINKED IN PARTICULAR TO USER ERROR OR NON-COMPLIANCE BY THE LATTER WITH THE PRODUCT REPAIR INSTRUCTIONS.



**DANGER:** BEFORE ANY INTERVENTION, ALL ELECTRIC SUPPLY CIRCUITS MUST BE DISCONNECTED.

### EN Cleaning



**WARNING:** ANY INTERVENTION RELATING TO THE APPLIANCE CLEANING, SERVICING OR MAINTENANCE MUST BE CARRIED OUT AFTER COMPLETE COOLING AND ALL ELECTRIC SUPPLY CIRCUITS DISCONNECTED.



**DANGER:** NEVER IMMERSE THE APPLIANCE IN WATER OR OTHER LIQUIDS AND NEVER HOLD IT UNDER RUNNING WATER.



**WARNING:** NEVER APPLY DETERGENT, CHEMICAL AGENTS OR SOLVENTS AS THEY COULD DAMAGE THE APPLIANCE, THE MATERIALS AND THE COATINGS, ESPECIALLY PLASTIC PARTS. LIKEWISE, ABRASIVE BRUSHES OR SHARP OBJECTS SHOULD NOT BE USED AS THIS COULD SCRATCH OR DAMAGE THE APPLIANCE.

- Do not use a steam cleaner when cleaning the appliance.
- Clean the appliance regularly, once a month maximum.
- The casing can be clean by wiping gently a soft non-abrasive dust cloth, a microfiber type can be used. If stains are visible, the cloth can be slightly dampened with water and a little mild soap can be added.



**DANGER:** DO NOT INSERT ANY OBJECT OR TOOLS INSIDE THE APPLIANCE.

### Availability of spare parts

Spare parts are available to professional repairers for a minimum period of 10 years after purchasing the product new.

The remote control (If originally included with your appliance) is available for at least the same period to both professional repairers and end users.

Repairs to this product must be carried out by professional repairers only.

Any unauthorised attempt of repairing will invalidate the warranty.

Please visit [www.kingfisher.com/products](http://www.kingfisher.com/products) for more information.

---

**Manufacturer:**

**UK Manufacturer:**

Kingfisher International Products Limited,  
1 Paddington Square, London, W2 1GG,  
United Kingdom

**EU Manufacturer:**

Kingfisher International Products B.V.,  
Rapenburgerstraat 175E,  
1011 VM Amsterdam,  
The Netherlands

**EN** [www.diy.com](http://www.diy.com)

[www.screwfix.com](http://www.screwfix.com)

[www.screwfix.ie](http://www.screwfix.ie)

**To view instruction manuals online,  
visit [www.kingfisher.com/products](http://www.kingfisher.com/products)**