

KEY FOB TESTER

24446

Read this manual in full before using this product and retain it for future use. Always use the latest version of the manual. Please visit drapertools.com/manuals for the latest version.

1. Intended Use

This product is designed for checking radio and infrared wavelength emissions from vehicle key fobs and remote controls to assist with diagnosing faults. The tester operates between 418–434MHz.

Any other application beyond the conditions established for use will be considered misuse. Draper Tools accepts no responsibility for improper use of this product.

Part of our Expert range, this product is intended for frequent trade use, with the quality and features to meet and exceed expectations of the most demanding user.

2. Specification

Stock No.	24446
Part No.	KFT
Radio frequency ranges	418Mhz, 433–434MHz
Power consumption	26mA approx.
Automatic power off	70–100 seconds after power on
Ambient conditions	
Operation	0 to 50°C, humidity <85%
Storage	-1 to 60°C, humidity <85%
Battery	1 x 9v PP3 (not supplied)
Dimensions	W 83 x H 138 x D 32mm
Weight (incl. battery)	130g approx



3. Health and Safety Information

- Use this product only for its intended purpose and do not modify it in any way.
- **DO NOT** expose this product to liquids or wet environments.
- Check the device carefully before use.
 - **DO NOT** use this product if it is damaged in any way or if there is evidence of battery leakage.
 - If battery acid comes into contact with your skin, wash it off immediately with plenty of clean water.
 - If battery acid comes into contact with your eyes, flush them with plenty of clean water and seek medical attention immediately.
- **DO NOT** immerse this device in water or allow the battery to come into contact with liquids.
- **DO NOT** abuse, mutilate or burn the battery.
- Keep this product out of reach of children.

4. Identification

- (1) Radio signal indicator (red)
- (2) Power indicator (green)
- (3) Infrared signal indicator (red)
- (4) Signal receptor
- (5) Power button
- (6) Battery compartment

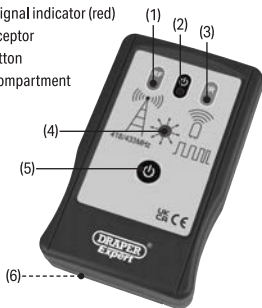

5. Operation

Important: This product requires 1 x 9V PP3 battery (not supplied).

1. Remove the battery compartment (6) and install a suitable battery.



Fig. 1

2. Press the power button (5) to switch on the tester.
 - The power indicator (2) illuminates.
 - The radio signal indicator (1) illuminates and goes out after two seconds.

3. Move the vehicle key fob or remote control to be tested close to the tester and direct it towards the signal receptor (4).

4. Operate the key fob or remote control.

5. If the tester detects radio or infrared wavelengths at the applicable frequencies, the corresponding indicator (1)(3) will illuminate.

Important: When testing for radio signal, Draper Tools recommends repeating the test several times as radio interference may affect the device's response.

6. If the key fob or remote control does not trigger the appropriate indicator, replace the battery in the emitting device and retry.

7. The tester switches off automatically after 70–100 seconds regardless of use.

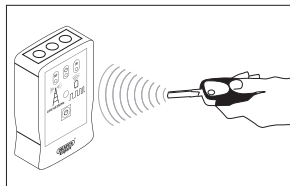

Fig. 2

6. Storage and Disposal

- Remove the battery if the product will not be used for extended periods.
- Store the product in a cool, clean and dry location, out of direct sunlight and out of reach of children.
- At the end of its working life, dispose of the product responsibly and in line with local regulations; recycle where possible.
- Remove the battery before decommissioning and dispose of the battery separately.
- **DO NOT** dispose of this product with domestic waste; most local authorities provide appropriate recycling facilities.
- **DO NOT** burn or mutilate batteries; this may release toxic or corrosive substances.



7. Explanation of Symbols



Read the instruction manual



Power consumption



Battery type



WEEE –

Waste Electrical & Electronic Equipment
Do not dispose of Waste Electrical & Electronic
Equipment in with domestic rubbish



Do not incinerate or throw onto fire



European conformity



UK Conformity Assessed