

Family Toilet Seat Instructions

Things to check before you start

- ✓ Check to make sure you have all of the parts listed.
- ✓ If you are in any doubt about installing this product, consult a technically competent installer.

Safety

- ✓ For domestic use only.
- ✓ **CAUTION:** DO NOT overtighten the fixings otherwise it may damage the product.
- ✓ **CAUTION:** Always ensure the product is securely installed before use.
- ✓ Failure to follow these instructions may result in personal injury, damage to the product and property damage.
- ✓ Children should be supervised to ensure they do not play with the toilet seat. Always use under adult supervision.
- ✓ Wash hands after each use.
- ✓ Take care when opening and closing the toilet seat.

Installation instructions

Option 1 : Top fixing

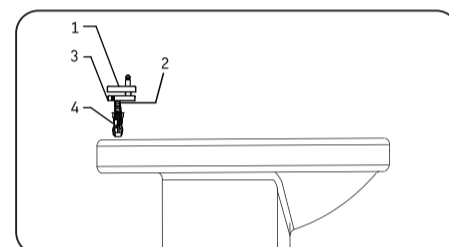
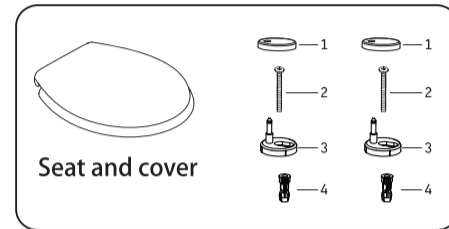

1. Insert the hinges into the toilet

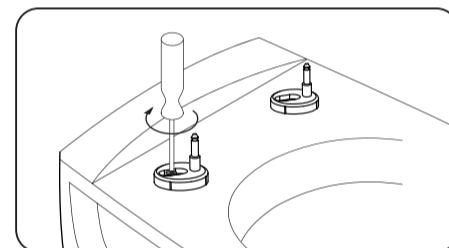

2. Tighten the screws of the hinges

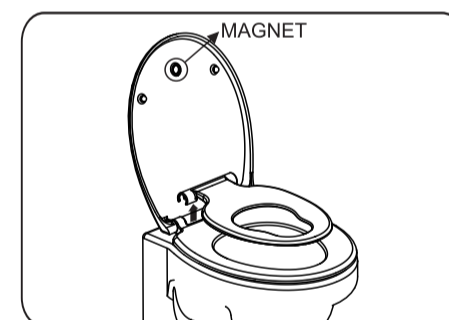

Option 2 : Bottom fixing

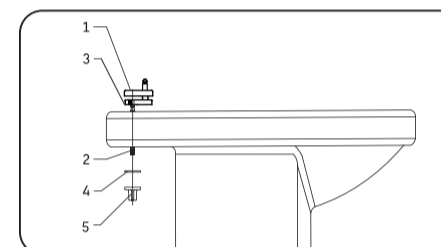
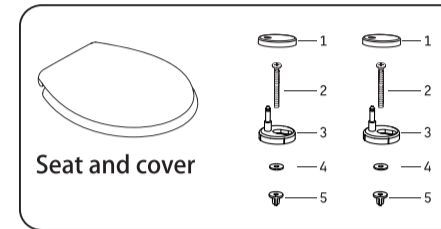

1. Insert the hinges into the toilet

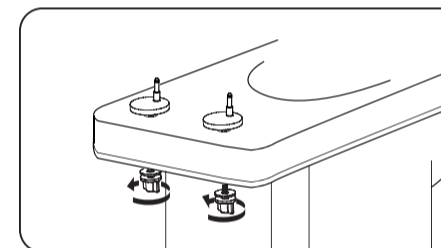

2. Tighten the screws of the hinges

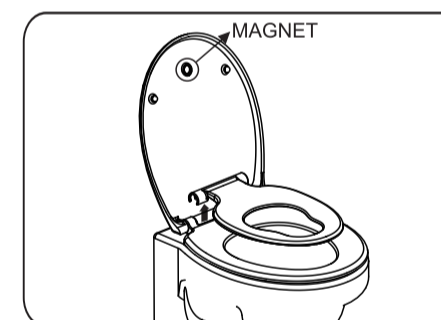

Care instructions

- 1 Use warm soapy water and a soft damp cloth to clean the surface of the product. Wipe dry with a clean cloth.
- 2 Never use any solvents, scourers, abrasives, bleach, acids, strong detergents, aggressive chemical cleaners or solvent-type cleaning solutions on the product.
- 3 Do not forcefully open or close the toilet seat and cover. This may cause damage to the product.
- 4 Never stand on the toilet rim, seat or cover. Standing on the toilet, seat or cover may result in serious product damage and personal injury.
- 5 Do not drop any hard objects on the toilet seat or cover. Damage may result with cracks and leaks.
- 6 If the toilet seat is damaged and cracked discontinue use immediately and replace the unit. Failure to do so may result in serious injury or property damage.
- 7 It is recommended to check the toilet seat fittings for security and tightness at regular intervals.