



Hand-Operated Backpack Sprayer

Patt No. 15LPAPS

User Manual



www.spear-and-jackson.com

Primary Functions

This Backpack Sprayer is economical, safe and highly efficient. This Sprayer is designed to be used for most typical spraying applications such as watering plants and flowers, pest control and cleaning paths, etc.

Structure - Operating Principles and Features

STRUCTURE: This Sprayer consists of five units:

- 15 Litre Tank
- Pump
- Spraying unit (tube, switch, a spray wand, and spray heads)
- Pump Handle
- Shoulder Straps

FEATURES:

1. The tank is ergonomically designed to fit for back-mounting.
2. It uses a inner plunge pump to allow easy operation, labour-saving, quick boosting and consistent pressure.
3. Both spot spraying and continual spraying are available due to the optional locking trigger feature.
4. The simple and practical Pump Handle allows for either left-hand or right-hand operation to contribute to reduction of labour intensity.
5. The Sprayer comes with various nozzles to produce fog or droplets depending on the desired applications.
6. The Sprayer is made of premium materials. It is airtight, durable and resistant to corrosion.

Parts Descriptions and Technical Parameters

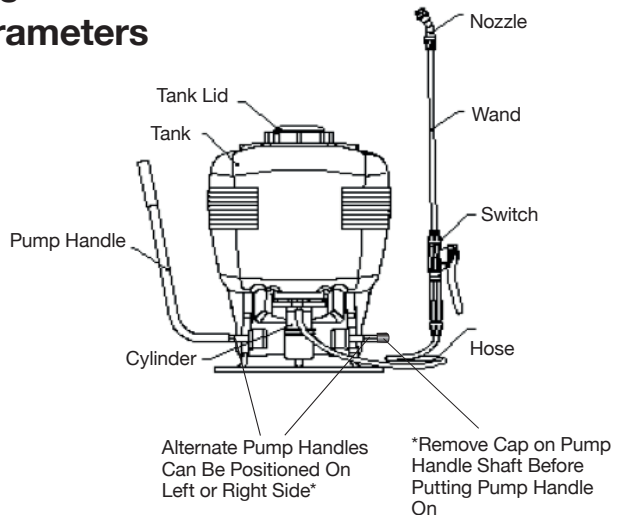

15L PAPS

1- Type: Backpack Sprayer

2 - Volume of Tank: 15 Litres

3 - Operating Pressure: 0.2 ~ 0.4Mpa

4 - Operating Stroke: 40-80mm

5 - Dia. of leather up: 45mm

6 - Net Weight of the Whole Unit: 4.08kg (empty) : 19kg (full)

7 - Overall Size: 355 × 210 × 520mm

Nozzle Type	Pres.MPa	Flow L/min	Nozzle Type	Pres.MPa	Flow L/min
Single cone nozzle	0.3-0.4	0.6-0.7	Double cone nozzle	0.2-0.4	1.1-1.4
Single fan nozzle	0.2-0.3	0.6-0.8	Four-hole adjustable nozzle	0.2-0.35	0.8-1.2

Precautions Hazards / Important Advice



It is highly recommended that you read this Manual and follow the safety and operational instructions.



The operator should wear Protective Safety Glasses, Mask, Hat, Gloves, and Protective Clothing.



Storage and warehousing of pesticide: The pesticide should be kept out of the reach of children. Disposal of pesticide should follow the safety instructions furnished by the manufacturer.



In case of inhaling; Immediately go to a well-ventilated place to lie down and rest. In case of skin contact, rinse with water immediately.

In case of ingestion, induce vomiting with water and go to hospital as soon as possible.

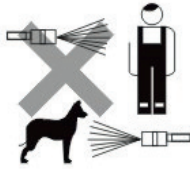

Never spray at human beings or animals. Never operate against the wind.

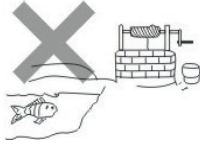

The residual chemical should be kept in a container instead of being poured into fields, ground or rivers. The empty bottles and bags should either be collected and sent to the manufacturer for taken to your Local Waste & Sanitation Department for proper disposal.



People affected by fatigue, poor health, injury, pesticide allergy or during pregnancy should never engage in pesticide dispensing.



Never use strong acid, strong alkaline, highly-toxic or highly-persistent pesticides for pest control of any food products.



After each use, the Sprayer should be washed according to the pesticide manufacturer's directions to prevent corrosion by the chemical and to avoid possible reaction between different chemicals.



As a safety precaution, never leave the sprayer unattended.

Precautions Hazards / Important Advice



The chemical for application in this Sprayer should not exceed 45°C /113° F

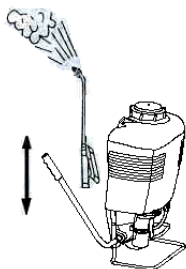

Perform trial spraying with clean water to check the tank, hose, and spray gun for possible leakage. Apply lubricant to the seal ring and other moving parts to reduce grinding and resistance.



The preparation of the chemical should follow the instructions and formula furnished by the pesticide manufacturer. Unauthorized alteration of the dilution ratio of the chemical is prohibited, as it may either endanger human beings and animals or result in the failure of pest control.



Upon the completion of operation, user should remove protective clothing and wash any exposed parts of the body. If highly toxic pesticides or germicides have been used, a shower is recommended.

Instructions for Operation

Unscrew the lid of the sprayer tank and carefully fill it with the prepared mixture through the strainer before replacing the tank lid. Mount the sprayer on your back and pump the Pump Handle to boost the gas pressure in the air chamber before holding the switch to spray. Both spot spraying and continual spraying are available - see diagram A and B below.

Pump Handle - Remove Protective Cap on Shaft

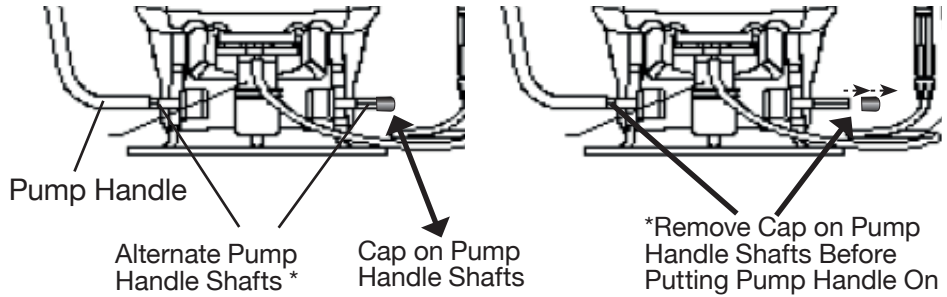

Pump Handle - To Boost Gas Pressure Before Spraying

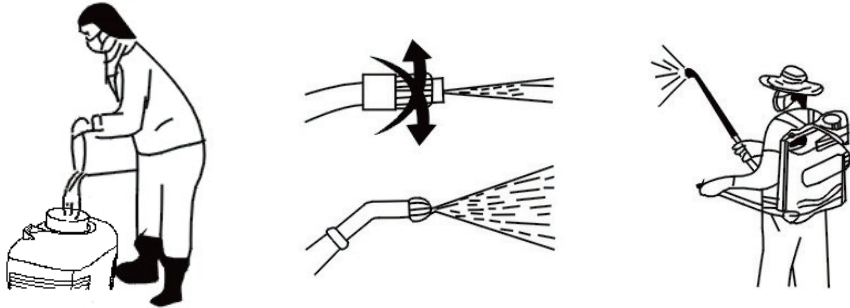
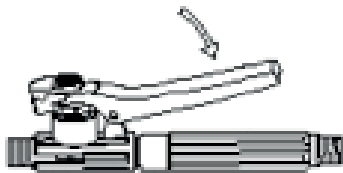
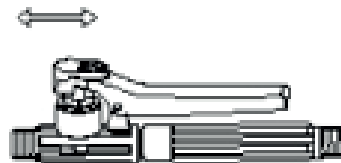

Diagram for Switch Control



A. Spot spraying



B. Continual spraying

Cleaning and Maintenance

After use, the surface of the Sprayer should be washed in an allowed cleaning site; the inner part should be cleaned with high-pressure injection until the drainage becomes clean.

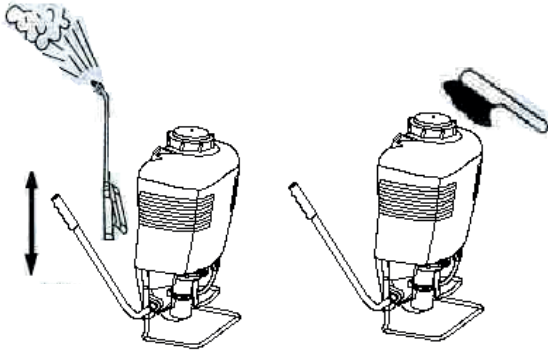

The Spraying parts should be lubricated after cleaning.

IX. Storage

The sprayer should be stored in a dry place indoors and out of reach of children.

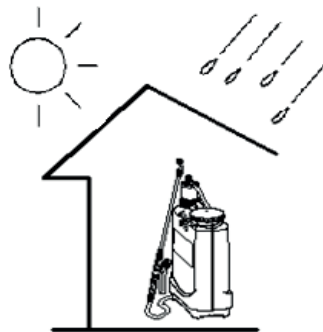

After use, any remaining air pressure inside the bottle can be easily expelled by holding down the switch trigger until no air or liquid is coming out of the nozzle.

Structural Diagram and Details

Part #	Part Description	Qty.	Part #	Part Description	Qty.
1	Cone Nozzle	1	17	Tank Lid	1
①	Nozzle Cap	1	18	Tank Seal Ring	1
②	Cone Sprinkle Sheet	1	19	Big Strainer	1
③	Split Sheet	1	20	Spray Tank	1
④	Seal Gasket 16-11*2	1	21	O-Ring 50*4	1
⑤	Elbow	1	22	Air Chamber Assembly	1
2	Spray Boom	1	23	O-Ring 29*3.6	1
3	Spray Boom Nut	3	24	Tap Screw 4*8	2
4	Fastening Sleeve	2	25	Flat Washer 4	2
5	O-Ring 15*3	1	26	Valve Sheet	2
6	Switch Parts	1	27	Cylinder	1
①	Spacing Cap	1	28	Internal Compression Spring	1
②	Switch Handle	1	29	Leather Cup	1
③	Switch Nut	1	30	Piston	1
④	Switch Spring	1	31	Connection Rod Circlip	1
⑤	Valve Plug	1	32	Connection Rod Clamp	1
⑥	Valve Plug O-Ring 9.5*1.9	1	33	Pump Handle	1
⑦	Washer	1	34	Socket Hexagon Screw M8*25	2
⑧	Switch Pin	1	35	Hex Nut M5	1
⑨	Switch Body	1	36	Air Chamber Clamp	1
⑩	O-Ring 18.5*2.65	1	37	Cross Recessed Pan Head Screw M5*45	1
11	Switch Strainer	1	38	Cylinder Cover	1
12	Handle Bar	1	39	Cross Recessed Pan Head Screw M5*25	1
7	Flared Sheath	1	40	Tap Screw 3*10	2
8	Plastic Tube Sheath	1	41	Pump Handle	1
9	Pipe-Clip	1	42	Pump Handle	1
10	Plastic Tube Assembly	1	43	Flat Washer 16	2
11	Strap Fastener	2	44	Bushing	2
12	Strap	2	45	Turn Bar	1
13	Shoulder Pad	2	46	Split Pin 2.5*30	1
14	Strap Buckle	2	47	Fan Nozzle	1
15	Strap Hook	2	48	30°Dual Nozzle	1
16	Inlet Valve	1	49	Four-Hole Adjustable Spray Nozzle	1

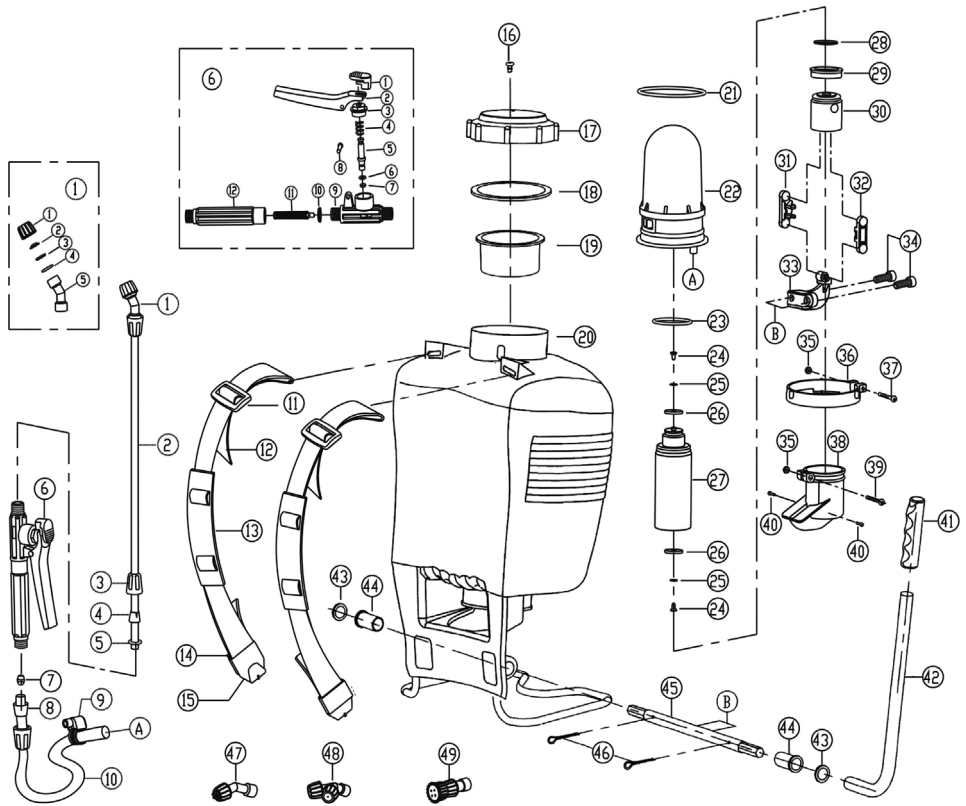

A spare set of 'O' Ring seals and nozzles is also available for this item
(our part no. 15LPAPSKIT).

Troubleshooting

Problems	Causes	Solutions
In case of leakage or poor spraying performance	Seal rings at various joints may be loose or be damaged	Tighten or replace them
Pump Handle is hard to move Strong resistance to motion occurs to the moving parts of Pump Handle and Turn Rod	The strainers or the spray nozzle may be blocked	Clean the strainer and spray nozzle immediately and apply lubricant to various moving parts
Decreasing pressure	The leather cup or valve may have been damaged	Replace the leather cup and the valve
It produces no pressure to turn the Pump Handle	The valve sheet has come off	Re-install the valve sheet

Packing List

Included	Descriptions	Unit	Quantity	Remarks
1	Main unit sprayer	Set	1	
2	Operating Instructions		1	
3	Seal Ring	Set	1	
4	Leather cup		1	
5	Four-hole adjustable nozzle	PC	1	
6	Fan nozzle	PC	1	
7	30° dual nozzle	PC	1	
8	Fastening sleeve	PC	1	
9	Inner hex wrench	PC	1	
10	Warranty Card	PC	1	



Visit our website at:

www.spear-and-jackson.com

To see our Extensive Selection of High Quality
Lawn & Garden Products and Accessories.

Spades, Forks, Loppers, Pruners, Gloves & More.

This product is guaranteed against defects in manufacturing,
subject to normal wear and tear and the provision of reasonable
care and maintenance. This does not affect your statutory rights.