

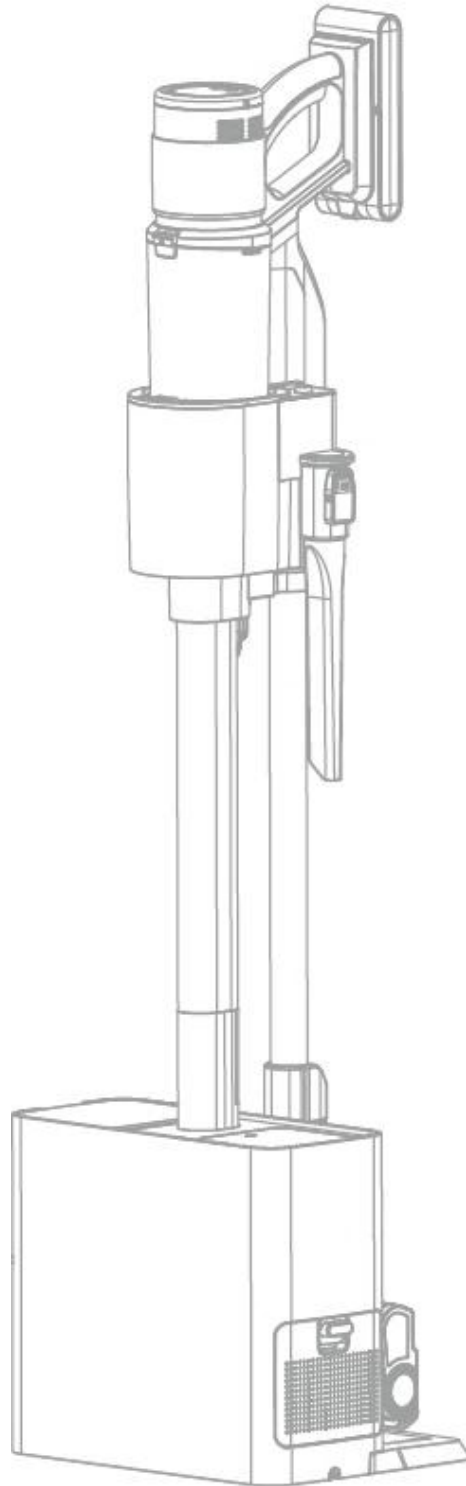

Electrolux



RECHARGEABLE STICK VACUUM CLEANER WITH AUTO EMPTY AND CHARGING STATION
FLR00207

User Manual

Contents

Page No.

2	Contents
4	Reading and Storing the User Manual
4	Important Safety Instructions for Proper Use
7	Explanation of Symbols
8	What's in the Box
9	Description of Parts – Charging Dock/Auto Empty Unit
10	Description of Parts – Included Tools & Accessories
11	Description of Parts – Vacuum Cleaner Control Panel
11	Before First of Your Auto Empty Vacuum
12	Assembling the Vacuum Cleaner
13	Assembling the Base Unit
14	Charging the Battery
16	Using Your Vacuum Cleaner
16	Changing the Suction Modes
17	Attaching the Tools
17	The Upholstery Brush Tool
18	The Crevice Tool
18	The Turbo Brush Tool
19	Using the Vacuum Handheld
20	Storing the Tools
21	Emptying Your Vacuum Cleaner – Auto Empty
22	Bag Full Indicator – Emptying the Base Unit
23	Emptying Your Vacuum Cleaner – Manually
24	Cleaning the Filters – Removing the Cyclonic Filter
25	Cleaning the Filters – Washing the Cyclonic Filter
26	Cleaning the Filters – Reassembling the Cyclonic Filter
27	Cleaning the Filters – Vacuum Cleaner Outlet Hepa Filter
28	Cleaning the Filters – The Base Unit Internal Filter
29	Cleaning the Filters – The Base Unit Outlet Hepa Filter
30	Recommended Filter Cleaning Intervals
31	Care & Maintenance of Your Auto Empty Vacuum
31	Blockage Indicator
31	Repositioning the Aluminium Tube

Contents

32	Removing the Brush Roller for Cleaning
33	Technical Specification
34	Troubleshooting Guide
37	Removing the Battery
38	Customer Support
39	Recycling Information
39	Mains Plug Wiring Information
40	FSC and Safety Marks
41	Notes

Before using this product, please read through this manual paying careful attention to the safety instructions. Failure to do so may result in personal injury or damage to the product.

Carefully save this instruction manual for future reference. Ensure the user manual is included when passing the product on to any third parties.

Important Safety Instructions for Proper Use

When using electrical appliances, basic safety precautions should always be followed.

Only use the product as described in this user manual. Any other use is considered improper and may result in damage to property or persons.

The manufacturer or vendor cannot be held liable for damages or injury incurred through improper or incorrect use.





- Read and familiarise yourself with all operating instructions before using this Vacuum Cleaner.
- Before plugging your unit into the mains, visually check that the unit is intact and has not suffered any transit damage.
- Check that the voltage indicated on the data plate corresponds with that of the local network before connecting the appliance to the mains power supply.
- This appliance can be used by persons with reduced physical, sensory or mental capabilities or lack of experience and knowledge if they have been given supervision or instruction concerning use of the appliance in a safe way and understand the hazards involved.
- Children shall not play with the appliance.

- Keep the appliance and its cord out of reach of children less than 8 years when it is energised or cooling down.
- **DO NOT** immerse the appliance or its cord in water or any other liquids.
- **DO NOT** leave the appliance unattended during use.
- **DO NOT** leave the appliance unattended whilst connected to the mains supply.
- **DO NOT** use this appliance outdoors.
- It is imperative to unplug the power cord after the appliance has been used, before it is cleaned and whilst being repaired.
- Repairs to electrical appliances should only be performed qualified personnel. Improper repairs may place user at serious risk.
- **DO NOT** operate this appliance with a damaged plug or cord, after a malfunction or after being dropped or damaged in any way.
- Regular, periodic checks should be carried out on the mains cable to
 - ensure no damage is evident. Should there be any signs of damage the appliance should not be used.
 - If the power cable is damaged, it should only be replaced by the manufacturer or a suitable qualified after-sales-service in order to avoid a hazard
- **DO NOT** allow the mains cable to hang over sharp edges or come in contact with hot surfaces.
- Allow the unit to cool before storage.
- Before cleaning, disconnect the appliance from the mains supply and allow to cool.
- This appliance is intended for household use only and should not be used for industrial purposes.
- **DO NOT** use any accessories or attachments with this appliance other than those supplied or recommended by supplier.

- **DO NOT** use this appliance for anything other than its intended use.
- **DO NOT** push objects into any openings as damage to the appliance and/or electric shock may occur.
- Unplug after each use. Grasp the plug, not the cord.
- **DO NOT** pull or carry the Vacuum Cleaner by the electrical cord, use the handle provided.
- Ensure fingers and other objects are never placed in any part of the vacuum cleaner. Baging or hair may become trapped if the vacuum is used improperly.
- Keep hair, loose clothing, jewellery, fingers and all parts of the body away from openings and moving parts.
- Keep all air vents clear and free of dust, lint, hair and anything else that may reduce airflow.
- Avoid directing the appliance towards naked flames as the air discharged may extinguish gas fires or pilot lights and may disturb ashes in open fires.
- **DO NOT** Vacuum water or any other liquids with this vacuum.
- **DO NOT** Vacuum hot ashes or lit cigarettes, etc.
- Never use the appliance without the filter in place.
- **DO NOT** use the Vacuum without the Dust Compartment fitted.
- **DO NOT** vacuum any large or broken objects such as glass.
- **DO NOT** vacuum anything that is burning or smoking such as cigarettes, matches or hot ashes.

Explanation of Symbols

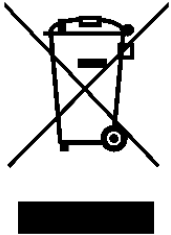
The following warning symbols or words are used in this instruction manual:

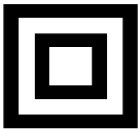
	<p>Products labelled with UK Conformity Assessment identifies products conforming to UK statutory requirements</p>
	<p>Products labelled with this symbol conform to applicable provisions of the European Economic Area.</p>
	<p>This symbol means batteries and rechargeable batteries may not be disposed of with household waste! As the end user you are required by law to bring all batteries and rechargeable batteries to a collection point run by the Local Authority or to a retailer, so that they can be disposed of in an environmentally friendly manner.</p>
	<p>You should now recycle your waste electrical goods and in doing so help the environment. This symbol means waste electrical products at the end of their useful life should not be disposed of with normal household waste and not sent to landfill. Please ensure it is taken to a suitable facility for disposal. Check with your Local Authority or retailer for recycling advice or visit www.recycle-more.co.uk or www.weeeireland.ie enter your postcode to find out your nearest recycling site.</p>
	<p>This symbol indicates that the supply uses an alternating current mains supply.</p>
 WARNING!	<p>This designates a hazard with moderate risk, which may result in severe injury or damage to the product if not adhered to.</p>
	<p>This symbol indicates that the product is class II and is double insulated and therefore does not require an earth connection.</p>

What's In the Box

- Stick Vacuum Cleaner
- Auto Empty Base Unit
- Battery
- Floor Tool
- Upholstery Brush Tool
- Crevice Tool
- Turbo Brush Tool
- Disposable Dust Bag
- Instruction Manual

Description of Parts – Charging Dock/Auto Empty Unit

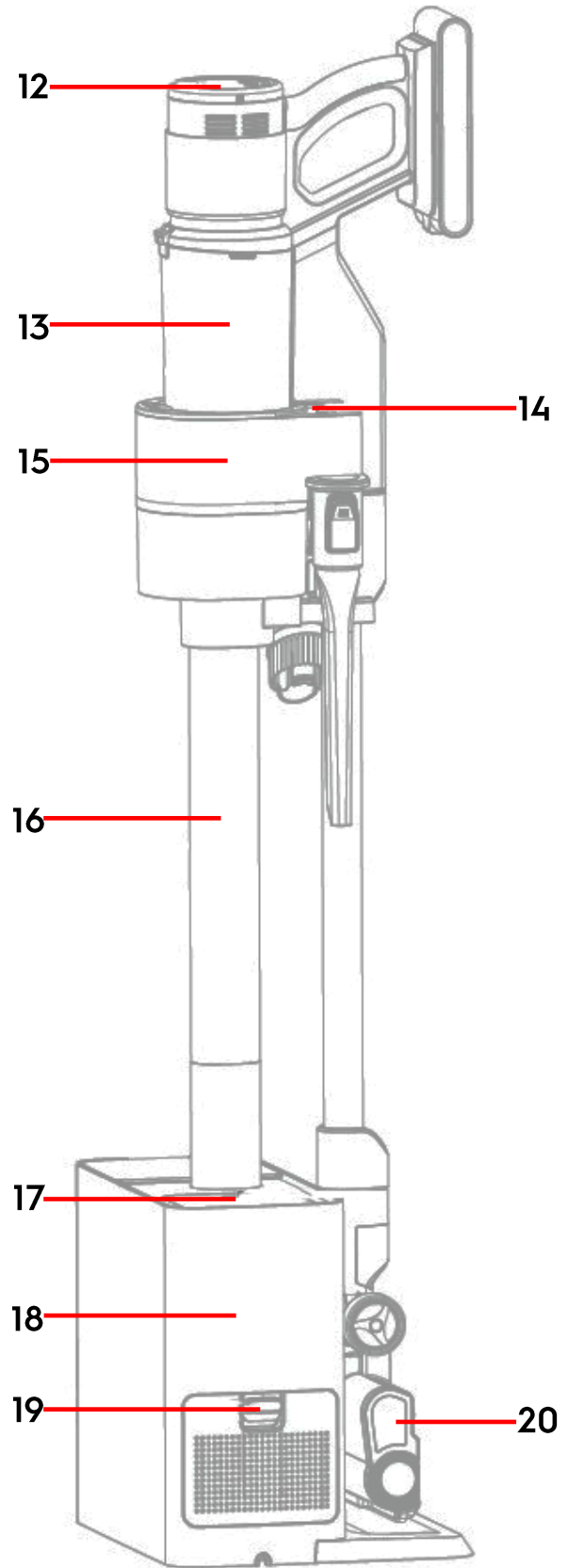
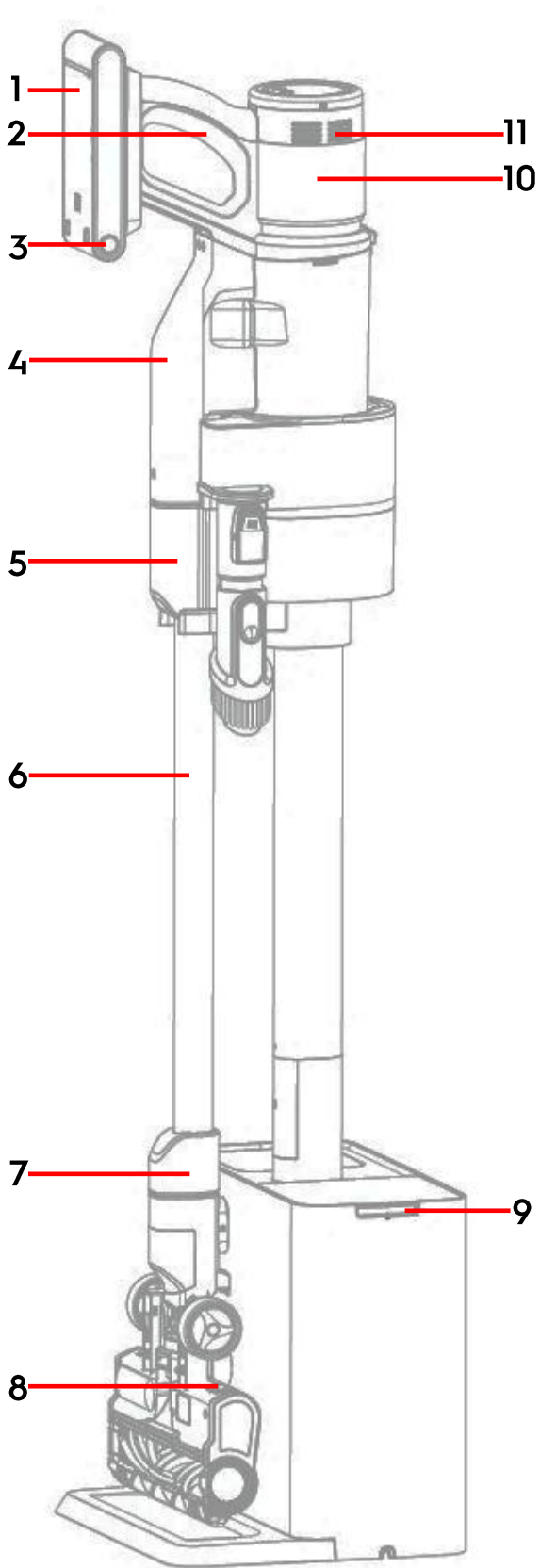

Description of Parts – Charging Dock/Auto Empty Unit

- | | |
|-------------------------------|-----------------------------------|
| 1. Battery Pack | 11. Air Outlet |
| 2. Handle | 12. Control Panel |
| 3. Battery Release Button | 13. Dust Compartment |
| 4. Vacuum Main Body | 14. Auto Empty Button |
| 5. Upper Tube Connector | 15. Charging Dock |
| 6. Aluminium Tube | 16. Base Unit Tube |
| 7. Lower Tube Connector | 17. Base Unit Bag Full Indicator |
| 8. Floor Brush Release Button | 18. Base Unit |
| 9. Dust Cover Catch | 19. Base Unit Outlet Filter Catch |
| 10. Motor Unit | 20. Floor Tool |

Included Tools & Accessories

- 21. Upholstery Brush Tool
- 22. Crevice Tool
- 23. Turbo Brush Tool
- 24. Disposable Dust Bag

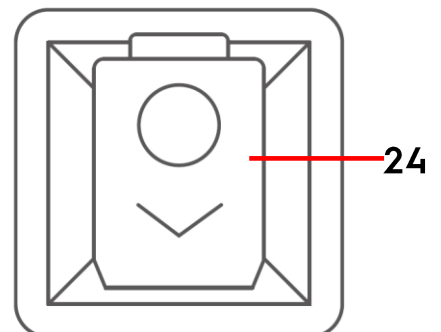
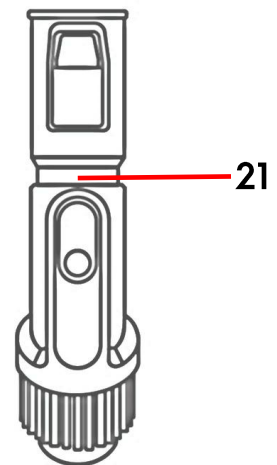
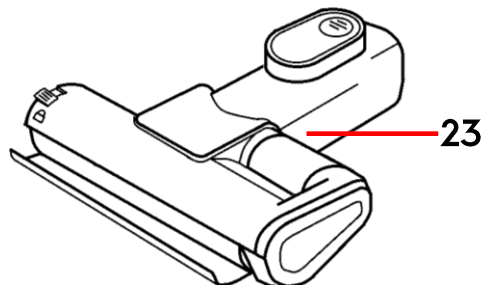
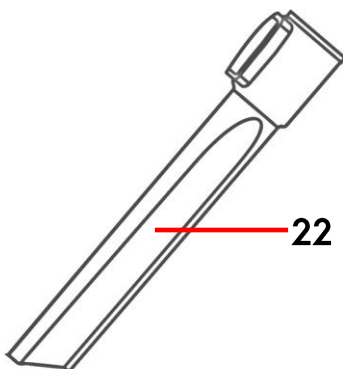

Description of Parts – Vacuum Cleaner Control Panel (12)

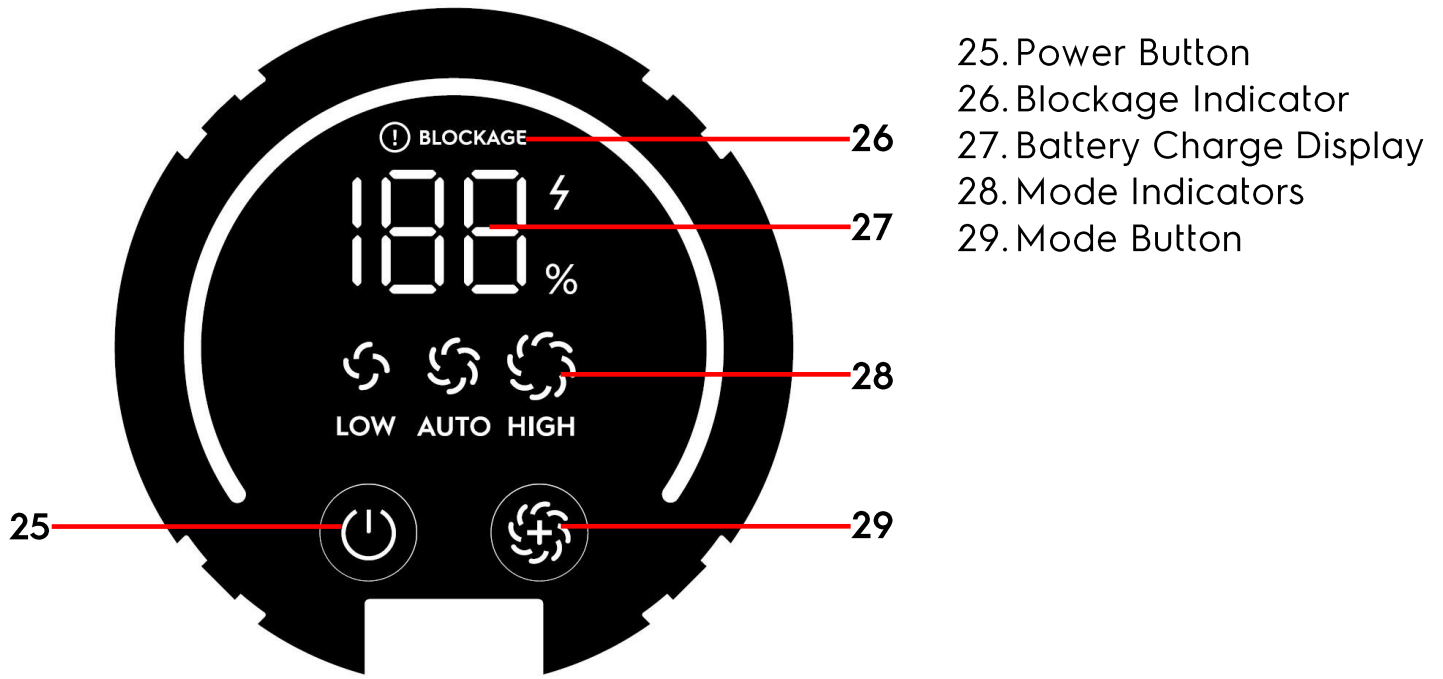

Before First Use of Your Auto Empty Vacuum Cleaner

- Before use, retain all packaging until all the parts are present against the parts list – see **Description of Parts & Accessories** above.
- Take care whilst opening the carton as a sharp blade may damage the product.
- After which discard packaging responsibly.

Assembling the Vacuum Cleaner

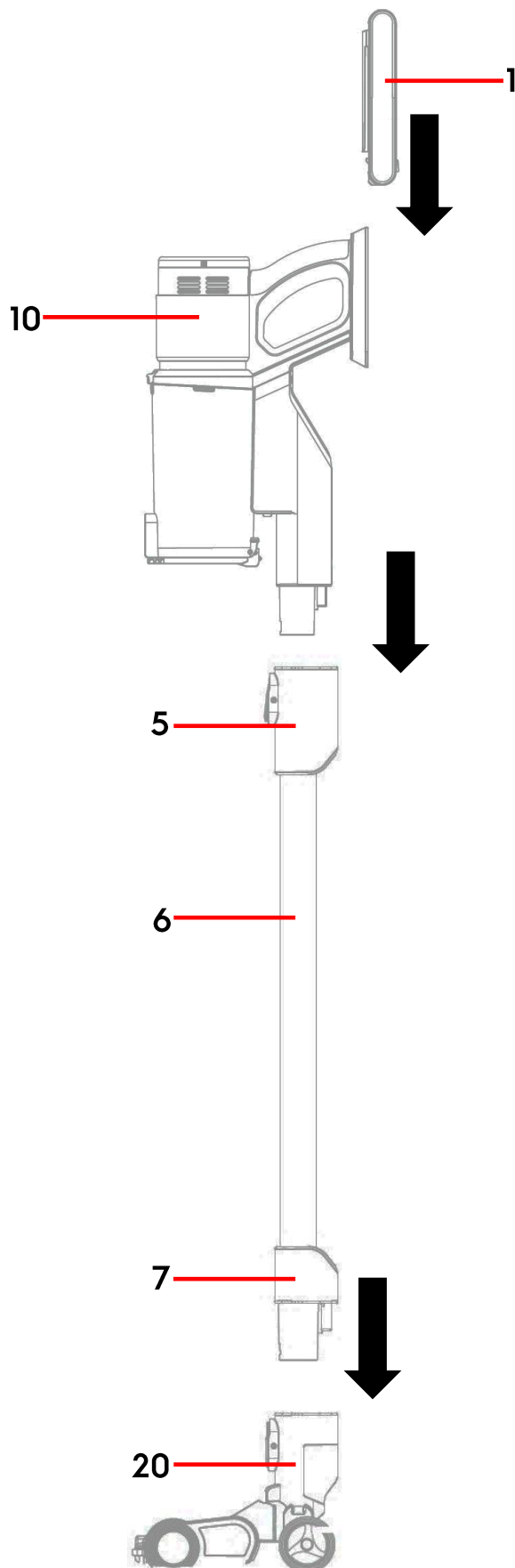

Slide the **Battery (1)** onto the **Motor Unit (10)** until it clicks into place.

NB To remove the **Battery (1)**, press the **Battery Release Button (3)**

Attach the **Aluminium Tube (6)** as follows:

Push the **Motor Unit (10)** into the **Upper Tube Connector (5)** until it clicks into place.

NB Press the button on the **Upper Tube Connector (5)** to remove the **Motor Unit (10)**.

Insert the **Low Tube Connector (7)** into the **Floor Tool (20)** until it clicks into place.

NB To remove the tool from the **Aluminium Tube (6)**, Press the button on the **Floor Tool (20)** and remove.

Assembling the Base Unit

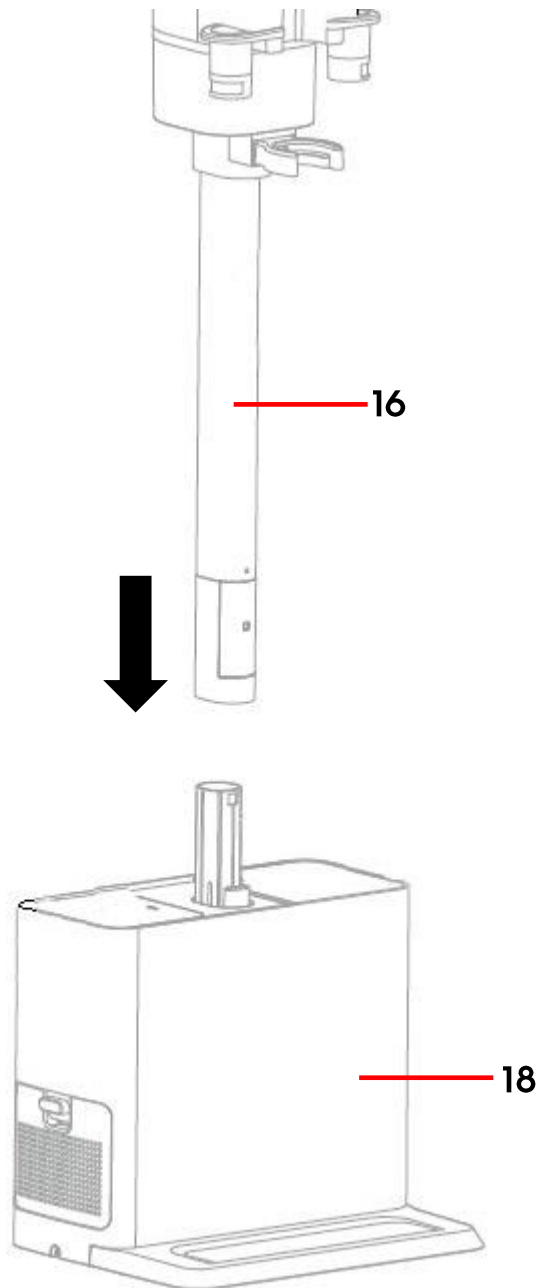

Push the **Base Unit Tube** (16) onto the **Base Unit** (18) as shown left until it clicks into place.

Charging the Battery

Before use, ensure that the rechargeable **Battery** (1) is fully charged as follows:

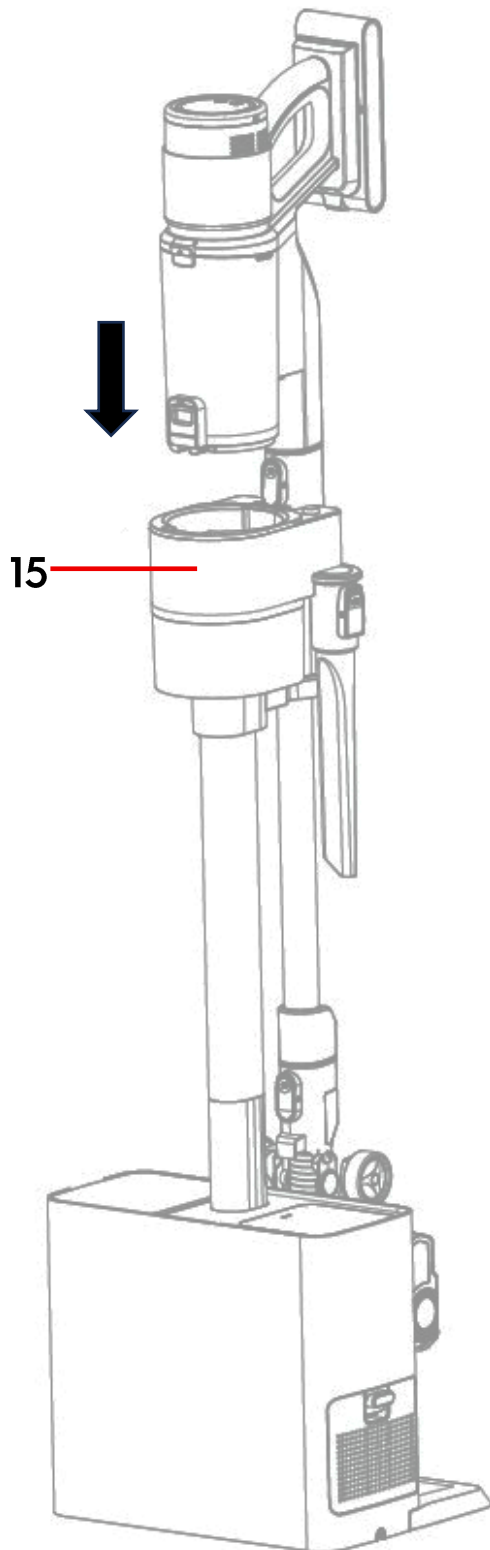

Left:

Place the **Base Unit** (18) in a convenient place that is solid, level and near to a mains socket outlet.

Hook the vacuum cleaner onto the **Charging Dock** (15) until it clicks into place.

Insert the mains plug of the **Base Unit** (18) into the nearest socket, as below:

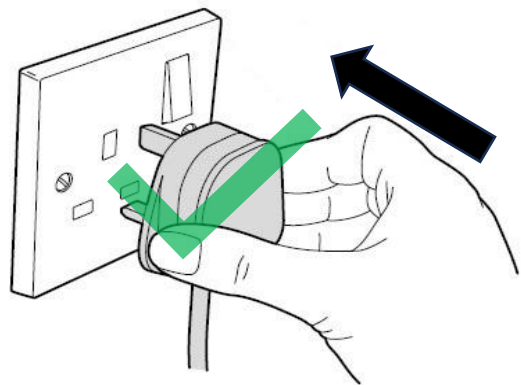

Charging the Battery

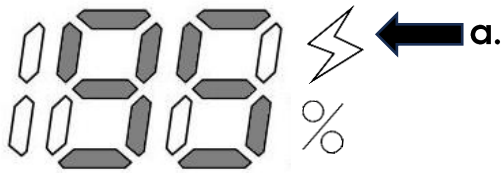

Left:

The **Charging Indicator** (a) will illuminate and the **Battery** (1) will begin to charge.

The **Battery Charge Display** (27) will illuminate showing the amount of charge in the **Battery** (1) in percent (95% in the example shown).

1. Once the **Battery** (1) is fully charged (after approximately 4-6 hours), the **Battery Charge Display** (27) will show '100' indicating that the battery is 100% fully charged and the vacuum can be removed from the **Charging Dock** (15) and used.
2. During use, the **Battery Charge Display** (27) will count down, as the display approaches 10% the **Charging Indicator** (a) will flash red indicating that the battery is low needs recharging as above.

NB Please note, the vacuum cleaner will not operate whilst it is mounted on the **Charging Dock** (15).

Using Your Vacuum Cleaner

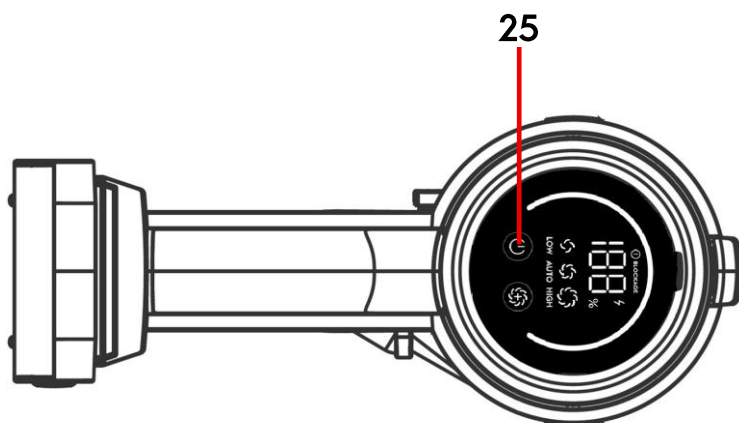

Lift the vacuum off the **Charging Dock (15)**.

Hold the vacuum by the **Handle (2)**.

Press the **Power Button (25)** on the **Control Panel (12)** once to switch the vacuum on.

Place your foot gently on the **Floor Tool (20)** and pull the cleaner back by the **Handle (2)** to start vacuum cleaning.

Press the **Power Button (25)** once again to switch the vacuum off.

Changing the Suction Modes

Press the **Mode Button (29)** on the **Control Panel (12)** repeatedly to select from:

LOW/AUTO/HIGH suction modes.

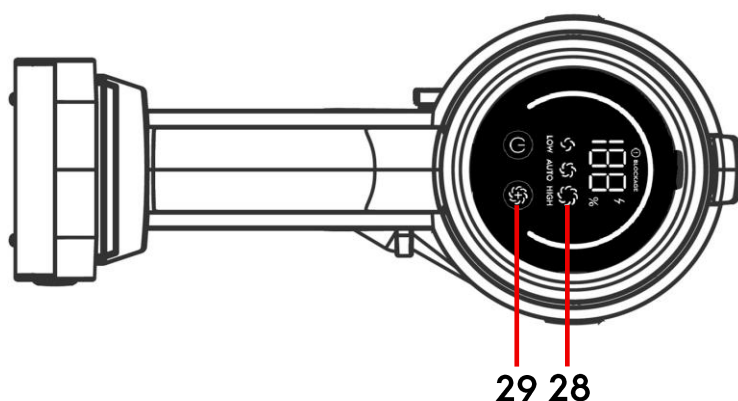

The select Mode will be shown by the **Mode Indicators (28)**:

LOW - the longest cleaning time.

AUTO - Varies the power according to the floor being cleaned.

HIGH - the high power setting is used for deep cleaning.

Attaching the Tools

Removing the Floor Tool

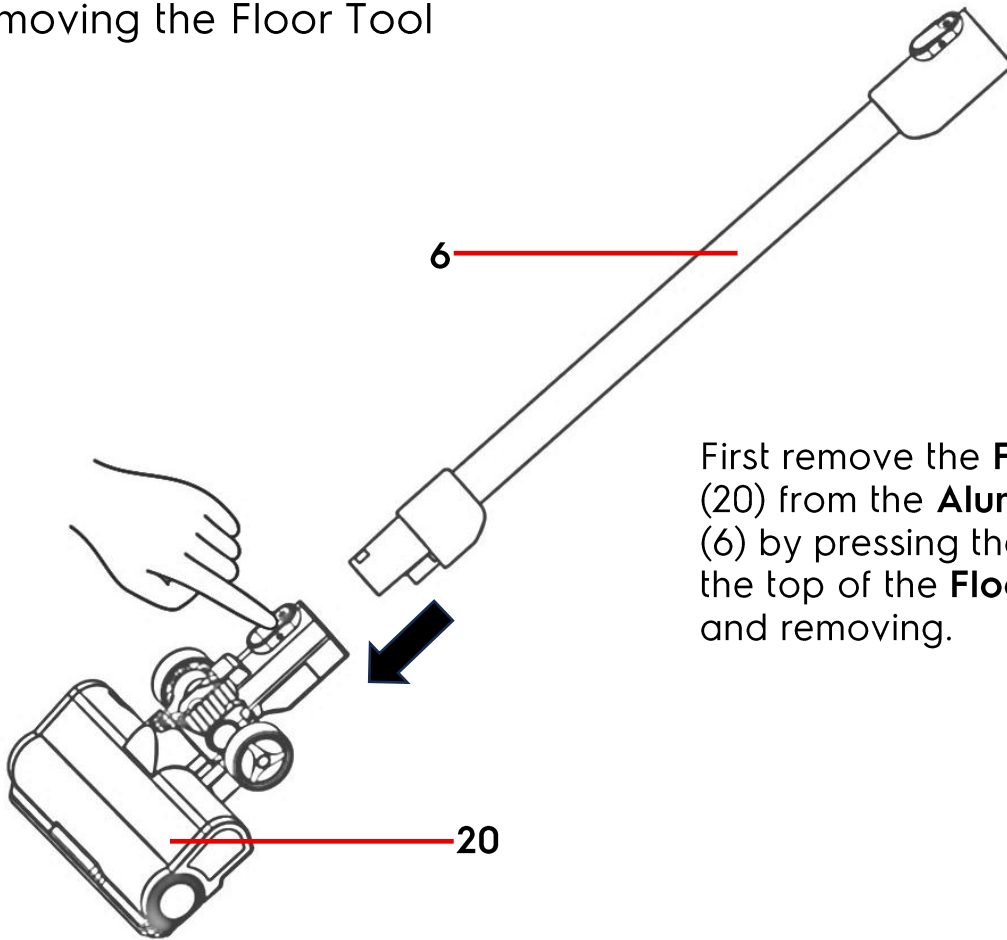

First remove the **Floor Tool** (20) from the **Aluminium Tube** (6) by pressing the button on the top of the **Floor Tool** (20) and removing.

Attaching the Upholstery Brush Tool

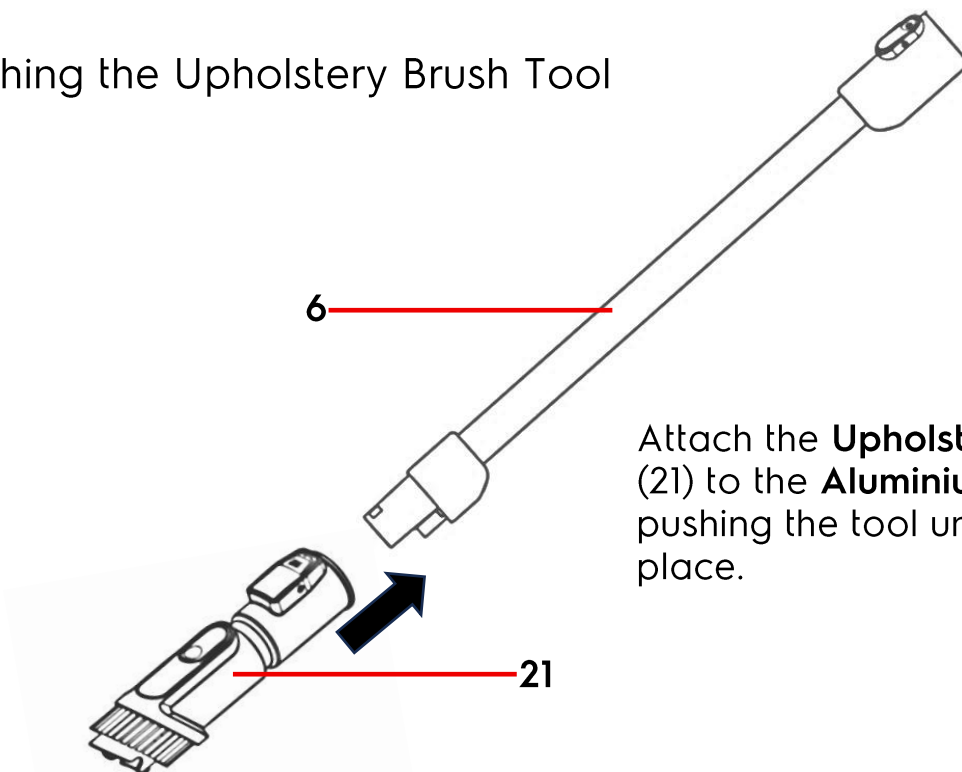

Attach the **Upholstery Brush Tool** (21) to the **Aluminium Tube** (6) by pushing the tool until it clicks into place.

Attaching the Tools

Attaching the Crevice Tool

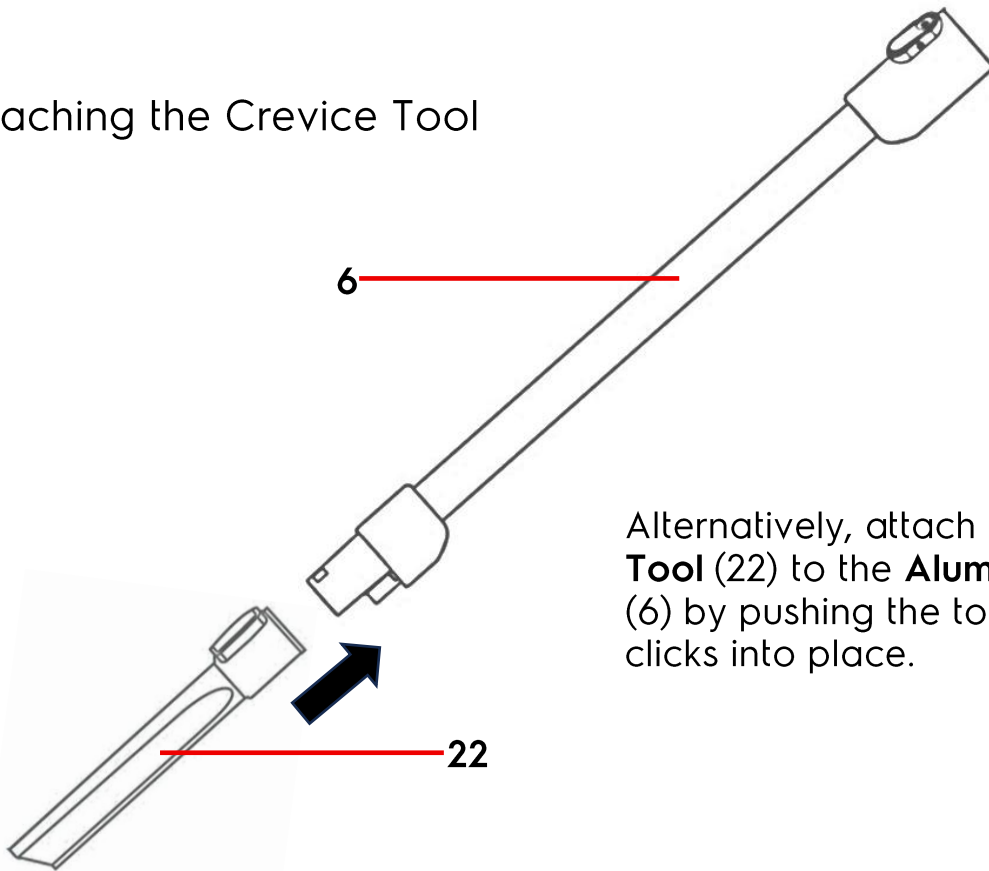

Alternatively, attach the **Crevice Tool (22)** to the **Aluminium Tube (6)** by pushing the tool until it clicks into place.

Attaching the Turbo Brush Tool

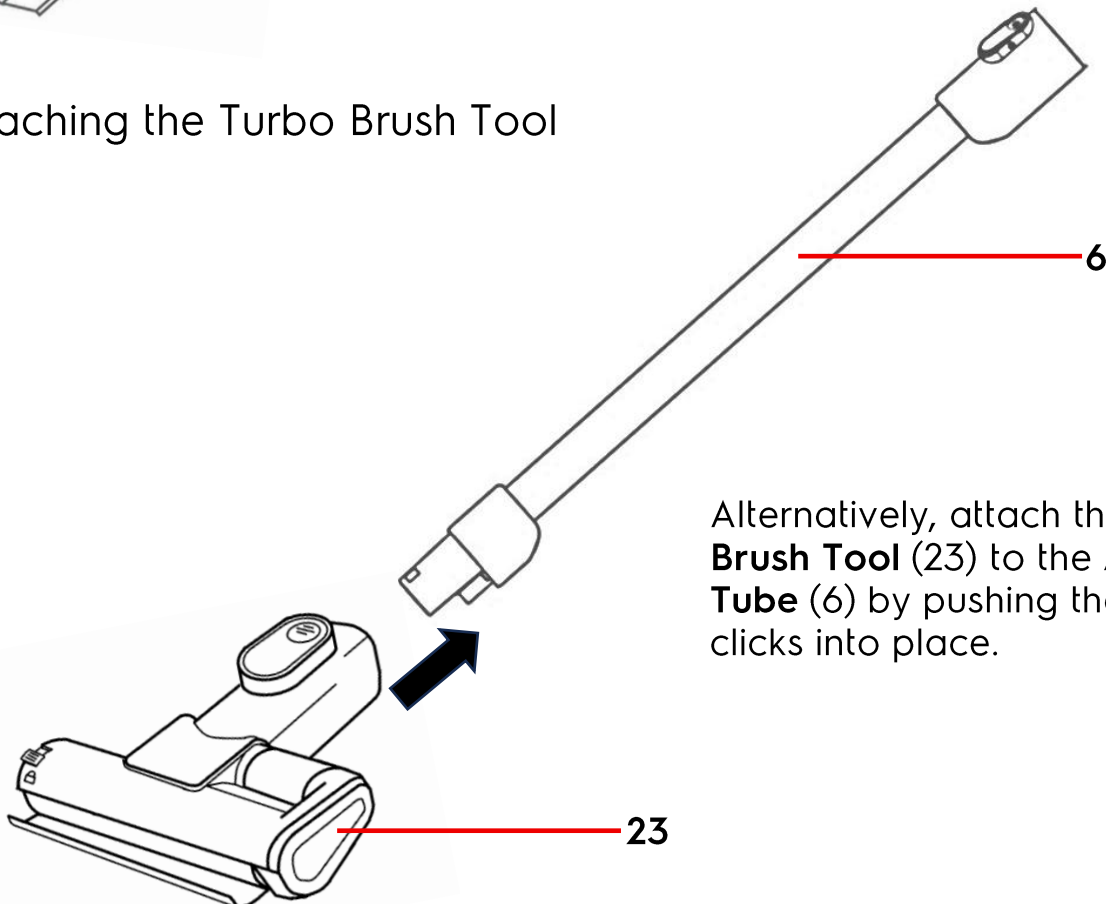

Alternatively, attach the **Turbo Brush Tool (23)** to the **Aluminium Tube (6)** by pushing the tool until it clicks into place.

Using the Vacuum Handheld

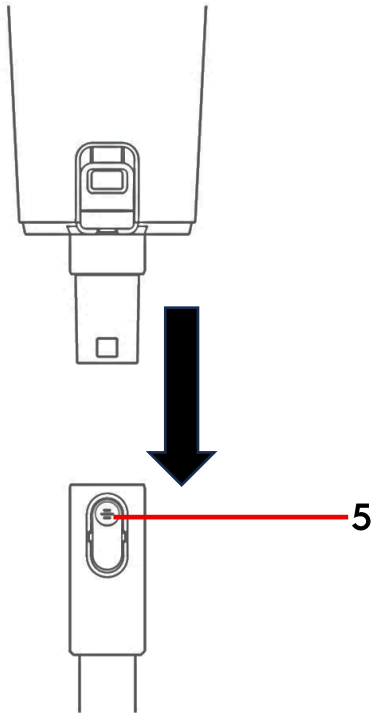

First, remove the **Aluminium Tube (6)** from the **Motor Unit (10)** by pressing the button on **Upper Tube Connector (5)** and removing the tube.

Attach the **Upholstery Brush Tool (21)** directly to the **Motor Unit (10)** as shown. Push the tool until it clicks into place.

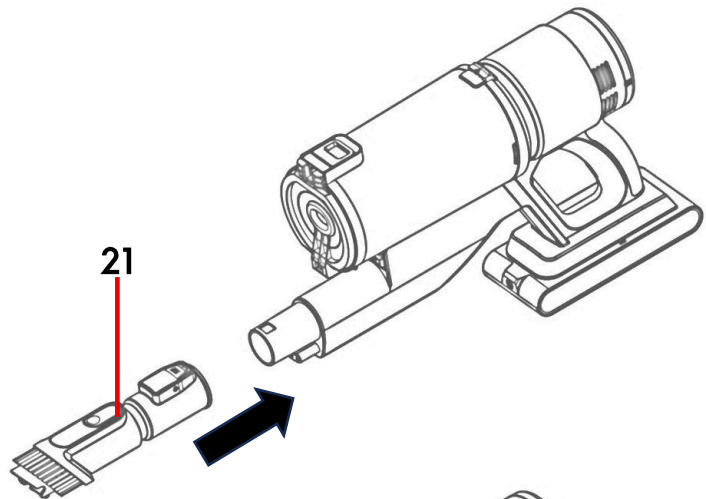

Alternatively attach the **Crevice Tool (22)** directly to the **Motor Unit (10)** as shown. Push the tool until it clicks into place.

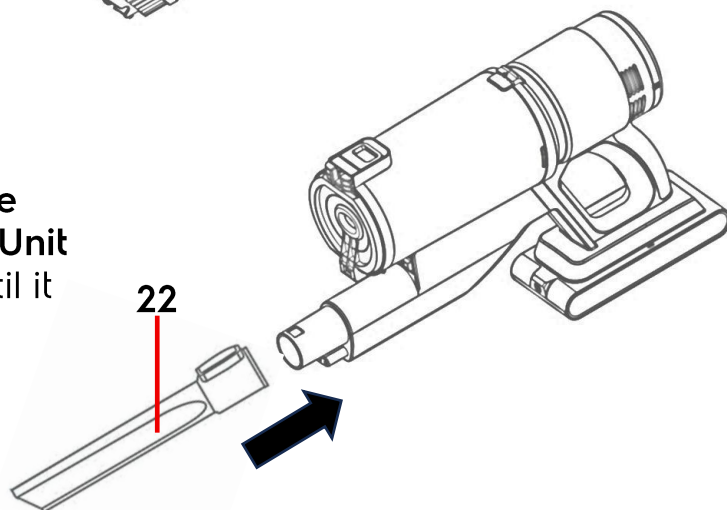

NB The **Floor Tool (20)** or the **Turbo Stair Brush (23)** can also be attached directly to the **Motor Unit (10)** also.

Storing the Tools

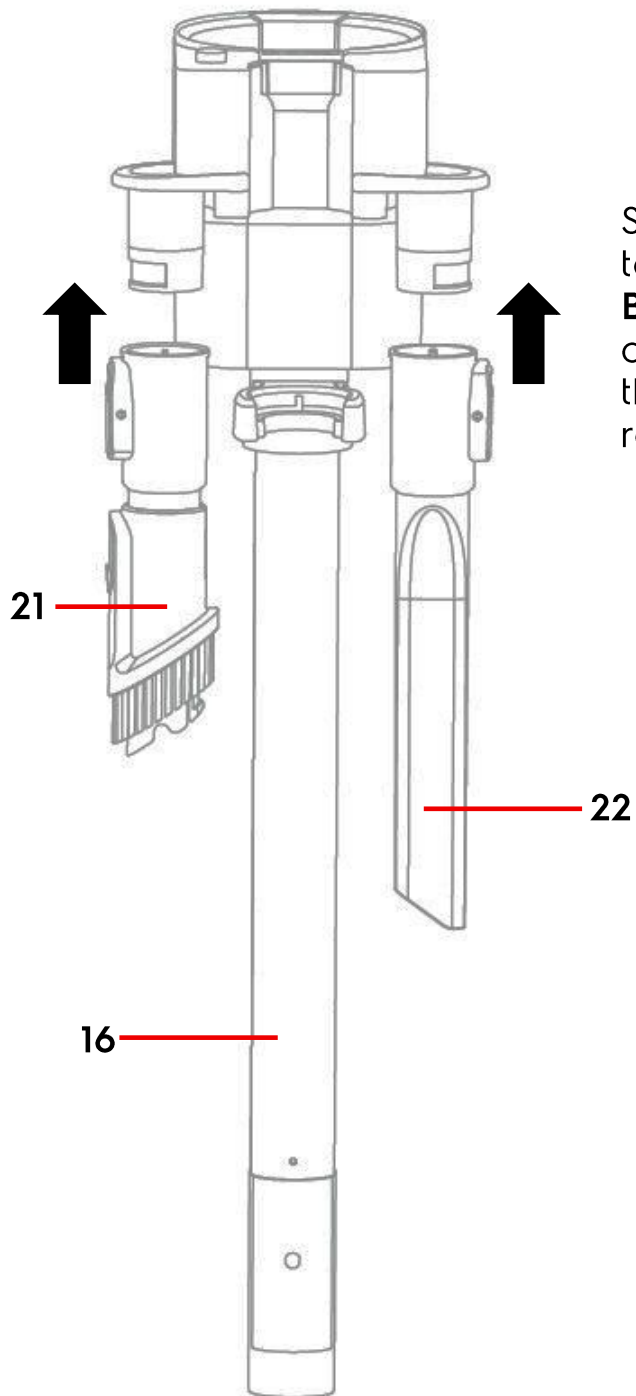

Store the tools when not in use in the tool storage section at the top of the **Base Unit Tube** (16). Press the buttons on the tools to remove them and push the tools back in place until they click to replace them.

Emptying Your Vacuum Cleaner – Auto Empty

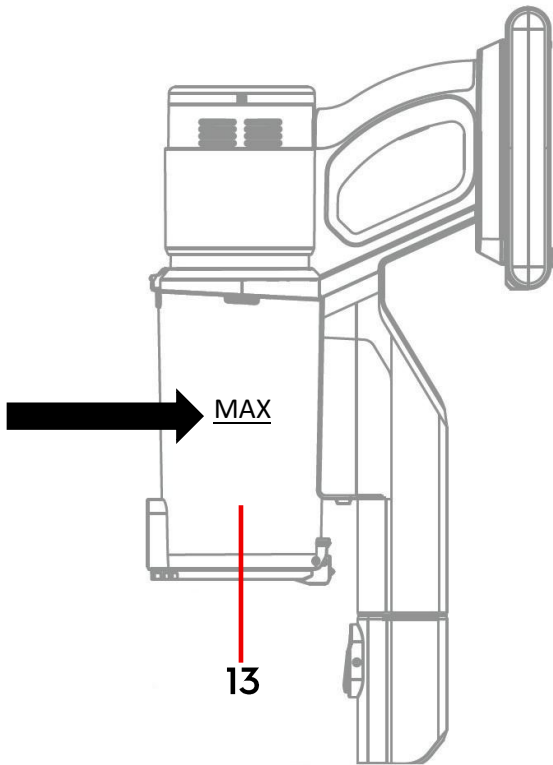

Once the **Dust compartment** (13) fills to the 'MAX' level shown arrowed left, it will require emptying.

⚠ WARNING! DO NOT continue to use your vacuum cleaner above the **Maximum Fill Level** shown arrowed above as permanent damage may occur to the appliance.

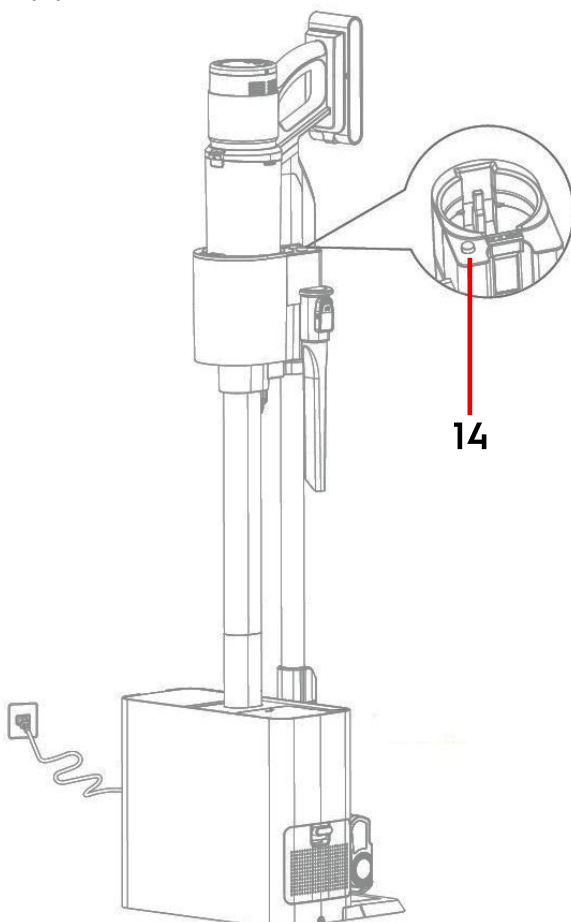

Hook the vacuum cleaner onto the **Charging Dock** (15) until it clicks into place.

Ensure the Mains Plug is inserted into the Mains Socket.

Press the **Auto Empty Button** (14) shown left.

The **Base Unit** (18) internal vacuum will run for 20 seconds to empty and clean the vacuum cleaner, after which the **Base Unit** (18) will stop.

NB the **Battery** (1) will not charge whilst the Auto Empty function is being used.

Bag Full Indicator (17) – Emptying the Base Unit

Once the **Base Unit Bag Full Indicator** (17) illuminates, the **Dust Bag** (b) inside the **Base Unit** (18) will require replacing as follows:

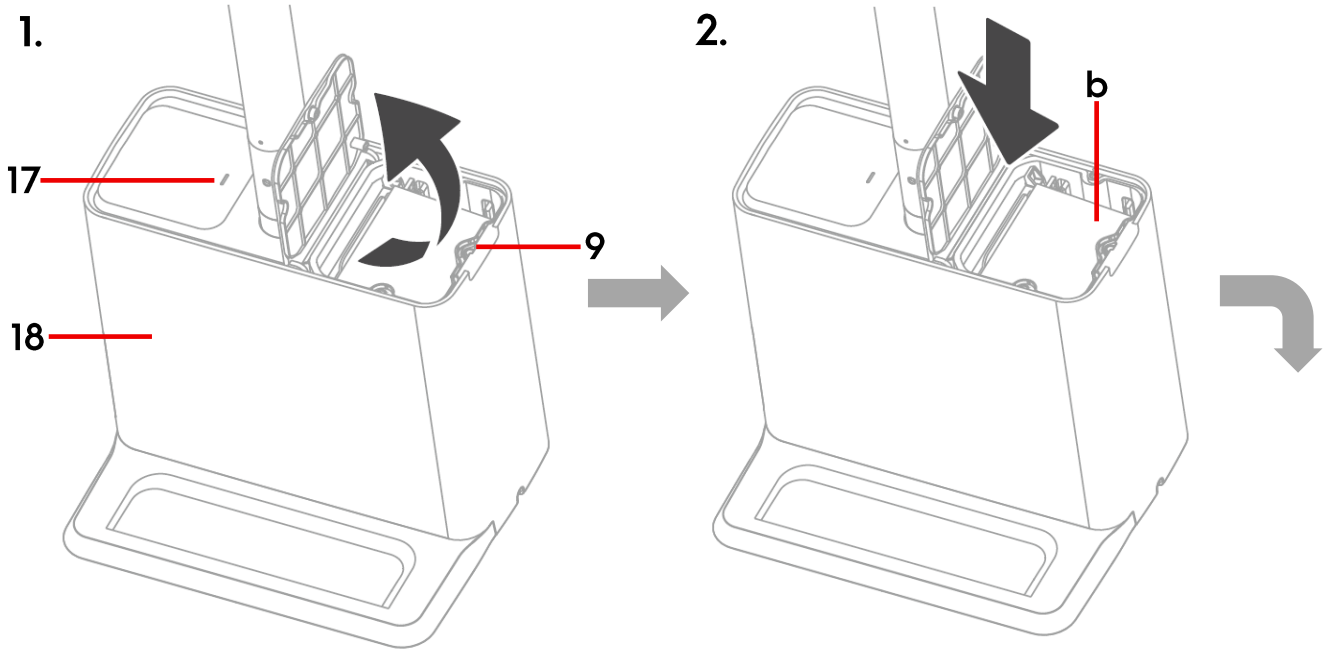

1. Open the dust compartment on the **Base Unit** (18) using the **Dust Cover Catch** (9)

2. Grasp the tab (arrowed above) on the **Dust Bag** (b)....

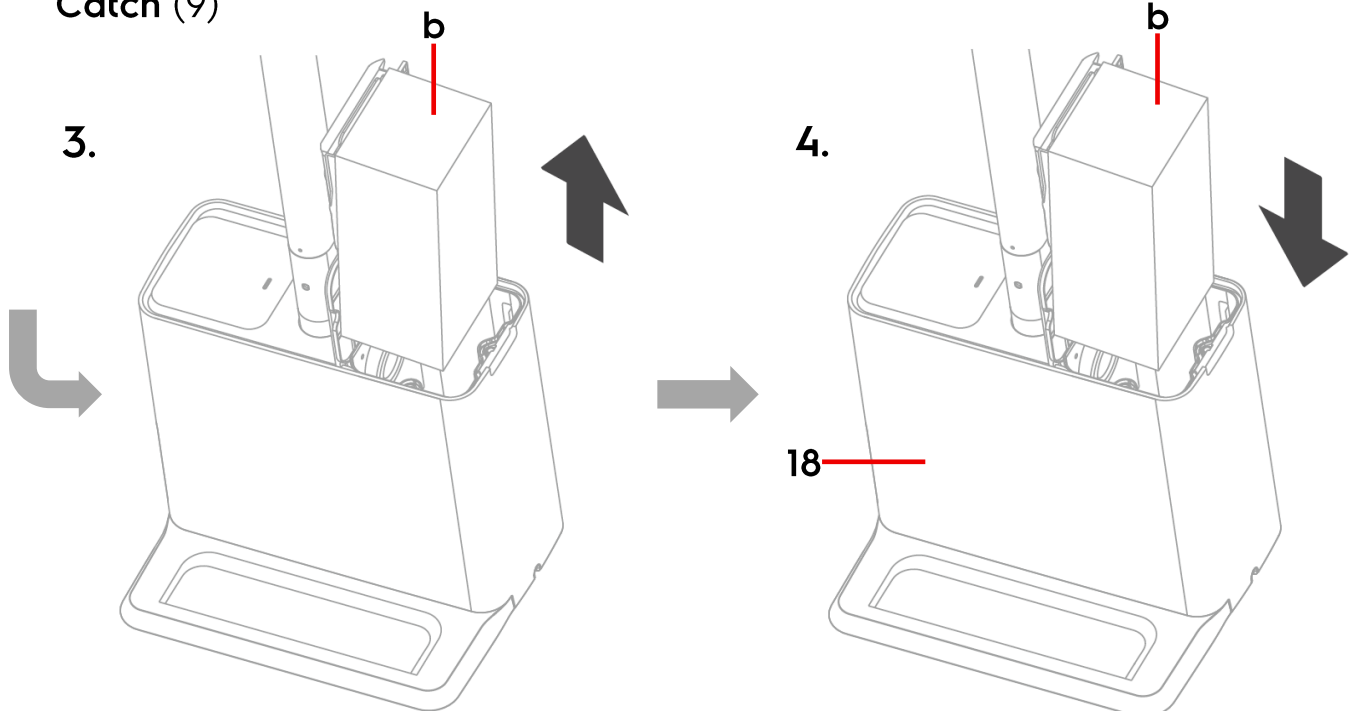

3.and pull the **Dust Bag** (b) upwards and dispose.

4. Insert a replacement **Dust Bag** (b) into the **Base Unit** (18) ensuring the tab locates in the runners as shown above.

Emptying Your Vacuum Cleaner – Manually

To empty the cleaner, hold the vacuum cleaner **Dust Compartment** (13) over a dust bin and slide the **Dust Release Catch** (c - arrowed right) upwards and the base of the dust compartment will swing open and allow the collected dust to fall out into the dust bin.

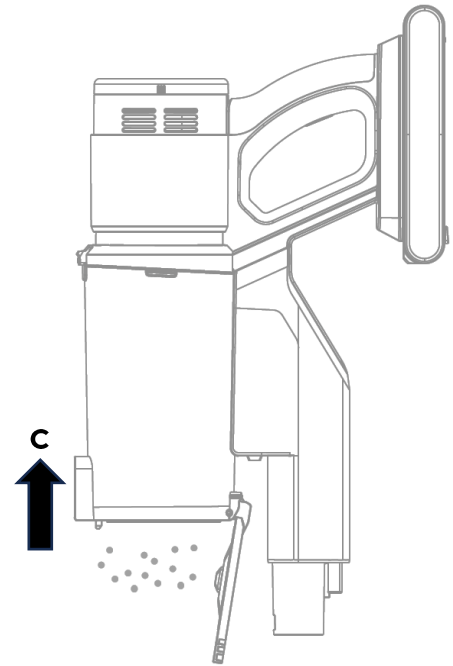

Cleaning the Filters – Removing the Cyclonic Filter

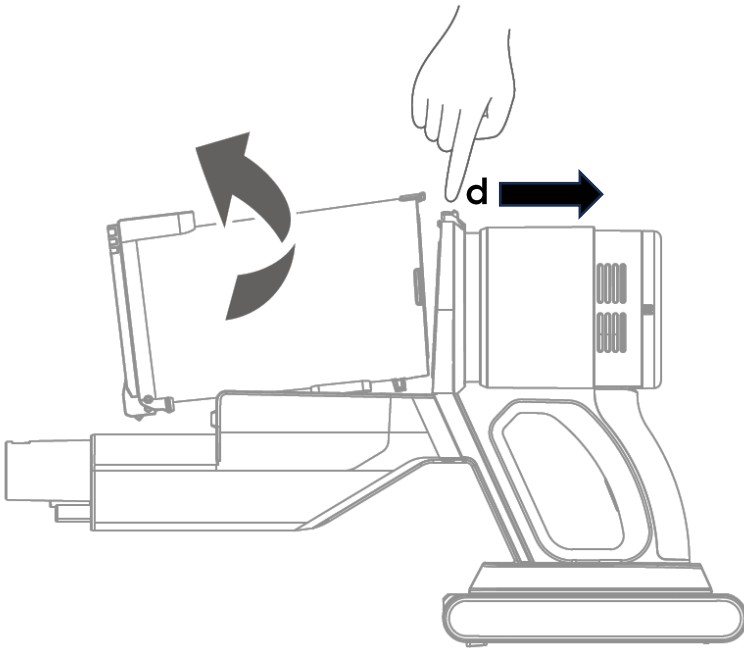

Slide the Vacuum Cleaner **Dust Compartment Release Catch (d)** in the direction of the arrow and lift off the **Dust Compartment (13)**.

Remove the **Cyclonic Filter (f)** out of the **Dust Compartment (13)** in the direction of the arrow shown right:

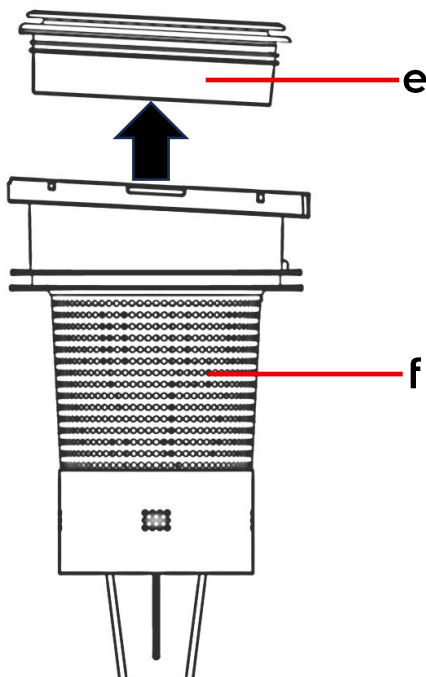
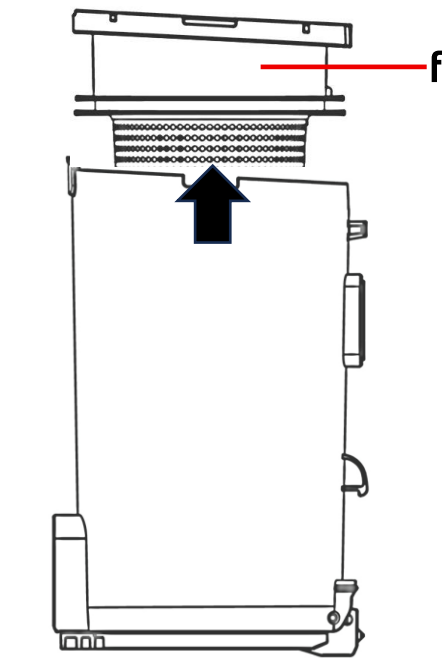

Lift the **Cotton/Sponge Filter (e)** out of the **Cyclonic Filter (f)**

Cleaning the Filters – Washing the Cyclonic Filter

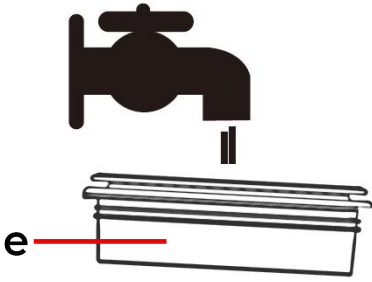

Wash the **Cotton/Sponge Filter** (e) in warm running water until clean. Allow the filter to dry thoroughly for at least 24 hours before reuse.

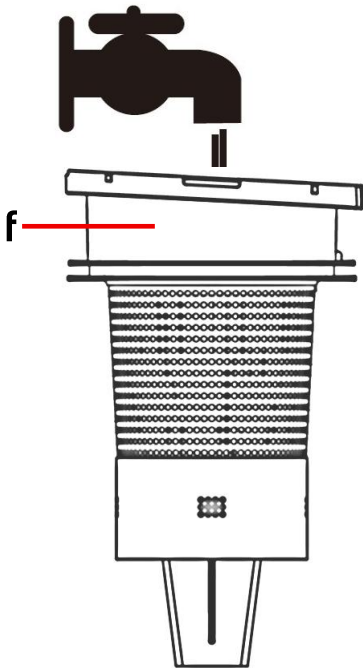

Shake the excess dirt from the **Cyclonic Filter** (f) and wash in warm running water until clean. Allow the filter to dry thoroughly for at least 24 hours before reuse.

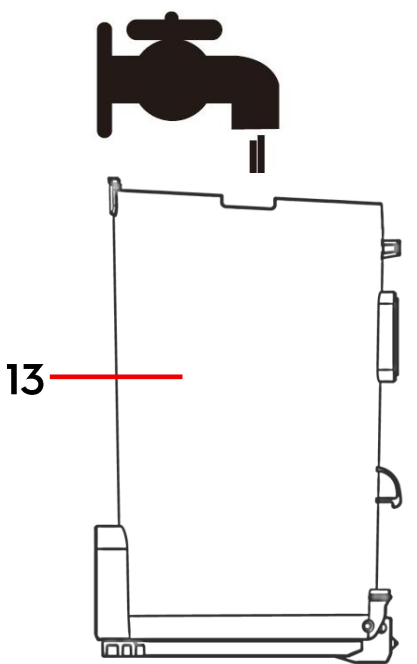

Shake the excess dirt from the **Dust Compartment** (13) after each use. Rinse in warm running water until clean once a month. Allow to dry thoroughly for at least 24 hours before reuse.

Cleaning the Cyclonic Filter – Reassembling the Cyclonic Filter

Once the filters have dried, re-assemble the filter into the **Dust Compartment (13)** as shown below:

Insert the **Cotton/Sponge Filter (e)**.....

.....into the **Cyclonic Filter (f)**

Insert the **Cyclonic Filter (f)** into the **Dust Compartment (13)** as shown right:

Re attached the **Dust Compartment (13)** to the vacuum.

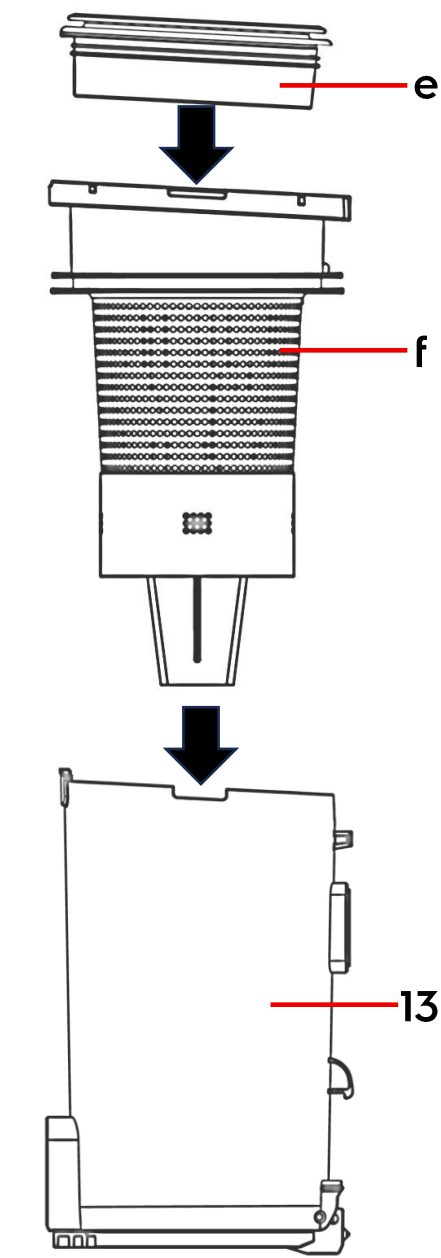

Cleaning the Filters – The Vacuum Cleaner Outlet Hepa Filter

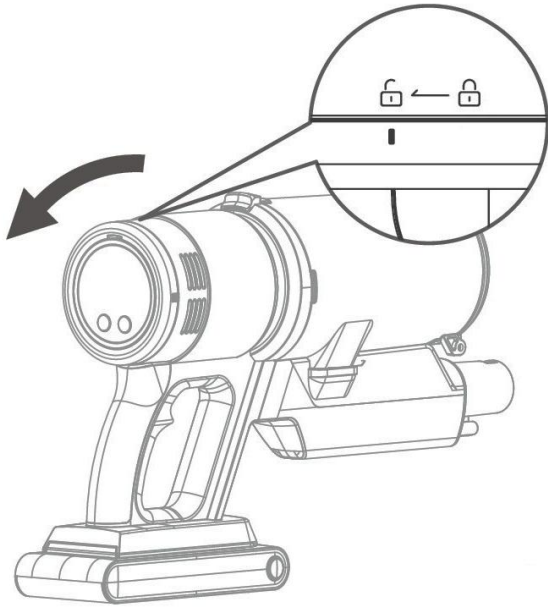

Rotate the ring on the outside edge of the **Control Panel (12)** to the unlocked position as shown left:

Open the door behind the **Control Panel (12)**.

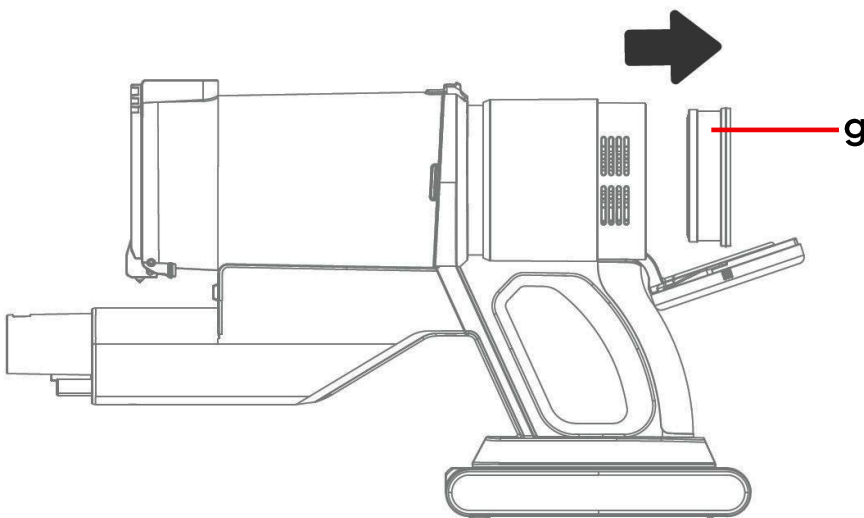
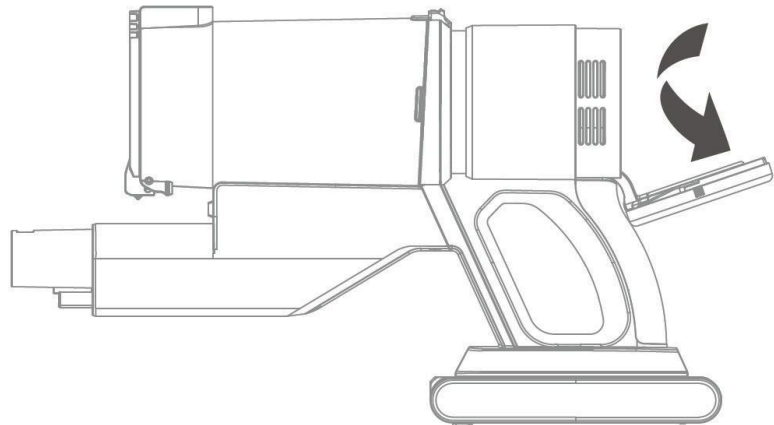

Remove the **Outlet Hepa Filter (g)** and wash in warm running water until clean. Allow the filter to dry for at least 24 hours before reuse.

Cleaning the Filters – The Base Unit Internal Filter

Before removing the **Internal Filter (h)**, first remove the **Base Unit (18)** and **Dust Bag (b)** – see page 22: **Bag Full Indicator (17) – Emptying the Base Unit.**

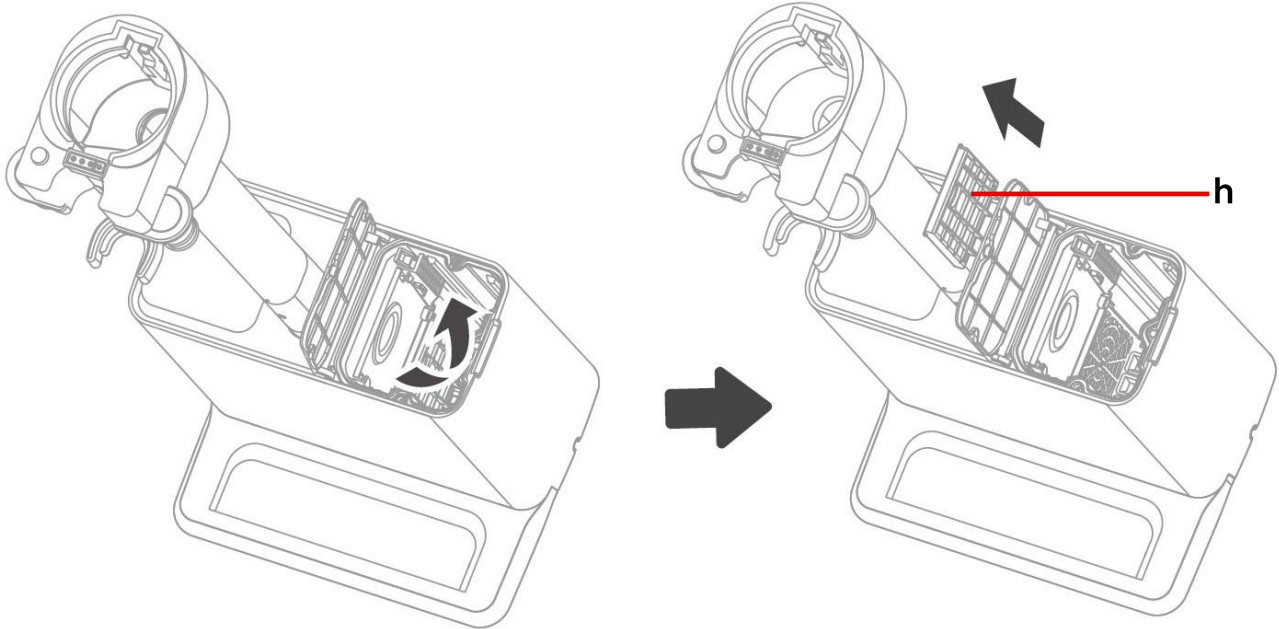

1. Open the dust compartment on the **Base Unit (18)** using the **Dust Cover Catch (9)**

2. Pull the **Internal Filter (h)** up by the grip in the holder (see below) and remove.

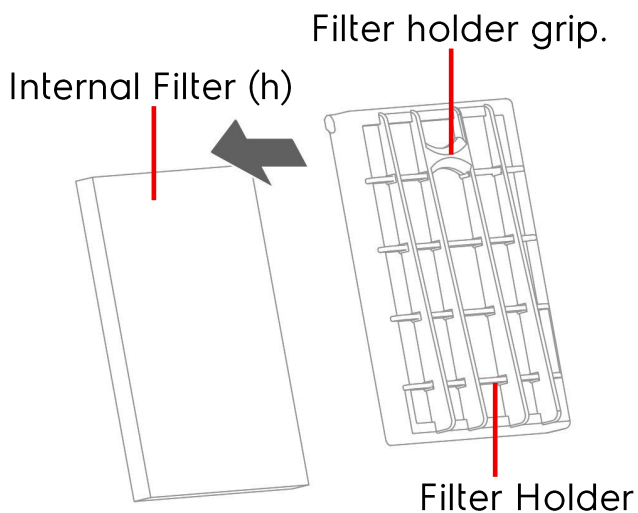

3. Remove the filter from the filter holder.

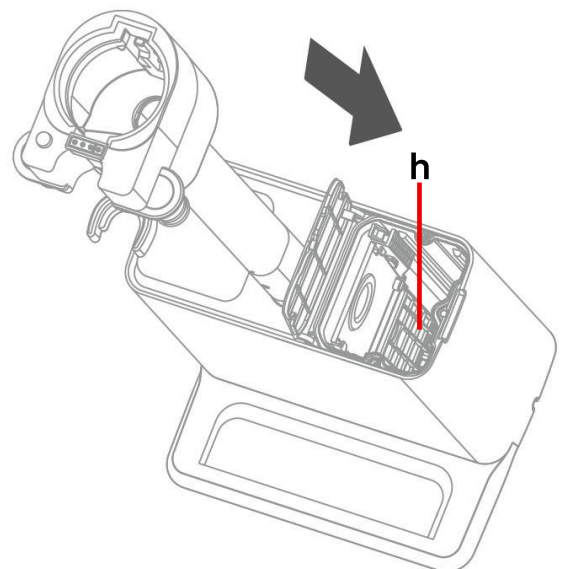

4. Replace the filter back into the holder and slide back into the Base Unit as shown above.

Cleaning the Filters – The Base Unit Outlet Hepa Filter

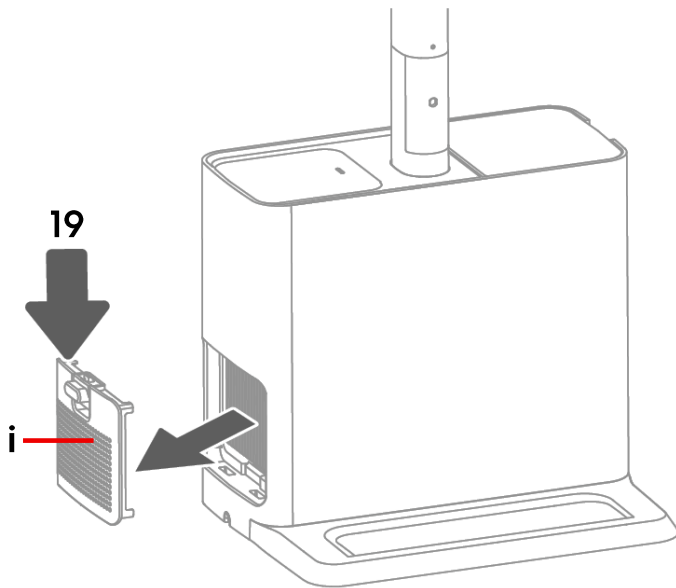

1. Open the **Outlet Filter Cover** (i - above) by pushing the **Base Unit Outlet Filter Catch** (19) down.

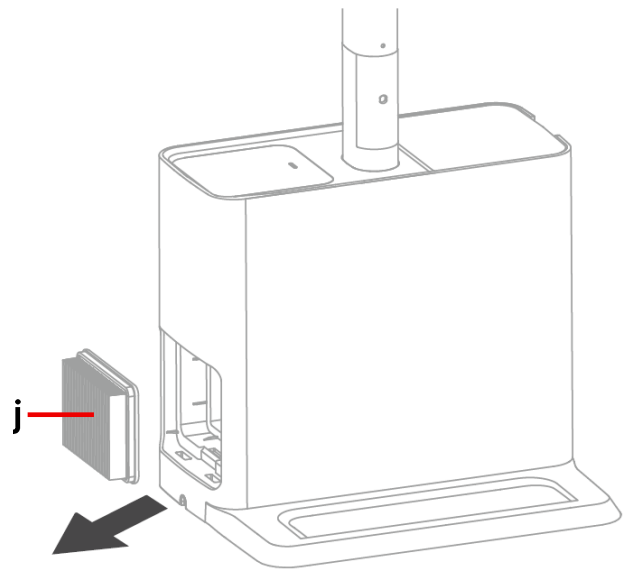

2. Lift the latch at the base of the **Hepa Filter** (j) and remove the filter.

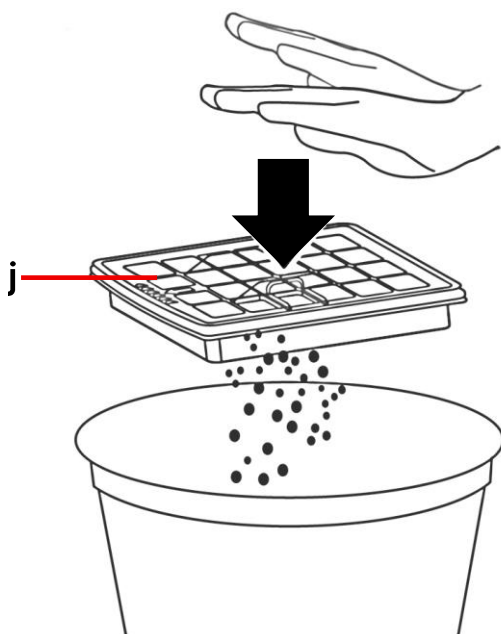

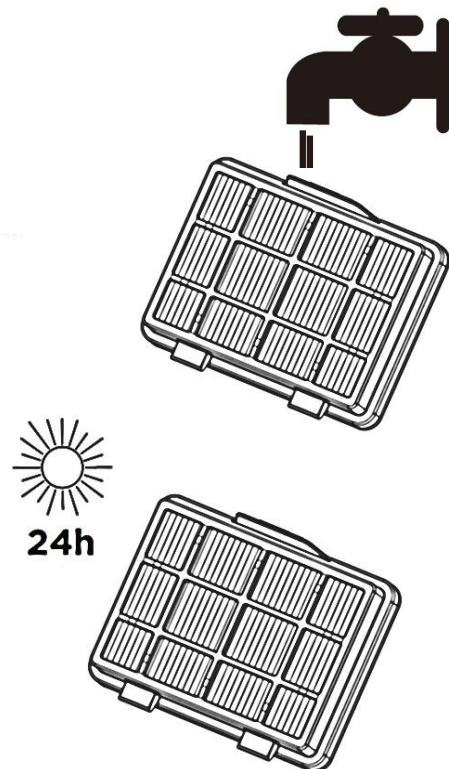

4. Tap out any loose dust and dirt from the **Hepa Filter** (j) over a waste bin.

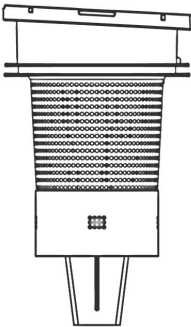
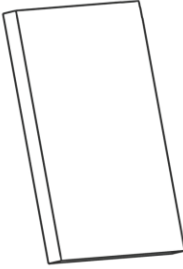

3. Wash the **Hepa Filter** (j) in warm running water until clean. Allow the filter to dry for at least 24 hours before refitting it to the **Base Unit** (18).

Recommended Filter Cleaning Intervals

Filter Type	Recommended cleaning period
<p>Cotton/Sponge Filter (e)</p> 	<ul style="list-style-type: none"> • Shake out debris when you empty the dust compartment. • Rinse under warm water once a month • Allow to dry thoroughly for at least 24 hours before use.
<p>Cyclonic Filter (f)</p> 	<ul style="list-style-type: none"> • Shake out debris when you empty the dust container. • Rinse under warm water once a month • Allow to dry thoroughly for at least 24 hours before use.
<p>Base Unit Internal Filter (h)</p> 	<ul style="list-style-type: none"> • Shake out debris once a month • Rinse under warm water once a month. • Allow to dry thoroughly for at least 24 hours before reuse.
<p>Base Unit Outlet Filter (i)</p> 	<ul style="list-style-type: none"> • Shake out debris once a month • Rinse the Hepa filter under warm water once every 3-6 months • Allow to dry thoroughly for at least 24 hours before reuse.
<p>Vacuum Outlet Hepa Filter (g)</p> 	<ul style="list-style-type: none"> • Shake out debris once a month • Rinse the Hepa filter under warm water once every 3-6 months • Allow to dry thoroughly for at least 24 hours before reuse.

⚠ WARNING! Ensure the filters are cleaned periodically according to the table above, failure to clean the filters regularly will severely impair the performance and permanent damage may occur to the appliance which may invalidate your warranty.

Care and Maintenance of Your Auto Empty Vacuum Cleaner

- Always disconnect the cleaner from the Charging Station before cleaning.
- Clean outside of the cleaner with a clean damp cloth. Never clean with harsh or abrasive cleaners.
- Do not submerge the cleaner or its charger in water or any other liquids.
- Empty the Dust Compartment as soon as it has reached maximum capacity (see above).*
- Clean the all the filters regularly – see table below.
- Allow the filters to thoroughly dry out for at least 24 hours before reassembly and reuse.

* **⚠ WARNING! DO NOT** continue to use your vacuum cleaner once the **Dust Compartment (13)** is full as permanent damage may occur to the appliance.

Blockage Indicator (26)

If the Blockage Indicator flashes red during cleaning, the vacuum is either blocked and/or very dirty and therefore restricting airflow. Switch the vacuum off and clean the Filters, Tubes and Accessories before continuing to use the vacuum.

Repositioning of the Aluminium Tube (6)

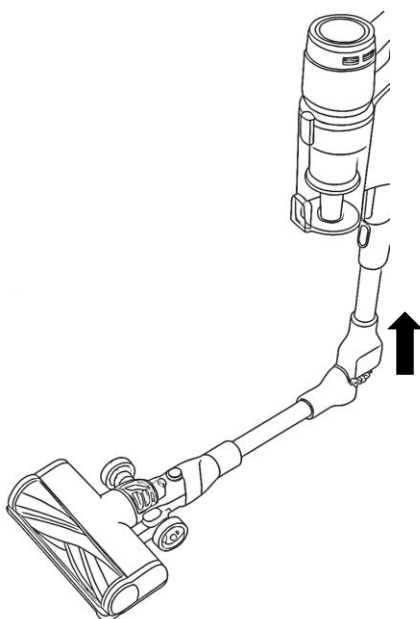

Lift the top housing at the centre joint in the direction of the arrow to allow the **Aluminium Tube (6)** to bend. This enables the cleaner to reach low and difficult to get at areas.

Removing the Brush Roller for Cleaning

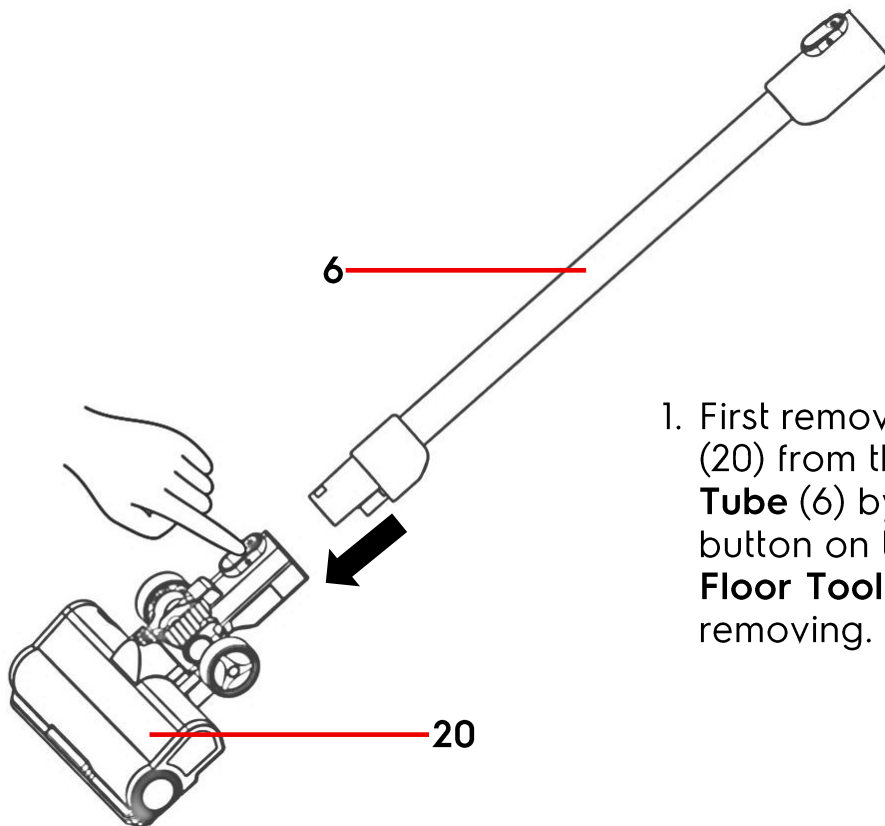

1. First remove the **Floor Tool (20)** from the **Aluminium Tube (6)** by pressing the button on the top of the **Floor Tool (20)** and removing.

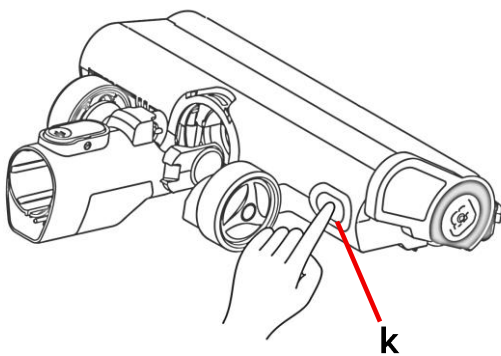

2. Press the **Roller Release** button (k) as shown above and lift the side of the **Floor Tool (20)** up.

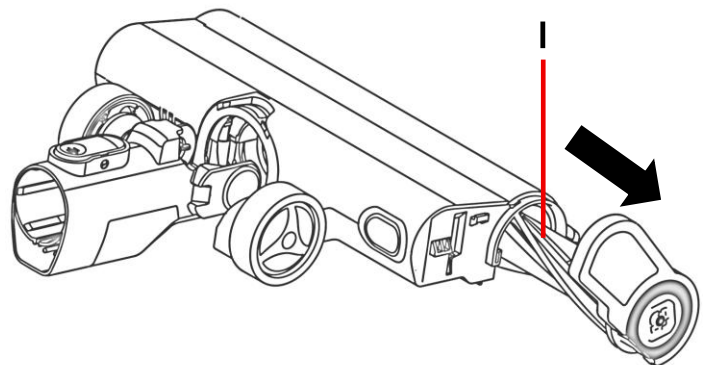

3. Pull the **Roller Brush (l)** sideways out of the **Floor Tool (20)**.

4. Replacing the **Roller Brush (l)** is the reverse procedure shown above. However, when inserting the **Roller Brush (l)** rotate it back and forth a little until it engages with the drive gear inside the **Floor Tool (20)**.

Technical Specification

Model Number	FLR00207
Auto Empty Unit	
Rated Voltage	220-240V ~ 50-60Hz 0.5A Output: 33.2V DC 500mA 20W
Rated Power	1100W
Dust Capacity	3L (Net 2.3L)
Protection Class II	This product is double insulated and therefore does not require an earth connection.
Cordless Vacuum	
Battery	29.6V (2500mAh Li-Ion cells x8)
Charging Time	4-6hrs
Rated Voltage	29.6V DC
Rated Power	600W
Motor Type	BLDC
Run Time	10/25/60MIN (High/Medium/Low Speeds)
Noise	84/78/76dB
Dust Compartment Capacity	0.5L
Vacuum	22-25kpa
ErP: Power consumption of equipment in standby mode shall not exceed 0.50W	0.4W
This equipment complies with Annex III of Commission Regulation (EU) 2023/826	

Troubleshooting Guide

Problem	Possible Cause	Possible Solution
Unit fails to turn on.	Internal battery not charged. The charger is not plugged into the mains socket.	Charge the internal battery. Ensure the charger is fully inserted into the socket and the socket is switched on.
Low suction or poor pick-up.	Dust Compartment is full. Filters are clogged. Low Power Selected	Empty the cylinder. Check and clean the filters. Check the Min/Max Power Button.
The vacuum is making a "hissing" sound.	The airflow is restricted	Empty the Dust Compartment. Check and clean the filters. Clear any blockages if necessary.
BLOCKAGE Indicator (26) Flashing Red	Vacuum is blocked and/or very dirty	Switch off and remove the blockage and clean filters, tubes and accessories thoroughly.

Troubleshooting Guide

To clear any blockages from the **Base Unit** (18), follow the below procedure:

2. Remove the **Base Unit Tube** (16) by pushing in the **Catch** (m) in with a small screwdriver, etc. and pulling the tube upwards and removing.
1. Place the Handheld vacuum against the top of the **Base Unit** (18) and select the High Speed Vacuum mode to clear any blockage.

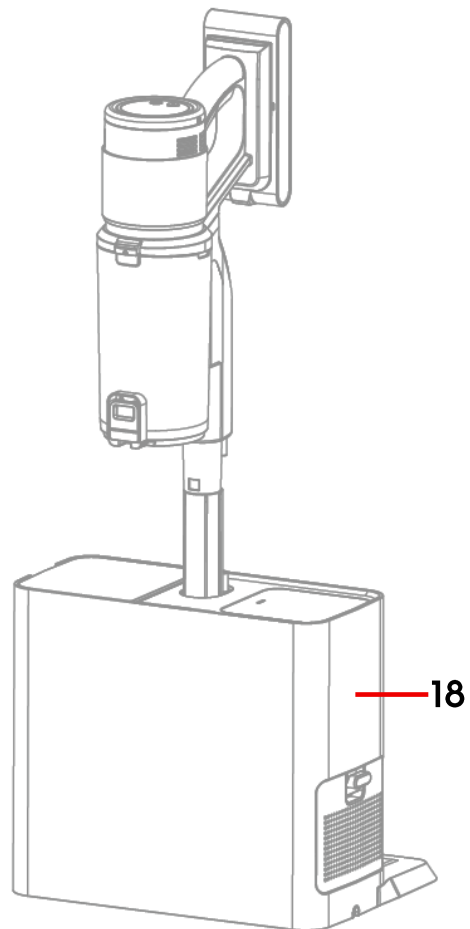
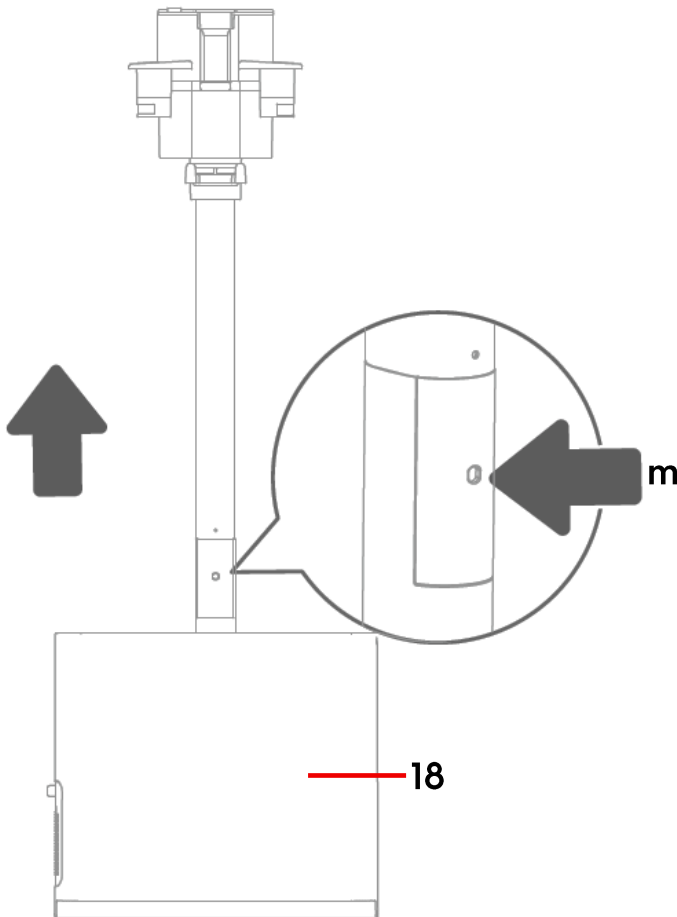

Troubleshooting Guide

To clean the **Base Unit** (18) from excess dust, etc. follow the below procedure:

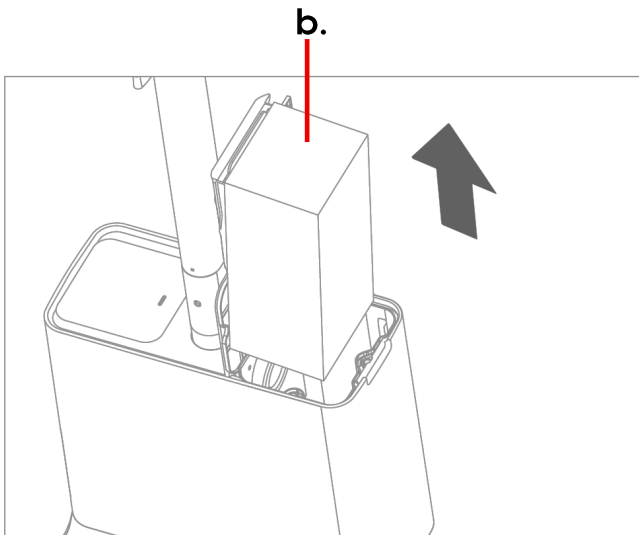

3. Remove the **Dust Bag** (b.) from the **Base Unit** (18).

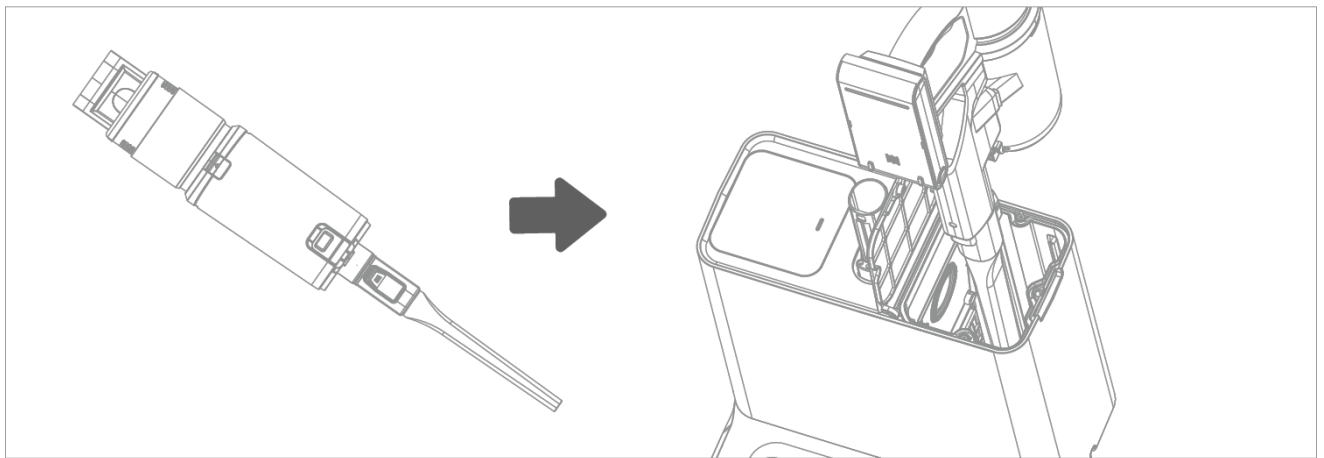

4. Attach the **Crevice Tool** (22) to the **Motor Unit** (10) and clean out the inside of the **Base Unit** (18).

Removing the Battery

To remove the **Battery (1)**, press the button and slide the battery in the direction of the arrow as shown below:

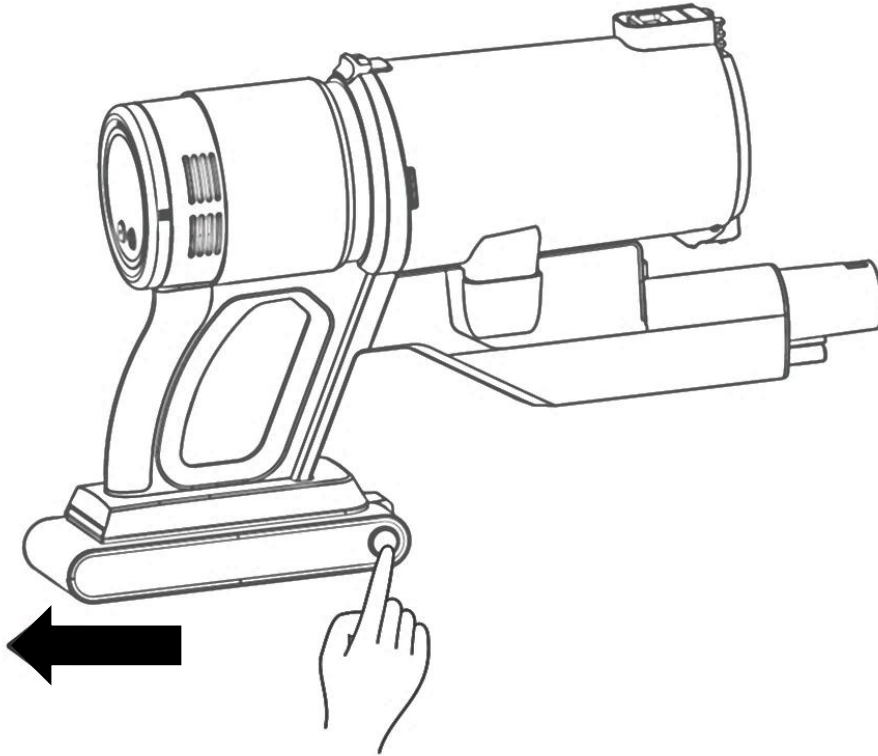

Should you require any product information, replacement parts or accessories, please contact our customer care team on 0161 831 7879 (8.30am-4.30pm Monday to Thursday, 8.00am-4.00pm Friday) and select option 3 or by contacting us via email:

help@electroluxsmalldomesticappliance.co.uk

- Replacement parts and accessories are guaranteed for 1 year from the date of purchase.
- It is important to note that your warranty becomes invalid should non Electrolux parts or accessories be used with this appliance.

Recycling Information

Disposal of the Packaging

Dispose of paper and cardboard in appropriate paper re-cycling facilities.

Dispose of recyclable plastics in appropriate plastic re-cycling facilities.

Dispose of non-recyclable plastics in the appropriate plastics collection service.

Disposal of the Product

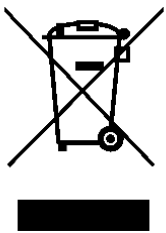

You should now recycle your waste electrical goods and in doing so help the environment. This symbol means waste electrical products at the end of their useful life should not be disposed of with normal household waste and not sent to landfill. Please ensure it is taken to a suitable facility for disposal. Check with your Local Authority or retailer for recycling advice or visit www.recycle-more.co.uk or www.weeeireland.ie enter your postcode to find out your nearest recycling site.



This symbol means batteries and rechargeable batteries may not be disposed of with household waste!
As the end user you are required by law to bring all batteries and rechargeable batteries to a collection point run by the Local Authority or to a retailer, so that they can be disposed of in an environmentally friendly manner.

Mains Plug Wiring Information

If your appliance is supplied with a non-rewireable plug fitted to the mains lead and should the fuse needed replacing, you must use an ASTA approved one (conforming to BS 1362 of the same rating). Never use a plug with the fuse cover missing. If in doubt, consult a qualified electrician.

If you need to remove the plug **-DISCONNECT FROM THE MAINS-** and then cut it off the mains lead and immediately dispose of it safely. Never attempt to reuse the plug or insert it into a socket outlet as there is a danger of electric shock.



**UK
CA**

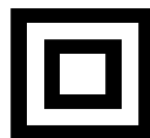



Electrolux

WARRANTY

Thank you for purchasing your Electrolux Product.

As part of our commitment to quality, we are offering you an extra 4 years warranty in addition to your 1 year guarantee

Your Electrolux product is guaranteed for 1 year from the date of original purchase, with proof of purchase or receipt. If any defect should occur due to faulty workmanship or material, your faulty vacuum should be returned to the place of purchase, replacement or refund is at the discretion of the retailer.

The guarantee is subject to the following provisions:

- The product must be correctly installed and operated in accordance with the requirements contained in the instruction manual.
- The product must be used solely for domestic purposes.
- It does not cover general wear and tear, damage, misuse or any consumable parts.
- The guarantee will be rendered invalid if the product is re-sold or has been damaged through inexpert repair.
- The guarantee is only valid within the UK and Eire.

Your standard 1 year guarantee will only be extended to the maximum available for your individual product upon registration. (Note: products must be registered individually and covers the main body and housing). If you do not register your product within 28 days of the original purchase date, your product will only be guaranteed for 1 year.

To validate your extended 4 year warranty*please register your purchase online within 28 days of the original purchase date by registering at:

help@electroluxsmalldomesticappliance.co.uk

or

Contact Us: www.electroluxsmalldomesticappliance.co.uk

*Your extended warranty is only valid with proof of purchase receipt and subject to the conditions outlined above.

Produced and imported under licence by

Eurosonic Group Limited

Brightgate House

1 Brightgate Way

Manchester M32 0TB UK

EU Rep: EuroSonic Magppie (ESM) Ltd. Ireland D05 X006

www.esgltd.com

ELECTROLUX is a pending or registered trademark used under license from AB Electrolux (publ)