

Fitting Instruction: Toilet Seats (ST1)

RTS

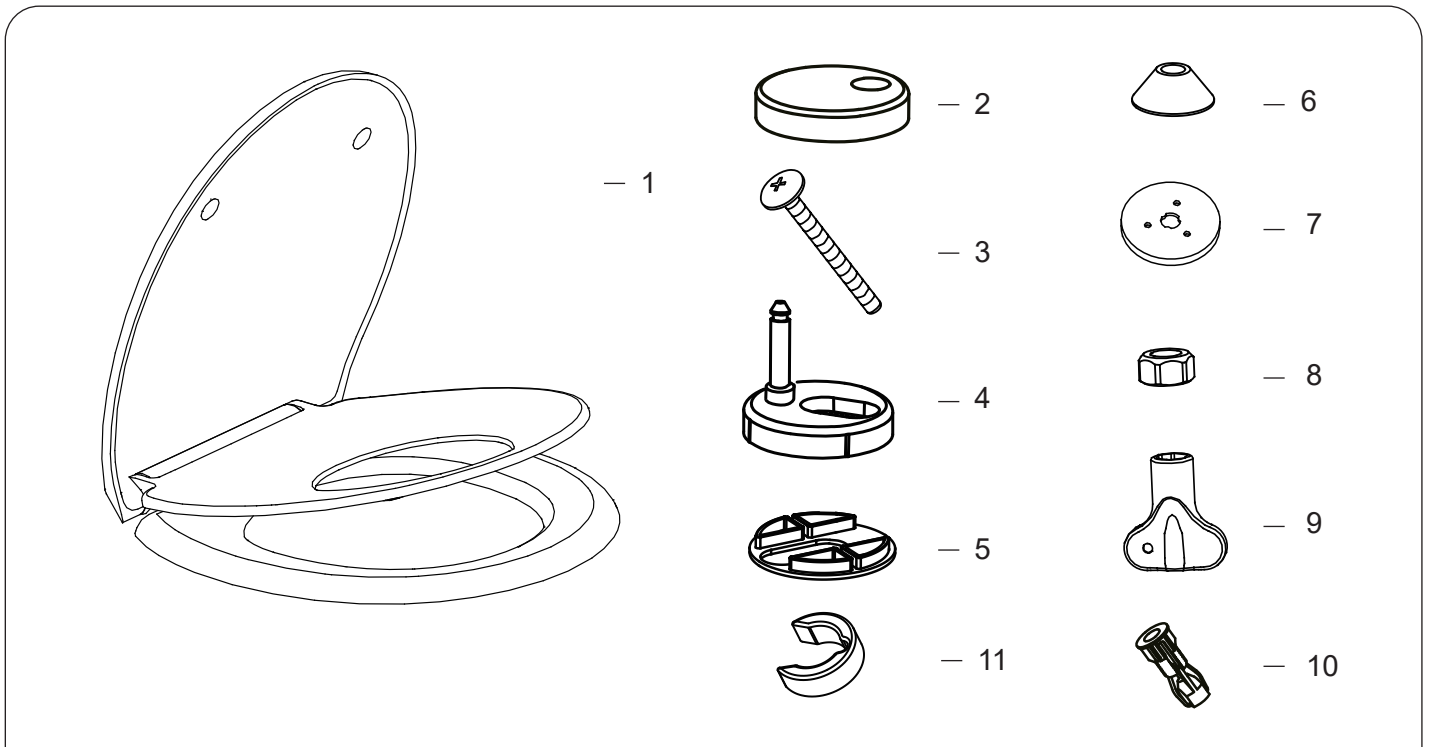

Inside the box

- | | | |
|--------------------------|----------------------------|---|
| 1 – Toilet seat with lid | 6 – No slip bottom grommet | 11 – Cover Ring (for when child seat removed) |
| 2 – Cover plate | 7 – Bottom washer | |
| 3 – Fixing bolt | 8 – Bolt | |
| 4 – Spigot | 9 – Spanner | |
| 5 – Spigot washer | 10 – Expanding grommet | |
- All parts are included inside the box – but some will not be used!**

Please Note

The lid is not a solid seat and should not be sat or stood upon.

Do not force the seat or the lid down - as this can damage the 'slow close' mechanism.

Only use hot soapy water and mild detergents to clean the seat, no strong chemicals or abrasives.

The toilet seat is fitted to the toilet pan using either 'top fix' or 'bottom fix' method.

Fitting Instruction: Top & Bottom fix Installation

Top Fix

This is when you cannot access the bolts from underneath the toilet pan. You will not use the no slip bottom grommet (6).

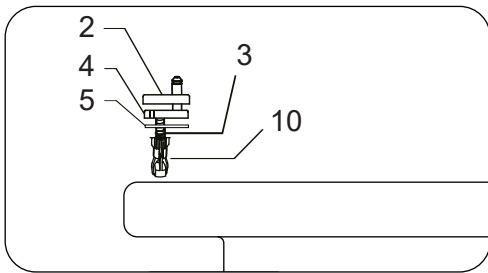

- 1 For top fix installations, please assemble as diagram.

Bottom Fix

This is when you have access to screw the nuts up from underneath the toilet pan. You will not use the Expanding Grommets (9).

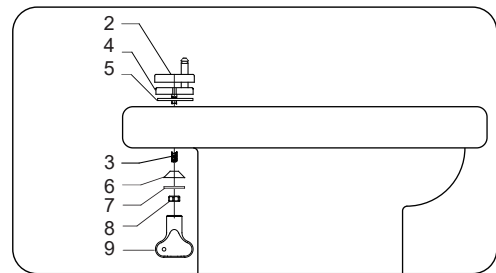

- 1 For bottom installations, please assemble as diagram.

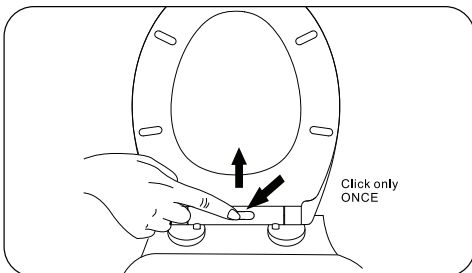

Toilet seat removal

To remove the seat for cleaning – press the button **ONCE** only.

