

JERONI SWAN

922123 – SINGLE HANDLE KITCHEN

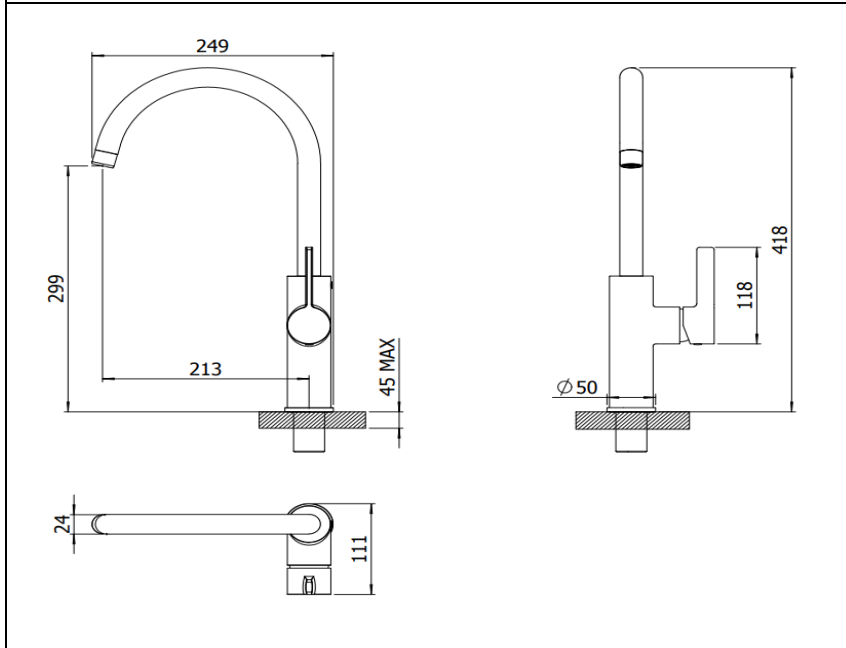

Specification

Finish	Gunmetal
Body	Brass
Fittings	Easy Fix System
Connection	M10 - DN8 Flexible hoses with 1/2" BSP thread ends
Min dynamic pressure	0.5
Max dynamic pressure	6
Max static pressure	16
Max water temperature	60°C

Flow rates

Pressure	0.1	0.5	1	3
Aerator				
F/Straight	0.8	3.2	5.2	11.4

All Pressures in Bar. All flow in L/Min.
 Dimensions supplied are nominal and subject to tolerance.
 Inclusion or restrictors (sold separately unless stated) will affect flow rate result.
 Performance details are based on trials under test conditions and for guidance only.
 The Company reserves the right to change product specification without prior notice.

Features & Benefits

10 YEAR Guarantee	M Medium Pressure	Flexible Hose	Flow Straightener
Eco Aerator	Cold Open	Easy Fix	Superfix

Certifications

Tested at 0.2 bar	2009772 – Sept 25