

# PRO-ELEC



**3kW Over Door Air Curtain Heater**

**Model: PEL00925**

## IMPORTANT SAFETY INFORMATION

**When using electrical appliances, basic safety precautions should always be followed to reduce the risk of fire, electric shock and injury to persons or property.**

**Read all instructions before using the appliance and retain for future reference.**

- Check that the voltage indicated on the rating plate corresponds with that of the local network before connecting the appliance to the mains power supply.
- This product must be earthed.
- Before drilling any fixing holes, check that there are no hidden obstructions behind the mounting surface, such as pipes or cables.
- Ensure the wall fixing can support the weight of the device and that the wall fixings will be securely anchored into solid masonry.
- The air curtain can be mounted on normally flammable surfaces.
- This appliance is designed for indoor use only.
- There are no user-serviceable parts in this product. Refer servicing to qualified personnel.
- Children should be supervised to ensure that they do not play with the appliance.
- Do not operate this appliance with a damaged cord, after a malfunction or after being dropped or damaged in any way.
- If the supply cord is damaged, it must be replaced by the manufacturer, its service agent or similarly qualified persons in order to avoid a hazard.

**WARNING:** Do not use this appliance near bathtubs, showers, basins or other vessels containing water.

- Do not block the air inlet or outlet as this will cause the air curtain to overheat.
- Do not place the air curtain near to soft furnishings as this may cause damage to them.

**CAUTION:** In order to avoid a hazard due to inadvertent resetting of the thermal cut-out, this appliance must not be supplied through an external switching device, such as a timer, or connected to a circuit that is regularly switched on and off by the utility.

## WHAT'S INCLUDED

- Air Curtain
- Installation / operation manual
- Wall Plugs and mounting screws

## PRODUCT OVERVIEW

- Ceiling or wall mounting (vertical or horizontal)
- Supplied with easy fix bracket
- 3 switched controls for fan only and 2 heat settings
- 2 heat settings (1500W and 3000W)
- Pressed steel resin coated body

1. Screw
2. Wall bracket
3. Front panel
4. Switches
5. Body

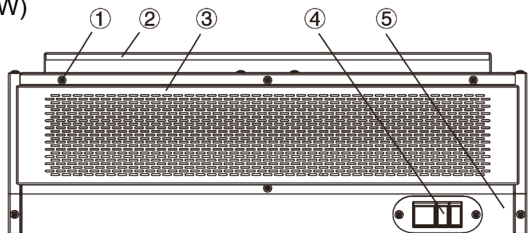

## INSTALLATION

- Remove the three screws securing the front panel and remove it.
  - Loosen the retaining bolts just enough that the mounting bracket can be unhooked and removed.
  - Offer the mounting bracket up to the wall or ceiling having checked that there is no hidden cables or pipes where the holes are required to be drilled.
  - Mark the wall using the mounting bracket as a template and drill the wall or ceiling and fit the wall plugs or suitable alternatives as required.
  - Secure the mounting bracket to the wall or ceiling using the screws supplied or if not suitable for your particular installation, use suitable alternative fixings.
  - Hang the air curtain heater on to the mounting bracket so the bolts previously loosened are located back into the slots in the bracket, ensuring the serrated washer is located inboard of the bracket.
  - Adjust the angle of the air curtain as required and tighten the bolts to secure the air curtain in place. Do not over tighten the bolts.
  - Refit the front panel and secure with the three screws.
  - Switch off the mains supply before connecting the wiring as follows:-
    - Live - Brown or red
    - Neutral - Blue or black
    - Earth - Green and yellow or green
  - If you are connecting to a fused spur, a 13A fuse should be used.
- DO NOT** connect to a mains socket using a standard 13A plug - this product should be wired directly by means of a permanent connector.
- Restore the power supply.

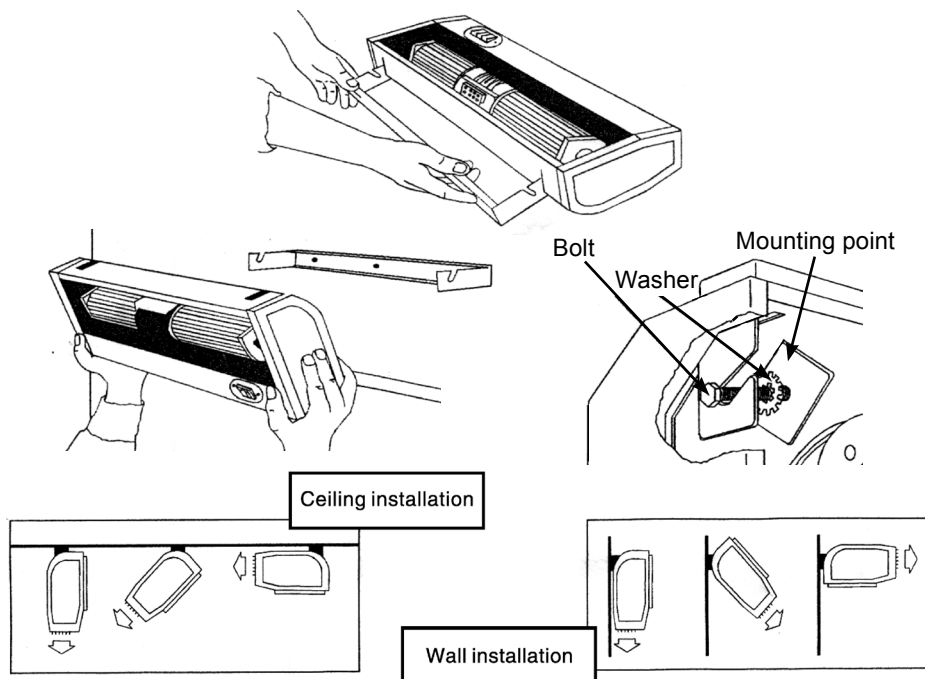

## OPERATION

- After finishing the installation, and switching on the power, switch the larger switch ON.
- This powers just the fan so the curtain can provide cooling air.
- The heating is controlled by the two smaller switches marked I and II.
- Switch I allows warm air (1500W) to be delivered and switch II allows hot air (3000W) to be delivered.
- If the unit overheats, an inbuilt thermal switch will cut the power and restore supply when the unit has cooled down again.
- However severe overheating will cause internal thermal fuses to isolate and cut the power for safety. These will not reset and are not user replaceable.
- Please contact a qualified electrician for repair having first ascertained what caused the air curtain to overheat and remedied it - airflow restriction, excessive dirt etc.

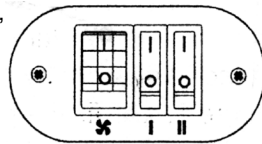

## CLEANING AND MAINTENANCE

- Disconnect the mains supply from the appliance and wait for it to cool completely before cleaning.
- Clean with a soft damp cloth.
- Do not use any chemicals, abrasives or solvents that could damage the appliance.

## SPECIFICATIONS

<b>Voltage:</b>	240V~/50Hz, Class I
<b>Rated Power:</b>	3000W
<b>Air Volume:</b>	254m <sup>3</sup> /hrs
<b>Air Velocity (max):</b>	4.8m/sec
<b>Noise Level:</b>	60dB
<b>Net Weight:</b>	5.2Kg
<b>Dimension:</b>	620×155×230mm
<b>Gross Weight:</b>	5.9Kg



### INFORMATION ON WASTE DISPOSAL FOR CONSUMERS OF ELECTRICAL & ELECTRONIC EQUIPMENT.

When this product has reached the end of its life it must be treated as Waste Electrical & Electronic Equipment (WEEE). Any WEEE marked products must not be mixed with general household waste, but kept separate for the treatment, recovery and recycling of the materials used. Contact your local authority for details of recycling schemes in your area.



Made in China. PR2 9PP

Man Rev 1.2