

700816

lighting  
the collection

ASSEMBLY  
INSTRUCTIONS

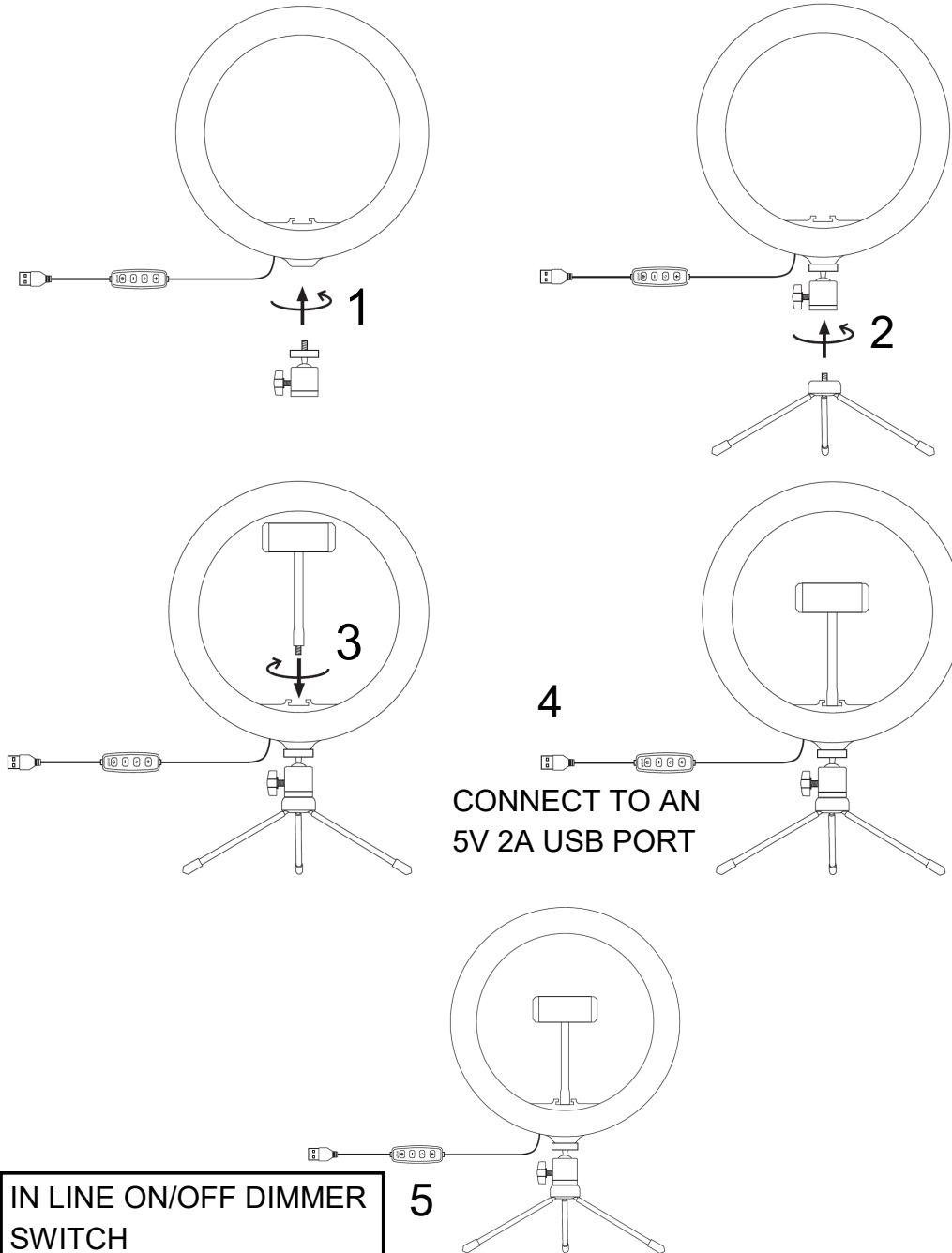

### SAFETY INFORMATION: (Please retain for future reference)

- This is a Class 3 product and must be connected to 5V 2A USB port.
- This product must be installed in accordance with the national building regulations, if in doubt consult a competent electrician.
- Do not stare at the operating lamp .
- Do not modify or alter any product before or after installation. This may invalidate your warranty and may render the product un-safe.
- The external cable of this luminaire cannot be replaced, if the cable is damaged the luminaire shall be destroyed.

### POSITION

- This fitting is suitable for installation in Indoor locations only .
- Ensure sufficient access to the fitting to enable safe maintenance.

### LAMP INFORMATION:

- The fitting is suitable for dimming using in line dimmer switch.
- The LED lamps are not replaceable, when the lamps reach the end of their life the whole luminaire shall be replaced.
- The LED chips are not removable.

### AFTERCARE AND MAINTENANCE:

- Always disconnect power supply when servicing or cleaning.
- Clean only with a dry or slightly damp cloth.
- Do no use any abrasive cloths or cleaners as this may damage the product .



APPROVED  
25/08/2020  
ISSUE 1