

STICK VAC

07/796 - Instruction Manual

07/200

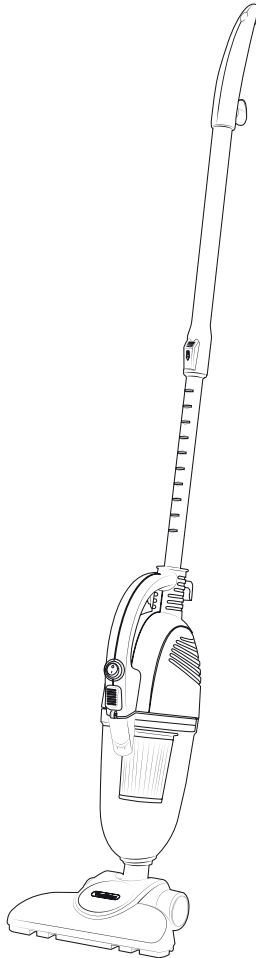

CONTENTS

Safety Instructions	1
Safety Instructions	2
Specification	3
Product Variations	4
Operation, Cleaning the Filter	5
Troubleshooting	6
Warranty	7

WARNING

PLEASE READ THESE INSTRUCTIONS CAREFULLY AND KEEP FOR FUTURE REFERENCE

INTENDED USE.

The Stick Vac is intended for domestic use only. It is not intended for use in commercial or industrial environments and is not suitable for use outdoors or on wet surfaces.

This appliance is not intended for use by persons (including children) with reduced physical, sensory or mental capabilities, or lack of experience and knowledge, unless they have been given supervision or instruction concerning use of the appliance by a person responsible for their safety.

GENERAL PRECAUTIONS.

Do not allow to be used as a toy. Close attention is necessary when used near children.

If the appliance is not functioning properly, has been dropped, damaged, left outdoors or immersed in liquid, do not use, contact DOMU Brands Customer Services.

Do not use the appliance if any parts appear to be faulty, missing or damaged. Ensure all parts are securely attached before using the appliance.

CABLES AND PLUGS.

Do not handle the plug or the appliance with wet hands.

Check to ensure your electricity supply matches that shown on the rating plate. The appliance must only be used as rated.

The use of an extension cable is not recommended.

Keep the cable away from heated surfaces.

Do not pull cable around sharp edges or corners.

Do not run the Stick Vac over the cable.

Do not unplug by pulling on the cable. To unplug, grasp the plug, not the cable.

Do not use with a damaged cable or

plug. If the supply cable is damaged, it must be replaced by a qualified engineer or authorized service agent in order to avoid a hazard.

RISK OF PERSONAL INJURY.

Never use the appliance without the HEPA Filter and Protective Mesh Filter in place.

Do not use the appliance in areas where flammable or combustible liquids may be present.

When using the Stick Vac for the first time, a smell or vapour may be given off. This will dissipate after a few uses.

Keep hair, loose clothing, fingers and all parts of the body away from openings and moving parts.

Do not insert any objects into openings or cover the appliance.

Take extra care when operating on stairs.

Do not leave the appliance unattended when plugged in. Always unplug from the outlet when not in use, and before performing user maintenance, connecting or disconnecting attachments or changing accessories.

In order to prevent damage to the product and reduce risk of fire and/or personal injury, the following objects are strictly prohibited from being sucked up:

Any large or broken objects such as glass
Anything that is burning or smoking such as cigarettes, matches or hot ashes

Liquid spills

Reactive liquids (solvents, corrosives, detergents)

Flammable or explosive substances such as alcohol, thinners etc.

Do not carry out any maintenance or repair work other than that shown in this manual, or as advised by the DOMU Brands Customer Care Helpline.

Store the appliance indoors, in a cool, dry place.

WARNING

PLEASE READ THESE INSTRUCTIONS CAREFULLY AND KEEP FOR FUTURE REFERENCE

Use only as described in this manual and with DOMU Brands recommended attachments only.

THERMAL CUT-OUT.

This appliance incorporates a safety thermal cut-out which will switch off the Stick Vac automatically should it overheat. The Stick Vac may overheat if the HEPA Filter is clogged, the Flexible Hose is blocked or the Dust Tank is full. Empty the Dust Tank or remove the blockages and clean the HEPA Filter before next use. The Stick Vac will become operational again after allowing 30-60 minutes to cool down.

It is essential that the Vacuum Cleaner is cleaned regularly and any blockages are prevented or cleared immediately in order to maintain performance.

PRODUCT SPECIFICATION

VOLTAGE	FREQUENCY	SUCTION POWER	POWER	CORD LENGTH	INLET FILTER
V	Hz	Air Watts	800W (Nom) 1000W (Max)	M	HEPA
220-240	50	140		6	

SUCTION PRESSURE

kPa
18

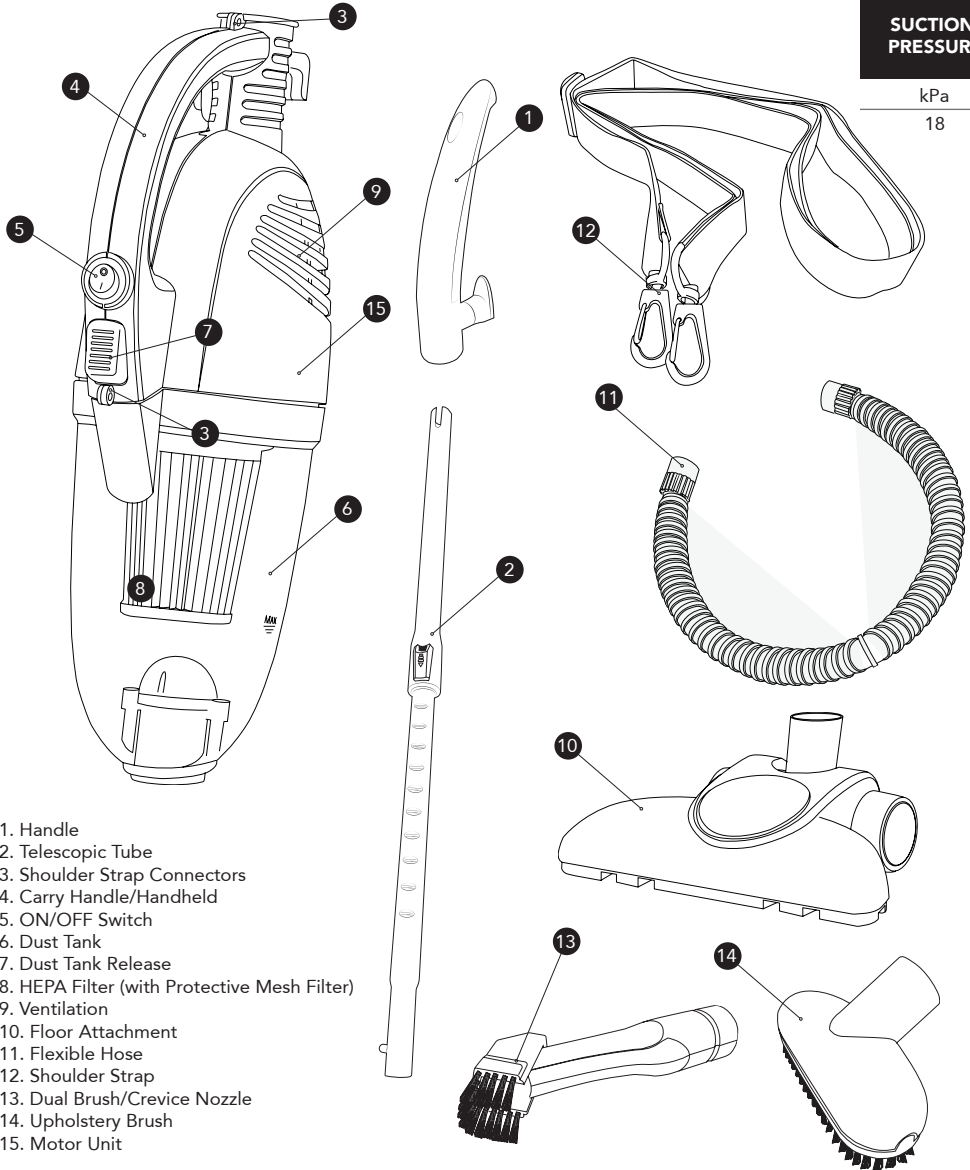

1. Handle
2. Telescopic Tube
3. Shoulder Strap Connectors
4. Carry Handle/Handheld
5. ON/OFF Switch
6. Dust Tank
7. Dust Tank Release
8. HEPA Filter (with Protective Mesh Filter)
9. Ventilation
10. Floor Attachment
11. Flexible Hose
12. Shoulder Strap
13. Dual Brush/Crevise Nozzle
14. Upholstery Brush
15. Motor Unit

PRODUCT VARIATIONS

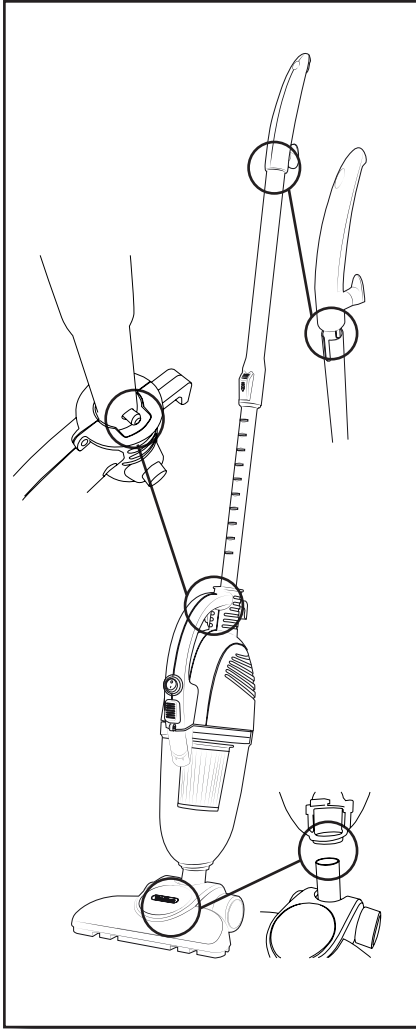

UPRIGHT

The upright assembly uses the Telescopic Tube (1), the Motor Unit (15) with the Dust Tank (6) attached, and the Floor Attachment (10).

To assemble push the Handle (1) onto the Telescopic Tube (2) to secure into place.

Align the clip on the Telescopic Tube with the gap on the Motor Unit and push in until it clicks into place.

To attach the Floor Attachment, simply push into the opening on the bottom of the Dust Tank.

To remove the Telescopic Tube, press the button to release and lift away from the Motor Unit.

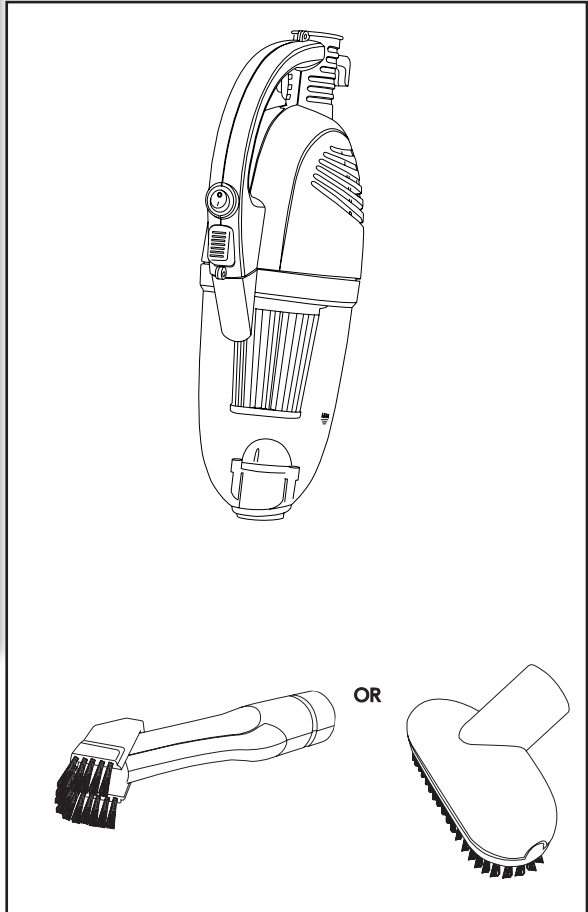

HANDHELD WITH UPHOLSTERY BRUSH OR DUAL BRUSH/CREVICE NOZZLE

Using the same method as above, securely attach either accessory.

NOTE: The accessories can also be used with the Flexible Hose (11) if required, which attaches in the same way.

OPERATION

Assemble the Stick Vac to your desired variation, then plug into a suitable outlet.

Roll out a sufficient amount of power cable.

CAUTION: Do not work with a stretched/limited amount of power cable.

To power on the Stick Vac, simply push the ON/OFF Switch (5) to the on position.

NOTE: Ensure you empty the Dust Bin regularly. Failure to do so can reduce the performance of the Stick Vac and can cause it to overheat.

CLEANING THE FILTER

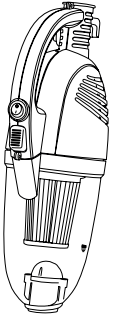

To remove the Dust Tank, press the Dust Tank Release (7).

NOTE: Ensure you are holding the Dust Tank when its released as it will detach from the Motor Unit (15).

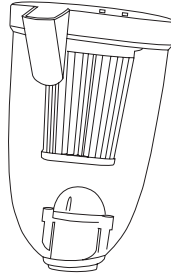

Remove the Dust Tank, ensuring it is kept upright.

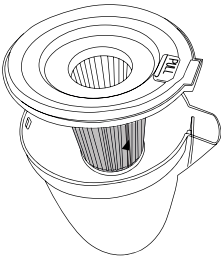

Locate the pull tab and lift to remove the HEPA Filter (8). Remove the Protective Mesh Filter by pulling on the tab.



Empty the Dust Tank into a bin.

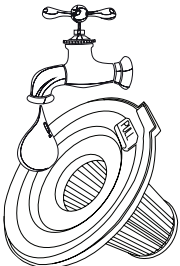
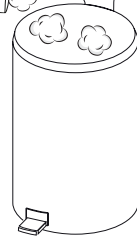

Clean the HEPA Filter and the Protective Mesh Filter with clean running water and leave to dry completely before reassembling.

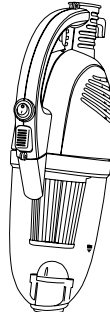

Reassemble and ensure everything is fitted correctly before commencing vacuuming.

TROUBLESHOOTING

PROBLEM	SOLUTION
NO POWER	<p>Ensure the Stick Vac is correctly connected to the mains outlet.</p> <p>Ensure the rating of the Stick Vac matches the outlet.</p> <p>Check and replace the fuse if necessary.</p> <p>Try another outlet.</p> <p>The thermal cut-out may have been activated. Unplug the Stick Vac and leave to cool for up to 30-60 minutes.</p> <p>Empty Dust Tank and clean the filters.</p>
LOSS OF SUCTION	<p>Check openings for any blockages. Unplug and remove if necessary.</p> <p>Ensure the HEPA Filter is correctly in place.</p> <p>Empty the Dust Tank and clean the HEPA Filter.</p> <p>Contact DOMU Brands Customer Services if the HEPA Filter has become damaged.</p>

If you are having difficulty using this product and require support, please contact **hello@DOMU.co.uk**

DISPOSAL INFORMATION

Please recycle where facilities exist. Check with your local authority for recycling advice.

WARRANTY

To register your product and find out if you qualify for a free extended warranty, go to:

www.VonHaus.com/warranty

Please retain a proof of purchase receipt or statement as proof of the purchase date.

The warranty only applies if the product is used solely in the manner indicated in the Warnings page of this manual, and all other instructions have been followed accurately. Any abuse of the product or the manner in which it is used will invalidate the warranty.

Returned goods will not be accepted unless re-packaged in its original packaging and accompanied by a relevant and completed returns form. This does not affect your statutory rights.

No rights are given under this warranty to a person acquiring the appliance second-hand or for commercial or communal use.

COPYRIGHT

All material in this instruction manual are copyrighted by DOMU Brands Ltd.

Any unauthorized use may violate worldwide copyright, trademark, and other laws.

www.VonHaus.com

Thank you for purchasing the Stick Vac.

VonHaus® is a registered trademark of DOMU Brands Ltd
Made in China for DOMU Brands Ltd M24 2RW

VonHaus®