

# 2500192 - ADDENDUM

At DOMU Brands, we are continually looking improve our products and customer experience.

Please find below, some further tips to compliment the Instruction Manual provided with this product.

**NOTE** This document is not a replacement for the Instruction Manual provided with your product.

Ensure to read all instructions carefully before use and retain for future reference.

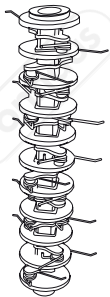

Raking Tool  
Outil de scarification  
Scarifying Tool  
Herramienta de escarificación  
Strumento Scarifying  
Herramienta de escarificación



Scarifying Tool  
Outil d'aérateur  
Belüfterwerkzeug  
Herramienta de aireador  
Atrezzo aeratore  
Herramienta Aerator

## EN

**RAKING TOOL** is used for loosening the soil, light weeding and levelling, removing dead grass from lawns.

### SPRING - RAKING & LIGHT SCARIFYING

Light de-thatching or scarifying and moss removal can be done in spring and or autumn. Spring generally means April, just as things warm up thereby increasing the growth and recovery rate but before the heat and dryness of summer slows things down. Autumn is generally late August or September as the rains start but before the cold sets in.

### AUTUMN - HEAVY SCARIFYING

For heavy thatch or moss infestations requiring deeper scarifying or raking then try to stick to the autumn period. Why?

Heavy raking or scarifying is going to thin the lawn

leaving soil exposed in many places. This makes an ideal seed bed not only for over seeding with new and improved grass seed but also for all the weed and grass seeds floating around. By confining this intensive treatment to August or September you will avoid the bulk of the years weed seeds. If you do this in spring you'll just replace moss or thatch with weeds. There are a few exceptions when spring is the best time:

- It is better to rake or scarify in spring if you were unable to do it the previous autumn perhaps due to bad weather rather than put it off.
- If the area to be scarified is shady. Shady areas will thin over winter and thicken up from spring onwards. Therefore if you scarify in autumn you'll just make things worse.
- If the area is under trees. The shade from trees plus the autumn fall of leaves will reduce grass health and vigour but in spring – late March through April – the trees are bare allowing maximum light to your lawn enabling good growth and maximum opportunity for new grass seed to get growing.

### READY THE LAWN FOR SCARIFYING OR RAKING

Planning ahead is important. You need short dry grass for raking or scarifying so bring the grass height down gradually over a week or two before hand. This doesn't shock the grass whilst also allowing air deeper into the turf helping dry the grass.

If you have any weeds in your lawn then you can manually remove them but do not use any weed killer. Scarifying within a few weeks of weed killer application disrupts the weed killing process and in addition may cause seed germination issues if you are going to over seed after scarifying. Scarifying can help control some creeping weeds though.

The final part of preparation is to have good soil moisture so that the lawn recovers as quickly as possible afterwards. If there is too much (soft ground) or too little (dry hard soil) you need to either wait until the conditions improve, assist them to improve or not rake or scarify at all.

Lawnmow it as close as possible without scalping. Long grass just creates resistance to the scarifier with ultimately more rubbish to collect. Dry grass and moss makes life a lot easier as well. Plan to rake on a dry day with no dew around. The afternoons are often best. If the weather is not suitable i.e wet, keep the grass short until you get another raking opportunity.

### Ride Height (adjusts the bottom platform of the product and therefore the attachment cutting depth)

0 +6mm above ground level

1 -3mm below ground level

2 -6mm below ground level

3 -9mm below ground level

4 -12mm below ground level

Always use height '0' for transporting when not in use.

We recommend beginning your scarifying process on height setting '1' and progressing lower as you progress

through the raking and scarification process.

**GENERAL OPERATION** Select the suitable cutting depth for the actual grass height.

Do not work with this product on a wet lawn because it tends to stick to the under-body of the product, preventing the proper discharge of collected material, and it could also cause you to slip and fall.

Slowly push the product forward. Move the product at an appropriate speed.

Do not move too fast to prevent the discharge opening from getting blocked and the motor from overloading.

Work in slight overlapping rows. The most effective pattern for scarifying/raking lawns is straight lines along one of the sides. This will keep the rows even and ensures that all the lawn is scarified/raked without missing any spots.

Circle around flower beds. When reaching a flower bed in the middle of the lawn, make a row or two around the circumference of the bed.

Pay special attention when changing direction.

## THANK YOU

Thank you for purchasing your product/appliance.

Should you require further assistance with your purchase, you can contact us at

**hello@domu.co.uk (UK/EU)**

**usasupport@domubrand.com (US)**

VonHaus is a registered trademark of DOMU Brands Ltd. Made in China for DOMU Brands. M24 2RW.