

FCL-31190X2

Set of 2 Gale - Polypropylene Coastal Black Up Down Wall Lights



LIGHT SOURCE DATA

- 4 x 35W Max GU10 Halogen (required)
- Lamp direction - Upwards & Downwards
- Lamp shape - Reflector/Pear Shape
- Dimmable
- Energy class: Not applicable

DIMENSION DATA

- Height 160mm
- Width 80mm
- Depth 89mm

- Weight 0.19kg

SPECIFICATION

- Manufacturer warranty for 2 years from date of purchase
- Black polypropylene and clear PC
- IP44
- No
- Class II - Double Insulated, No Earth
- 240V
- Assembly required? No
- UKCA Marking, Energy Efficient, Energy Saving

CERTIFICATION



CONTACT

www.firstchoicelighting.co.uk

info@firstchoicelighting.co.uk

FCL-31190X2

Set of 2 Gale - Polypropylene Coastal Black Up Down Wall Lights

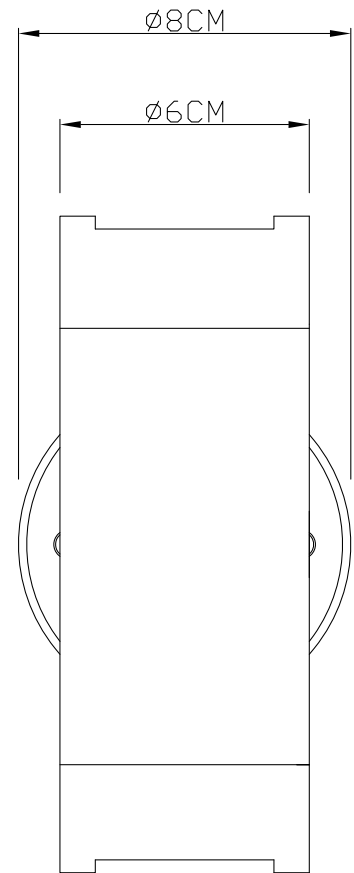
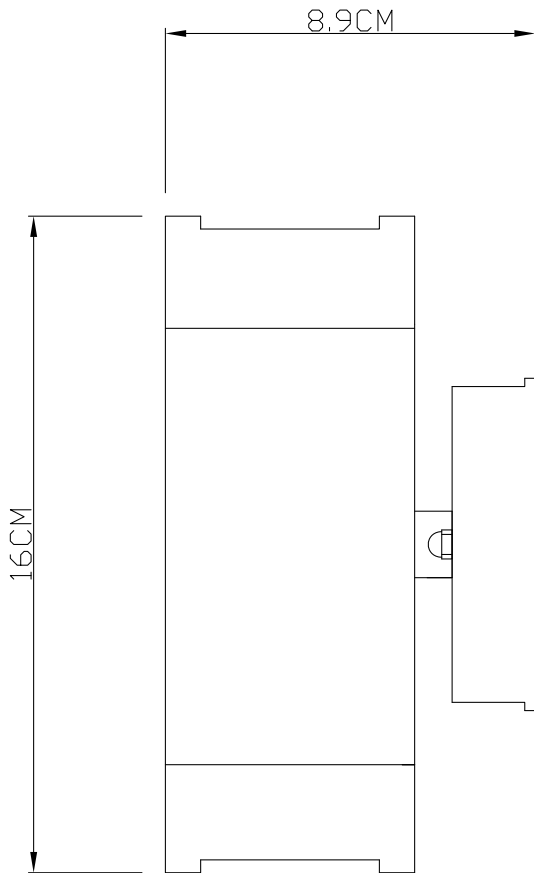

CERTIFICATION



CONTACT

www.firstchoicelighting.co.uk

info@firstchoicelighting.co.uk