

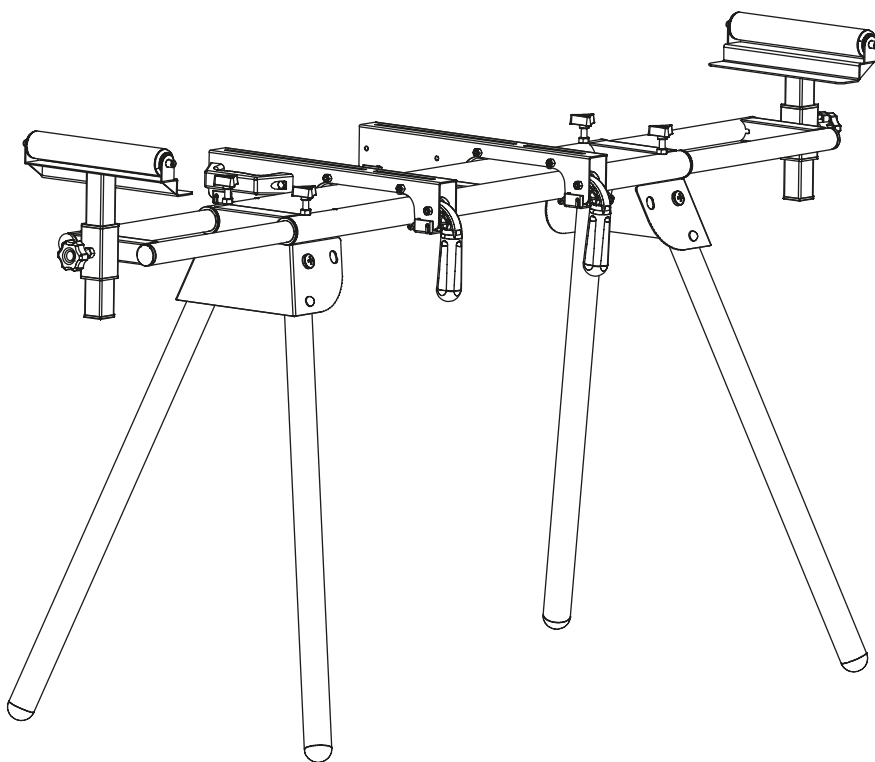

ORIGINAL INSTRUCTIONS



21-MS-ST

Original Instructions

IM-MS-ST-EN
Iss: 06/2021



GENERAL WARNINGS



To reduce the risk of injury, the user must read the instruction manual.



This symbol is used throughout this manual to warn the user about potential risks. Please read & understand these sections before using the device.



Personal Protective Equipment (P.P.E.), such as ear defenders, eye protection, safety gloves and a dust mask, must be worn during the operation of the device.

WARNING: Drilling, sawing, sanding or machining wood products can expose you to wood dust, a substance known to the State of California to cause cancer. Avoid inhaling wood dust or use a dust mask or other safeguards for personal protection. For more information go to www.P65Warnings.ca.gov/wood.



Contents

SAFETY WARNINGS	4
COMPONENT LIST	5
TECHNICAL DATA	6
OPERATING INSTRUCTIONS	7
Intended Use	7
Before starting the equipment	7
ASSEMBLY AND OPERATION	8
Cleaning, maintenance, storage and transport	11
WARRANTY STATEMENT	12



SAFETY WARNINGS

- > **Use the mitre saw stand only in conjunction with suitable electric power tools!**
- > **Check the mitre saw stand for damage each time before use. Electric power tools shall not be mounted or operated on damaged support arms / crossbars.**
- > **Electric power tools must be bolted to the support arms / crossbars and be secured on the mitre saw stand in accordance with the manufacturers instructions.**
- > **Do not use the stand on uneven surfaces. The stand is designed to be used on a stable flat surface.**
- > **Do not use on a slippery surface. The stand load capacity is greatly reduced if used on a slippery surface.**
- > **Always ensure the mitre saw stand is secure when setting it up.**
- > **Always ensure that you assume a natural and safe standing position when working.**
- > **Do not use the mitre saw stand for purposes for which it is not intended.**
- > **Modifications or unauthorised changes to the mitre saw stand as well as the use of unapproved parts is forbidden.**
- > **All parts of the mitre saw stand, including any safety devices, must be correctly mounted in order to guarantee trouble-free operation.**
- > **Keep the mitre saw stand out of reach of children. Store the device in a location that is inaccessible to unauthorised persons and children.**
- > **Do not exceed the maximum working load specified on the product label. It is unsafe to climb, sit or stand on the table.**

ATTENTION!

When using electric power tools, in conjunction with the mitre saw stand, the respective machine-specific safety measures must be implemented as protection against electric shock, and the risk of injury or fire. Read all of the instructions for the electric power tool that you intend to mount and operate before using the tool.

Safety instructions for the electric device mounted must likewise be observed. Store these safety instructions safely.

Observe all safety instructions. If you disregard the safety instructions, you endanger yourself and others.

WARNING!

Never place your fingers or hands in the vicinity or in line with the saw blade



COMPONENT LIST

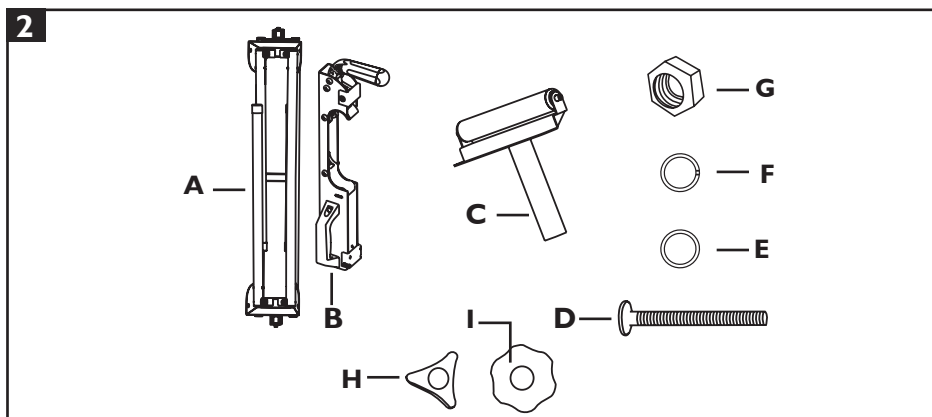
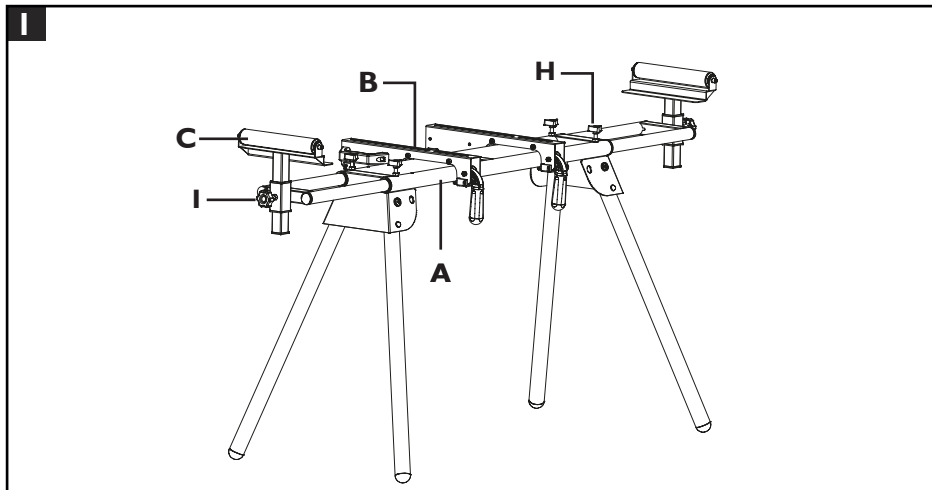

A Mitre saw stand

B Support arm 2x

C Adjustable workpiece support 2x

D Coach bolt M6x60 4x

E Washer 6mm 4x

F Spring washer 6mm 4x

G Nut M6 4x

H Star-grip screw (small) 4x

I Star-grip screw (large) 2x



TECHNICAL DATA

Dimensions (LxWxH) in inch	40 - 65 x 23 x 32 - 36"
Table height	30"
Height range of the workpiece supports	32 - 36"
Width range of the workpiece supports	40 - 65"
Max. permissible load	440 lb
Weight net / gross	29.3 / 33.2 lb
Dimensions (LxWxH) in mm	1000 - 1650 x 580 x 810 - 910 mm
Table height	750 mm
Height range of the workpiece supports	810 - 910 mm
Width range of the workpiece supports	1000 - 1650 mm
Max. permissible load	200 kg
Weight net / gross	13.3 / 15.1 kg



OPERATING INSTRUCTIONS

Intended Use

Always observe the proper use of your mitre saw stand.

The mitre saw stand is designed for use with tabletop devices such as mitre saws, scroll saws, circular table saws, etc.

Electric power tools without suitable mounting holes are not permitted to be fitted to the mitre saw stand and shall not be operated in conjunction with the mitre saw stand. Electric power tools must be firmly bolted to the mitre saw stand before starting them up.

The mitre saw stand is also designed as a workpiece support when working with mitre saws, scroll saws, circular table saws, and other similar electric power tools.

The maximum workpiece length is 10ft (3m).

Additional workpiece supports may have to be used (e.g. a roller trestle) in order to prevent longer workpieces tilting.

Attention: Ensure that the workpiece support is secure and not tilted!

Do not use the mitre saw stand as a ladder or as scaffolding. Ensure that all handgrips, nuts and screws are tightened before use. Electric power tools on this device shall not exceed an overall height of 130 cm (4 ft). The maximum permissible load is 200 kg (440 lbs). Ensure that the mitre saw stand is on a level, firm and stable floor. Any use beyond this is improper use. The manufacturer is not responsible for the resultant damages, the user bears this risk alone.

Before starting the equipment

Check the device for transport damage. Immediately report any damage to the transport company that delivered the device.



ASSEMBLY AND OPERATION

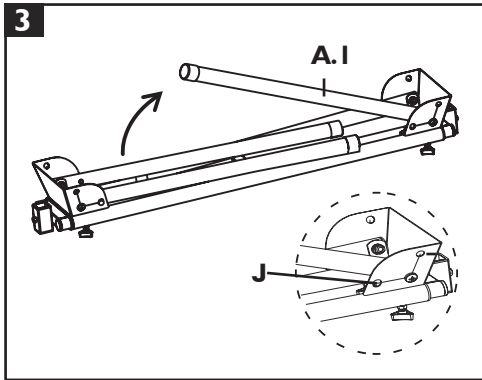

The mitre saw stand is largely assembled and you need only fit the support arms and the crossbars as follows:

Erecting the mitre saw stand (Fig. 3-4)

Place the mitre saw stand (A) on the floor or on a workbench such that the frame legs (A.1) are uppermost.

Press the spring pins (J) and fold out the frame legs.

Once the spring pin latches into the intended position, the frame leg is locked.

Rotate the mitre saw stand and set down on its feet.

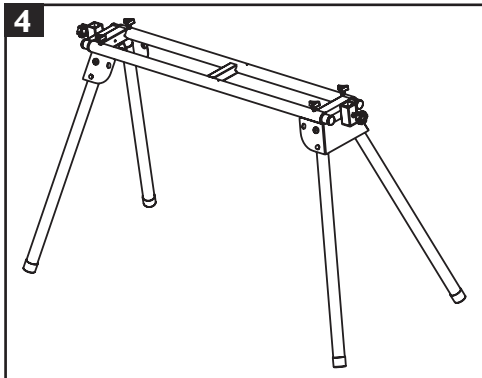

Mounting support arms (Fig. 5)

Fit the support arms (B) to the frame bed (A) by pulling the locking lever (B.3) upwards to unlock it and then latching the arm into place on the frame base, firstly on the front side (B.2).

Lower the rear side onto the bed and fasten the support arm in place on the frame bed by pressing the locking lever (B.3).

Disassembly is performed in reverse order.

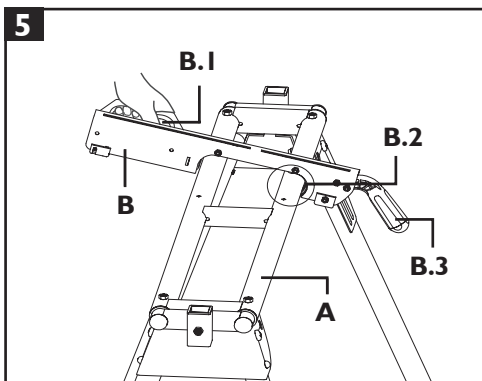

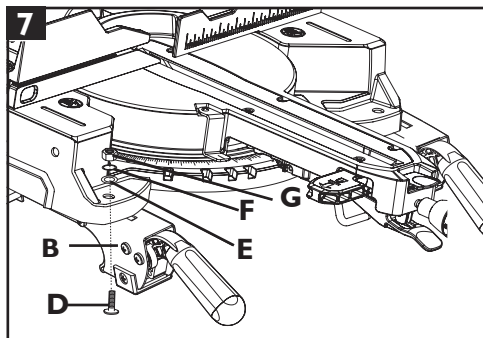
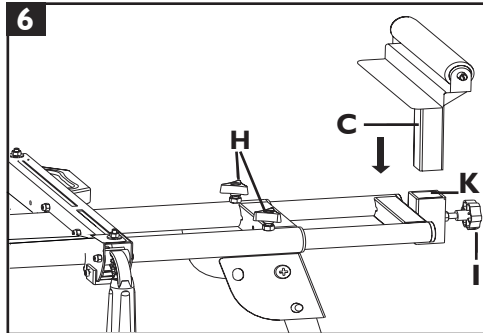

- › Fasten the tabletop machine with 4 coach screws (D), 4 washers (E), 4 spring washers (F) and 4 hexagonal nuts (G) on each of the support arms.
- › Tighten the screws after assembly.
- › Fasten the support arms (B) with the mounted tabletop machine on the mitre saw stand, as described on page 8.

Fitting the workpiece supports (Fig. 6-7)

Insert the workpiece support (C) into the support post (K) of the frame bed and fasten in place with the star-grip screw (I).

Repeat the above for the other support.

The width and height of the workpiece supports can be adjusted with the star-grip screws (H, I). (Fig. 6)

Fastening your tabletop machine (Fig. 7)

Different tabletop machines can be fastened to your mitre saw stand by adjusting the support arms (B) to the spacing of the mounting holes on your machine.

- › Place your tabletop machine (e.g. mitre saw) on the support arms (B) (Fig. 7).



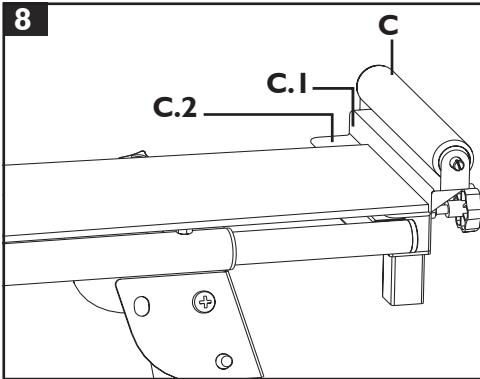

Using the workpiece stops, Fig. 9

The workpiece supports (C) have integrated workpiece stops (C.2), which can be used to saw multiple pieces of wood to the same length. (Fig. 8)

- Loosen the star-grip screw (I) on the desired side of the mitre saw stand and adjust the height of the workpiece support (C) such that the support surface (C.2) is at the same height as the workpiece support of the saw. (Fig. 9)
- Loosen the star-grip screws (I) to slide the workpiece support horizontally.
- Set the desired distance between the saw blade and the stop surface (C.1). (Fig. 8)
- Lock your setting by tightening the star-grip screws (H) again.

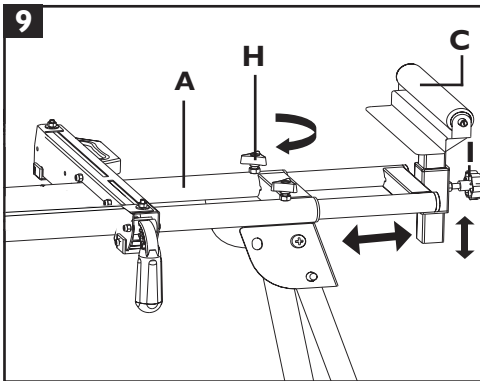



CLEANING, MAINTENANCE, STORAGE AND TRANSPORT

IMPORTANT!

Before any cleaning or maintenance work, the electrical tool fitted must be switched off and the mains plug disconnected, or battery pack removed! Risk of injury!

Cleaning

- › Keep the mitre saw stand as free of dust and dirt as possible. Rub the mitre saw stand clean with a clean cloth or blow debris off with compressed air at low pressure.
- › We recommend that you clean the mitre saw stand immediately after every use.
- › Clean the stand at regular intervals using a damp cloth and a little soft soap. Do not use any cleaning products or solvents - they could attack the plastic parts of the mitre saw stand.

Storage

ATTENTION!

Store the mitre saw stand only in dry locations. Do not allow access to the mitre saw stand by unauthorised persons or children.

Transport

ATTENTION! !

Do not transport whilst the electric power tool is running.

Before moving the mitre saw stand, pull out the mains plug, or remove the battery pack, of the electric power tool mounted on it! Risk of injury due to electric shock and unexpected start-up of the power tool!

Two people can lift the mitre saw stand by its frame bed in order to move the mitre saw stand within rooms (do not drag it along the ground).

If being transported in a vehicle, remove the electric power tool first. Fold up the legs for transport.

Ensure that the load is well secured if transporting the mitre saw stand in a motor vehicle.



WARRANTY STATEMENT

JCB Power Tools are guaranteed against manufacturing defects for up to 3 years from date of purchase by simply registering your product online within 30 days. Proof of purchase required. This does not affect your statutory rights.

To register your JCB Power Tool, please visit: jcb-tools.com

Online registration is required within 30 days to receive a warranty certificate to activate your standard 3 year warranty. Registration is only available online via www.jcb-tools.com. You will need your original sales receipt, the model number and the serial number (if applicable) of your product. Kits comprising of two or more tools are excluded from single registration and must be registered individually for full warranty cover.

Upon successful registration, a warranty certificate will be available to download, print or save as a PDF document. The relevant warranty certificate together with the original sales receipt will be required in the event of any claim within the warranty period.

Should you choose not to register your product within 30 days of purchase, your statutory consumer rights will not be affected. You will need the original sales receipt as proof of purchase in the event of a warranty claim.

Warranty cover commences from the date of purchase on the retail sales receipt and is valid only for JCB Tools products purchased within the UK bearing the CE and UKCA mark and a visible serial number.

In the unlikely event your JCB Power Tool is subject to a manufacturing fault within the warranty period, JCB Tools may repair the product by replacing defective parts free of charge at our discretion. In the event parts are irreplaceable JCB Tools may replace your product free of charge. The original product will remain the property of JCB Tools in this situation.

The above repair or replacement of products will be undertaken providing that:

- › The product has been subject to fair wear and tear only.
- › The product has not been subject to accidental or cosmetic damage.



- › The product has not been misused and has been used only in accordance with the instruction manual provided.
- › The product has not been subject to overload or insufficient servicing and maintenance.
- › The product has not been subject to any abnormal environmental conditions or inappropriate operating conditions.
- › Repairs have not been attempted by an unauthorised person and no modifications have been made to the product.
- › Repairs have not been undertaken using non-genuine spare parts.

JCB Power Tools used for Hire Fleets or as part of B2B and Service Contracts are not covered by these terms and conditions.

JCB Tools 3 Year Warranty excludes the following (where applicable):

- › Components normally subject to wear such as carbon brushes.
- › Batteries, Chucks and Chargers.
- › Accessories and consumable items.
- › Cases and tool storage products.

If your product develops a fault within 30 days of purchase, return it to the retailer where it was purchased together with your sales receipt. If a product develops a fault after 30 days a warranty claim must be submitted.

If you have a warranty claim please take your product, original sales receipt and if applicable, a copy of your extended warranty certificate to your place of purchase or nearest JCB Tools retailer.

If you wish to send your product to us directly, please send to JCB Tools, Unit 55, Romsey Industrial Estate, Greatbridge Road, Romsey, Hampshire, SO51 0HR, along with your original receipt and, if applicable, a copy of your extended warranty certificate. Delivery and repair charges may apply at our discretion should the warranty claim be invalid for any of the reasons illustrated above. In the event charges are not accepted the product will be retained by JCB Tools and remain the property of JCB Tools.

The information on both your sales receipt and your extended warranty certificate must match.

JCB TOOLS WILL NOT BE LIABLE FOR ANY INJURIES OR CONSEQUENTIAL DAMAGES RESULTING FROM USE OF THIS PRODUCT.

