

DRAPER

EN

Original Instructions
Version 2 - March 2025

ROLLER/BEARING
STAND

70274



These instructions accompanying the product are the original instructions. This document is part of the product, keep it for the life of the product passing it on to any subsequent holder of the product. Read all these instructions before assembling, operating or maintaining this product.

This manual has been compiled by Draper Tools describing the purpose for which the product has been designed, and contains all the necessary information to ensure its correct and safe use. By following all the general safety instructions contained in this manual, it will ensure both product

and operator safety, together with longer life of the product itself.

All photographs and drawings in this manual are supplied by Draper Tools to help illustrate the operation of the product.

Whilst every effort has been made to ensure the accuracy of information contained in this manual, the Draper Tools policy of continuous improvement determines the right to make modifications without prior warning.

1.1 Intended Use

This telescopic roller stand is designed to be used with bandsaws and planer/thicknesser machines where additional support is required for sawing long workpieces. Stand head changes between roller and bearings to allow additional movement of sheets.

Any other application beyond the conditions established for use will be considered misuse. Draper Tools accepts no responsibility for improper use of this product.

Read this manual in full before using this product and retain it for future use. Always use the latest version of the manual. Please visit drapertools.com/manuals for the latest version

1.2 Specification

Stock No.	70274
Part No.	RST400A
Roller length	300mm
Min. stand height	700mm
Max. stand height	1100mm
Max. supporting weights:	
700mm	60kg
1100mm	30kg
Net Weight:	5kg

2.1 Assembling the Roller Stand

1. Attach the feet (Fig. 1).
2. Connect the folding legs (Fig.2).
3. Slide the extending arm.
4. Screw in the adjustment handle.
5. Attach the roller/bearing head (Fig.3)

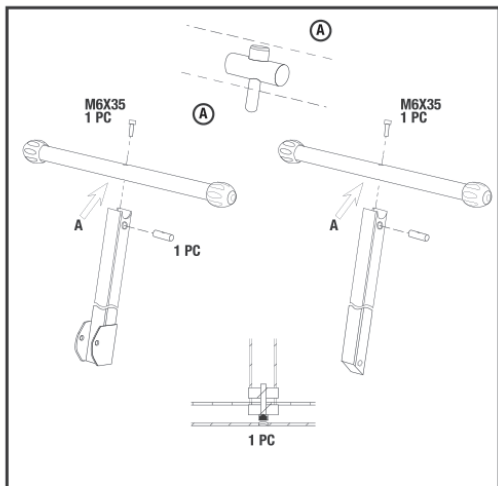

Fig. 1

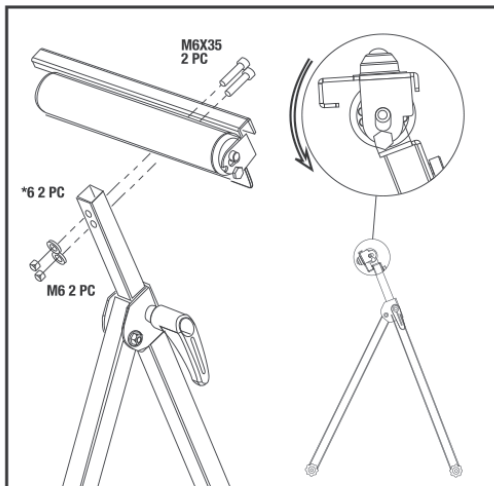

Fig. 3

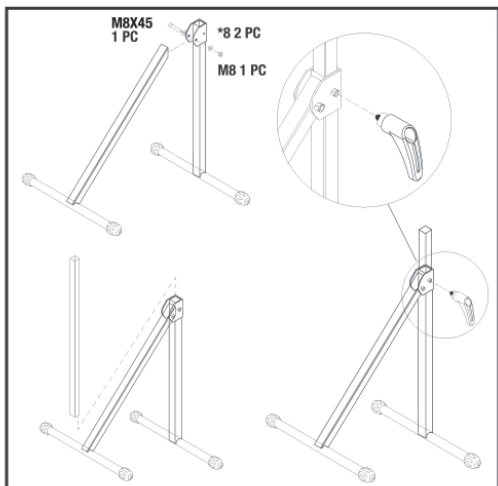

Fig. 2

Contact Details

Draper Tools

Draper Tools Limited
Hursley Road
Chandler's Ford
Eastleigh
Hampshire
SO53 1YF
UK

Website: drapertools.com

Email: sales@drapertools.com

Product Helpline: +44 (0) 23 8049 4344

Telephone Sales Desk: +44 (0) 23 8049 4333

General Enquiries: +44 (0) 23 8026 6355

Delta International

Delta International BV
Oude Graaf 8
6002 NL
Weert
Netherlands

Please contact the Draper Tools Product Helpline for repair and servicing enquiries.