

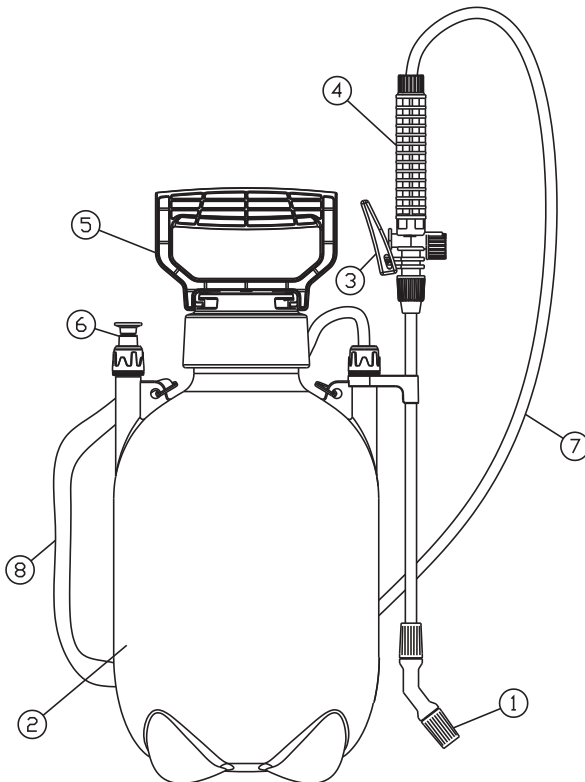

# PRESSURE SPRAYER 8L

CT0236

## Instruction Manual



- 1 Adjustable Spray Nozzle
- 2 Tank
- 3 Trigger
- 4 Handle

- 5 Pump handle
- 6 Safety Valve
- 7 Hose
- 8 Strap

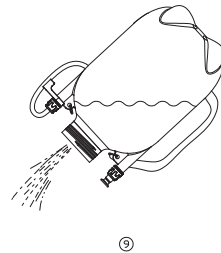
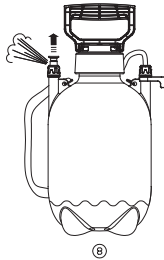
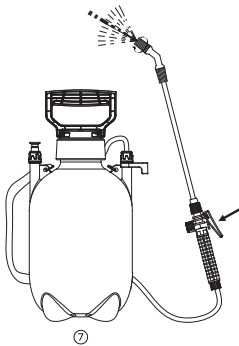
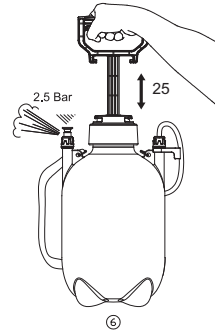
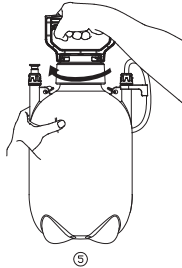
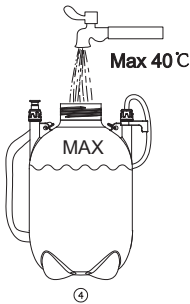
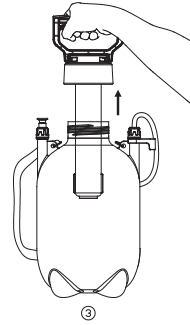
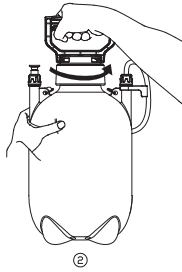
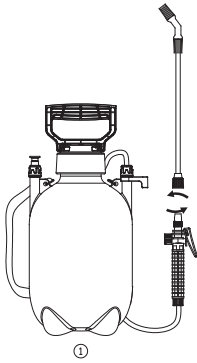

1. Attach the nozzle by screwing it on in a clockwise direction(Fig 1)
2. Unscrew the pump handle in an anti-clockwise direction(Fig 2)
3. Put out the pump(Fig 3)
4. Fill with the desired liquid to the max fill line as shown on bottle (Fig 4)
5. Screw the pump cover tightly in clockwise direction(Fig 5)
6. Pump about 25 times (Fig 6), safety valve will release if the inside pressure is too high .Don't over fill with water or air pressure.
7. The sprayer will work when the trigger on status, to spray continuously, slide trigger in lock position after depressing , to unlock ,slide the trigger back ; Adjust nozzle for mist and stream usage purpose (Fig 7)
8. After using ,release remain pressure (Fig 8)
9. After using ,pour out the remaining water.(Fig 9)