

# Instruction Manual

Petrol Lawnmower

**Model:** HG41SM-N139

**Petrol Engine:** N139, 139cc, OHV, Single Cylinder, 4 Strokes



**CAUTION:** Before any use, please read carefully the user manual this was purposely drawn up to provide you with all the necessary information for proper use and in compliance with basic safety requirements.



**Caution:** Read carefully the manual before use.



**Caution:** Keep other people well away from the danger area.



**Caution:** Risk of hand and feet injuries.



**Caution:** Emission of toxic gas, do not use the mower in a close area or not well ventilated.



**Caution:** hot surfaces.



**Caution:** Before carrying out any operation, please stop the engine and disconnect the spark plug cap.



**Caution:** Never fill up the fuel tank while the engine is running.

## **IMPORTANT:**

**Read with care the security requirements included in the engine manual before the first use of the engine.**

## Before the first use of the Mower

### SUMMARY

- 1/ DESCRIPTION
- 2/ ASSEMBLY OF GRASS BAG
- 3/ HANDLE ASSEMBLY
- 4/ CUTTING HEIGHT ADJUSTMENT
- 5/ SAFETY PRECAUTIONS
- 6/ OPERATION
- 7/ SAFETY RULES
- 8/ MAINTENANCE
- 9/ GUARANTEE

### 1 - DESCRIPTION

- |                 |                 |                        |                 |
|-----------------|-----------------|------------------------|-----------------|
| 1 Braking lever | 2 Driving lever | 3 Upper handle         | 4 Lower handle  |
| 5 Engine        | 6 Steel Deck    | 7 Height adjusting bar | 8 Grass catcher |

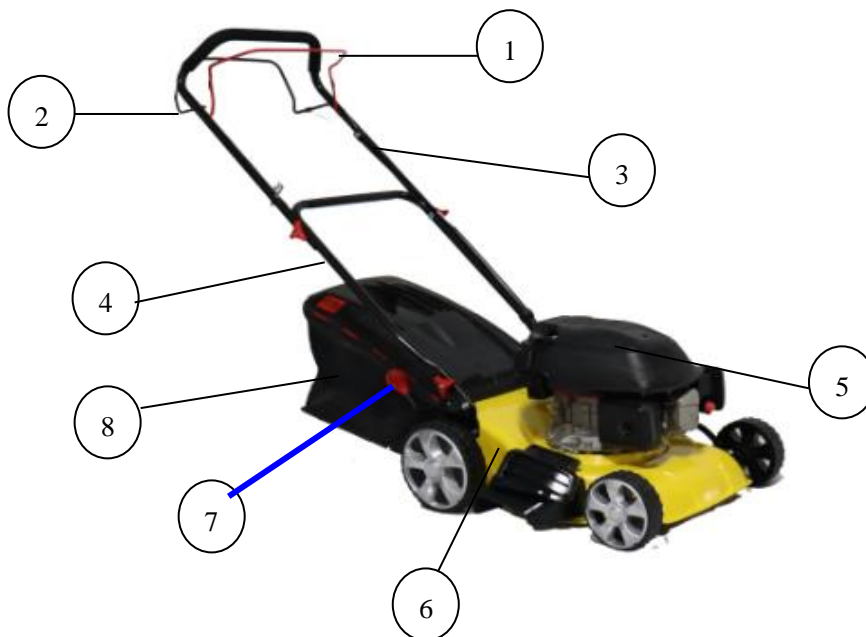

## 2 – ASSEMBLY OF GRASS BAG

- Put the metallic frame inside the grass catcher. (fig A)
- Fix the bag on the metallic frame. (fig A)
- Pull up the deflector and place the grass catcher at its place. (fig B)

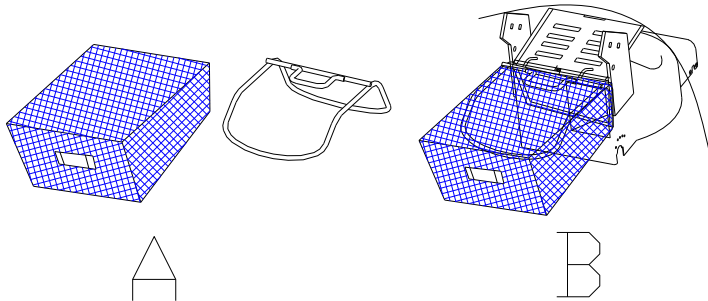

## 3– HANDLE ASSEMBLY

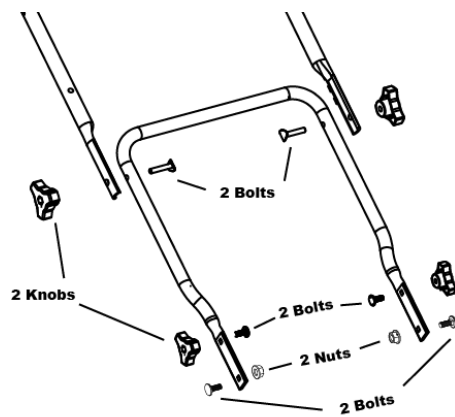

## 4– CUTTING HEIGHT ADJUSTMENT

One central height adjustment, 7 positions to select.

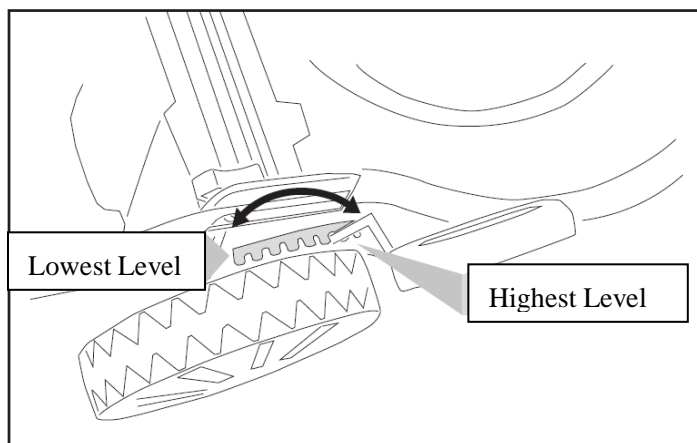

## 5- SAFETY PRECAUTIONS

- Always use the lawnmower with the grass catcher or/ and the deflector in position.
- Stop the engine before emptying the grass catcher or before you change the cutting height.
- While the engine is running, never introduce your hands or feet under the lawnmower or under the grass ejection area. (fig C)
- Before mowing, remove all foreign objects from the lawn, which maybe thrown by the machine. (fig D)
- Keep children and other people and domestic animals at a safe distance when the lawnmower is in use.
- Never lift the mower while starting the engine. (fig E)

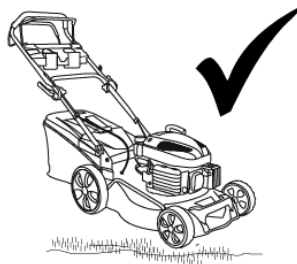
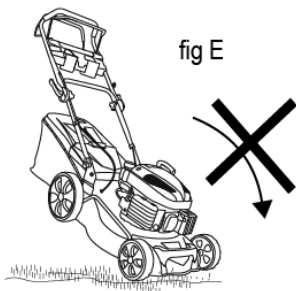
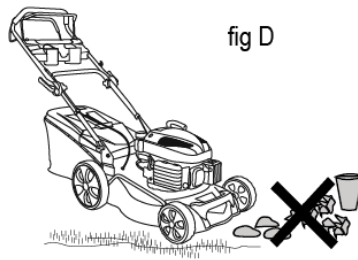
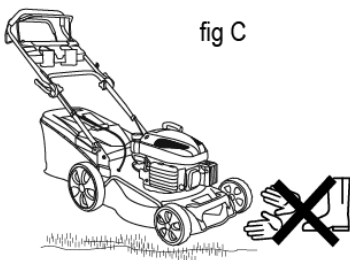

## 6- OPERATION



**Engine delivered without oil: Please add 0.50 litre oil before use.  
Attention: Every 20 hours replace the engine oil.**

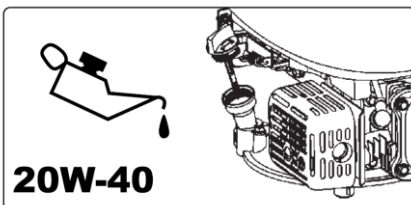

Blade is in action as soon as engine started. While the machine is working, maintain the engine control bar in working position. The engine will stop as soon as you release the engine control bar.

**A. COLD-STARTING THE ENGINE**

1. Press the primer button 3 - 5 times

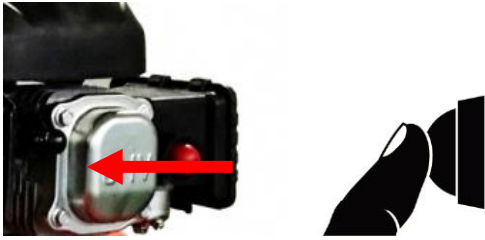

2. Pull the braking lever until it touches the upper handle, then pull the starter rope until the engine starts.

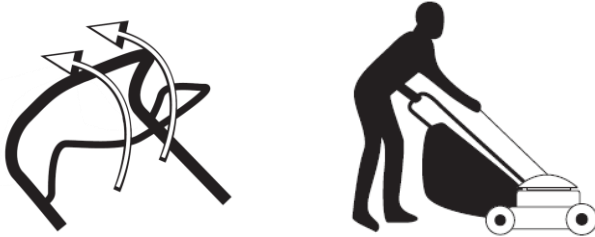

**B. WARM-STARTING THE ENGINE**

1. Pull the braking lever until it touches the upper handle.
2. Pull the starter rope until the engine starts.

**C. STOP THE ENGINE**

Pull the driving lever against the handle bar, while keeping the brake lever pulling.

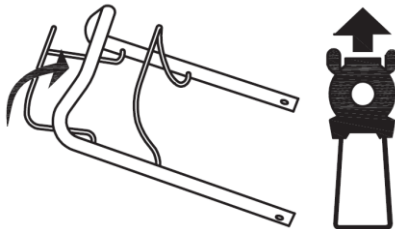

**D. STOP THE ENGINE**

Release the braking lever.



## 7- SAFETY RULES

### General conditions of use.

1. This machine is to be used exclusively for cutting natural grass. Never use the mower for other purposes. Any other utilization can involve danger for your safety and can involve damage to the mower.
2. Persons under 16 years of age and persons who are not familiar with the user instructions must not use the mower.
3. The user is responsible of the safety of other people in the working area. Keep children and domestic animals at a safe distance while the mower is in use.
4. Before mowing, remove all foreign objects from the lawn which may be thrown by the machine, stay alert for any foreign objects which may have been missed.

### USING INSTRUCTIONS

1. Check that all nuts, bolts and screws are well tightened.
  2. Before mowing place the grass catcher in its position.
  3. Before mowing make sure that the blade and the blade fixing screw are securely fastened. When cutting edges require resharpening, this must be done evenly on both sides so as to prevent any imbalance. If the blade is damaged, it must be replaced.
  4. When mowing always wear a long trousers and strong footwear.
  5. Do not run the engine in an enclosed and/or poorly ventilated area, where gas of the engine contains carbon monoxide, which are dangerous for your health.
  6. Work only when there is sufficient light.
  7. Do not use the lawnmower when it is raining or when the grass is wet.
  8. Particular precautions must be taken while mowing on slopes or downing stretches. Mow across the face of slopes, never down or up.
  9. Turn off the engine if you must leave the lawnmower unattended, displace the lawnmower or incline it.
  10. Never lift the rear of the mower while starting the engine and never place your hands and feet underneath the deck or into the rear discharge chute while the engine is running.
  11. **Never change in any way the rated speed of the engine.**
  12. Never lift or carry the mower while the engine is running.
  13. Stop the engine and remove the spark plug cover in these cases:
    - Before any operation under the deck or the grass rear discharge chute.
    - Before any maintenance, repairing or checking operations.
    - Before carrying, lifting or removing the mower.
    - If you leave the mower unattended or changing the cutting height.
    - To remove and emptying the grass catcher.
    - After hitting a foreign object, stop the engine and check thoroughly the mower in order to see if it is damage. Bring the mower in an agreed service station to do the repairing if necessary.
- WARNING: After you stopped the engine the blade is still in action during a few seconds.**

- If the mower vibrates in an abnormal way, find the reasons why, and take your mower to an agreed service station.
- Check regularly that bolts, nuts and screw are secularly tightening for a safe use of the mower.

#### 14. WARNING:PETROL IS HIGHLY INFLAMMABLE.

- Keep petrol in a jerry can specially made for this purpose.
- Fill up the tank with a funnel, do the operation outside. Do not smoke. Do not use mobile phone.
- Fill up with petrol and oil before staring the engine. Never open the cap of the fuel tank to add petrol while the engine is running or still hot.
- Do not start the engine if there is some petrol spread around, take the mower away from the one where petrol have been split and avoid any contact from a hot source as long as the split petrol is completely eva0porated.
- Tighten the fuel tank cap and close tightly the jerry can cap.

#### Maintenance and Storage

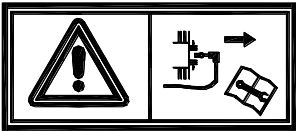

#### **WARNING:**

Stop the engine and unplug the spark plug before repairing or maintenance operations.

- Make sure that all nuts, bolts and screws are kept well tightened to keep the lawnmower in a safe operating condition.
- Never store the lawnmower with a tank with petrol in an enclosed area where petrol fumes could reach a strong heat source or a flame. Allow the engine to cool down before you store your lawnmower in any storage place.
- In order to reduce any risk of fire, clean the lawnmower and in particularly the engine, the muffler, the fuel tank. Suppress all grass traces or leaves or excess of grease.
- Check frequently the condition of the deflector and the grass catcher, replace them if the are damage.
- In case of drain oil of the tank before winter, do this operation outside.
- Wear thick gloves for the mounting and the sharpening of the blade. Be sure that the blade is always well balance.

## 8- MAINTENANCE

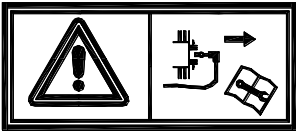

### WARNING:

Stop the engine and unplug the spark plug before repairing or maintenance operations.

Stop the engine and unplug the spark plug before any repairing or maintenance operations.

- For four strokes engine read carefully the maintenance engine manual. Check regularly the oil level and add some oil or replace it if necessary.
- Frequently check the lawnmower and ensure that all grass deposits are removed from beneath the deck.
- Lubricate regularly the wheel axle and the bearings with grease.
- Check often the blade, in order to obtain a clean work the blade should always be sharp and well balance.
- At regularly intervals check the tightening of all bolts and screws. Wear off or badly tightening nuts and bolts can involve some important damages to the engine or the frame.
- If the blade hits violently an obstacle, stop the lawnmower and bring it to agreed service station.

**THE BLADE:** the blade is made of pressed steel, in order to obtain a clean work, sharpen the blade frequently, around every 25 hours of work. Be sure that the blade is always well balance, introduce a small iron axle ( $\varnothing 2$  or  $\varnothing 3$  mm) in the central hole of the blade, it should stay horizontal.

If the blade does not stay horizontal balance, please replace the blade from the manufacturer.

To remove the blade, unscrew the screw, check the blade support and change all spare parts if they are worn out or damage.

When reassembling the blade, make sure that the cutting edges face in the direction of the engine rotation. The blade screw must be torque to 3.7 K-gm(37Nm) with a HGnamometric tool.

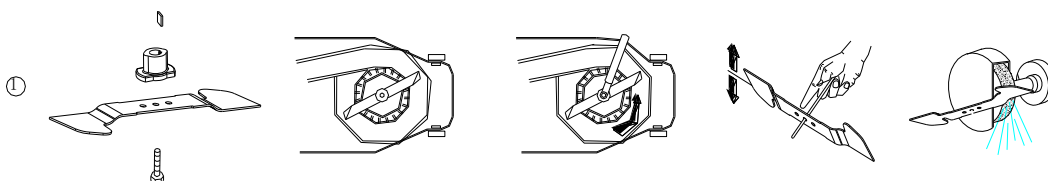

**ONLY USE ORIGINAL SPARE PARTS. SPARE PART OF BAD QUALITY CAN INVOLVE IMPORTANT DAMAGES TO YOUR LAWNMOWER AND BE PREJUDICIAL FOR YOUR SECURITY.**

## TECHNICAL DATA:

Engine Model:	N139
Rated Power:	2.3kW
Rated Speed:	2800/min
Displacement:	139cc
Starting:	Recoil
Fuel Tank:	1000ml
Oil Capacity:	500ml
Cutting Heights:	25-70mm, 7 positions
Height Adjustment:	One central adjustment
Cutting Width:	405mm
Grass Bag:	40L
Deck Material:	Steel
Weight:	24 kg

## 9- GUARANTEE

### WARRANTY CONDITIONS:

The manufacturer warrants the product 12 months from the date of purchasing, from all fabrication faults. The lawnmowers that are used in a professional or locative way are warranted 3 months. The warranty cannot be claimed in case of normal wear.

The manufacturer will replace at his expense the spare parts, which would be classified as defective by him or an agreed station service. In any case the manufacturer will not accept the reimbursement of the machine (partially or totally) and/or damages and interest direct or indirect.

The warranty does no cover:

- An insufficient maintenance.
- An abnormal use or damage due to shocks.
- The mounting, adjustment and preparation of the machine.
- The spare parts with normal wear, security spare parts (belt, blade, blade support, bearings, cables, deflectors, spark plug, air filter etc...)
- Freight and packing cost.
- Only use spare parts coming for the manufacturer **Callow Retail – [sales@callowretail.co.uk](mailto:sales@callowretail.co.uk) or 01522 704505.**

The manufacturer will refuse any responsibility if the machine was not used for the purpose it was made or if the operator did not use the machine as describe in the operations and maintenance rules in the owner manual. Read carefully the instruction manual before any use of the lawnmower. For all spare parts order you must specify the reference of the mower the construction year, the serial number of the mower and of the engine.

### **EC Declaration of Conformity**

We Callow Retail Ltd – Hereby declare that the following designated device, based on its design and construction and in the version marketed by us, complies with the relevant, basic safety and health requirements of the EC directives.

This declaration relates only to the device in the condition in which it was placed on the market and does not take account of parts added or interventions carried out subsequently by the end user.

that the following product complies with the appropriate basic safety and health requirements of the EC Directive based on its design and type, as brought into circulation by us from the manufacturer. In case of alteration of the machine, not agreed upon by us, this declaration will lose its validity

- 1: Machine Description: Petrol lawn mower for cutting domestic grass and lawns
- 2: Machine Type/models: HG41SM-N139
- 3: Applicable EC Directives: EC Council Directive 2014/30/EU
- 4: Applicable Harmonized Standards: EN ISO 14982:2009
- 5: Authorized person for the compilation of the technical documentation: Scott Frances
- 6: Authorized Signature/Date/ Place:

Callow Retail Ltd  
Unit 11 Stirlin Court  
Saxilby Enterprise Park  
Lincoln  
LN1 2IR  
01522 704505  
**Signature** – On Behalf Callow Retail Ltd



Managing Director

**Signature on Behalf of Factory** – Authorising Callow Retail Ltd as Distributor and Confirming the Above Standards.