

PETROL TILLER
MODEL HG60T-N173
MANUAL INSTRUCTION



Petrol Engine: N173, OHV, 173cc Single Cylinder, 4 Strokes

WARNING!

This is a Warning symbol. The symbol is used through the Instruction Booklet whenever there is a risk of personal injury. Ensure that these warning were read and understood at all times.

CAUTION!

This is a Caution symbol. The symbol is used through the Instruction Booklet whenever there is a risk of personal injury. Ensure that these warning were read and understood at all times.



This symbol means the engine speed is slow.



This symbol means the engine speed is fast.

WARNING SYMBOLS

The following symbols are displayed on the machine in order to remind you of the safety precautions you should take when operating the tiller



Read this instruction booklet carefully before using the tiller and keep it in a safe place for future reference.

WARNING!

This tiller uses petrol and oil. Always take extreme precautions when operating or moving this machine.

WARNING!

Turn off the engine and disconnect the spark plug cap before cleaning, transporting, making any adjustments or leaving the tiller unattended.

WARNING!

Never put your hands or feet under the tiller deck while the blade is being rotated.

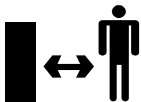
WARNING!

There is a risk that stones and other objects could be thrown out by the tiller. Always keep other people, children pets at a safe place.

Read this manual carefully before putting the unit in operation

Every effort is made to improve our products continuously. Therefore, technical data and figures are subject to change.

1 Unit

The lightweight tiller is equipped with a high-efficient 4-stroke engine. A rugged design for light to medium heavy soils is ideal for tilling close-planted crops. Please extra-silent and steady run. A tiller of special steel, only little wearable provides for good cost-effectiveness. A special shape of blades provides for thrifty and efficient tilling. It is easy operation by use a turning guide wheel. Start-up system responding to a button pressing (the tiller will run upon pressing an operation button in rest state) improves the labor safety.

Scope of Delivery

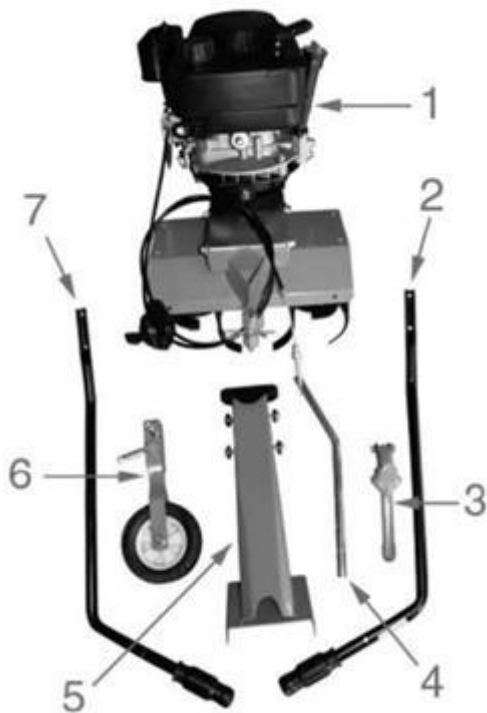

Fig. 1

1. Carriage
2. Left-hand handle (driving lever)
3. Driving lever
4. Depth limiter
5. Bracket and handle
6. Wheel
7. Right-hand handle (ON/OFF, SPEED)

2 General Safety Instructions

Prior to the initial use of the unit, the operating instructions should be read completely. If in doubt with regard to connection and operation of the unit, consult the manufacturer (Servicing Department)

FOLLOW THE INSTRUCTIONS BELOW CAREFULLY IN ORDER TO SECURE A HIGH DEGREE OF SAFETY:

CAUTION!

1. Pay attention to the conditions of the area, which you're working in. After the engine is started, power machine will produce poisonous flue gas. The gas may be invisible and odorless. Hence never work with the machine closed or poorly ventilated areas. Provide for good lighting when cutting. Provide for stability when cutting in wet, snow or icy weather conditions on slopes or rough ground.
2. Do not let any unauthorized persons approach the machine. The visitors and viewers, primarily the children, the ill and infirm persons should not have any access to the working area. Prevent other persons from any contact with the machine.
3. Make provision for the tools storage. The machines not in current use should be kept in a dry place, elevated or locked where practicable so that any access to them is prevented.
4. Always use a correct tool for the job to be done. E.g. avoid using small tools and accessories for work that should be actually done with a heavy tool. Use the tools only for the purposes they were designed for.
5. Pay attention to adequate clothing. The clothing should fit the purpose and should not put any limits to you when working.
6. Use personal protection equipment. Wear safety shoes with steel toes and antiskid or rough sole.
7. Wear goggles. Object may be thrown against you.
8. Wear ear protectors. Wear personal protective equipment to protect your ears, such as ear protectors.
9. Hand protection. Wear hard gloves-gloves of chrome tanned side leather give a good protection.
10. Transport. The tiller should be always transported with the driving wheel in transport position. Make sure that nobody is exposed to risk when the tiller is put out of service. Secure the unit against tilting, damage and fuel leakage.
11. Remove the wrench etc. Any wrenches/spanners etc. must be removed before the tiller is put on.

12. Be attentive any time. Mind what you are doing. Use common sense. Do not use the tiller when tired. Never work with the crusher when influence by alcohol, drugs or medicaments affecting the concentration capability.
13. Refueling. Always switch the engine off before refueling. Open the tank closure carefully for overpressure run out slowly and the fuel ejaculation is prevented. When working with the tiller, the unit body temperature increased. Let the unit cool down before refueling. Otherwise, the fuel could ignite and persons get burnt. Beware of overfilling the tank. If there is a spill, remove it and clean the unit. After finishing the refueling, make sure the screwed closure is tight to avoid loosening in result of vibrations.
14. Watch out for any damaged parts. Inspect the machine before use. Are any parts damaged? Ask yourself seriously when detecting slight damage whether the machine will work perfectly and safely despite that. Watch out for proper aligning and adjustment of any moving parts. Do the parts fit one in another properly? Are the part damaged? Is everything installed as appropriate? Are any other prerequisites of proper working in place? Damaged protective devices etc. must be repaired or replaced by authorized entitles unless the operation manual expressly says otherwise. Any defective switches must be replaced at an authorized servicing centre. Do not use the machine if it cannot be put on and off with the switch. When repairs are necessary, kindly turn to your local servicing centre.
15. Switch the engine off before any adjustment and maintenance. That applies to the blades replacement in the first place.
16. Use approved parts only. Use only identical spare parts for maintenance and repairs. Request advice of an authorized servicing centre for this purpose.

2.1 Emergency Action

Apply the first aid adequate to the injury and get qualified medical assistance as quickly as possible. Protect the injured person from more accidents and calm him/her down.

2.2 Assigned Use

The unit is designed only for regular use in agriculture, forestry, and horticulture and area treatment. The manufacturer should not be held liable for any personal and material losses due to a failure to observe these rules.

3 Transportation and Storage

- The unit is allowed to be transported with the engine off only
- Clean the unit thoroughly before putting in on storage
- Store the unit at a dry clean place



Fuel or oil may leak at transport. Secure the unit as appropriate and take preventive action to protect the environment against contamination.

4 Assembly and First Putting in Operation

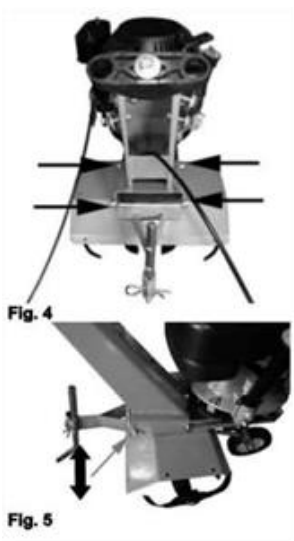
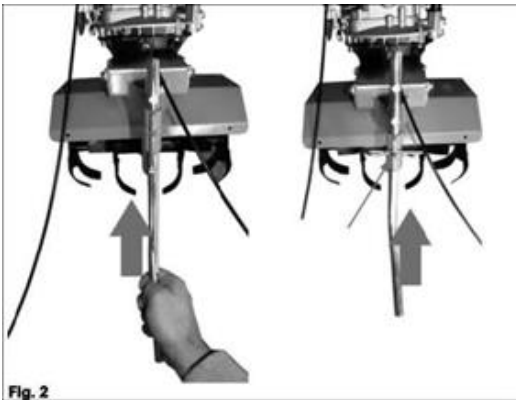



Refueling Use only regular leadless petrol



- Refuel outdoors only!
- Never refuel with engine running or while it still hot!
- Do not smoke and do not handle open fire!

Engine oil filling

Use only oil type 15W40

Use oil dip rod to check the filling status.



Avoid fuel or oil splashing so that soil contamination is avoided.

Use appropriate tools for filling (funnel)

4.1 Safety Instruction for the First Putting In Operation

Always make sure that the screwed parts are tight as appropriate and use only the parts included in the delivery.

4.2 Procedure

Assemble separate parts in the correct order as shown. Make sure that structural parts are arranged as shown in figures.



The unit is delivered without oil and fuel. Fill in the liquids according to specifications.

5 Operation



Guiding wheel in work position

Put the wheel in pos.1 for tilling.

CAUTION!

Transport the unit with the wheel in position 2.

The wheel should be adjusted with engine off only!

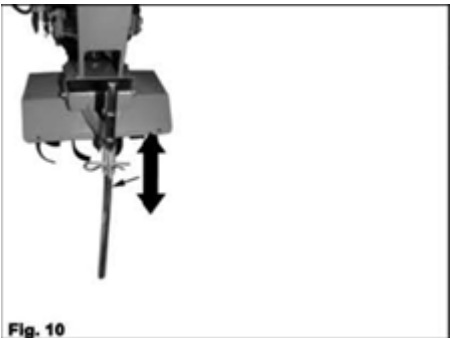

Cutting height setting

Shifting the depth limiter shall set up the required depth of tilling. 3 different positions are possible.

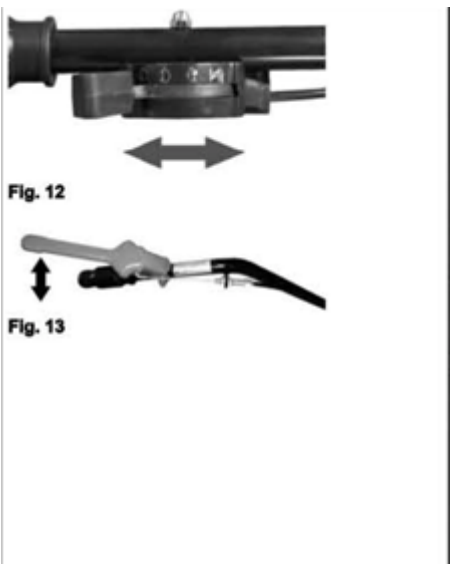

Switching unit on/off

Put the lever on the chute (Fig 12). Pull the starter cable evenly. The engine should start up after 3-5 pulls. Put the lever at the required speed and pull the driving lever (Fig. 12) against the handle (Fig. 13)

Notice: If the engine is heated up, it is possible to start up in the slow/fast position.

With the driving lever tripped, the drive will be off but the engine works on. The engine may be switched off with the switch in **OFF** position (Fig. 12)

5.1 Operator Safety Instruction

- * Do not use the machine until you have read the instruction manual carefully.
- * Observe any safety instruction included in the manual.
- * Be responsible to the others
- * The unit is provided with a foot-operated brake that stops the blades within 3 seconds after the drive lever tripping. Never attempt stopping the unit or tilting the unit with blades still rotating. Wait for the blades to come stand by themselves.
- * If the blades get in touch with foreign objects, stop the engine immediately and check the unit with blades stopped for damage. Continue working with unit undamaged only.
- * Walk while working and do not run.
- * Always walk forward only. Never pull the unit walking backwards.
- * When working on a slope, always work across, never down and up. Be particularly careful when changing direction.
- * When travelling across ungrassed areas and transferring the unit from the work area to another one, the blades must not be operating.

5.2 Step-by-Step Instructions

1. Fill in the fuel (see chapter Assembly and First Putting In Operation)
2. Clear any foreign objects from the land.
3. Spud the land until the soil is sufficiently loose.
4. Clean the unit thoroughly after every use.

6 Troubleshooting

Trouble	Cause	Troubleshooting
Engine will not start	<ol style="list-style-type: none">1. Empty tank2. Fouled air filter3. No ignition spark4. Flooded engine	<ol style="list-style-type: none">1. Fill in the tank, check the fuel in carburetor, and clean the hole in the lid with a needle.2. Clean the air filter.3. Clean the ignition plug or use a new one.4. Remove the plug, clean and wipe dry; pull the starting cable several times with the plug removed.
Faltering engine	<ol style="list-style-type: none">1. Ignition cable detached2. Fuel piping clogged or wrong fuel3. Blocked hole in the fuel	<ol style="list-style-type: none">1. Push the plug socket firmly on the plug.2. Clean fuel piping, use fresh/different fuel.3. Replace the fuel tank cover

	tank cover. 4. Water or dirt in fuel system 5. Fouled air filter	4. Drain the fuel and refuel. 5. Clean the air filter
Engine often switches off when idling	1. Too long ignition interval, defective ignition plug 2. Carburetor not set correctly 3. Fouled air filter	1. Adjust/replace the ignition plug 2. Set up the carburetor
Drive will not work properly	1. Check the drive lever cable tension 2. Drive does not work	1. Adjust the cable tension if necessary. 2. Have the unit checked in a servicing shop
Excessive vibrations	1. Loose lock screws	1. Tighten the lock screws

7 Inspections and Maintenance

7.1 Inspections and Maintenance Safety Instructions

The machine will serve as a sufficient aid only if maintained and care for appropriately. Insufficient maintenance and care may result in accidents and injuries.

- Prior to any works on the unit, always switch the engine off and pull the sparkle plug socket out!
- Never use aggressive detergents for cleaning. That could result in damage or destruction of the unit.

7.2 Inspection and Maintenance Schedule

Time Interval	Description
Before start of work	<ul style="list-style-type: none"> ● Check the engine oil level ● Check for any loosen parts
Every 25 operating hours	<ul style="list-style-type: none"> ● Exchange the engine oil ● Check the engine oil level ● Clean the air filter ● Remove remnants of grass from rotating parting with a brush or a blunt tool ● Wipe the body with a soft cloth ● When the dirt is hardened, the unit may be cleaned with soft cloth wetted in soapy waters
Every 100 operating hours	<ul style="list-style-type: none"> ● Check, clean or replace the ignition sparkle plug

8 Technical Data

Drive Type:	Hand push
Engine Model:	N173
Engine:	4-stroke, Forced air cooling, Single cylinder, OHV
Rated Power:	3.2 kW
Rated Speed:	3000rpm
Displacement:	173cc
Starting:	Recoil
Oil volume	0.5 L
Fuel Tank Volume:	1.0 L
Cutting Path:	360/600mm
Wheel Diameter:	6"
N.W./G.W.:	31.7kg/34.7kg

⚠ Due to continual improvement, specifications are subject to change

EC Declaration of Conformity

We Callow Retail Ltd – Hereby declare that the following designated device, based on its design and construction and in the version marketed by us, complies with the relevant, basic safety and health requirements of the EC directives.

This declaration relates only to the device in the condition in which it was placed on the market and does not take account of parts added or interventions carried out subsequently by the end user.

that the following product complies with the appropriate basic safety and health requirements of the EC Directive based on its design and type, as brought into circulation by us from the manufacturer. In case of alteration of the machine, not agreed upon by us, this declaration will lose its validity

- 1: Machine Description: Petrol tiller for agricultural and forestry machinery
- 2: Machine Type/models: HG60T-N173
- 3: Applicable EC Directives: EC Council Directive 2014/30/EU
- 4: Applicable Harmonized Standards: EN ISO 14982:2009
- 5: Authorized person for the compilation of the technical documentation: Scott Frances
- 6: Authorized Signature/Date/ Place:

Callow Retail Ltd
Unit 11 Stirlin Court
Saxilby Enterprise Park
Lincoln
LN1 2IR
01522 704505

Signature – On Behalf Callow Retail Ltd



Managing Director

Signature on Behalf of Factory – Authorising Callow Retail Ltd as Distributor and Confirming the Above Standards.

without prior notification.