

WARMROOM®

magnetic radiator heat saver

**REDUCES HEAT LOSS
BY UP TO 60%**

**ROLL SIZE:
195mm x 30m**

Enough to cover 10 average sized radiators

TRADE

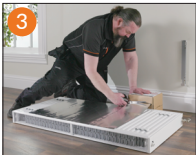

TRADE INSTALLATION INSTRUCTIONS

Fitting the magnetic WARMROOM® roll can easily be done prior to or after installing the radiator.

You will need a pair of scissors or a Stanley knife. A pencil and measuring tape can be used if measuring required.

Always apply the WARMROOM® material vertically top to bottom so each panel remains accessible for cleaning or removal at a later date.

1. Place the radiator on its face and position the WARMROOM® dispenser at the bottom of the radiator.
2. Pull the WARMROOM® roll out of the dispenser up to the top of the radiator and cut once in position.
3. Position each panel side by side, with the shiny side facing towards you.
4. Extra panels of WARMROOM® can be easily cut to fit inbetween & outside the mounting brackets if required.
5. Can be retrofitted to radiators quickly and easily.

For use on steel, water filled, radiators of all sizes.

Not suitable for electric radiators.

For more information or to watch our instructional video visit www.anchor magnets.com/warmroom

Patent: GB2374951

am
anchor magnets

UK ADDRESS: Bankside Works,
Darnall Road, Sheffield, UK, S9 5AH

EU ADDRESS: GMBH C/O Kühne + Nagel
An der Lache 8, 36179 Bebra, Germany

T: +44 (0) 114 244 1171 E: sales@anchormagnets.com W: www.anchor magnets.com