

User Guide

Pushbutton combination

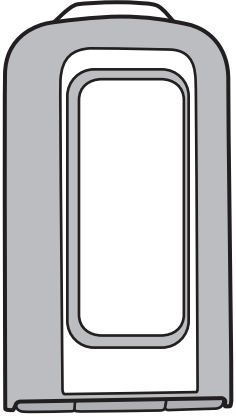

P/N 10102770P1-01 Rev. L • July 2021
© 2021 Kidde.
All rights reserved.

A

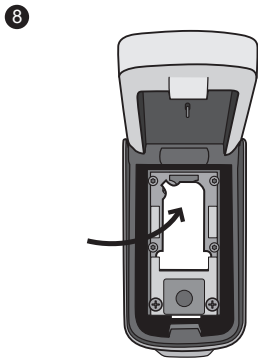
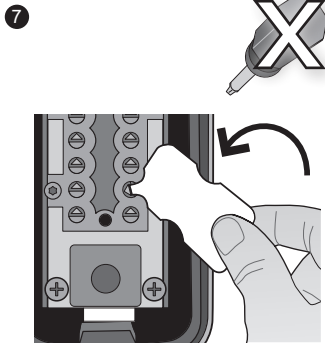
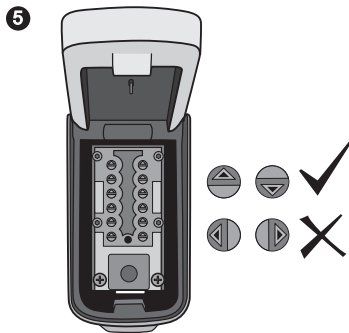
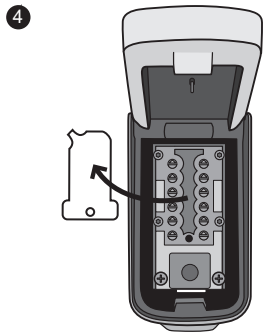

B



C

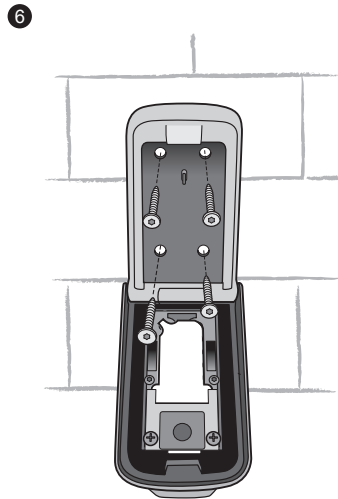
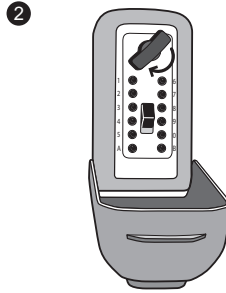
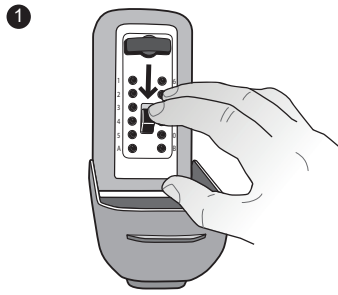

D

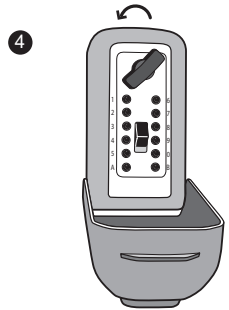
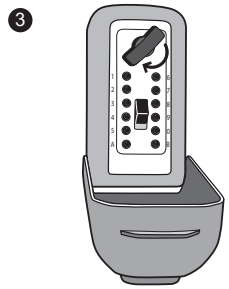
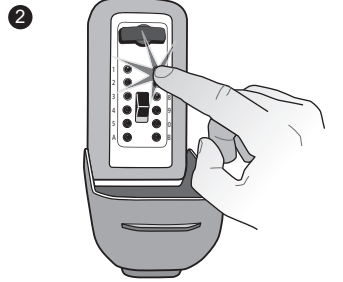
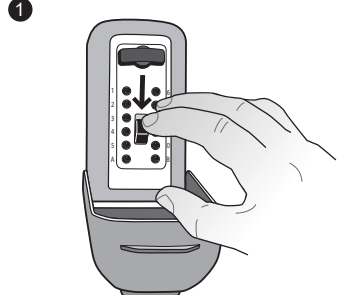

Installation Instructions

See pictures for step-by-step instructions. Further information is provided below.

 = Enter the combination.

A. Setting your combination

- There is no preset combination on your KeySafe Consumer 500. Select your own combination. Each number/letter can only be used once.
 - Do not use a combination that can be easily guessed.
- Hold the clear plastic tab and pull open the weather cover.
 - Press down on the CLEAR button.
 - Turn the OPEN handle clockwise 180° to open the lid.
 - Slide the plastic instruction card on the lid towards the hinge of the KeySafe and remove the card.
 - There are ten numbered buttons and two lettered buttons with arrows on the back of the lid. Arrows pointing away from the hinge are OFF and are not part of the combination. Arrows pointing towards the hinge are ON and are part of the combination.
 - With the KeySafe open, turn the open handle counter clockwise 180°, back to the locked position.
Important! The OPEN handle must be in LOCKED position before the code can be changed. Forcing the setting buttons when in the OPEN position may damage the KeySafe and void the warranty.
 - Use the code change tool on the plastic card provided to set the combination.
Note: Do not use a screwdriver!
To add a number or letter to the code, use the code change tool to push in the grooved arrow by the number/letter you wish to set. Turn 180° until the arrow pops back up completely and the arrow points in the ON direction. To remove a number or letter from the code, use the code change tool to push in the grooved arrow by the number/letter you wish to set. Turn 180° until the arrow pops back up completely and the arrow points in the OFF direction.
 - Place the plastic card over the back of the lid and slide back into place.

B. Testing your combination

- Make sure OPEN handle is in the locked position. If not, turn OPEN handle counter-clockwise until it's in the locked position. On the front of the KeySafe, press only the buttons in your combination. Press each button in until it clicks. If you press the wrong button, push down on the clear button and enter your code again.
- Turn the OPEN handle clockwise 180° to open. If the combination is set correctly, the OPEN handle will turn fully and the locking bolt will retract. If not, push down the CLEAR button and refer to section A. Setting your combination.

C. Mounting the KeySafe Consumer 500 Pro

- Press down on the CLEAR button and enter the combination set in Section B.
- Turn the OPEN handle clockwise 180° to open the lid.
- Use the mounting template to position the holes so they are as close to the center of the brick as possible. Do not install screws into mortar since this will weaken the mounting.
- Use the mounting template to drill four mounting holes using a 5mm masonry drill bit to a depth of at least 7mm deeper

- than the length of the screw.
- Clean out dust and debris from all holes.
 - Position the KeySafe on the four holes and drive the screws directly into the brick. **Note: You must use the included size 6x60mm masonry screws provided and install the Keysafe into brick or concrete to maintain the LPS 1175 security certification. When mounting on a rendered wall, the maximum thickness of the render cannot exceed 10mm. Note: a rendered substrate is not covered within the approval to LPS 1175.**
- Note: Do not mount KeySafe closer than 6" or 15cm to the corner of a masonry surface. Make sure KeySafe is mounted flush with masonry surface and the masonry screws are only installed directly into brick. Never install masonry screws into mortar. Minimize all gaps between back of KeySafe and masonry surface.**
- Tighten the screws until the heads are snug against the back of the KeySafe. Be careful not to over tighten the screws.

D. Opening and Closing your KeySafe

- Press down on the CLEAR button.
- Enter the combination. If you enter an incorrect combination, press down on the CLEAR button to reset the buttons and reenter the combination.
- Turn the OPEN handle clockwise 180° to open. When you turn the handle, the combination will clear. **Note: The open handle is designed so it cannot be forced open. If an incorrect code is entered and the handle is forced, the handle will unlatch from the locking mechanism and turn freely without opening. To reset the handle, turn it all the way back to the locked position where it will snap back into place.**
- To relock, close the lid and turn the OPEN handle counter-clockwise 180° back to the locked position.

Parts Included

KeySafe Consumer 500 Pro, 002049 includes:	
Masonry mounting kit	10102698G1-01
Code change tool	

Accessories/Replacement Parts

Item	Part #
Weather cover	10102726P1
Code tamper plate	10102703G1
Masonry mounting kit	10102698G1-01
Key Cover	10102725P1

KeySafe™ Consumer 500 Pro

Mounting Template

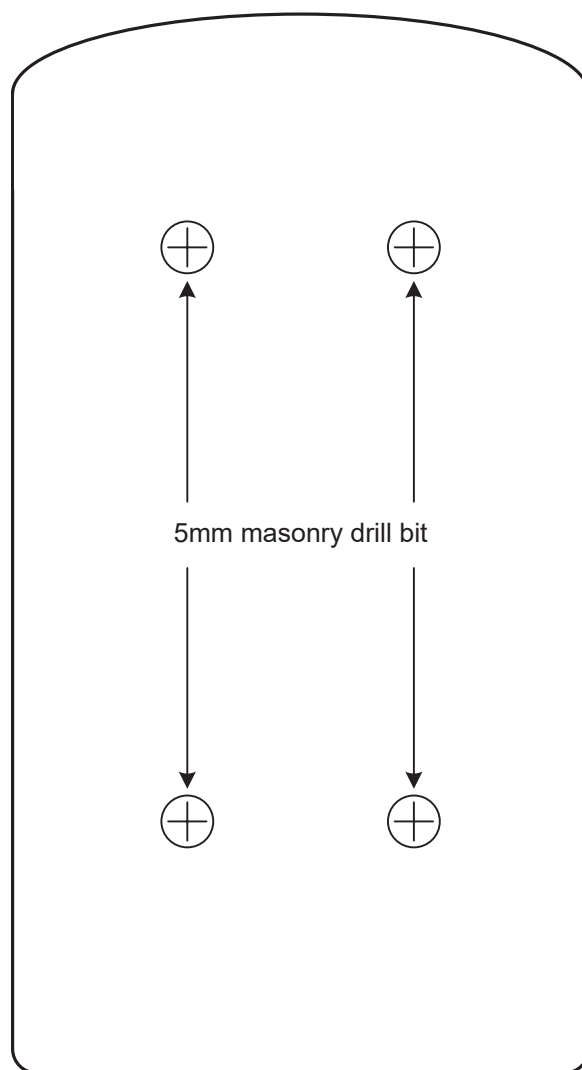

Tools Needed

- Drill
- 5mm masonry drill bit
- Torx T30 screwdriver

Limited Warranty

UTC Fire & Security ("UTCFS") warrants that this product will be free of defects in material and workmanship for one year (two years in Europe) from the date of purchase. This warranty is limited to repair or replacement at UTCFS' option. This warranty does not cover forgotten or incorrectly set combinations. Damage caused by modification, abuse or misuse, wear and tear, improper installation, application, storage, or fault or negligence of a party other than UTCFS are not covered. UTCFS will not be responsible for labor costs of removal or reinstallation of products. The repaired or replaced product is then warranted under the terms of this limited warranty for the balance of the term of the warranty or for 90 days, whichever is longer. UTCFS MAKES NO OTHER WARRANTY, EXPRESS OR IMPLIED, OF MERCHANTABILITY OR FITNESS FOR A PARTICULAR PURPOSE. IN NO EVENT SHALL UTCFS BE LIABLE FOR LOSS OF USE, LOST PROFITS, THEFT, PROPERTY DAMAGE, SPECIAL, INCIDENTAL OR CONSEQUENTIAL DAMAGES. To obtain repair or replacement information under the terms of this warranty, please contact your local supplier.



www.keysafe.co.uk