

Motorcycle Front Paddock Stand

KCT

MBS102

Assembly Instructions

Imported by:

KCT Direct
Glebe Farm,
Old London Road,
Copdock, Ipswich,
Suffolk, IP83JN,
United Kingdom



**Max Weight
750lbs**

Please read the following installation instructions carefully.

We accept no liability for damage to property and/or personal injury resulting from improper or faulty installation or use.

Please check the correct function before each use.
Re-tighten the screws if necessary.

Subject to technical changes, printing errors and mistakes.



**DO NOT START THE MOTORCYCLE ON THE STAND
DO NOT SIT ON THE MOTORCYCLE WHEN IT IS LIFTED BY THE STAND**

Parts List

Required tools - Open ended spanner SW17 & 6mm hexagon key.

Parts

A. Handle Frame	x1
B. Wheel Frames	x2
C. U Type Adapters	x2
1. Bolts	x2
2. Lock Nuts	x2
3. Knobs	x2
4. Washers	x4



Assembly

Step 1: Mount the Wheel Frames (B) to the Handle Frame (A). Use the Bolts (1) and the Nuts (2) and Washer (4) for this purpose.

Step 2: Connect the U Type Adapters (C) to the Wheel Frames (B) using the Knobs (3).



Motorcycle Rear Paddock Stand Dolly

KCT

MBS111

Assembly Instructions

Imported by:

KCT Direct
Glebe Farm,
Old London Road,
Copdock, Ipswich,
Suffolk, IP83JN,
United Kingdom



Please read the following installation instructions carefully.

We accept no liability for damage to property and/or personal injury resulting from improper or faulty installation or use.

Please check the correct function before each use.
Re-tighten the bolts if necessary.

Subject to technical changes, printing errors and mistakes.



**DO NOT START THE MOTORCYCLE ON THE STAND
DO NOT SIT ON THE MOTORCYCLE WHEN IT IS LIFTED BY THE STAND**

Parts List

Required tools - Open ended spanner SW17 & 6mm hexagon key.

Parts

A. Base Carrier	x1	5. Bolt M8x60	x2
B. Handle Frame	x1	6. Washer M8	x2
C. Wheel Frames	x2	7. Washer M10	x4
D. Reel (with Bracket)	x1		
E. Mountings	x2		
F. Hexagon Bolts	x2		
1. Bolt M10x60	x2		
2. Nut M10	x2		
3. Pins	x2		
4. Locking Plate	x2		

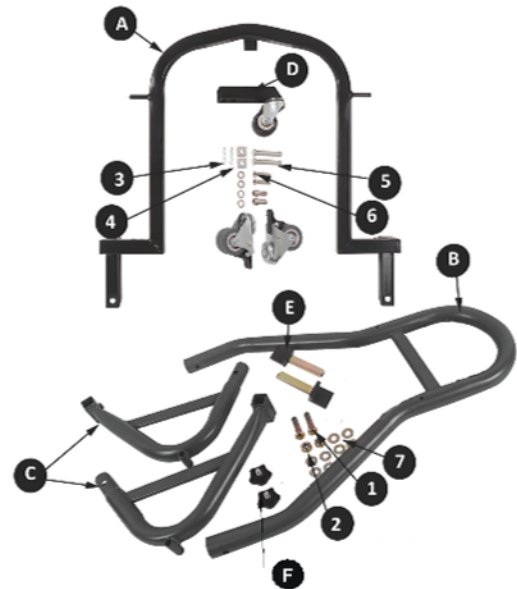

Assembly

Step 1: Mount the wheel frames (C) to the base carrier (A). Use the bolts (1) and the locking plates (4) for this purpose.

Step 1



Step 2: Connect the wheel frames (C) to the handle frame (B) using the M10x60 bolt (1), Nut (2) and Washer (7).

Step 2



Step 3: Mount the reel with bracket (D) to the base carrier (A), use the M8x60 bolts (5) and the M8 washers (6) for this.



Step 4: Install the mountings (E) and secure them with the Hexagon Socket Bolts (F).



Step 5: Place the base stand on the roller stand. Secure it with the bolts and the locking plates.

