

# SUPERLOCK 2.0 RAPID RESET DOUBLE SIDED KEYPAD

## Specification Sheet BDGRR 2.0

### PRODUCT DETAILS

- **RapidReset:** Enables you to change codes in just seconds.
- **Easy to fit:** Slim 70mm (2 3/4") wide lock case, along with an adjustable and removable latchbolt, ensures easy fitting to gates.
- **Secure:** The latchbolt moves 15mm (5/8"), ensuring the bolt enters deep into the gatepost.
- **Durable:** The latchbolt is supported on the edge of the gatepost to reduce friction and wear.
- **Anti-corrosion:** Designed for outdoor use for long-lasting performance.
- **Auto-latching:** Includes a gate post strike plate for easy and secure latching.



Product code	Description
BDGRR1030L	To fit 10-30mm (1/2" - 1 1/4") gate frames, left hand
BDGRR4060L	To fit 40-60mm (1-1/2" - 2-1/4") gate frames, left hand
BDGRR1030R	To fit 10-30mm (1/2" - 1-1/4") gate frames, right hand
BDGRR4060R	To fit 40-60mm (1-1/2" - 2-1/4") gate frames, right hand

### INSTALLATION

1. Drill 2 x 9mm (3/8") holes at 140mm (5 1/2") centres for fixing bolts provided.
2. Drill a 18mm (3/4") clearance hole for the latchbolt at 60mm (2 3/8") centres up from the bottom fixing hole.
3. Fix the handles to the square spindles so that the handles are facing away from the latchbolt and secure using the hex key.
4. Hold the lock against the back of the box section and screw on the latchbolt through the larger hole.
5. Lock the latchbolt with the hex key supplied by inserting the hex key into the end of the latchbolt.
6. Fix lock in place using the stainless steel bolt support plate and the countersunk screws provided. Ensure the latchbolt moves freely.
7. Weld or screw fix the strike plate to the gate post.
8. **Maintenance:** Every 6 months, lubricate the latchbolt with light oil. Annually, dismantle the lock and spray mechanism with light

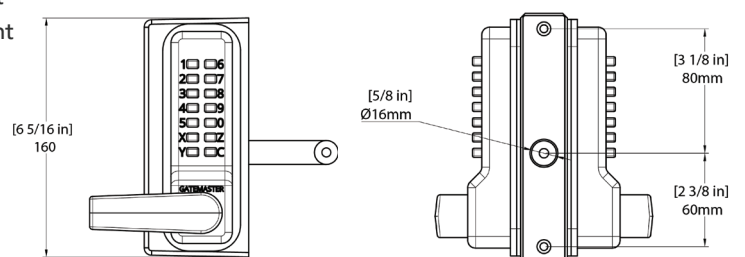
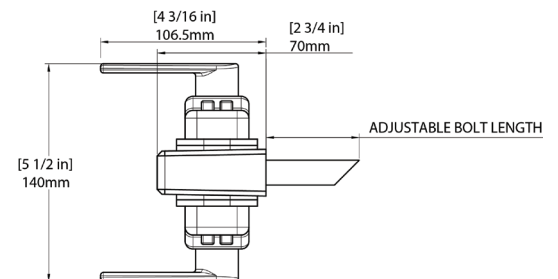
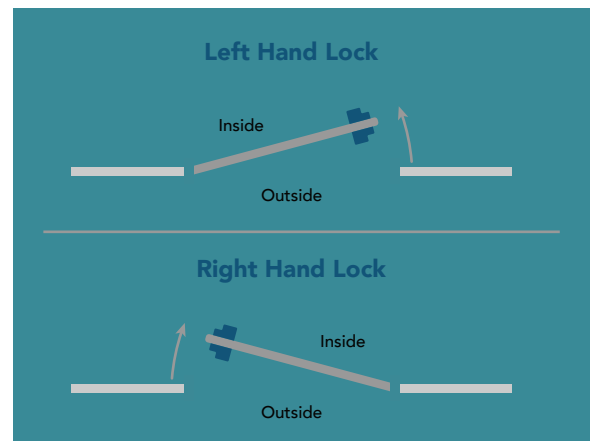

WATCH VIDEO  
 OF INSTALLATION

