

# AIYAPLAY

IN241000225V01\_UK

**AA1-119V70**

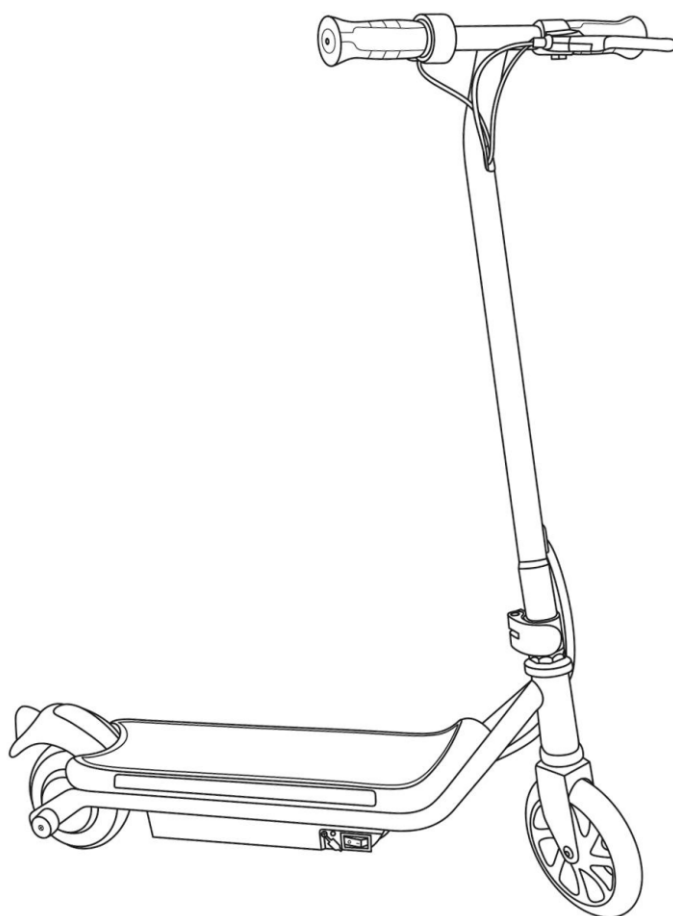

## **ELECTRIC SCOOTER**



**WARNING:** Certification Age: 6+ years old; Max weight: 50 kg(110lbs).

**IMPORTANT, RETAIN FOR FUTURE REFERENCE: READ CAREFULLY**

# USER'S MANUAL

## **SAFETY AND WARNINGS**



**WARNING:** Riding an electric scooter can be a dangerous activity. Certain circumstances may cause the components to fail without fault of the manufacturer. A scooter can and has the intention of accelerating so that it is possible to lose control, fall and / or be in dangerous situations that can not be avoided even if care, instruction or experience is taken care of. If this happens, you may be injured or killed, even when using safety equipment and other safety precautions.

Before use, please read the user manual and safety warnings carefully, and make sure you understand and accept all the safety instructions. The user will be responsible for any loss or damage caused by improper use.

- Any rider who can not fit comfortably on the scooter should not try to ride it. A parent's decision to allow their child to use the scooter should be based on the child's maturity, ability, and ability to follow the rules.
- All safety labels need to be in place and understood by the operator.
- Always inspect all the scooter components if they are loose or damaged, tighten loose components or call customer service if parts need to be replaced.
- Before riding, make sure the brake system is working properly.
- Always inspect the tire conditions before using this scooter.
- Always use the scooter in a safe, secure environment on flat, smooth paved surfaces only.

### **Please understand and accept all the warnings.**

- The recommended age of the rider is 6 years old and more.
- The rider should not exceed 50kg(110 lb).
- Adult supervision is required.
- Always wear protective equipment such as helmet, knee pads, and elbow pads.
- Always wear shoes and keep shoelaces tied, never operate the scooter barefooted.
- Hold the handlebars with both hands at all times.
- Make sure your feet are always placed securely on the deck.
- The scooter shall not be operated to perform racing, stunt riding, or other maneuvers, which may cause loss of control, or may cause uncontrolled operator/ passenger actions or reactions.
- Never use in roadways, near motor vehicles, on or near steep inclines or steps, swimming pools or other bodies of water.
- Avoid streets and surfaces with water, sand, gravel, dirt, leaves, and other debris, wet weather impairs traction, braking, and visibility.
- Avoid sharp bumps, drainage grates, and sudden surface changes. Scooter may suddenly stop.
- Avoid riding around flammable gas, steam, liquid, or dust that could cause fire.
- Do not ride after drinking or taking prescription medication.
- Do not carry items when riding.
- Always give way to pedestrians.
- Be alert to things in front and far away from you.
- Do not allow distractions when riding, such as answering the phone or engaging in any other activities, never drive while using a cell phone or headset.
- The scooter cannot be ridden by more than one person.
- When you ride the scooter along with other riders, always keep a safe distance to avoid a collision.
- When turning, be sure to maintain your balance.
- Keep fingers and other body parts away from the engine, brake system, steering system, steering wheels, and all other moving parts.
- Never tow the scooter to another vehicle or pull anyone or anything.



## BEFORE STARTING

Your Scooter comes with the following items in the box. Please locate all of the following:

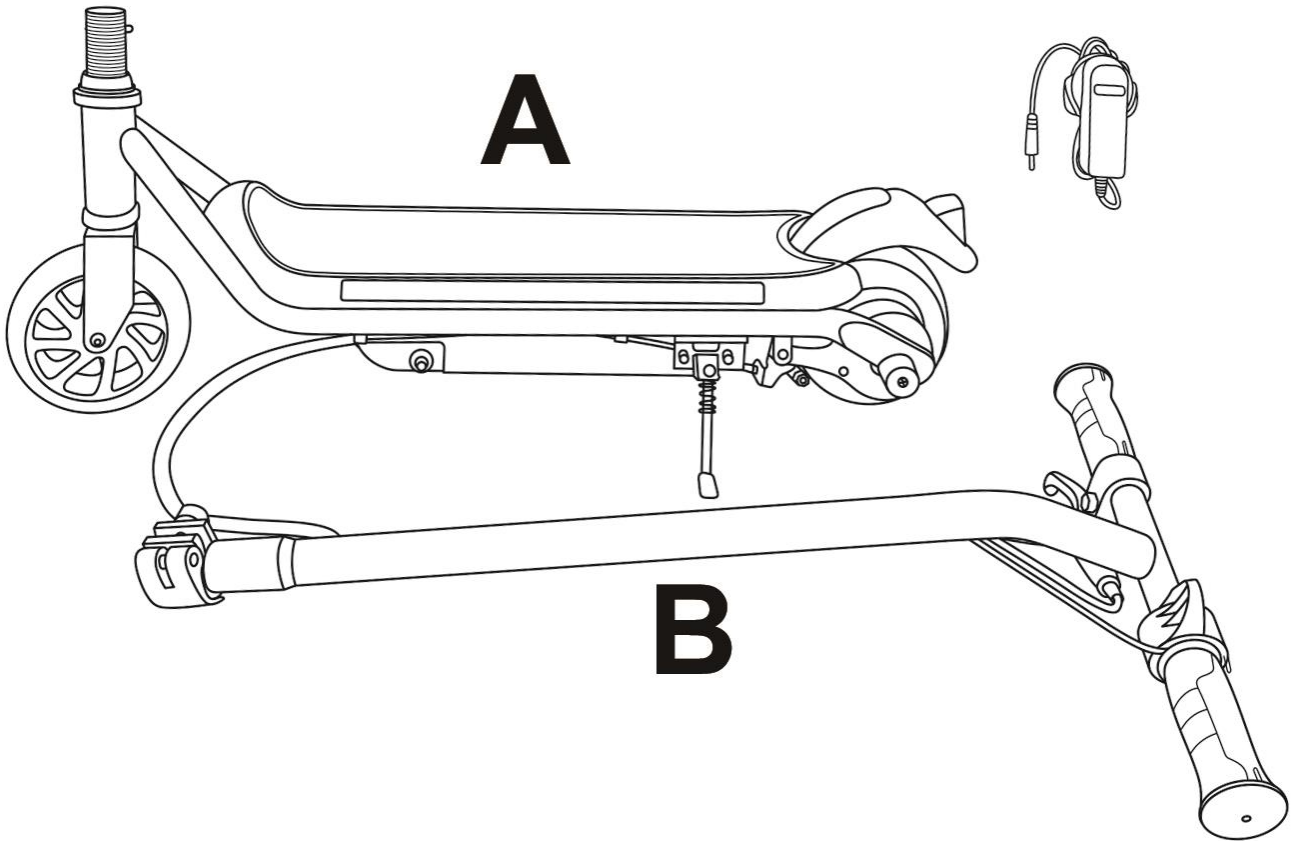
1. Scooter
2. Charger
3. Manual
4. Tools



### Tools Included:

		
1* 8mm / 10mm wrench 1* 13mm / 15mm wrench	2* 5mm hex wrench 1* 2.5mm hex wrench 1* 4mm hex wrench	1*Phillips

# ASSEMBLE

Estimated Assembly Time

Allow up to 5-10 minutes for the assembly, not including the initial loading time.

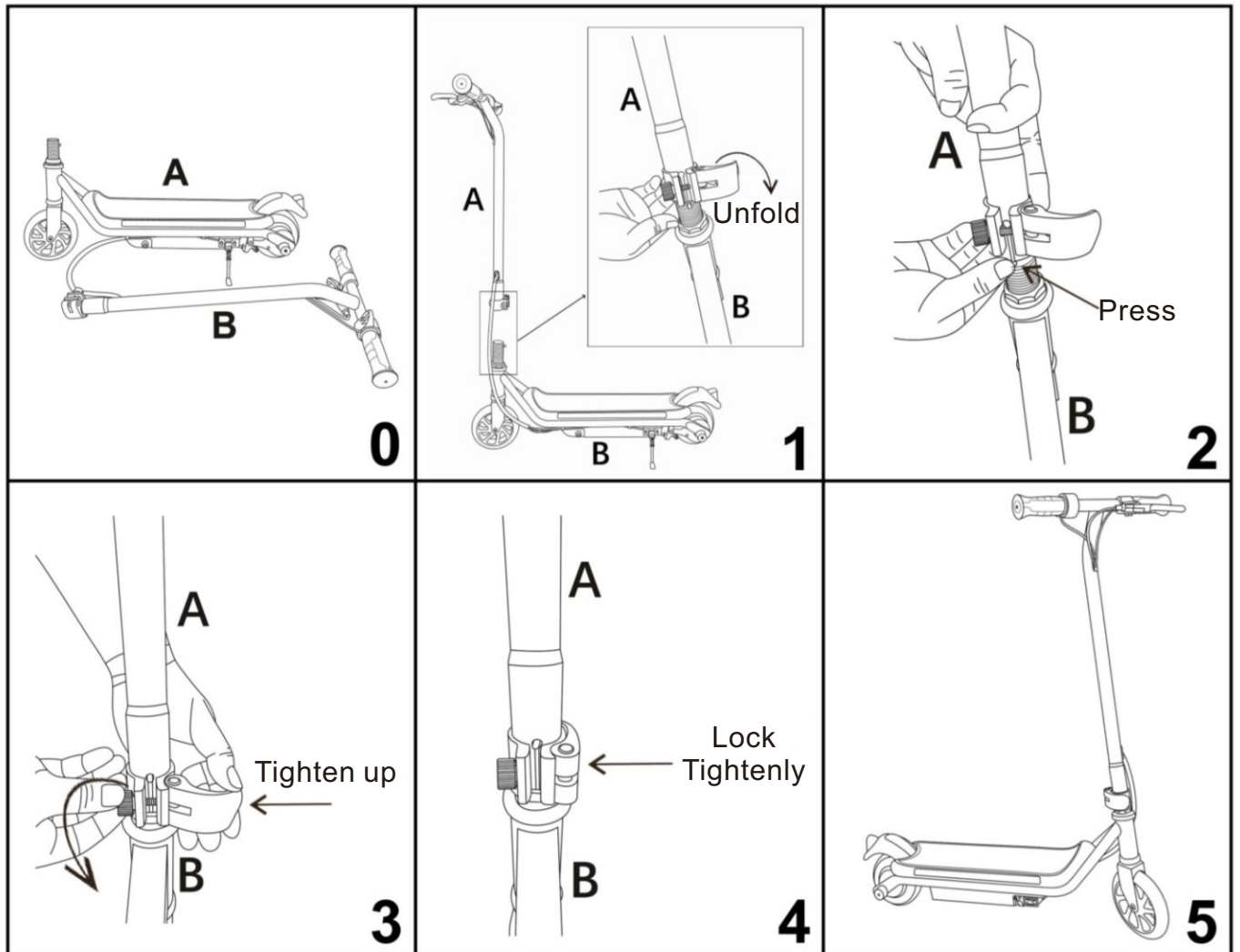

# GETTING TO KNOW THE SCOOTER

## Scooter Components

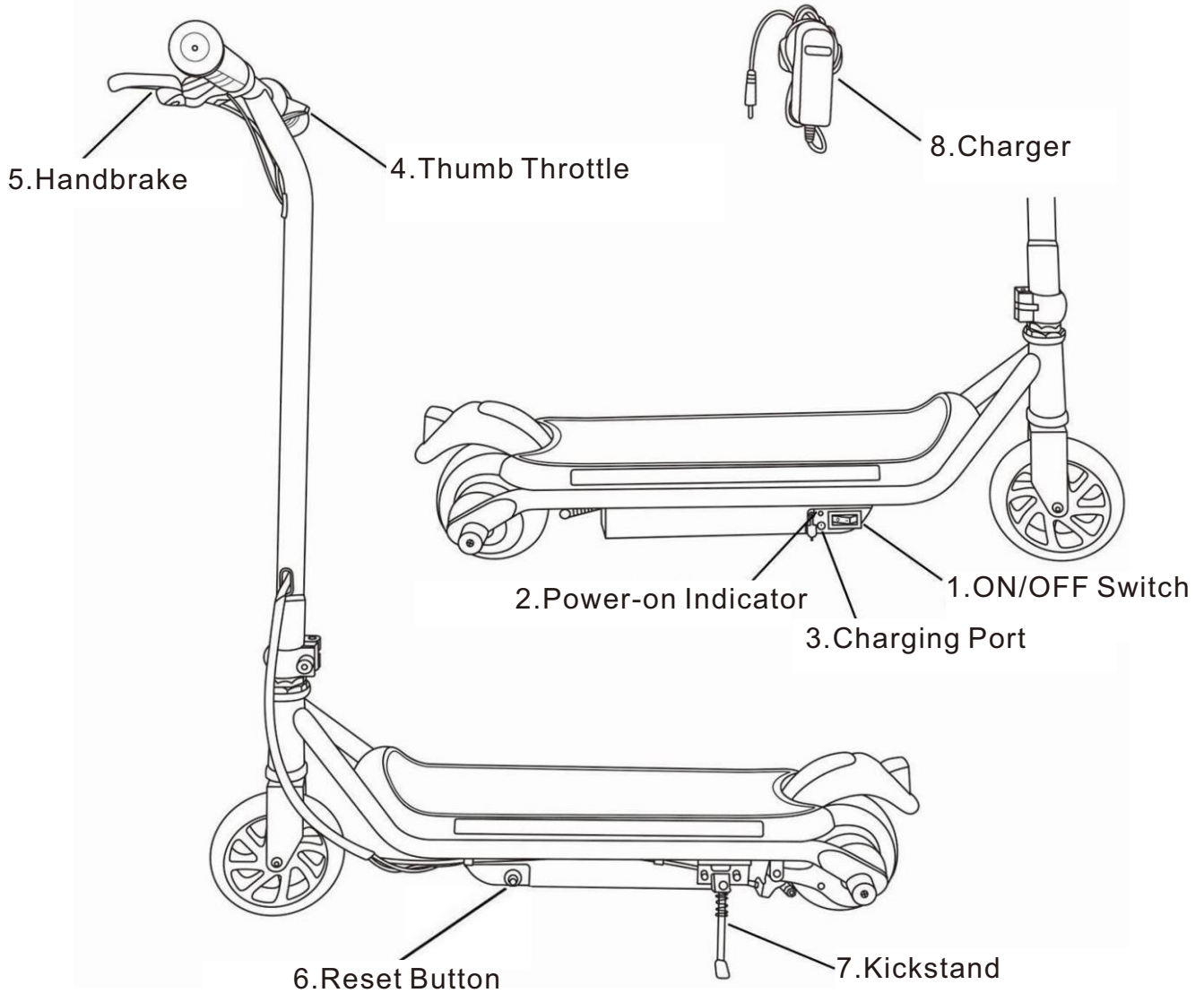

(When the scooter is overloaded or over-current, it will come out and the scooter will stop working or can not be charged, press it back to reset and restart the scooter then the scooter will work and be charged again.)

## Product Specification

Product Size:	81x36x91cm
Product Net Weight:	9.5kgs
Battery Capacity&Type:	24V4.5Ah Lead Acid Battery
Motor Power&Type:	24V200W Brushless Motor
Max Speed:	12km/h
Range per Charge:	8-10km
Charging Time:	5-8h
Charger Input&Output Voltage&Current:	100-240V~50/60Hz 0.5A / 24V0.4A
Wheel Size&Material:	Front Flash140mm PU Tire+Rear 5.5inch Solid Rubber Tire
Max Load Capacity:	50kg
Drive Model:	Brushless Motor

# ELECTRIC SCOOTER OPERATION

## Riding Operation

- Always wear an approved helmet, eye protection, shoes and for inexperienced riders, we further recommend gloves, knee and elbow pads.
- Before riding, be sure to have a clear unobstructed level path ahead of the rider.

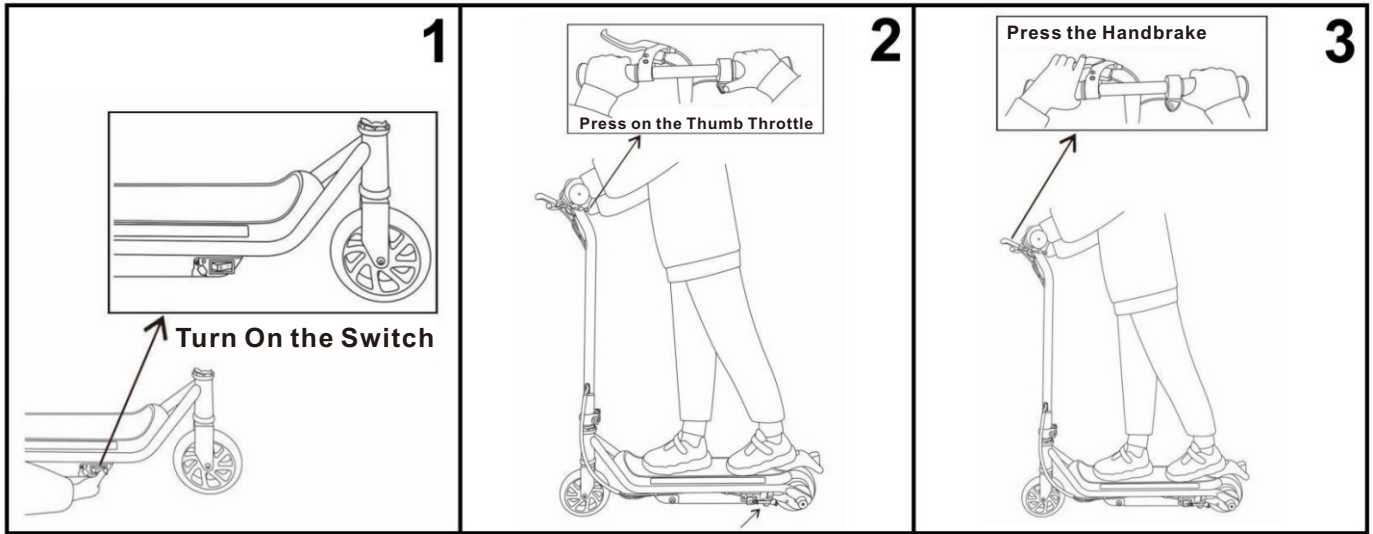

**Step 1:** Turn the electric scooter to the “ON” mode with the red ON/OFF Switch located on the bottom right side of the scooter.

### Step 2:

- 2.1. Put the Kickstand in the folded position, securely away from the ground.
- 2.2. Firmly grab the Handlebars with both hands. Place one foot onto the footplate.
- 2.3. Press on the Thumb Throttle simply and simultaneously, located on the right-hand side of the handlebar. You will feel the power of the motor then you begin to raise the other leg off the ground onto the foot pedal, then you can speed up.

**Step 3:** To slow down or complete stop, step and press the Handbrake and release the Thumb Throttle, there is the band brake system at the rear wheel to stop the scooter. As you become a more skilled rider and familiarize with your new electric scooter, you will begin to use a combination of brake and power to achieve optimum operation.

**Step 4:** Turn off the Switch when not in use. Be sure to recharge the batteries after using.

## Brake Adjustment instructions

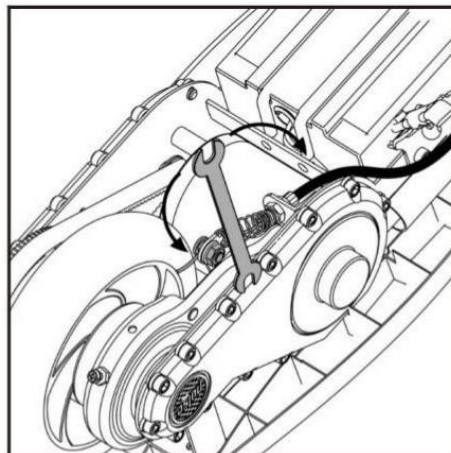
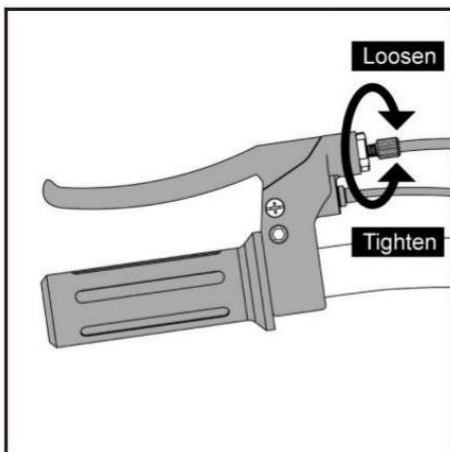

Tool required: 1\* 8mm / 10mm wrench

## Charging the Battery Operation

**⚠ WARNING: Battery must be full charged before you ride your electric scooter.**

### Required components: Charger

Failure to follow these instructions may damage the product and void the warranty.

- Use only the supplied battery charger.
- Do not use this scooter for the first time until you have fully charged the battery for at least up to 8-12 hours.
- To condition of the battery of this product for long-term use, the periodic charging session is required, the recommended charging cycle is daily after use or 15 days at least once a month if not used for a long time.

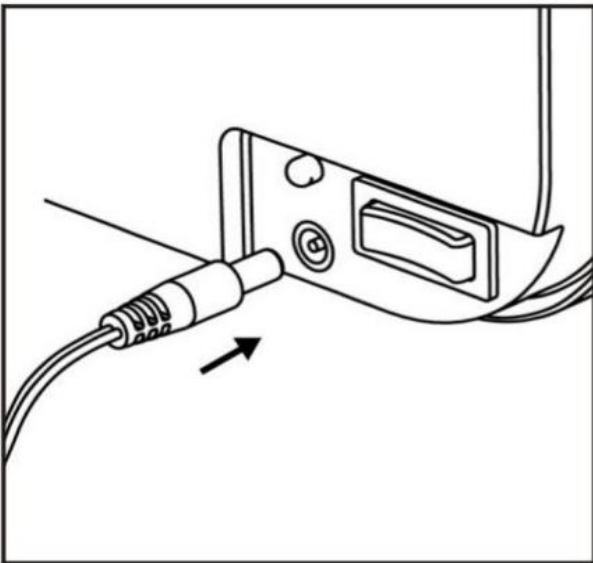

1. Make sure that the switch is in the off position before plugging in the charger. Insert the charger socket into the charging port closely on the right side of the battery box.

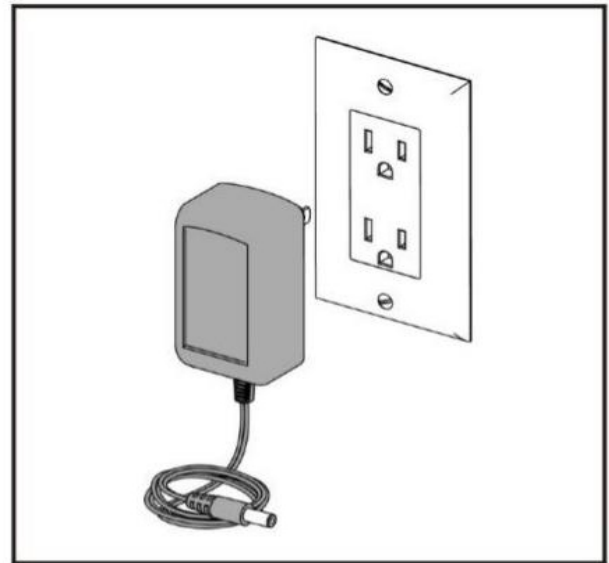

2. Plug the charger into a wall outlet. The light on the charger case will illuminate.

**The Red Light indicates that the battery is charging.**

**The Green Light indicates that the battery is fully charged.**

**Note:** Please insert the charger socket into the charging port closely on the right side of the battery box before plugging the charger into a wall outlet, it can protect the charging port to be over current.

If the charger port is damaged, please replace it with a new charger recommended.

If the charger is damaged, please stop using it immediately and replace it with a new charger recommended.

## Battery Care and Disposal

- Store and charge batteries at a temperature between 10 and 35°C. The higher the temperature, the faster the batteries will self-discharge. Always try to keep your batteries charged at all times. Inspect batteries occasionally and keep the terminals clean and connections tight.
- Handle the batteries and charger with care. Do not overcharge. Refer to the charging times chart.
- We suggest that you purchase additional batteries for extra power requirements.

**THIS SCOOTER CONTAINS LEAD-ACID SEALED BATTERIES TO BE RECYCLED IN ACCORDANCE WITH ITS LOCAL AND STATE LAWS. PLEASE READ CAREFULLY AND UNDERSTAND THE INSTRUCTIONS FOR YOUR DISPOSAL.**

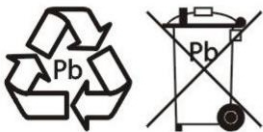

**Disposal:** This product contains sealed lead-acid batteries that must be disposed of or recycled in an environmentally sound manner. Do not dispose of batteries in the household waste. Do not dispose of batteries in a fire as this may cause battery leakage or explode. Incineration, landfill disposal, and placement of lead-acid batteries sealed with household waste is prohibited by law in most areas. Return used batteries to an authorized battery lead-acid recycle or consult your local vehicle battery dealer.

**⚠ WARNING: Do not mix old and new batteries. Do not mix alkaline, standard (carbon-zinc) or rechargeable (nickel-cadmium) batteries.**

## Problem Solution

ISSUE	Possible Cause	Solution
The scooter doesn't work.	The Battery is undercharged.	Fully charge the Battery. First charge should be 8-12 hours and up to 6 hours of recharge.
	The cables or connectors of are loosen or disconnected.	Open the footplate to check if the cables are connected with the controller.
	The Battery is damaged.	Change to a new set of Battery. The scooter is recommended to be charged frequently weekly. The battery will be deep damaged if it is not charged for long period.
	The Accelerator is broken by crash or violent pull.	Change to a new Accelerator.
	The Switch to power off of the rear Foot Brake is broken, it will cut the power off.	Change to a new Switch to power off of the rear Foot Brake.
	The Controller is broken by overload or over-current.	Change to a new Controller.
	The Motor is broken by overload or over-current.	Change to a new Motor.

The scooter running time is short.	The battery is not charged to full.	The battery needs to be charged. Fully charge the battery. The first charge should be 8-12 hours and up to 6 hours of recharge.
The scooter stops working suddenly.	The Reset Button tripped. It is on the left side of the battery case, it will automatically fire and shut off if the motor is overloaded. Excessive overload (steep slope or too much weight of a user) could have caused the motor to overheat and trip the switch.	Press the Reset Button back and Restart the scooter.  Verify all connectors and cables to ensure they are connected and adjusted.
The scooter runs slowly.	The Brake are not set correctly.	Refer to the Brake Adjustment instructions.
	The scooter is overloaded.	Be sure not to overload the scooter with more than 50kg, maximum weight limit, steep slopes or towing objects behind the motorcycle. Avoid overloading the scooter, as the batteries and components used will wear out before long.
	The road situation is not suitable.	Inappropriate conditions of use only on solid, flat, clean and dry ground.
The scooter cannot be charged.	The Charger is broken.	Change to a new charger.
	The Battery is damaged.	Change to a new set of battery. The scooter is recommended to be charged frequently weekly. The battery will be deep damaged if it is not charged for long period.
	The Reset Button (Fuse) tripped. It is on the left side of the battery case, it will automatically fire and shut off if the motor is overloaded. Excessive overload (steep slope or too much weight of a user) could have caused the motor to overheat and trip the switch, then the scooter cannot work and be charged.	Press the Reset Button back and Restart the scooter.  Verify all connectors and cables to ensure they are connected and adjusted.
	The Charging Port is excessive current to short circuit.	Change to a new Charging Port.

**If you have any questions, please contact our customer care centre.**

**Our contact details are below:**

 0044-800-240-4004

 enquiries@mhstar.co.uk

IMPORTER ADDRESS:  
MH STAR UK LTD  
Unit 27, Perivale Park,  
Horsenden lane South  
Perivale, UB6 7RH  
MADE IN CHINA

