

AIYAPLAY

IN250700298V01_UK_FR_DE_ES_IT

370-447V00

PEDAL GO-KART / KART À PÉDALES / PEDAL-GOKART / KARTING DE PÉDALES / GO-KART A PEDALI

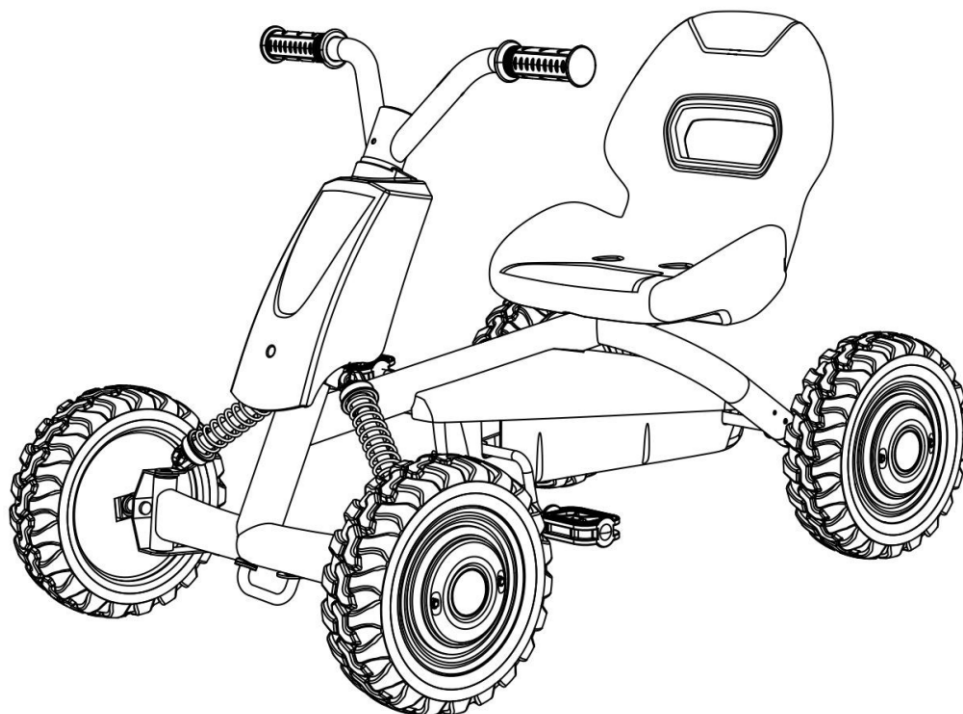

EN: WARNING: Not suitable for children under 2 years old; Max weight: 30 kg.

DE: ACHTUNG: Nicht geeignet für Kinder unter 2 Jahren; Max. Gewicht: 30 kg.

FR: ATTENTION: Ne convient pas aux enfants de moins de 2 ans; Poids maximum : 30 kg.

ES: ADVERTENCIA: No apto para niños menores de 2 años; Peso máximo: 30 kg.

PT: ADVERTÊNCIA: Não é adequado para crianças menores de 2 anos; Peso máximo: 30 kg.

IT: AVVERTENZA: Non adatto a bambini sotto i 2 anni; Peso massimo: 30 kg.

EN_IMPORTANT, RETAIN FOR FUTURE REFERENCE: READ CAREFULLY.

**FR_IMPORTANT : A LIRE ATTENTIVEMENT ET A CONSERVER POUR VOUS Y REFERER
ULTERIEUREMENT**

ES_IMPORTANTE, LEA Y GUARDE PARA FUTURAS REFERENCIAS.

DE_WICHTIG! SORGFÄLTIG LESEN UND FÜR SPÄTER NACHSCHLAGEN AUFBEWAHREN.

**IT_IMPORTANTE! CONSERVARE IL PRESENTE MANUALE PER FUTURO RIFERIMENTO E
LEggerlo ATTENTAMENTE.**

Parts List (included)

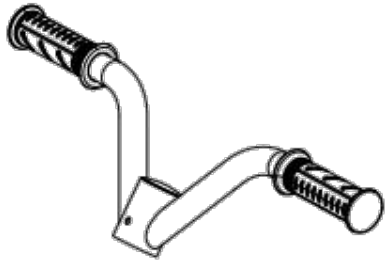

1. Head end *1

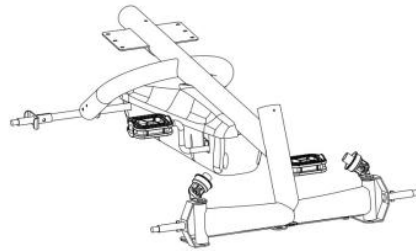

2. Frame*1

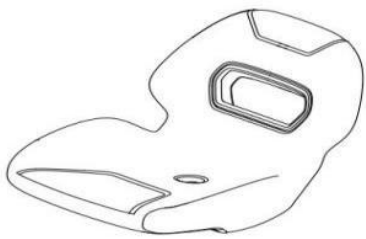

3. Seat *1

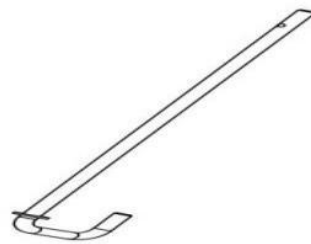

4. Steering shaft*1



5. Liner tube*1



6. Panel*1

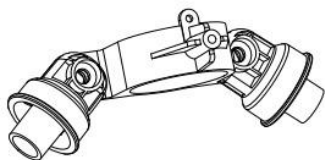

7. Plastic part*1

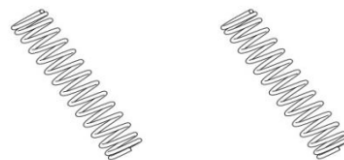

8. Spring tubes*2

Parts List (included)

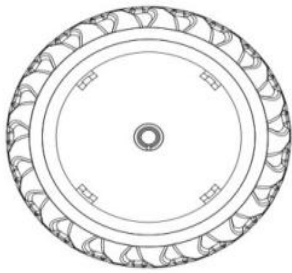

9. Wheels*4

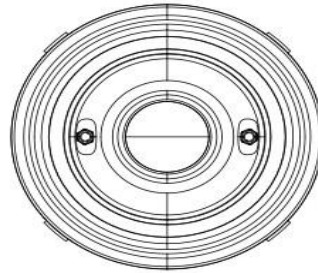

10. Wheel hubs*4



11. Sticker on the panel



12. Manual

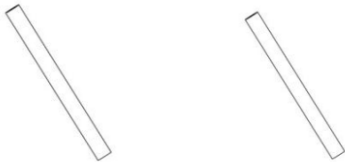

13. Iron parts *2

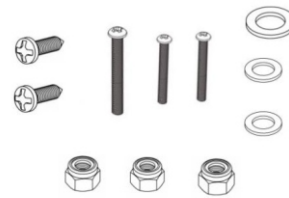

14. Bag of nuts and bolts:

2 x M4*14

1 x M5*45

2 x M5*30

2 x gasket M5

1 x gasket M10

3 x nut M5

Assembly Instructions:

1. Put the plastic part on the frame.

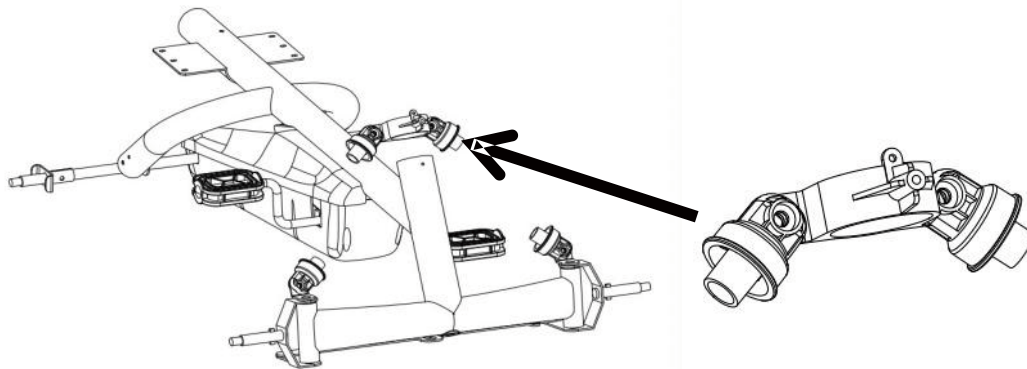

2. First, place the iron parts into the proper position on the frame. Then, slide the spring tubes over the iron part, as shown in the figure below.

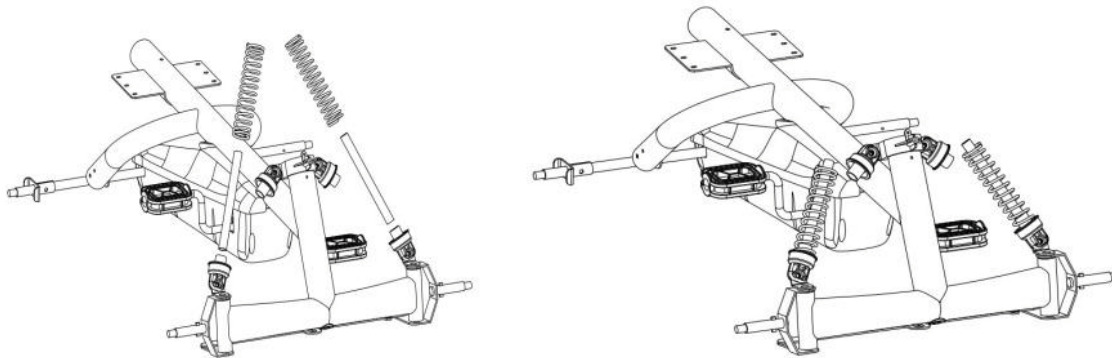

3. First, secure the iron parts to the plastic part, then press down on the plastic part to align its mounting holes with those on the frame. then fix it with screw M4*14.

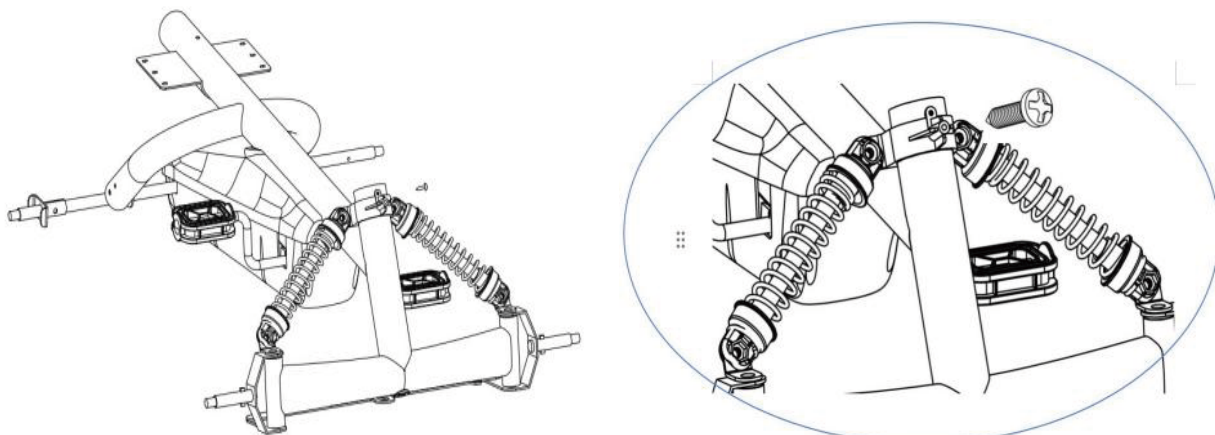

4. Fix the wheel and hub at the top of the shaft, as shown in the figure below.

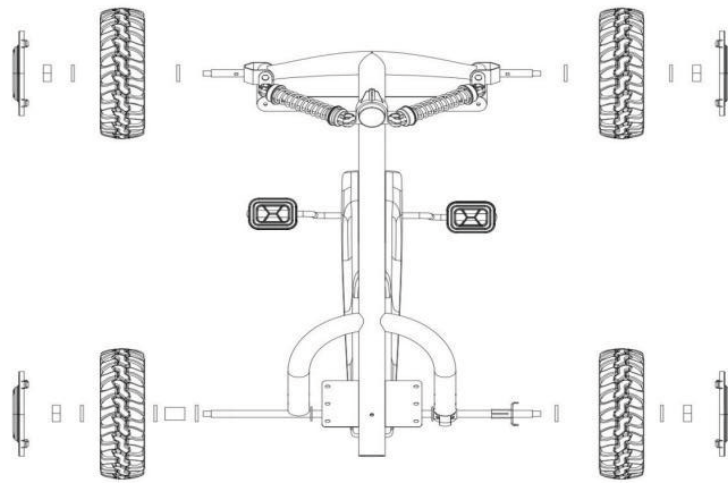

5. Put the washer (gasket M10) on the steering shaft .then insert the steering shaft and slot the loop into connecting part. as shown in the figure below.

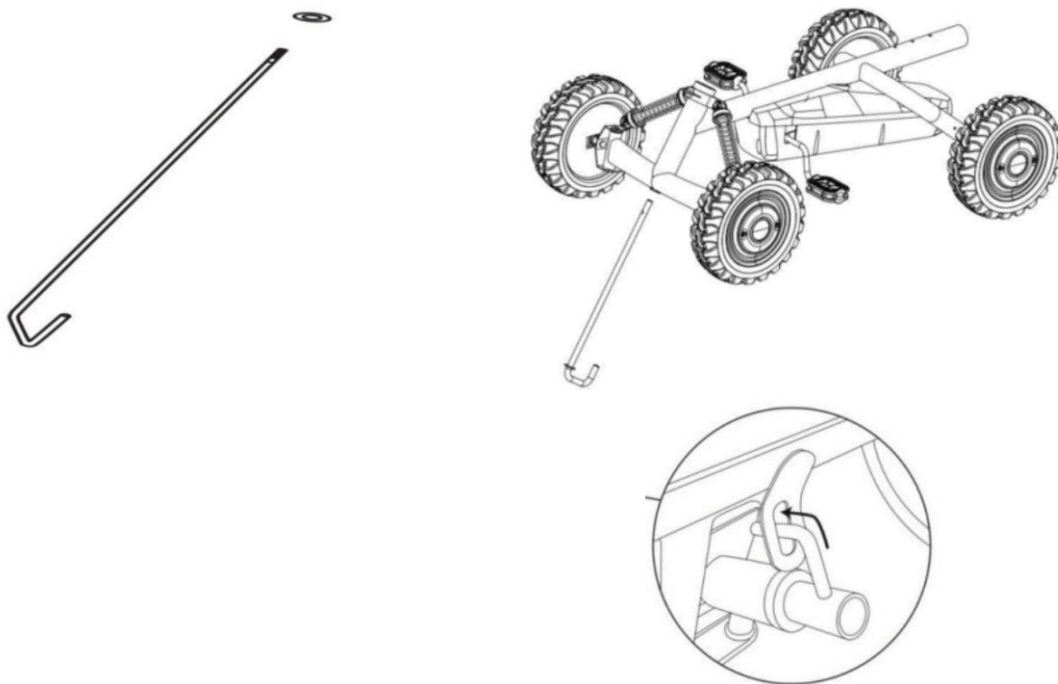

6. Put the liner tube cover the steering shaft.

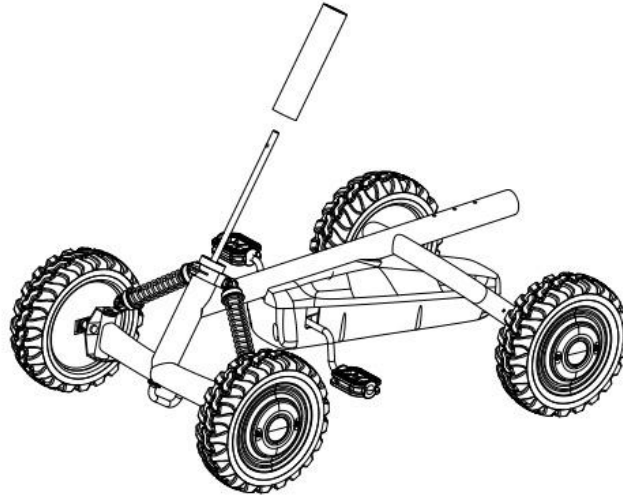

7. Put the panel on the liner tube.

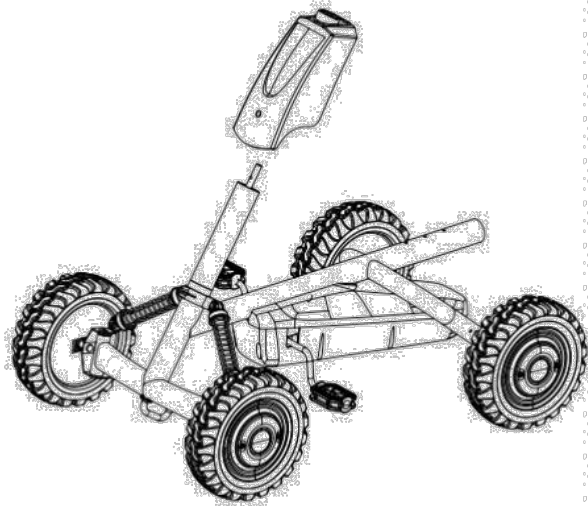

8. Fix head end on the steering shaft then fix it with screw M5*45 and nut M5.

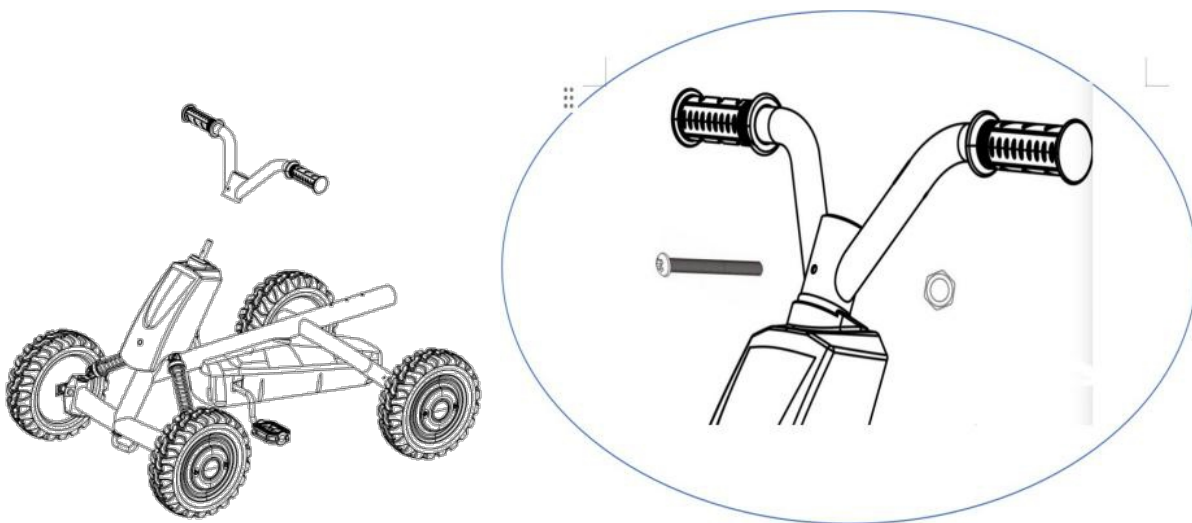

9. Fix the front panel to the liner tube. then fix it with screw M4*14.

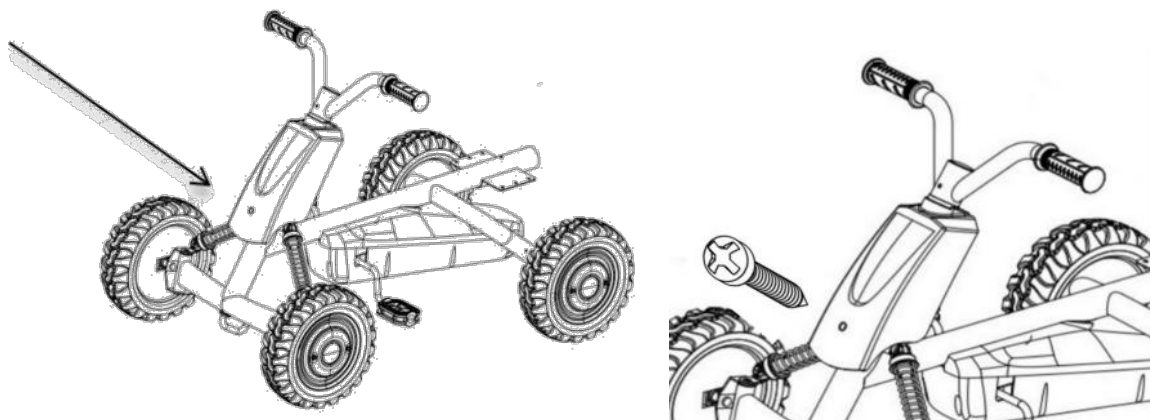

10. Fix the seat with 2x M5*30 screws, 2x gasket M5 and 2 x nut M5.

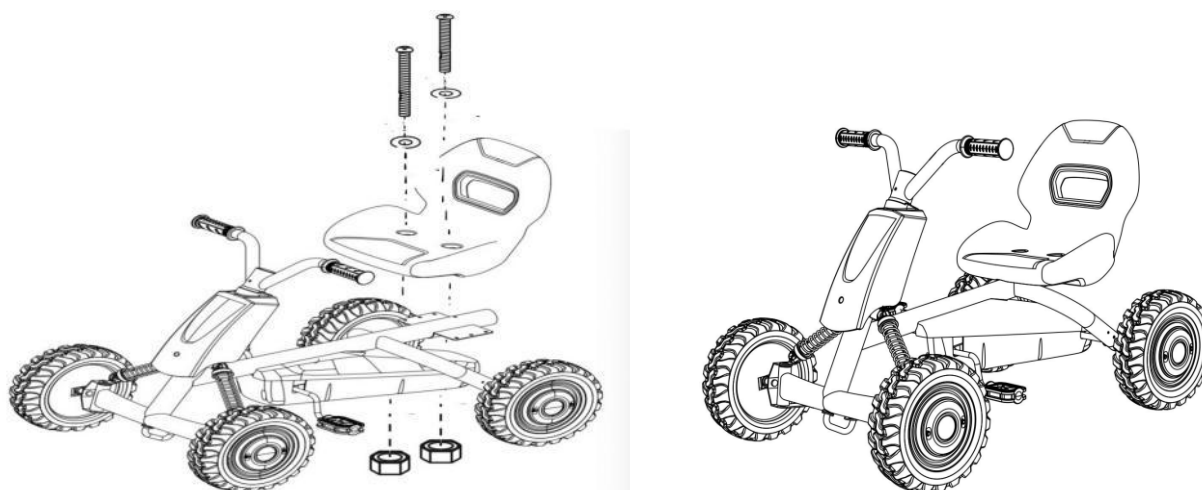

11. Stick the sticker on the front panel.

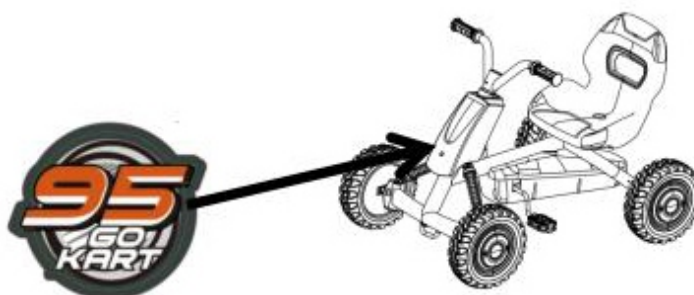

WARNINGS:

Not suitable for children under 2 years of age

Maximum capacity of 30kgs

Adult supervision required at all item

This product should not be operated on public roads, highways or bicycle paths

Read 'Safe operation' section before use

Always inspect and maintain product prior to use

SAFE OPERATION:

This product must be assembled by an adult and checked by an adult before use

Ensure nuts and bolts remain securely fastened before use

Lubricate the chain often

The toy should be used with caution since skill is required to avoid falls or collisions causing injury to the user or third parties.

Do not store in direct sunlight

Material of products:

A、 (PP) B、 (IRON)

Liste des pièces (incluses)

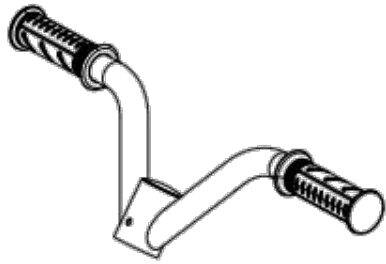

1. Extrémité de tête*1

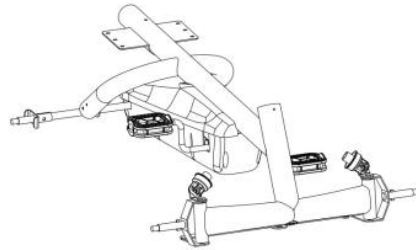

2. Cadre*1

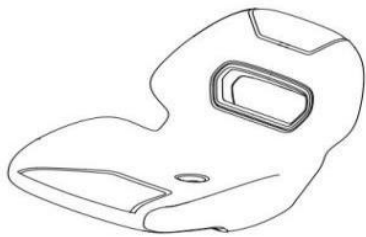

3. Siège*1

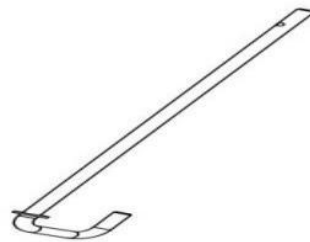

4. Arbre de direction*1



5. Tube linéaire*1

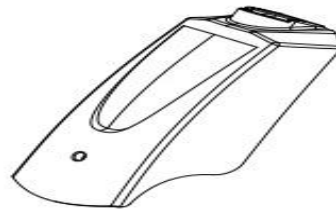

6. Panneau*1

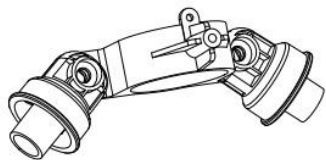

7. Pièce en plastique*1

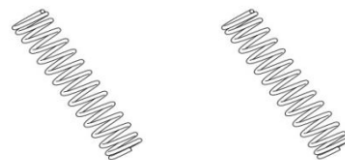

8. Tubes à ressort*2

Liste des pièces (incluses)

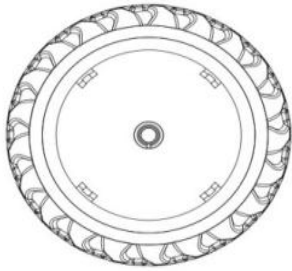

9. Roues*4

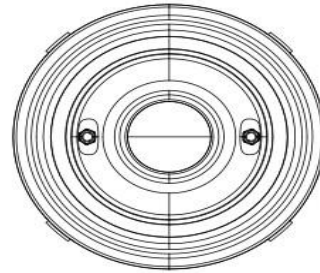

10. Moyeux de roues *4



11. Autocollant sur le panneau



12. Manuel

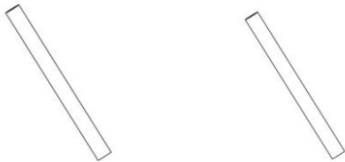

13. Pièces en fer *2



14. Sachet d'écrous et boulons :

- 2 x M4*14
- 1 x M5*45
- 2 x M5*30
- 2 x joint M5
- 1 x joint M10
- 3 x écrou M5

Instructions d'assemblage :

1. Placez la pièce en plastique sur le cadre.

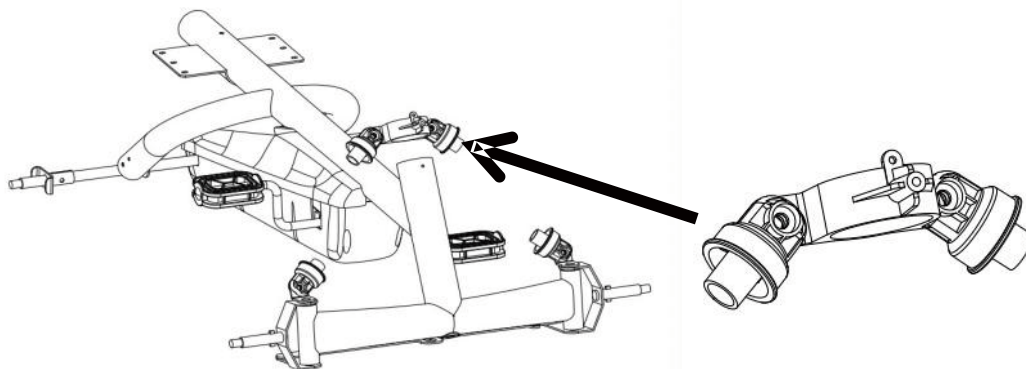

2. Tout d'abord, positionnez les pièces en fer à leur emplacement correct sur le cadre. Ensuite, glissez les tubes à ressort sur la partie en fer, comme illustré dans la figure ci-dessous.

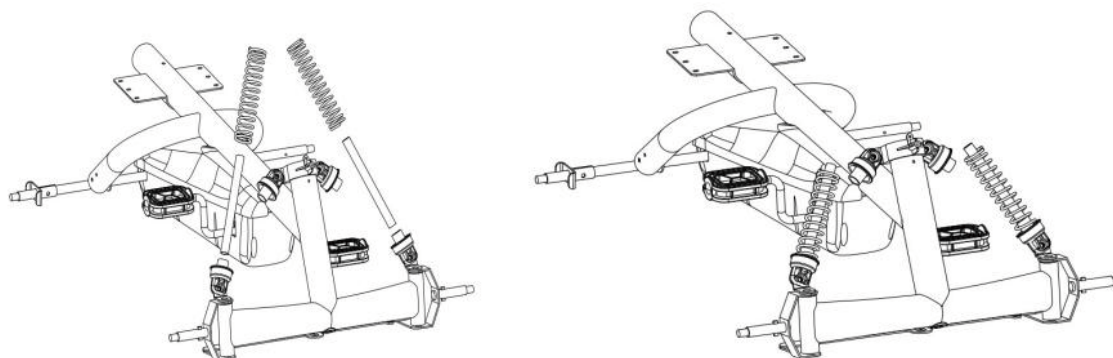

3. Commencez par fixer les pièces en fer à la partie en plastique, puis appuyez sur la pièce en plastique pour aligner ses trous de montage avec ceux du cadre. Enfin, fixez le tout avec une vis M4*14.

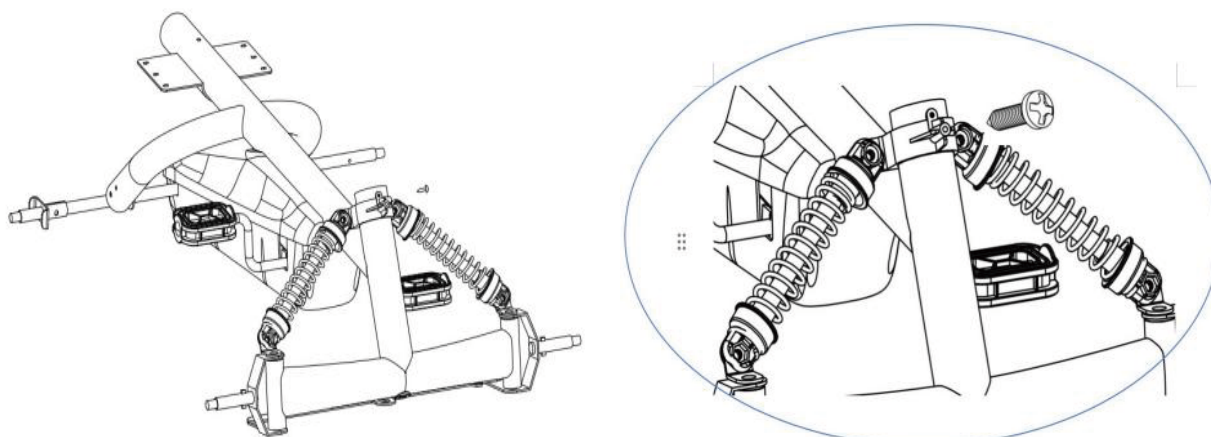

4. Fixez la roue et le moyeu en haut de l'arbre, comme illustré dans la figure ci-dessous.

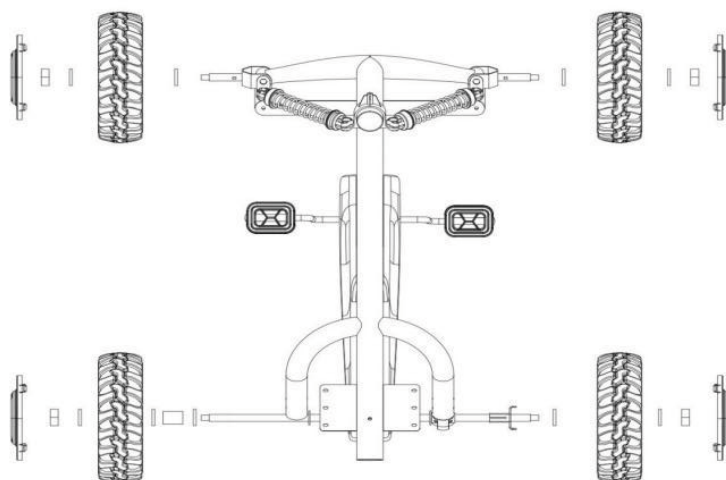

5. Placez la rondelle (joint M10) sur l'arbre de direction, puis insérez l'arbre de direction et engagez la boucle dans la partie de connexion, comme illustré dans la figure ci-dessous.

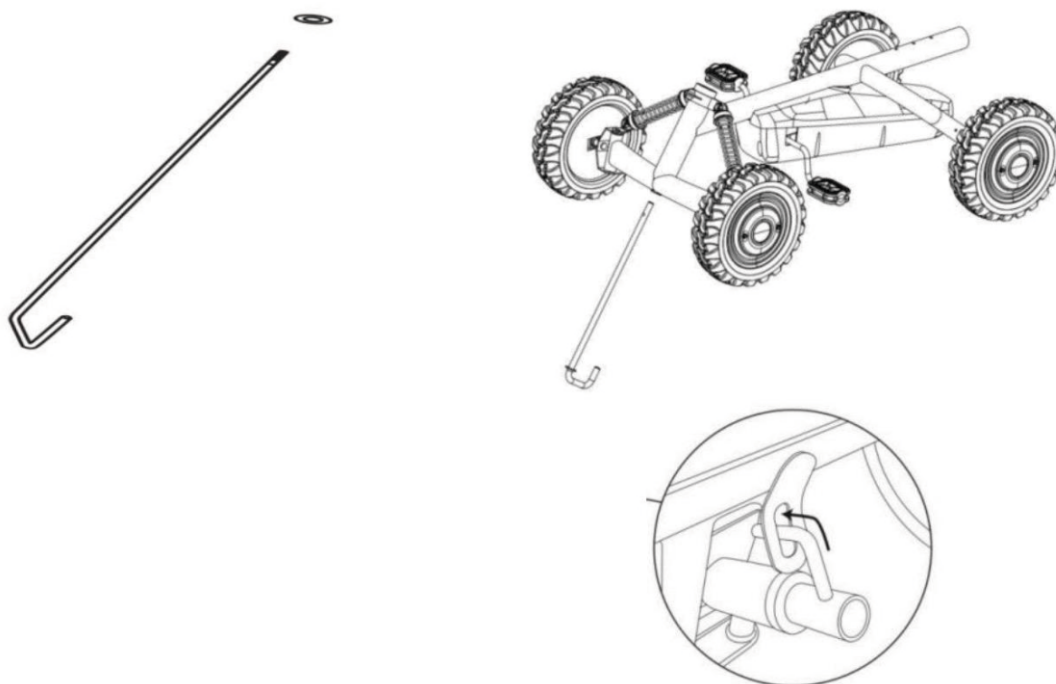

6. Placer le tube de revêtement sur l'arbre de direction.

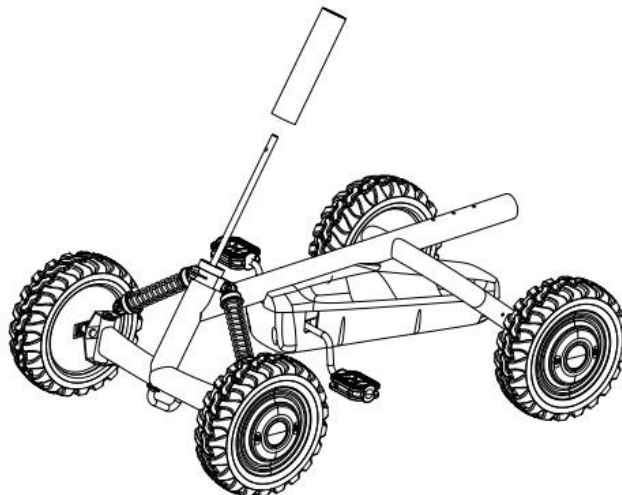

7. Placer le panneau sur le tube de revêtement.

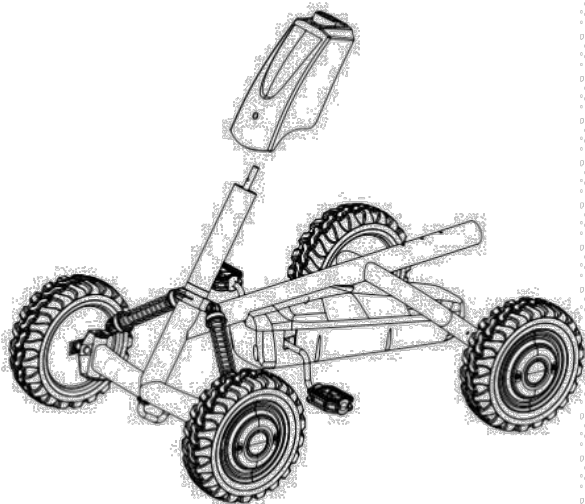

8. Fixer l'extrémité avant sur l'arbre de direction puis la fixer avec une vis M5*45 et un écrou M5.

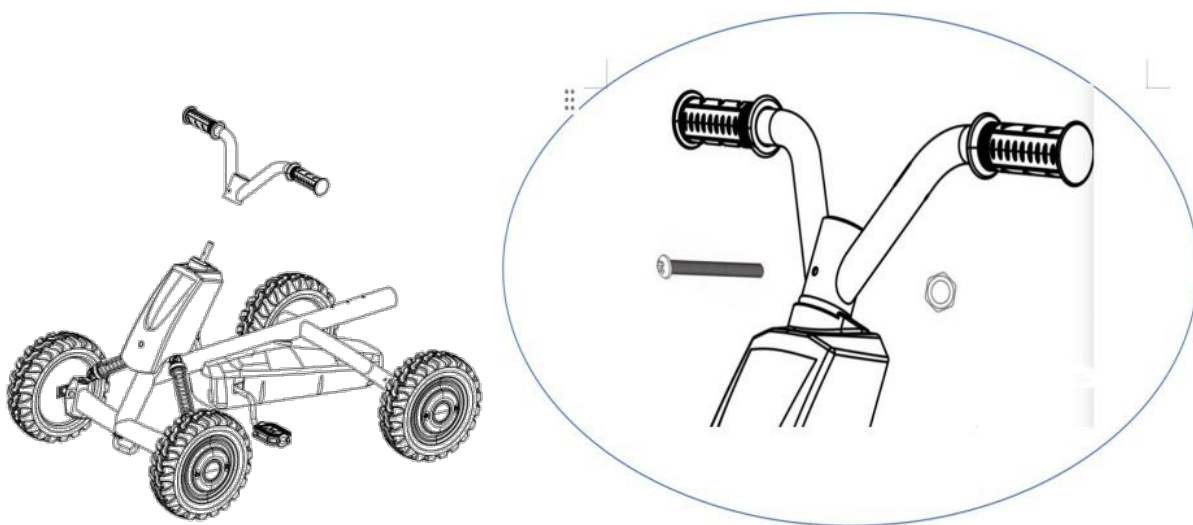

9. Fixez le panneau avant au tube de doublure, puis fixez-le avec une vis M4*14.

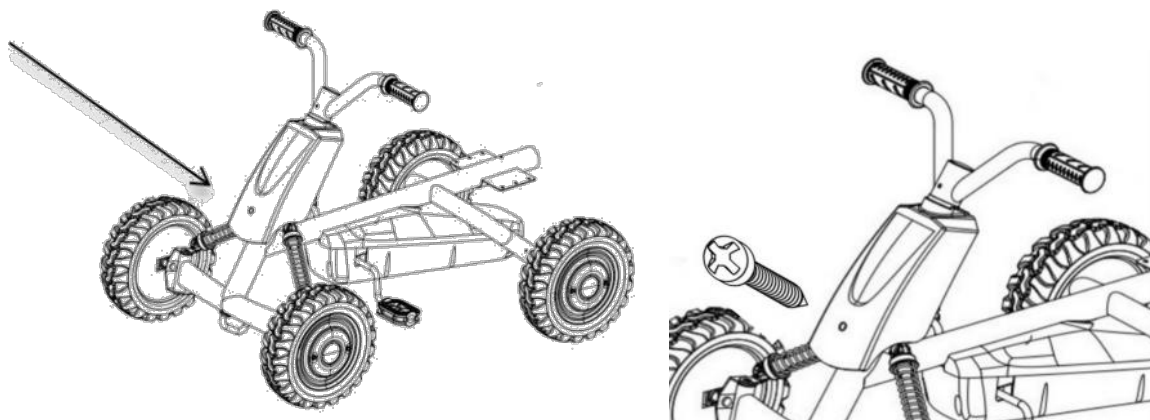

10. Fixez le siège avec 2 vis M5*30, 2 joints M5 et 2 écrous M5.

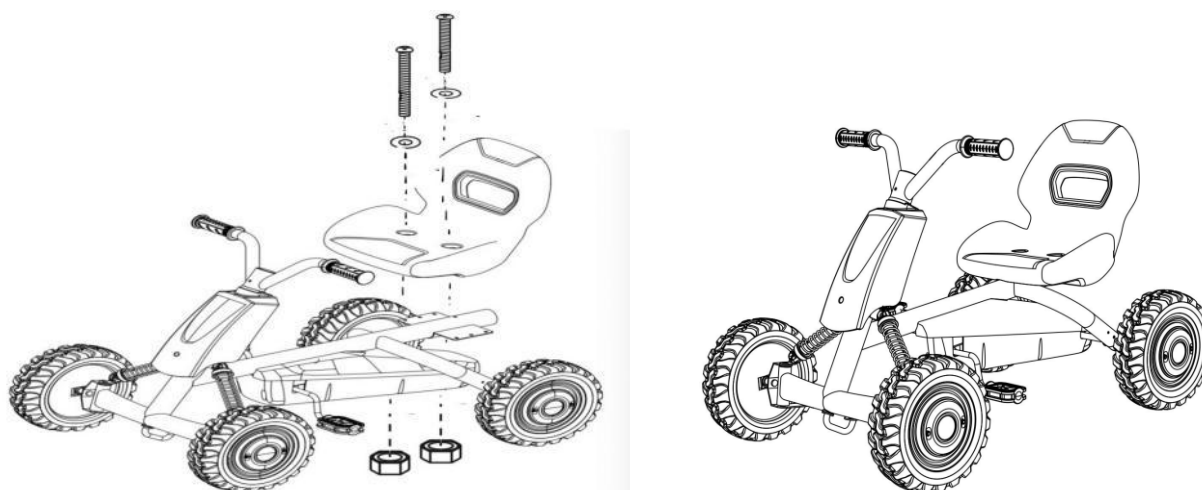

11. Collez l'autocollant sur le panneau avant.

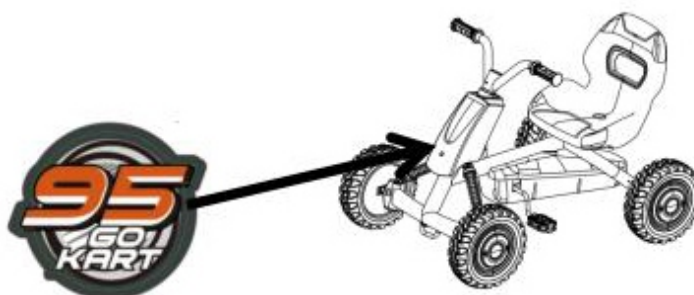

ATTENTION:

Ne convient pas aux enfants de moins de 2 ans

Capacité maximale de 30 kg

Une surveillance adulte est requise en permanence

Ce produit ne doit pas être utilisé sur les routes publiques, les autoroutes ou les pistes cyclables

Lire la section 'Sécurité d'utilisation' avant emploi

Toujours inspecter et entretenir le produit avant utilisation

SÉCURITÉ D'UTILISATION :

Ce produit doit être assemblé par un adulte et vérifié par un adulte avant utilisation

Vérifiez que les écrous et boulons sont bien serrés avant utilisation

Graissez souvent la chaîne

Le jouet doit être utilisé avec prudence car il nécessite une certaine habileté pour éviter les chutes ou collisions pouvant causer des blessures à l'utilisateur ou à des tiers.

Ne pas stocker à la lumière directe du soleil

Matériau des produits :

A、(PP) B、(FER)

Teileliste (im Lieferumfang enthalten)

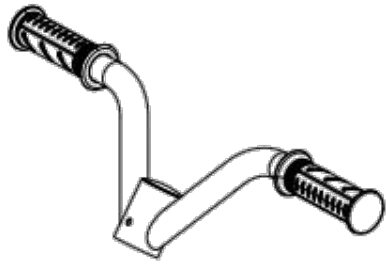

1. Kopfende*1

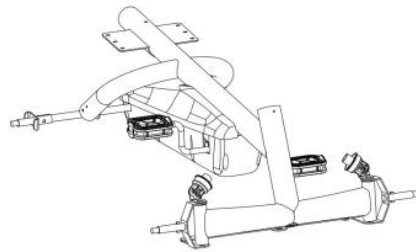

2. Rahmen*1

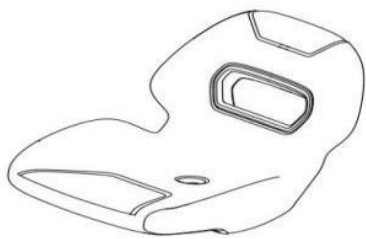

3. Sitz*1

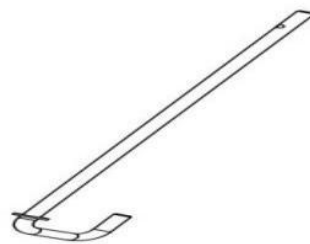

4. Lenkwelle*1



5. Einzeiliges Rohr*1

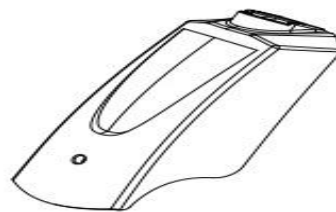

6. Panel*1

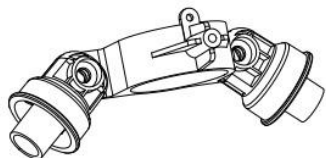

7. Kunststoffteil*1

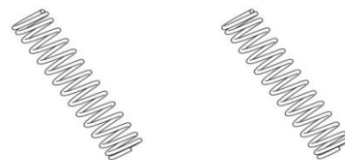

8. Federrohre*2

Teileliste (im Lieferumfang enthalten)

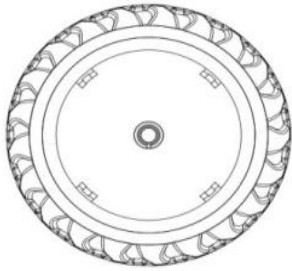

9. Räder*4

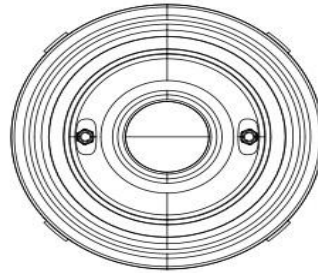

10. Radnaben*4



11. Aufkleber auf dem Panel



12. Handbuch

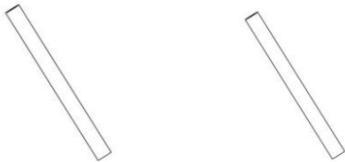

13. Eisenbauteile*2

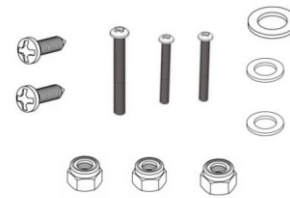

14. Beutel mit Muttern und Schrauben:

- 2 x M4*14
- 1 x M5*45
- 2 x M5*30
- 2 x Dichtung M5
- 1 x Dichtung M10
- 3 x Mutter M5

Montageanleitung:

1. Setzen Sie das Kunststoffteil auf den Rahmen.

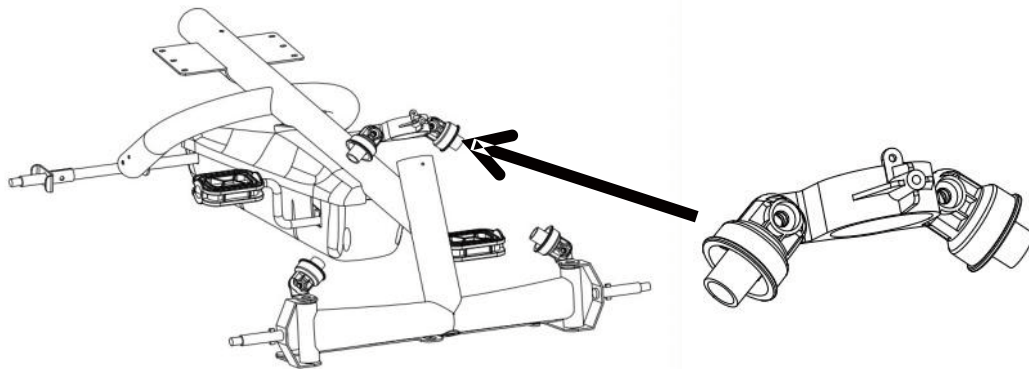

2. Legen Sie zunächst die Eisenteile in die richtige Position auf dem Rahmen. Schieben Sie dann die Federhülsen über das Eisenteil, wie in der folgenden Abbildung dargestellt.

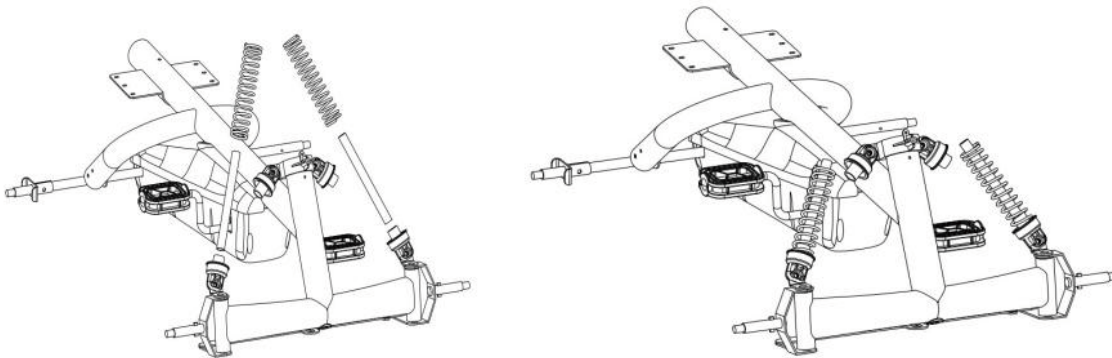

3. Befestigen Sie zunächst die Eisenteile am Kunststoffteil, drücken Sie dann das Kunststoffteil nach unten, um seine Montagelöcher mit denen am Rahmen auszurichten, und befestigen Sie es anschließend mit der Schraube M414.

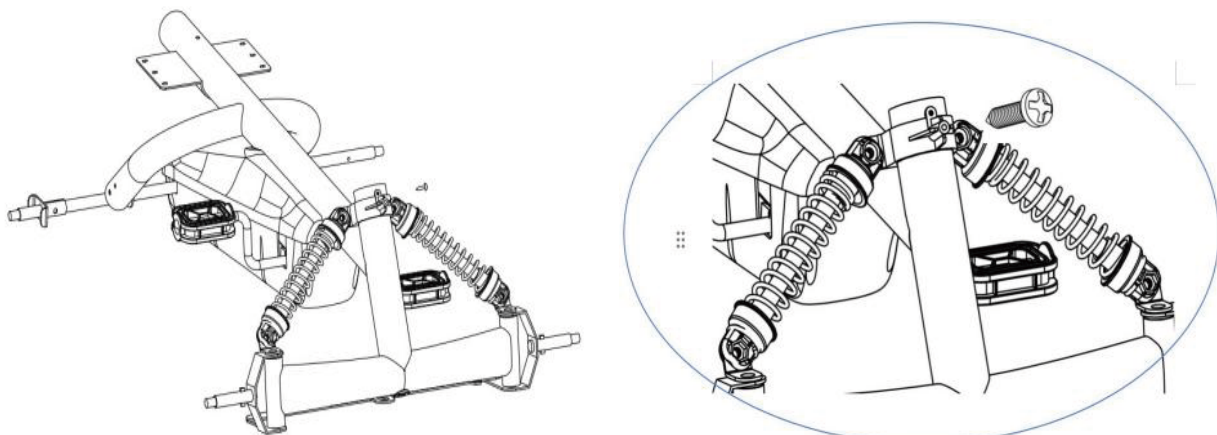

4. Befestigen Sie das Rad und die Nabe oben an der Welle, wie in der folgenden Abbildung dargestellt.

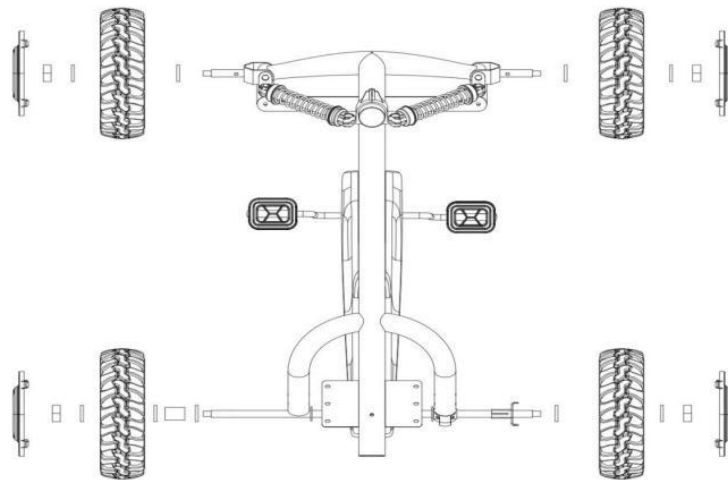

5. Legen Sie die Unterlegscheibe (Dichtung M10) auf die Lenkwelle. Setzen Sie dann die Lenkwelle ein und führen Sie die Schlaufe in das Verbindungsteil ein, wie in der folgenden Abbildung dargestellt.

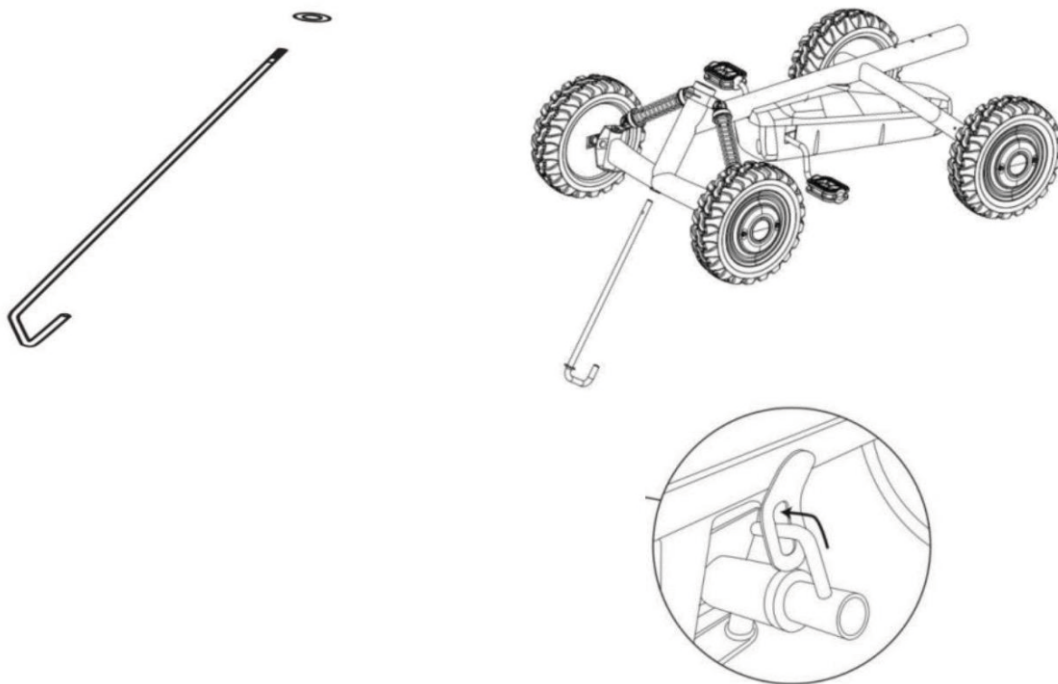

6. Setzen Sie die Auskleidungsröhre über die Lenkwelle.

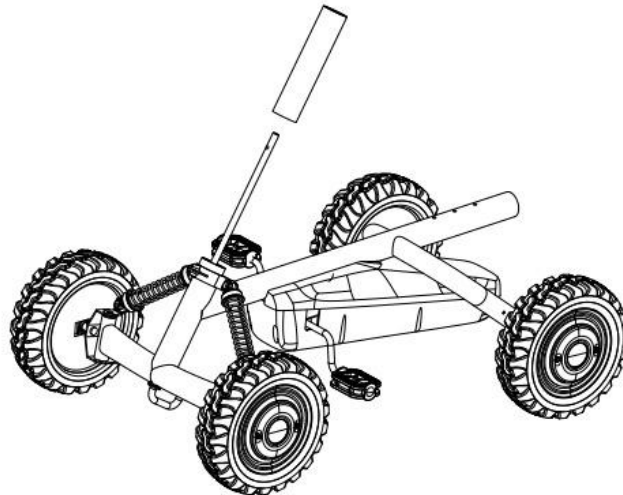

7. Legen Sie das Panel auf das Linerrohr.

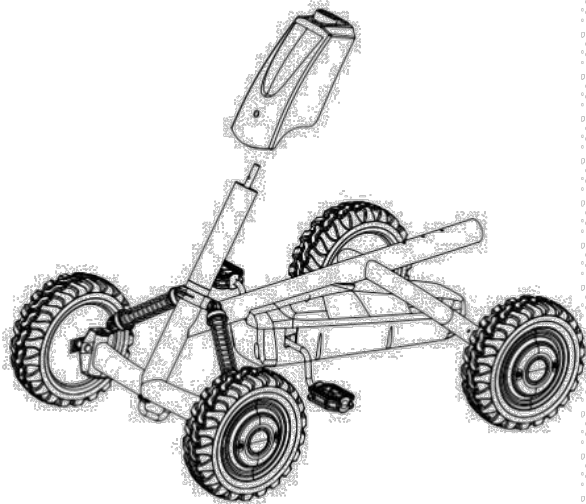

8. Befestigen Sie das Kopfende an der Lenkwelle und fixieren Sie es mit einer M5-45-Schraube und einer M5-Mutter.

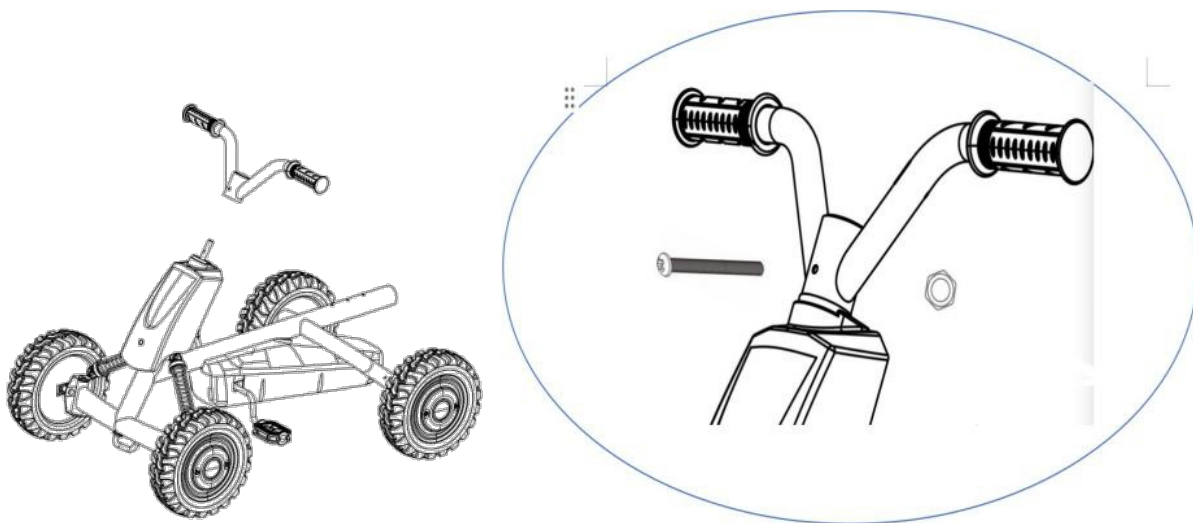

9. Befestigen Sie die Frontplatte am Linerrohr und fixieren Sie sie mit einer M4*14-Schraube.

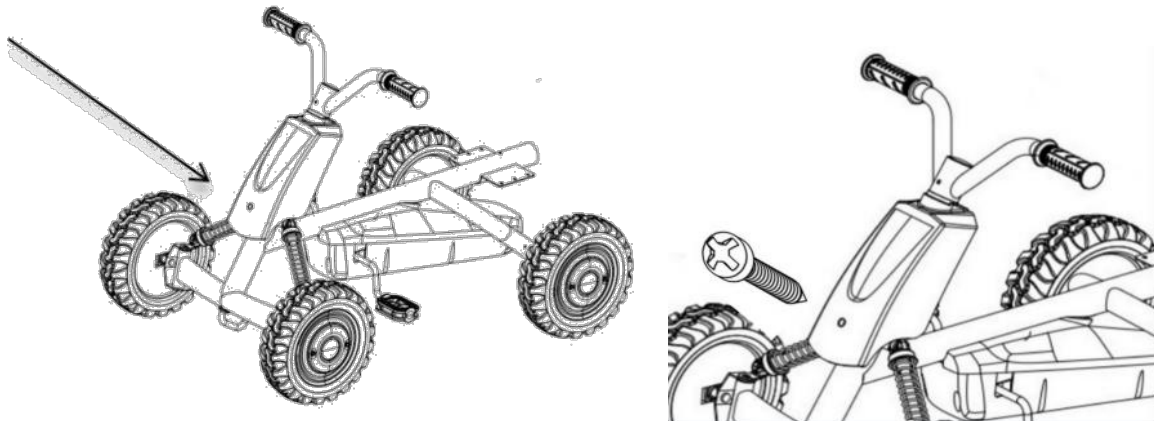

10. Befestigen Sie den Sitz mit 2x M5*30 Schrauben, 2x M5-Dichtung und 2x M5 Mutter.

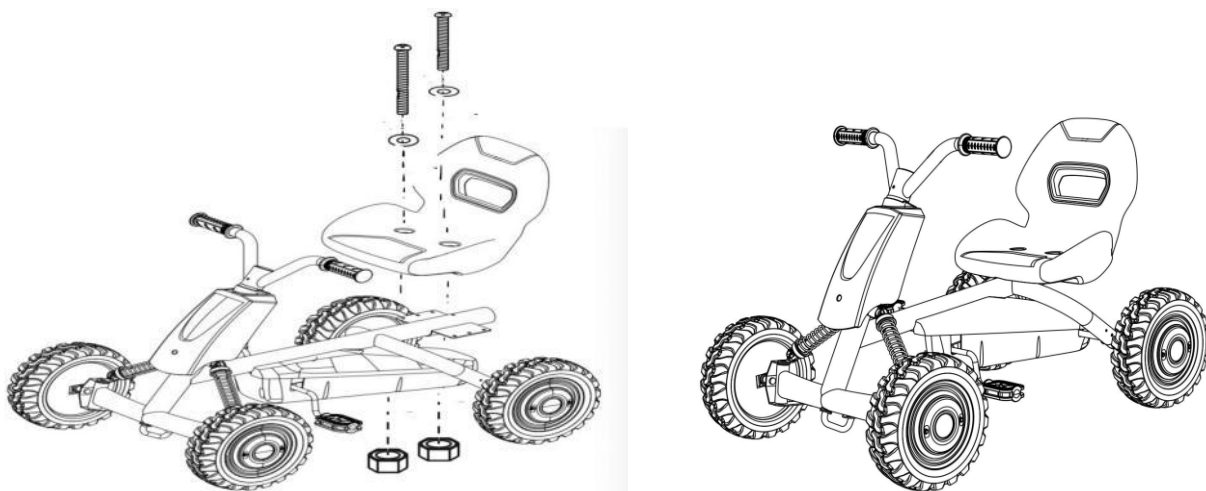

11. Kleben Sie den Aufkleber auf die Frontplatte.



ACHTUNG:

Nicht geeignet für Kinder unter 2 Jahren

Maximale Tragfähigkeit von 30 kg

Erwachsenenaufsicht ist bei allen Gegenständen erforderlich

Dieses Produkt sollte nicht auf öffentlichen Straßen, Autobahnen oder Fahrradwegen betrieben werden

Lesen Sie vor der Verwendung den Abschnitt "Sicherer Betrieb"

Produkt vor jeder Verwendung immer überprüfen und warten

SICHERER BETRIEB:

Dieses Produkt muss von einem Erwachsenen montiert und vor der Verwendung von einem Erwachsenen überprüft werden

Sicherstellen, dass Schrauben und Muttern vor der Verwendung fest angezogen sind

Die Kette regelmäßig schmieren

Das Spielzeug sollte mit Vorsicht verwendet werden, da Geschick erforderlich ist, um Stürze oder Kollisionen zu vermeiden, die zu Verletzungen des Benutzers oder Dritter führen könnten.

Nicht in direktem Sonnenlicht lagern

Material der Produkte:

A、(PP) B、(IRON)

Lista de piezas (incluidas)

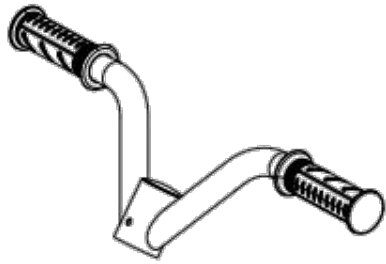

1. Extremo de cabeza*1

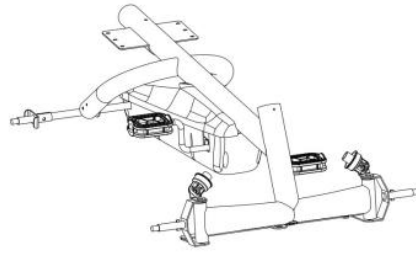

2.Chasis*1

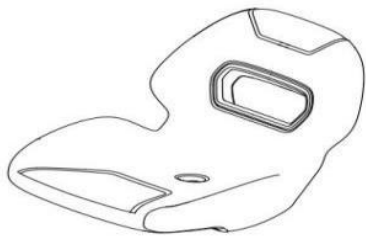

3. Asiento*1

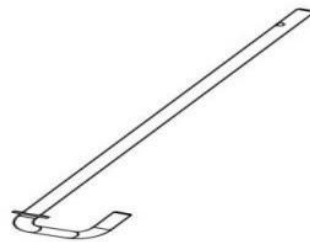

4.Eje de dirección*1



5. Tubo lineal*1

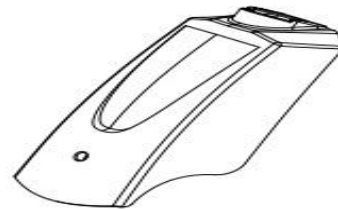

6.Panel*1

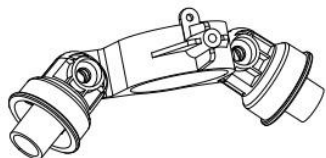

7. Pieza de plástico*1

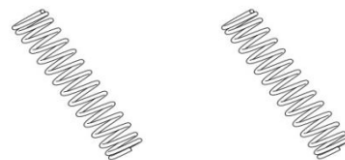

8. Tubos de resorte*2

Lista de piezas (incluidas)

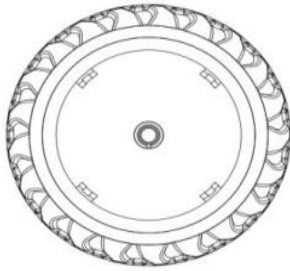

9. Ruedas*4

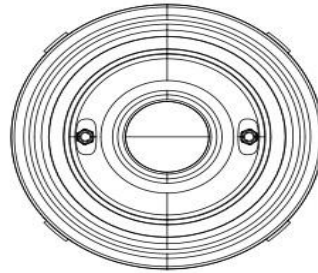

10. Bujes de rueda*4



11. Pegatina en el panel.



12. Manual

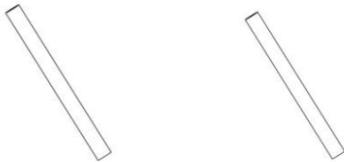

13. Piezas de hierro*2

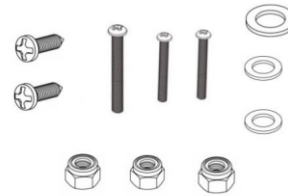

14. Bolsa de tuercas y tornillos:

2 x M4*14

1 x M5*45

2 x M5*30

2 x arandela M5

1 x arandela M10

3 x tuerca M5

Instrucciones de montaje:

1. Coloque la pieza de plástico sobre el marco.

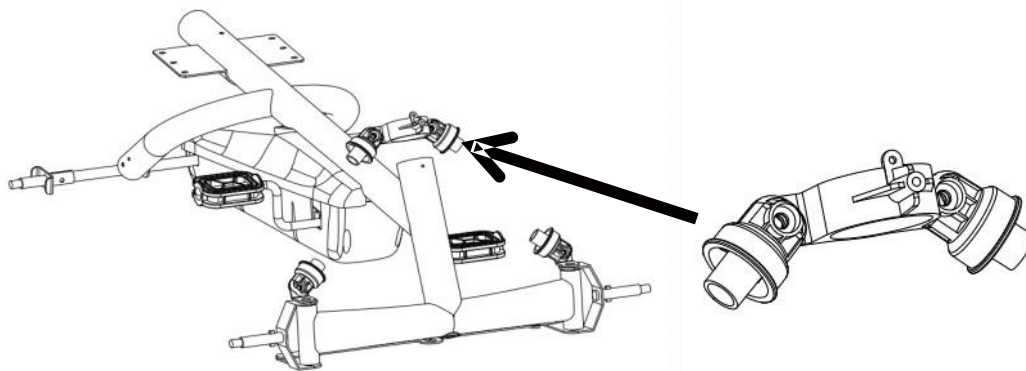

2. Primero, coloque las piezas de hierro en la posición correcta del marco. Luego, deslice los tubos del resorte sobre la pieza de hierro, como se muestra en la figura a continuación.

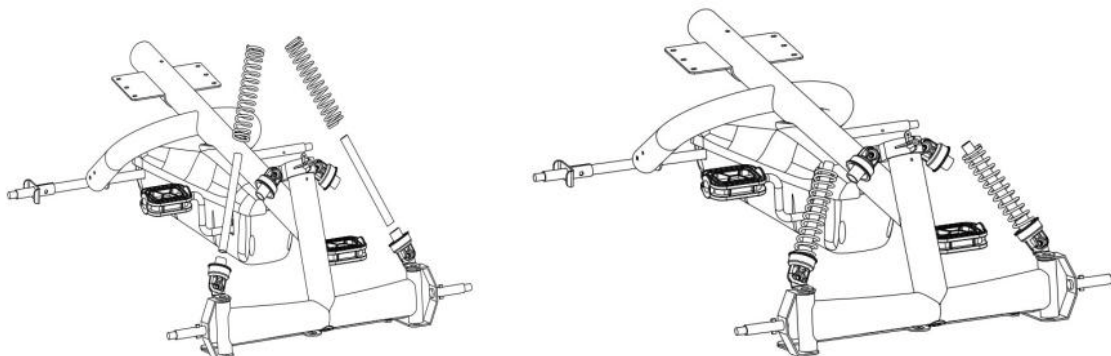

3. Primero, fije las piezas de hierro a la pieza de plástico, luego presione hacia abajo la pieza de plástico para alinear sus agujeros de montaje con los del marco. Después, fíjela con el tornillo M4*14.

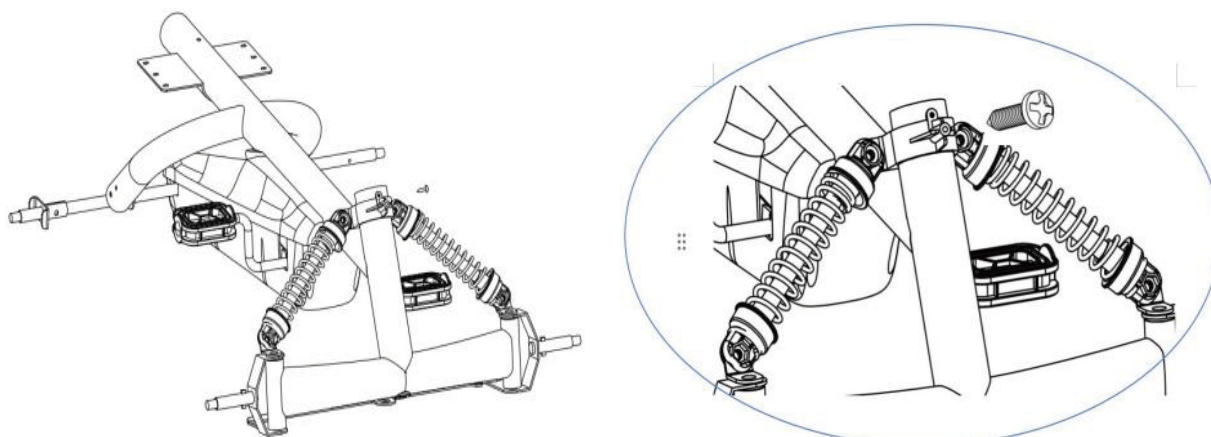

4. Fije la rueda y el cubo en la parte superior del eje, como se muestra en la figura a continuación.

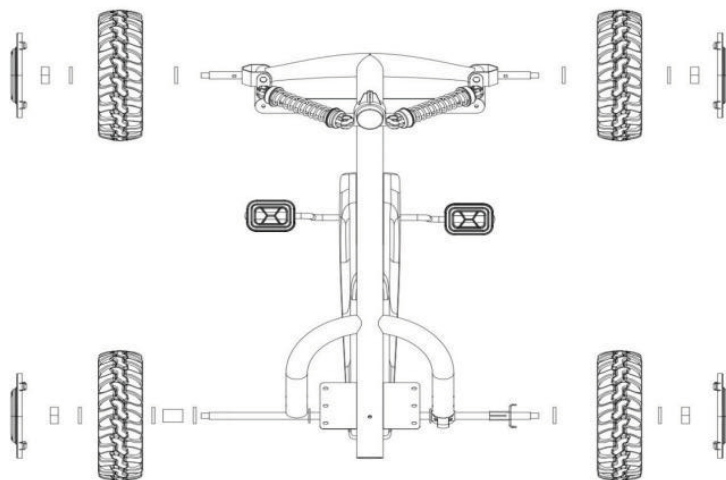

5. Coloque la arandela (junta M10) en el eje de dirección. Luego inserte el eje de dirección y encaje el bucle en la parte de conexión, como se muestra en la figura a continuación.

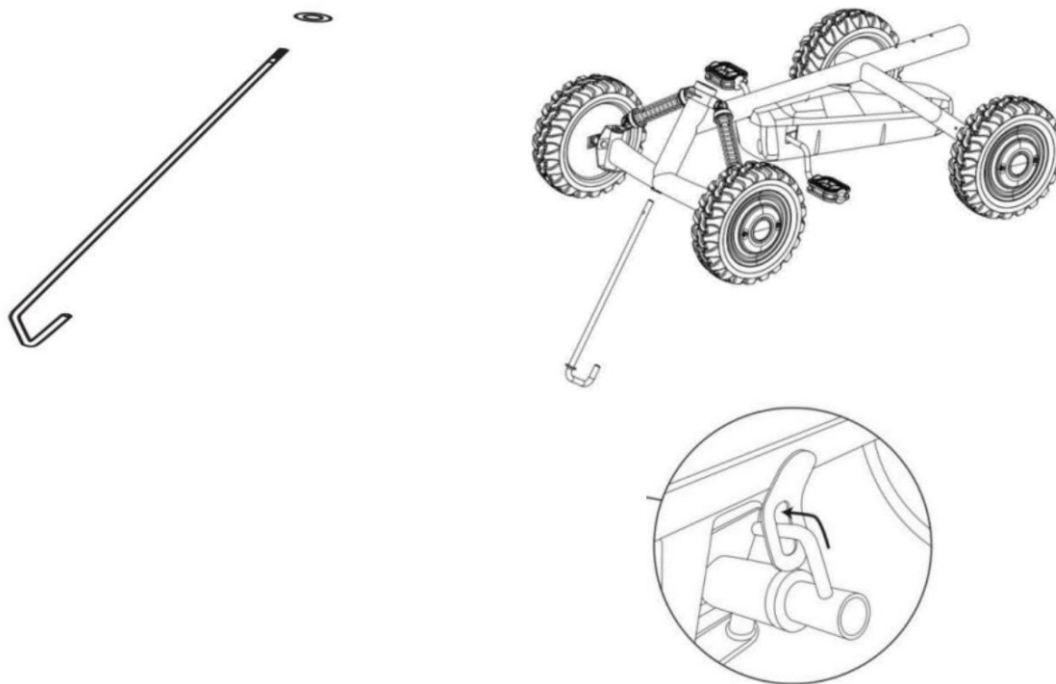

6. Coloque la cubierta del tubo guía sobre el eje de dirección.

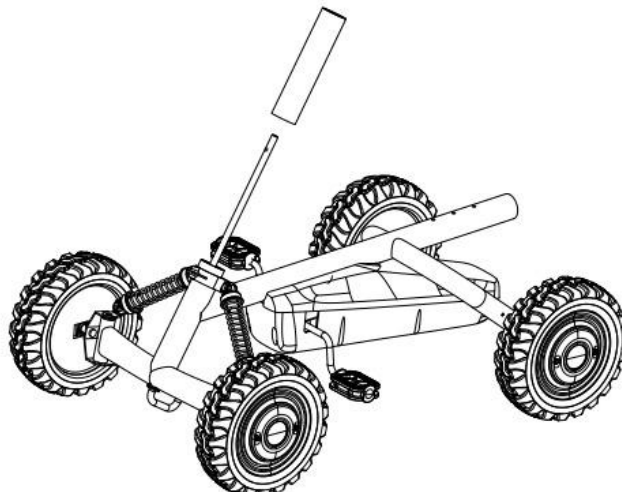

7. Coloque el panel sobre el tubo guía.

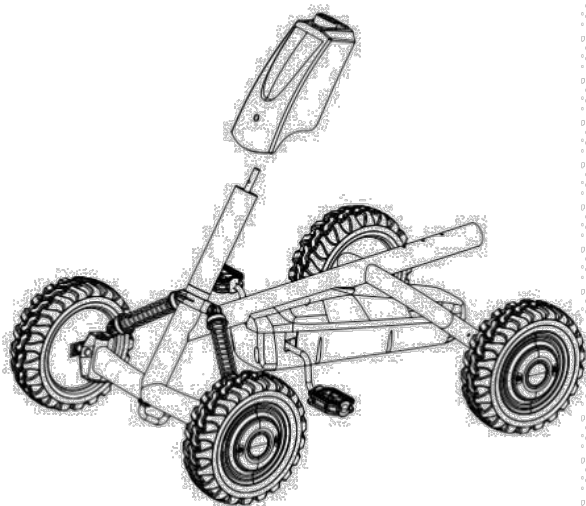

8. Fije el extremo de la cabeza en el eje de dirección y luego ajústelo con el tornillo M5*45 y la tuerca M5.

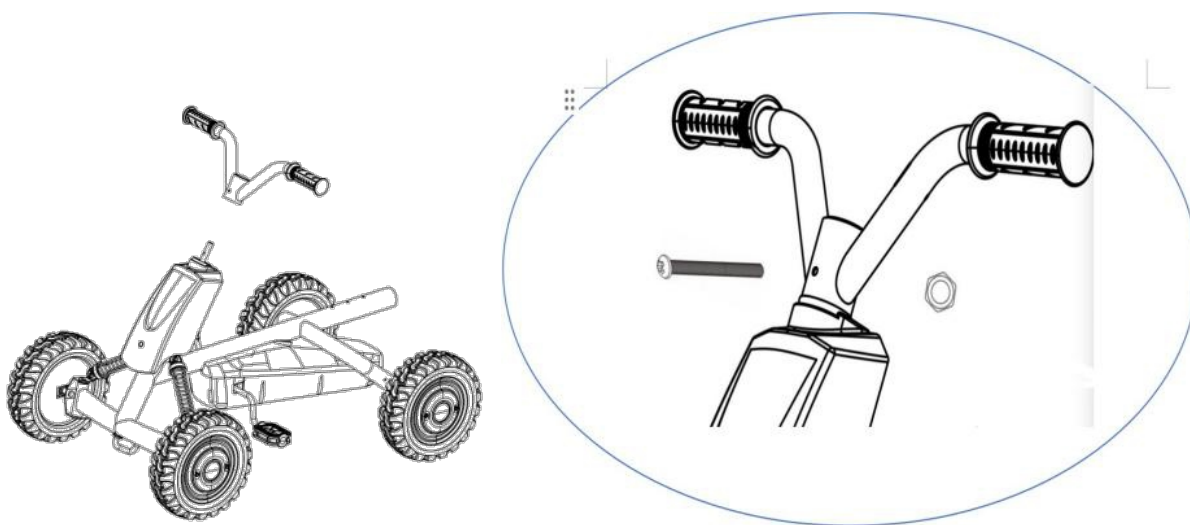

9. Fije el panel frontal al tubo del revestimiento y luego fijelo con el tornillo M4*14.

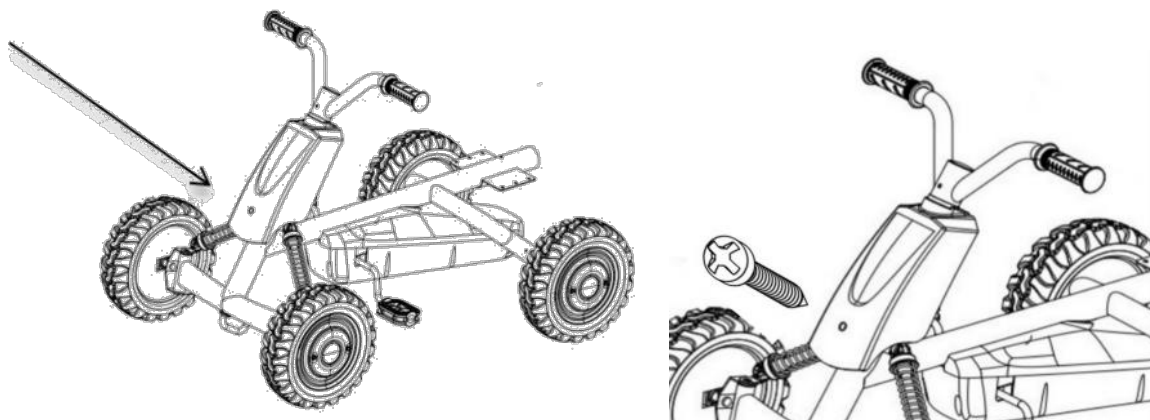

10. Fije el asiento con 2 tornillos M5*30, 2 juntas M5 y 2 tuercas M5.

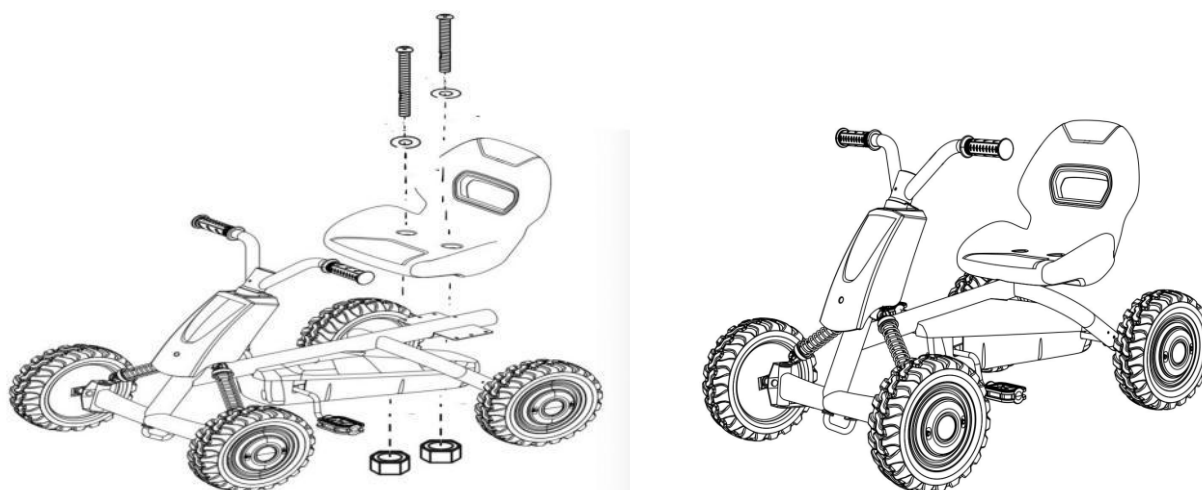

11. Pegue la calcomanía en el panel frontal.

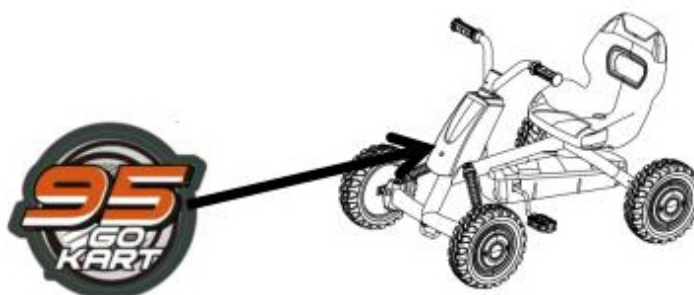

ADVERTENCIAS:

No apto para niños menores de 2 años

Capacidad máxima de 30 kg

Se requiere supervisión de un adulto en todo momento

Este producto no debe operarse en vías públicas, carreteras o carriles para bicicletas

Lea la sección 'Operación segura' antes de usar

Siempre inspeccione y mantenga el producto antes de usarlo

OPERACIÓN SEGURA:

Este producto debe ser ensamblado por un adulto y revisado por un adulto antes de su uso

Asegúrese de que las tuercas y los tornillos permanezcan bien ajustados antes de usar

Lubrique la cadena con frecuencia

El juguete debe usarse con precaución ya que se requiere habilidad para evitar caídas o colisiones que puedan causar lesiones al usuario o a terceros.

No almacenar bajo luz solar directa

Material de los productos:

A、 (PP) B、 (HIERRO)

Elenco dei componenti (inclusi)

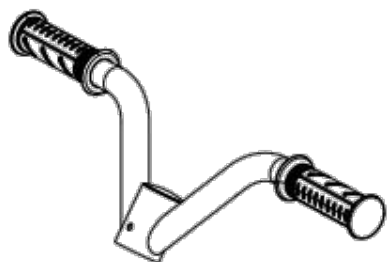

1. Testata*1

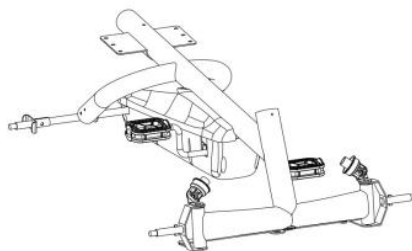

2. Telaio*1

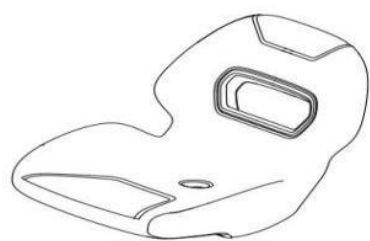

3. Sedile*1

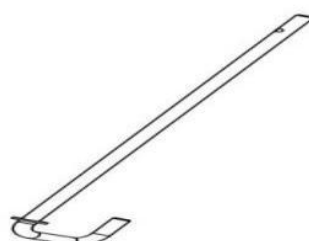

4. Albero di sterzo*1



5. Tubo lineare*1

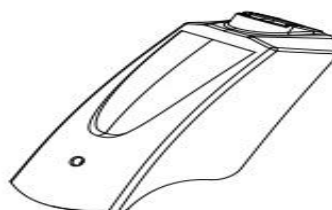

6. Pannello*1

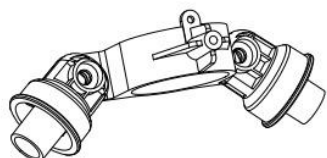

7. Componente plastico*1

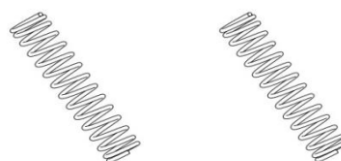

8. Tubi a molla*2

Elenco dei pezzi (inclusi)

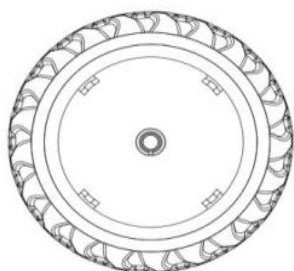

9. Ruote*4

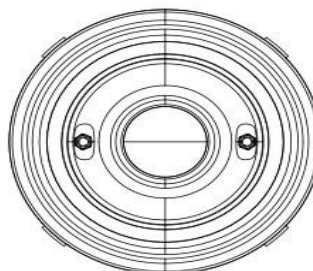

10. Mozzi ruota*4



11. Adesivo sul pannello



12. Manuale

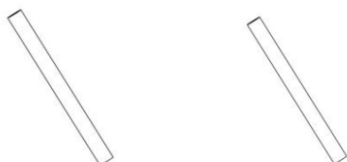

13. Parti in ferro*2



14. Sacchetto di dadi e bulloni:

- 2 x M4*14
- 1 x M5*45
- 2 x M5*30
- 2 x guarnizione M5
- 1 x guarnizione M10
- 3 x dado M5

Istruzioni di Montaggio:

1. Posizionare la parte in plastica sul telaio.

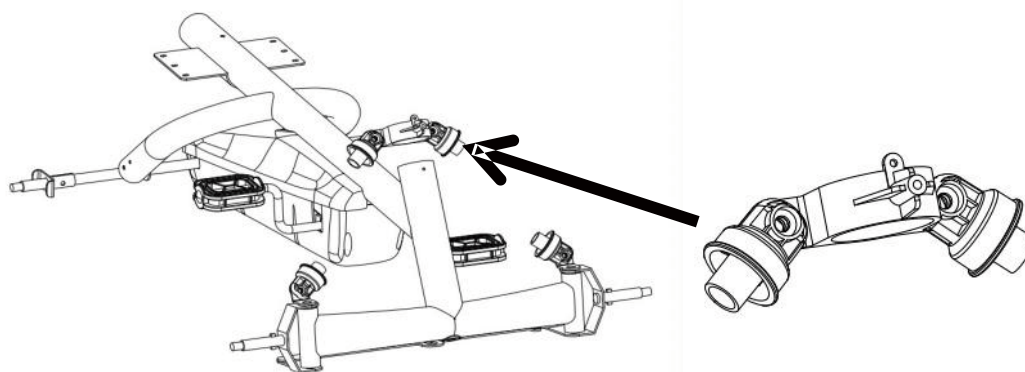

2. Per prima cosa, posizionare le parti in ferro nella posizione corretta sul telaio. Poi, far scorrere i tubi della molla sopra la parte in ferro, come mostrato nella figura sottostante.

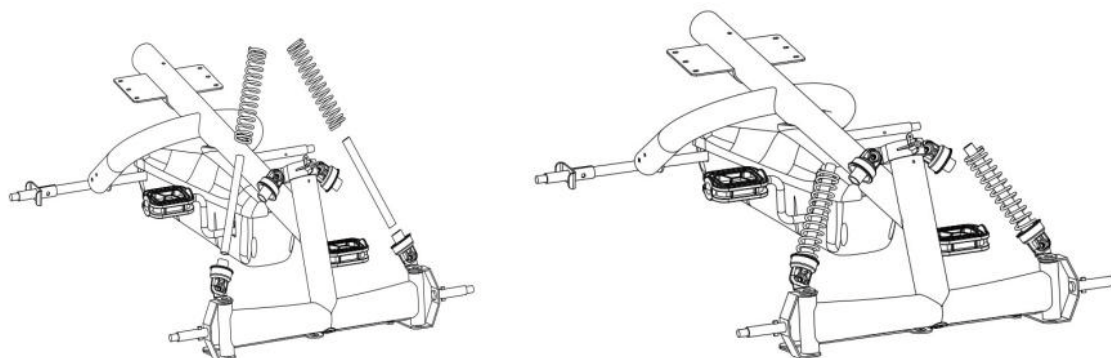

3. Prima fissare le parti in ferro alla parte in plastica, poi premere verso il basso la parte in plastica per allineare i suoi fori di montaggio con quelli sul telaio. Quindi fissarla con la vite M4*14.

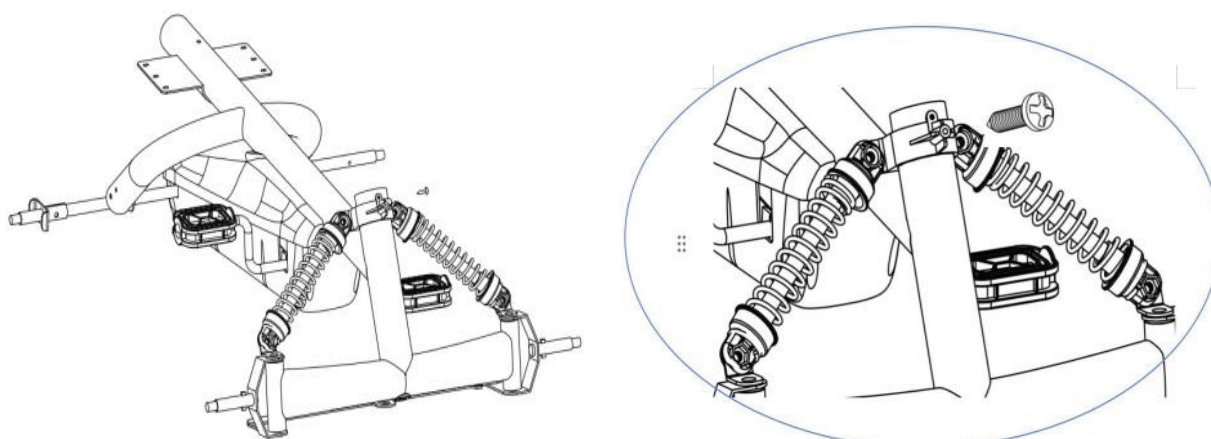

4. Fissare la ruota e il mozzo nella parte superiore dell'albero, come mostrato nella figura sottostante.

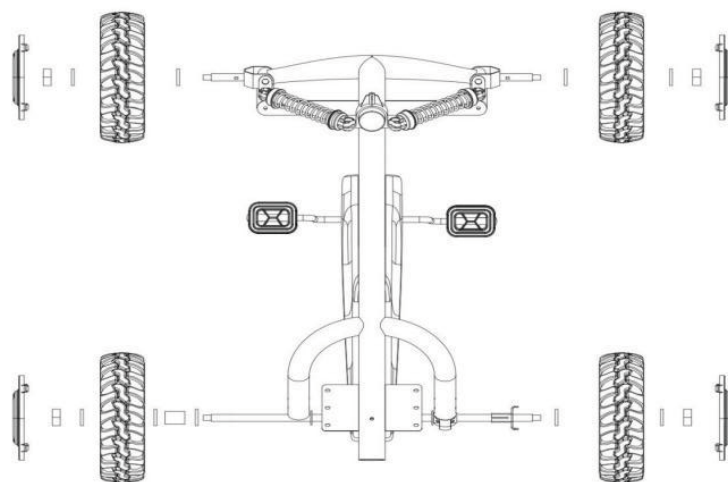

5. Posizionare la rondella (guarnizione M10) sull'albero sterzante, quindi inserire l'albero sterzante e far scorrere l'anello nella parte di collegamento, come mostrato nella figura sottostante.

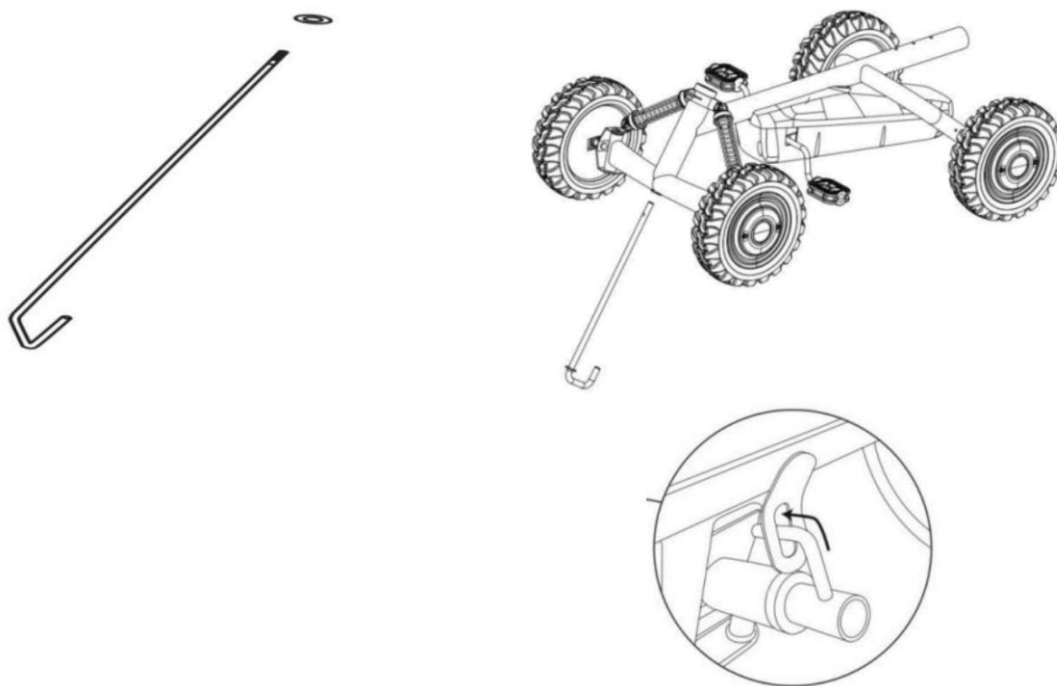

6. Posizionare il copertubo sull'albero dello sterzo.

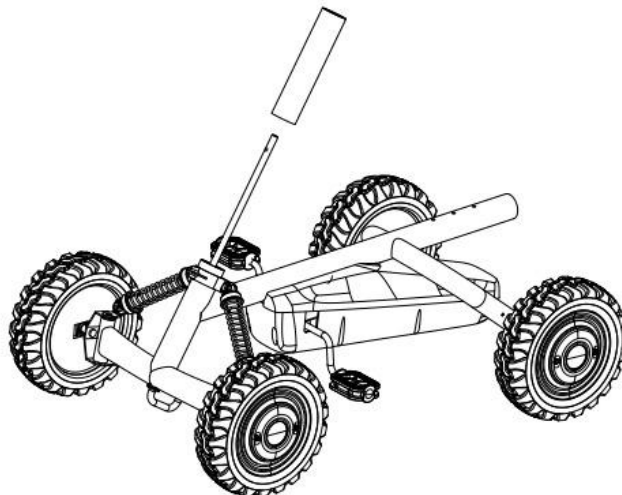

7. Posizionare il pannello sul copertubo.

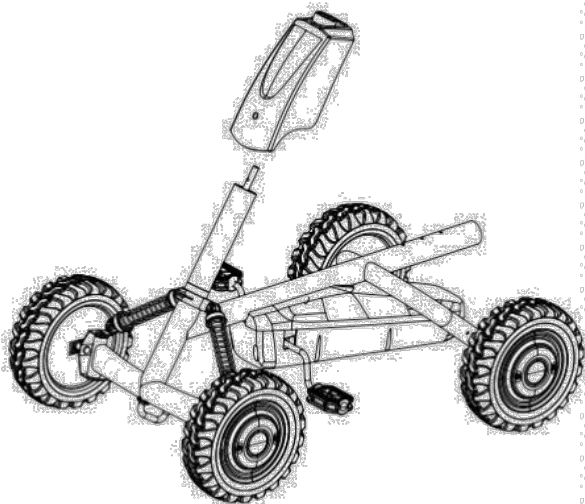

8. Fissare l'estremità superiore sull'albero dello sterzo, quindi fissarla con vite M5*45 e dado M5.

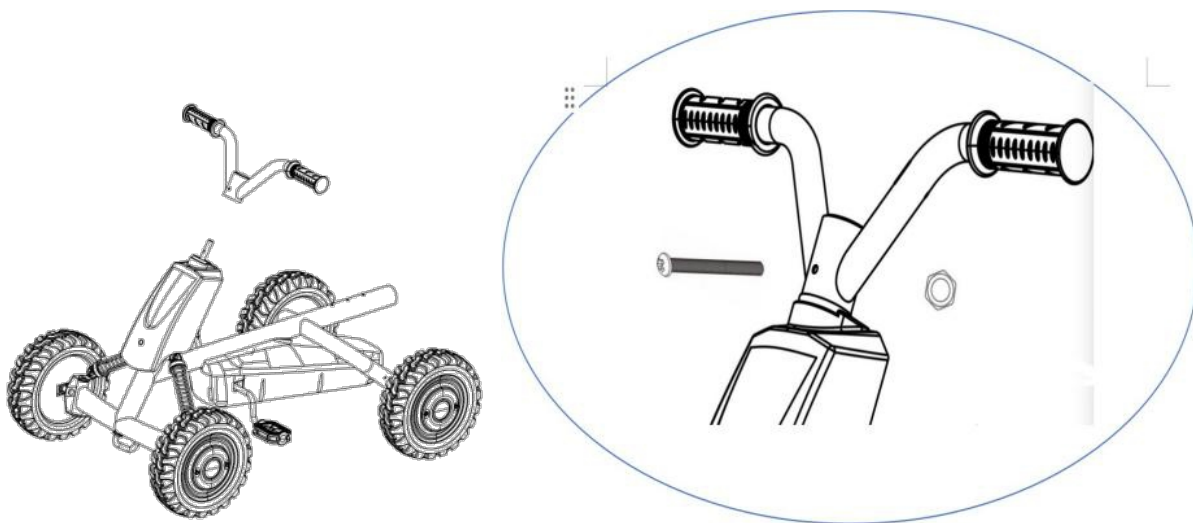

9. Fissare il pannello frontale al tubo di rivestimento, quindi fissarlo con la vite M4*14.

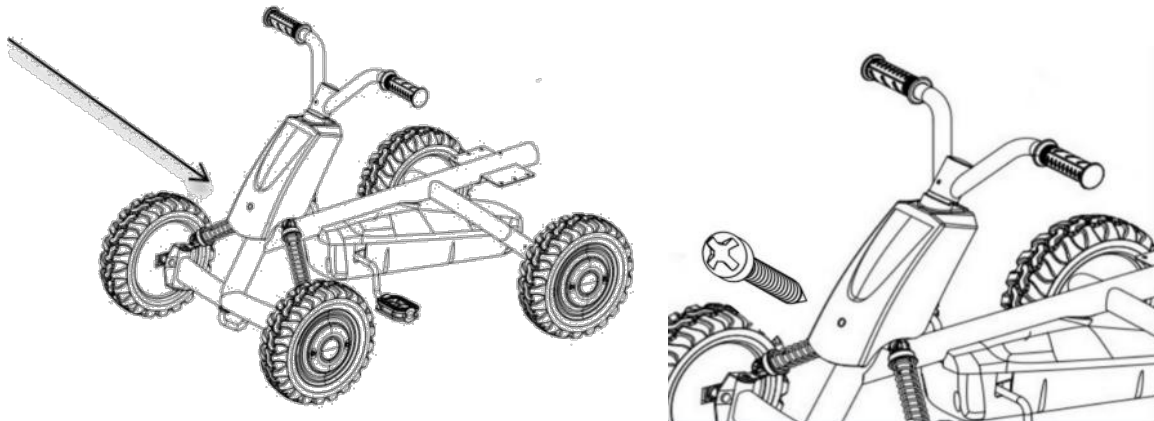

10. Fissare il sedile con 2 viti M5*30, 2 guarnizioni M5 e 2 dadi M5.

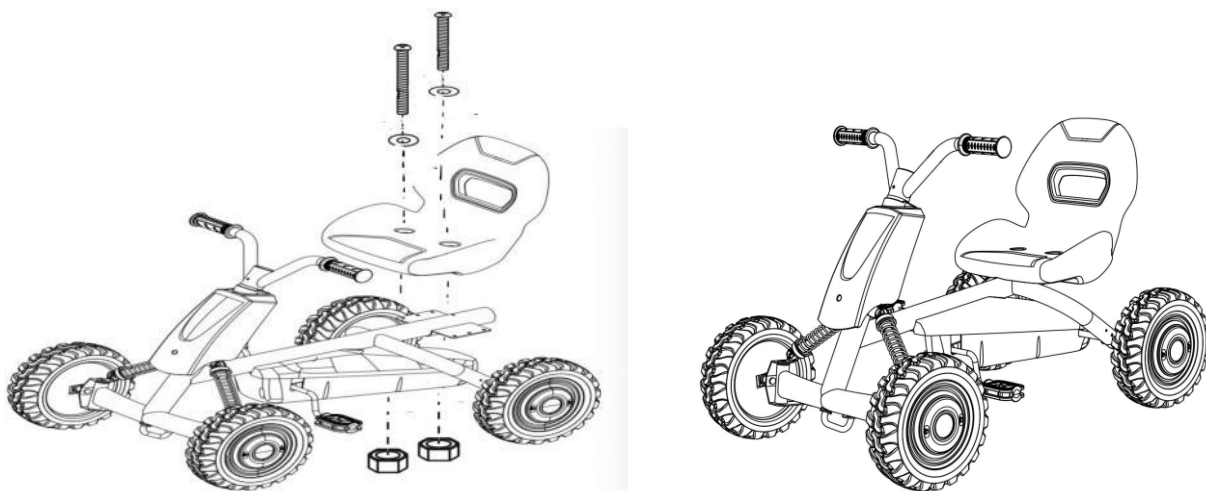

11. Applicare l'adesivo sul pannello frontale.



AVVERTENZE:

Non adatto a bambini di età inferiore a 2 anni

Capacità massima di 30 kg

È necessaria la supervisione di un adulto in ogni momento

Questo prodotto non deve essere utilizzato su strade pubbliche, autostrade o piste ciclabili

Leggere la sezione "Sicurezza operativa" prima dell'uso

Ispezionare e mantenere sempre il prodotto prima dell'uso

SICUREZZA OPERATIVA:

Questo prodotto deve essere assemblato da un adulto e controllato da un adulto prima dell'uso

Assicurarsi che dadi e bulloni rimangano saldamente fissati prima dell'uso

Lubrificare spesso la catena

Il giocattolo deve essere usato con cautela poiché è necessaria abilità per evitare cadute o collisioni che potrebbero causare lesioni all'utente o a terzi.

Non conservare alla luce diretta del sole

Materiale dei prodotti:

A (PP) B、 (FERRO)

UK

If you have any questions, please contact our customer care centre.

Our contact details are below:



0044-800-240-4004



enquiries@mhstar.co.uk

IMPORTER ADDRESS:

MH STAR UK LTD
Unit 27, Perivale Park,
Horsenden lane South
Perivale, UB6 7RH
MADE IN CHINA

ES

Si tiene alguna pregunta, comuníquese con nuestro Centro de Atención al Cliente. Nuestros datos de contacto son los siguientes:



0034-931294512



atencioncliente@aosom.es

Importador/Fabricante/REP:

Spanish Aosom, S.L.
C/ Roc Gros, nº 15. 08550, Els Hostalets de Balenyà, Spain.
B66295775
atencioncliente@aosom.es
TEL: 931294512
HECHO EN CHINA

FR

Si vous avez la moindre question, veuillez contacter notre centre d'assistance à la clientèle.

Nos coordonnées sont les suivantes:



0033-1-84166106



aosom@mhfrance.fr

Importé par/Fabricant/REP:

MH France
2, rue Maurice Hartmann
92130 Issy-les-Moulineaux
France
Fabriqué en Chine



Adresses sur quefairedemesdechets.fr

DE

Wenn Sie Fragen haben, wenden Sie sich bitte an unser Kundendienstzentrum.

Unsere Kontaktdaten stehen unten:



0049-0(40)-87408465



service@aosom.de

Importeur/Hersteller/REP:

MH Handel GmbH
Wendenstraße 309
D-20537 Hamburg
Germany
IN CHINA HERGESTELLT

IT

In caso di dubbio, si prega di contattare il nostro centro assistenza clienti. I nostri dettagli di contatto sono di seguito:



0039-0249471447



clienti@aosom.it

IMPORTATO DA/Produttore/REP:

AOSOM Italy srl
Centro Direzionale Milanofiori
Strada 1 Palazzo F1
20057 Assago (MI)
P.I.: 08567220960
FATTO IN CINA

