

English



ROSE HEATERS
UK INFRARED HEATER COMPANY

Jasmine range



User Manual

INFRARED HEATER - THERMAL WAVE PANEL

Basic, Premium

MODEL: TWP 300 / TWP 500 /
TWP 700 / TWP 1000



Before use, it is **MANDATORY** to read the instructions. Please pay particular attention to the passages with this symbol.



Thank you for purchasing this metal infrared heater. We hope that using our product will only evoke positive emotions.



Warning

Warning! Some components can get hot.

Special attention must be paid to the presence of children and people in the room vulnerable

- The heater can be used by children from 7 years of age and older. under adult supervision. The risk covers children and adult people who are physically and mentally limited in terms of their perception of their surroundings, and people who do not have sufficient knowledge about the safe operation of the device.
- Do not allow children to play with the appliance. Cleaning and using the device should not be made by children.
- Children under 3 years of age must not be near the device without adult supervision.
- Children from 10 to 15 years of age may turn on / off the heater if it is in a mode corresponding to the rules of using the device for its proper operation and they are under the supervision of adults or have been instructed on the safe use of the device and understand the possible dangers.
- Children from 3 to 10 years of age should not use the device or perform maintenance.
- If the power cord is damaged, it must be replaced by the manufacturer or a qualified specialist.



The unique fixing solution enables quick and easy installation of the TWP hybrid steel heating panel.

- 1 mm steel
- Powder coated
- Total thickness 40 mm
- Reflective top layer on the back to increase natural convection heat
- Each heater is equipped with an automatic protection against overheating
- Impact resistant and 2mm rounded corners

Specially designed hybrid steel heaters which operates through the combination of 60% radiation and 40% convection heating modes.

TWP hybrid steel heating panels are maintenance-free.

The panels are made of environmentally friendly materials.

Basic heating allowed. TWP heaters are also very often used as the primary additional type of heating.

The dimensions of the panels are possible to install both under the window and in other suitable places.

TWP heaters do not dry the ambient air, do not emit combustion products or water vapor, do not generate drafts and do not circulate dust in the room.

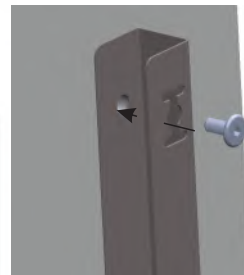
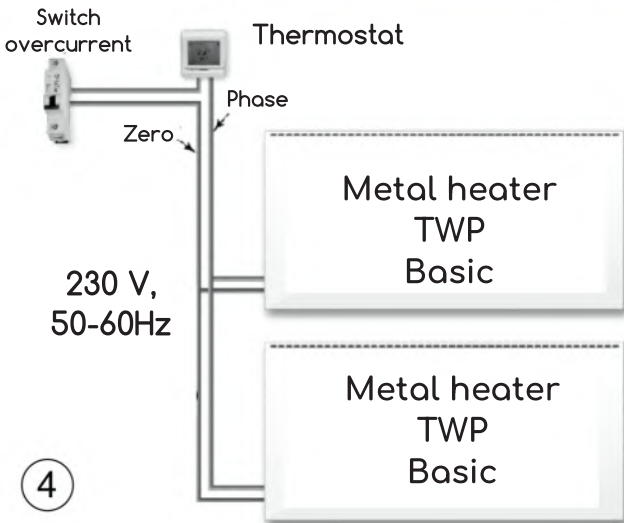
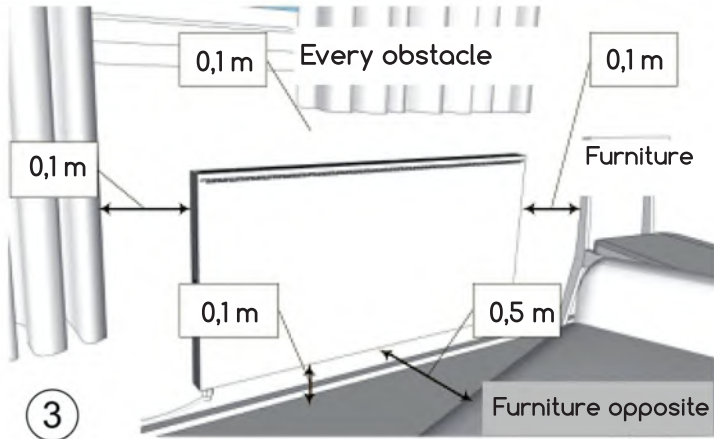
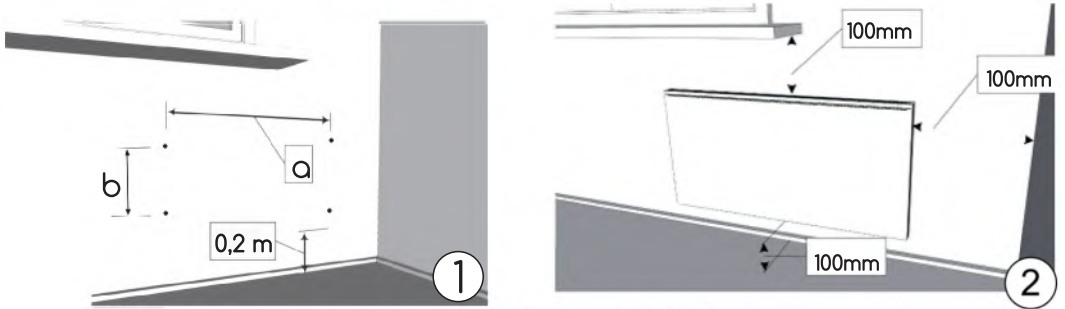

5

Installation scheme

TWP heaters can be mounted on the wall or used in a mobile version feet (sold separately).

Spacing table, mm

Model	a	b
TWP 300 (525x400x40)	240	340
TWP 500 (525x700x40)	400	340
TWP 700 (525x950x40)	500	340
TWP 1000 (525x1130x40)	600	340

Fig №1,2

Installation of the heater

All activities related to the assembly and service of the heater must be performed by qualified technical personnel.

1. The heater must be installed in accordance with Fig. 3.
2. Make sure there is NO electricity or water supply in the drilling area.
3. Measure distances "a" and "b" (Fig. 1).
4. Mark the holes.
5. Drill holes with a diameter of 8 mm.
6. Insert the plastic wall plugs.
7. Tighten the screws. (Fig. 1).
8. Screw on the brackets and install the heater. (Fig. 5).
9. Connect the heater to a power source.

If several radiators are installed in one room, they should be connected in parallel.

Do not mount the heater directly below an electrical outlet.

 To be able to completely disconnect the appliance from the mains, the heaters should be connected via an automatic residual current device (RCD).

The device should be disconnected from the socket before cleaning. Cleaning should be done with care products that do not contain abrasives.

 Do not use strong detergents or solvent-based care products for cleaning the heater.



Series: Basic, Premium

All heaters have a power cord with an electric plug.

Basic - a power cord with an electric plug.

Premium - electronic thermostat with an air temperature sensor and the surface of the heater.

Components for the heater:

Heater TWP.....1 psc.;

Power cord with plug.....1 psc.;

Pins with screws.....4 psc.;

Screws.....4 psc.;

Fastening buckles.....2 psc.;

User manual.....1 psc.;

Electronic thermostat.....1 psc.* Series Premium

The legs can be purchased separately.

Destiny:

Metal infrared heaters TWP are designed for the basic and additional heating of residential and utility rooms at a voltage of 220-230 V, 50 Hz.

Model	TWP 1000	TWP 700	TWP 500	TWP 300
Rated power consumption, kW	1,0	0,7	0,5	0,3
Nominal current max., A	4,54	3,18	2,27	1,36
Voltage, V	220-230			
Frequency Hz	50			
Heater area, m ²	0,59	0,50	0,36	0,21
Heating temperature, C°	85±5	85±5	85±5	85±5
Weight (not more), kg	7,4	6,1	4,7	1,8
Time to enter the mode, min.	7	7	7	7
Heated volume of the room (no more), m ³	45-50	30-35	20-25	10-15
Installation method	wall			
Sizes (HxWxD), mm	520x1130x40	520x950x40	520x700x40	520x400x40



WARNING!

- When connecting TWP, make sure that the power supply is adequate (according to the table)
- Before installation, it is necessary to check the electric load, whether its power is suitable for connecting radiators and other appliances in the house.
- The electrical safety of TWP is only guaranteed if the earthing is carried out in accordance with the applicable safety standards.
- TWP is connected to a 220-230 V (50 Hz) network.

Remember!

It is not recommended to use adapters, double or more sockets, as well as extension cords.

Practical advice

- There is no need to set the maximum temperature on the thermostat as the room temperature will not rise any faster.
- The heater must be turned off when ventilating the room.
- If you leave the house for less than 2 hours, there is no need to change the temperature on the thermostat, but if you leave for 2-24 hours, it is necessary to maintain the temperature (+ 15C °).

Maintenance instruction thermostat "TWP" (to the time programmer Premium)

This thermostat "TWP" is designed for economic management of electro-heating devices to ensure the maximum comfort. Temperature control is by means of two temperature sensors, one controls the room temperature, which enables to minimize the power consumption and as well to set for each room the individual temperature; another sensor monitors the surface temperature of the heater that maximizes its security (excludes overheating under high voltage power supply, covering and tipping of the device, it provides the possibility to limit the temperature in children rooms, etc.). The user sets for itself the necessary temperature in the room (it is possible according to the clockwise programme), the thermostat automatically finds, depending on heat the room, the needed temperature of the heater, as well as the load on the electricity grid (100% or 50% of capacity).

The thermostat during turning on and as well as during operation of the device controls the device ground and in case its absence gives the warning 'Grnd', accompanied by a sound signal and then goes into the operating mode. For turning on ('Gnd'), and off ('nGnd') the ban on heaters work, during the absence of the heaters ground, it is necessary during display 'Grnd' to press and hold both buttons, then to remove and insert the plug into the socket, and once the relevant indication appears, to release the button.



Indicator of the heating mode

Heating

(Indicator light on = Full power. Flashing = half power)



Room temperature

(displays temperature when in operation)

Current time

(Displayed from time to time with the temperature when heating mode on program is switched on)

12:35

The temperature of the heater surface

(Displayed for 4 seconds after the short pressing of both buttons)

P62

Button to increase Button to lower
with the accuracy of 0,5 the room
temperature within 5 °C ... 35

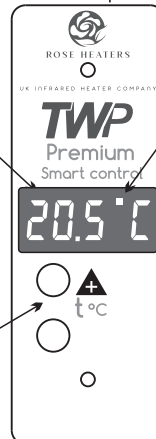



Indicator of the heating mode (last symbol)



Heating completely turned off by the user, the brightness of the display is reduced, only thermometer works. Turning on ('On') and OFF ('OFF') is carried out by simultaneously pressing and holding both buttons for more than 2s until you hear sound confirmation.

The mode is enabled by the program or constantly running when the program is shut down



Maintaining the comfortable temperature in the room. * To set the temperature in the heating mode, briefly press any button, the previously set value starts to blink, until the value is flashing, you can change the set temperature by pressing the appropriate button. If the button is not pressed for more than 5 seconds, you are returned to the heating mode.

Flashing of this symbol means that when you reach a comfortable room temperature the heater surface may heat up to 95 °C, in spite of this limit (only program).

Modes, which are turned on in the program



Maintaining the economical room temperature.* Can be set from the correction - 9,5 °C till + 9,5 °C - as far as it's necessary to lower or raise the temperature in the room with respect to given comfortable 'C' temperature.



Cooling premises not lower + 5 °C (Antifreeze). *



The surface of the heater is heated to the maximum set temperature regardless of the room temperature.



Heating isn't carried out.



For blocking the buttons (protection of children, etc.) remove the socket from outlet, press and hold the button '▲', insert the plug into the wall outlet and do not let go the button until the appearing indication 'Loc', and tone.



To unlock the buttons, you must remove the plug from the socket, press and keep the button '▼', insert the plug into the wall outlet and do not let go the button till the indication 'UnLo' and tone appears.



To turn on the heating hour program it's enough to enter the current time setting screen (meanwhile the numbers of any passing screens can be adjusted, you can also change the value of time and go to the next screen to view and edit modes of the program).

For disabling the hourly program (in this case in the room will be kept comfortable temperature 24 hours) it's necessary to reset only comfortable temperature (to make any changes of the Screen 1 without switching to other screens).

* - Present 3 heating modes (Antifreeze , Comfort, Economy) .

Adjusting temperatures, current time and setting the warm-up program on time

Parameter setting mode is activated (Screen 1 value starts to blink). Press and hold button to turn on auto-scrolling (especially it's necessary to set the time). Return to the main mode automatically, after 5 ... 12s. inactivity. Go to the next screen by simultaneously pressing and holding the button (until the value is flashing!) for more than 2 seconds until the confirmation beeps.

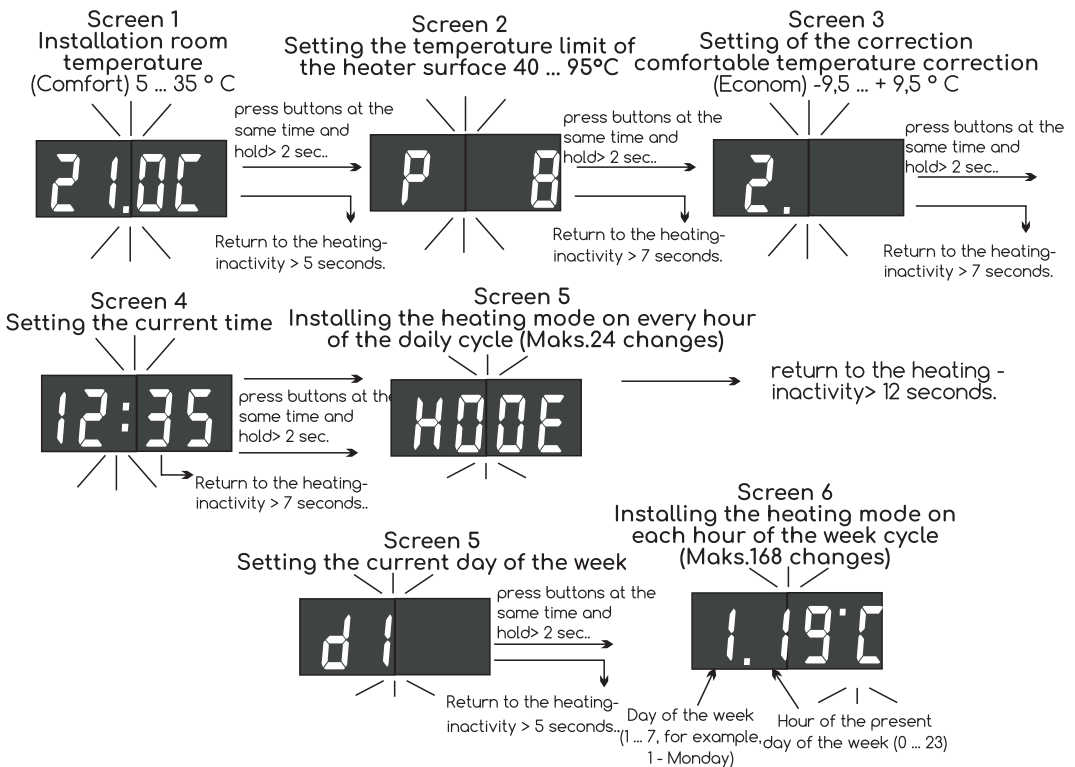

Installation examples of the Screen 5 of the daily programming cycle (first three) and Screen 6 of the week cycle.

h20C

Every day from 20.00 to 20.59
comfortable temperature
(Setting Screen 1)

h00E

Every day from 00.00 to 00.59
economical temperature
(Setting Screen 1 and 3)

h01A

Every day from 01.00 to 01.59
antifreeze mode
(not less than + 5 ° C in the room)

1.19°C

In day №1 from 19.00 to 19.59
to achieve the comfortable
temperature with the heater
warming to 95 ° C
(setting Screen 2 is ignored)

1.05P

In day №1 from 05.00 to 05.59
the heater warming irrespective
of the room temperature
(setting Screen 2)

1.10

In day №1 from 10.00 to 10.59
heating is not carried out

 Installation of the time warm-up mode (5/6 screen). Downtime of the screen till the automatically exit 12 seconds. Press the buttons to select the desired hour of the day (day of the week) and to view preset heating mode for him. To change the heating mode of the displayed hour (day), press both buttons simultaneously, if the buttons are continued to hold - the selected mode will be automatically copied to the next hour. Copying 23th hour 1 ... 6 days will cause the copying of the entire program of the current day to the next..

Technical characteristics of the thermostat:

Measuring range of the room temperature -9.5 ... + 99.5 °C

Room temperature setting range 5 ... 35 °C

Setting range of the limit heater temperature 40 ... 95 °C

Operating voltage power supply range 160 - 250 V (50 Hz)

Power consumption 1,4 W

Warnings of the thermostat:

'E r r 2' - Emergency overheat

'- - - P' - Sensor of the heater does not work



Terms of warranty

1. The basis for accepting a complaint under the warranty is an official warranty card correctly filled in by the seller with a proof of purchase (invoice or receipt). The warranty card must contain the name and serial number of the device, the date of sale as indicated on the proof of purchase, and the name and address of the seller (stamp). In the event of a defect that is not covered by the warranty, the customer covers the costs of the repair service.
2. The device is intended for home use in accordance with the instruction manual. Connect to a socket with a grounding pin.
3. The warranty is granted for a period of 5 years from the date of purchase, but not more than 6 years from the date of production. The warranty for electrical components is 2 years.
4. This warranty does not exclude, limit or suspend the rights of the buyer resulting from the provisions on the warranty for defects in the sold item.
5. The warranty does not cover:
 - a) using the device contrary to the requirements of the operating conditions;
 - b) mechanical damage to the equipment caused by the user and defects caused by them;
 - c) damage and defects to equipment resulting from:
 - use of the device inconsistent with the operating instructions;
 - installation that does not meet the technical requirements for the device specified in the device manual;
 - unauthorized repair, alter or change the design or any parts of the device

If the nameplate with the serial number of the device has been destroyed (removed).

