





TABLE OF CONTENTS

SECTION	PAGE
Symbols	4
Safety Information	5
Unpacking and Product Features	8
Assembly	9
Operation	10
Maintenance	12
Troubleshooting	13
Technical Data	15
Recycling And Disposal	15

Thank you for purchasing this Vacmaster® carpet spot cleaner. Feel confident that with Vacmaster® you are obtaining a high-quality product that is engineered for optimal performance. This carpet spot cleaner is suitable for use with liquid materials.

FOR YOUR SAFETY: CAREFULLY READ AND UNDERSTAND ALL INSTRUCTIONS.

SYMBOLS

	Caution.
	Read instruction manual. Failure to follow the warnings and instructions may result in electric shock, fire and/or serious injury.
	Appliance in which protection against electric shock does not rely on basic insulation only but in which additional safety precautions are provided, such as double insulation or reinforced insulation, there being no provision for protective earthing or reliance upon installation conditions.
	Do not dispose of electrical equipment in domestic waste.
IPX4	Protection against penetration of dust, protection against vertical water drips.

SAFETY INFORMATION

READ AND UNDERSTAND ALL INSTRUCTIONS BEFORE USING THIS PORTABLE CARPET SPOT CLEANER.

When using the equipment, a few safety precautions must be observed to avoid injuries and damage. Please read the complete operating manual with due care. Keep this manual in a safe place so that the information is always available. If you give the equipment to any other person, give them these operating instructions as well. We cannot accept any liability for damage or accidents which arise due to a failure to follow these instructions and the safety information.

- Never leave the appliance switched on unattended, if you leave the work area, switch the appliance off or unplug it from the power supply.
- Do not vacuum or use this carpet cleaner near flammable liquids, gases or explosive vapours like gasoline or other fuels, lighter fluids, cleaners, oil-based paints, natural gas, hydrogen, or explosive dusts like coal dust, magnesium dust, grain dust or gun powder. Sparks inside the motor can ignite flammable vapours or dust.
- This carpet cleaner is not suitable for the vacuuming of asbestos or asbestos dust.
- Do not vacuum anything that is burning or smoking, such as cigarettes, matches, or hot ashes.
- Ensure the hose and connections are always pointed away from the users face, hair, ears and eyes during operation and never direct the nozzle towards persons or animals.
- Clear the working area of any items or possessions that you do not wish to be vacuumed before operation.
- Keep cord away from heated surfaces.
- Do not expose to rain. Store indoors.

- Do not unplug by pulling on the cord. To unplug, grasp the plug, not the cord.
- Do not use with damaged cord, plug or other parts.
- Do not pull or carry by cord, use cord as handle, close a door on cord, or pull cord around sharp edges or corners.
- Do not handle the plug or carpet cleaner with wet hands.
- To reduce the risk of health hazards from vapours or dusts, do not vacuum toxic materials.
- Do not use or store near hazardous materials.
- Do not allow to be used as a toy. Close attention is necessary when used by or near children.
- Unplug from power supply when not in use and before carrying out maintenance.
- Do not cover the ventilation openings. Do not vacuum with any ventilation openings blocked; keep free of dust, lint, hair or anything that may reduce air flow.
- Keep hair, loose clothing, fingers, all parts of body away from openings and moving parts.
- If the supply cord is damaged, it must be replaced by the manufacturer, a qualified service agent or similarly qualified persons in order to avoid a hazard.
- This appliance can be used by children aged from 8 years and above and persons with reduced physical, sensory or mental capabilities or lack of experience and knowledge if they have been given supervision or instruction concerning use of the appliance in a safe way and understanding the hazards involved.
- Children shall not play with the appliance.
- Cleaning and user maintenance shall not be made by children without supervision.
- Use extra care when cleaning on stairs. To avoid personal injury or damage, and to prevent the cleaner from falling,

always place cleaner at bottom of stairs or on floor. Do not place cleaner on stairs or furniture, as it may result in injury or damage.

- For additional protection: It is recommended that this carpet cleaner can be used in conjunction with residual current device (RCD) with a rated residual current of 30mA or less.
- If foam or liquid escapes from the machine, switch off immediately.
- Check the float valve regularly to ensure it is moving freely and examine it for signs of damage.
- Besides the operating instructions and the binding accident prevention regulations valid in the country of use, observe recognised regulations for safety and proper use.
- Before starting work, the operating staff must be informed on
 - use of the carpet cleaner,
 - risks associated with the material to be picked up, safe disposal of the picked up material.

UNPACKING AND PRODUCT FEATURES

1	Carry Handle	10	Clean Water Tank
2	Power Button	11	Power Cord Hooks
3	Suction Hose	12	Clean Water Tank Cover Tab
4	Dirty Water Tank	13	Clean Water Tank Cover
5	Dirty Water Tank Cover Tab	14	Hose Cleaning Tool
6	Dirty Water Tank Cover	15	Tough Stain Nozzle
7	Tool Release Button	16	Cleaning Solution
8	Power Cord	17	Instruction Manual
9	Hose Storage Clip		

ASSEMBLY

1. Align the primary hose storage clip with the bracket as shown (Fig. 1). Slide the hose storage clip downwards until it is secured into place.
2. Align the secondary hose storage clip with the bracket as shown (Fig.2). Slide the hose storage clip downwards until it is secured into place.
3. Attach the tough stain tool onto the end of the suction hose until it clicks into place (Fig. 3).
To remove: Press the tool release button and pull away.

NOTE: Wrap the suction hose into the hose storage clips when not in use (Fig. 4).

4. Wrap the power cord loosely around the quick release cord hooks (Fig. 5).

NOTE: Make sure to wrap the power cord around the lower cord hook first to avoid damaging the power cord.

OPERATION

1. Filling The Clean Water Tank

- 1) Remove the clean water tank from the side of the unit. A security latch (①) is positioned to keep the clean water tank in position to avoid unintentional release. The latch will automatically release when the tank is pulled upwards (Fig. 6).
- 2) Remove the clean water tank cover by releasing the clean water tank cover tab. Fill with warm water (Max 40°C) and solution. Ensure the correct proportion of water and cleaning solution is used by referring to the solution label (Fig. 7).

SMALL CLEANING AREA - 0.8L Liquid (②)

LARGE CLEANING AREA - 1.6L Liquid (③)

Do not exceed filling the clean water tank over the maximum fill line indicated on the clean water tank.



CAUTION: Do not fill with water above 40°C. Do not heat water or tank in microwave.

NOTE: A 236ml bottle of solution is provided with this carpet cleaner. Ensure the solution and water are mixed correctly. Once sample bottle is depleted, the solution can be replaced with a high-quality carpet solution.

NOTE: The carpet solution can cause eye irritation. Wash affected area cautiously with water for several minutes. If irritation persists, seek medical advice. Do not ingest. Keep out of reach of children.

- 3) Insert the locking tabs into the slots of the clean water tank and then secure the clean water tank cover back into place until a click is heard (Fig. 8).
- 4) Slide the clean water tank back onto the unit. The security latch will automatically secure once the clean water tank is in position. A click will be heard when correctly installed.

2. Using Your Machine

IMPORTANT: Before using the carpet cleaner, thoroughly vacuum the area to be cleaned. Always test a small hidden area for colourfastness and pile distortion.

Test colourfastness - Gently rub surface with a dampened white cloth containing cleaning solution. Wait 10 minutes and check for colour removal with a white paper towel. If colour changes, do not use.

NOTE: To prevent staining, please use plastic, wax paper or aluminum foil to protect wood or metal surfaces from possible water spray.

To protect the wooden floors underneath rugs or carpet, place protective material (e.g. plastic) underneath them before cleaning.

NOTE: Always refer to and follow the manufactures care guidelines before using cleaning solution and carpet cleaner.

- 1) Unwrap the hose and ensure a tool is attached securely.
- 2) Turn the quick release cord hooks to release the power cord (Fig. 9).

3) Plug the power cord into a power outlet.



WARNING: If any abnormality/failure occurs, stop using the product immediately and disconnect the power plug.

4) Press the power button to turn the carpet cleaner on (Fig. 10).

5) For spills, first collect any excess liquid before using water/solution. Place the cleaning nozzle towards the front of the spill and slowly pull backwards over the area.

6) To dispense cleaning solution, hold the tool about 2.5 cm over the area to be cleaned. Squeeze the spray trigger to release a mix of water and cleaning solution (Fig. 11).

7) Release the trigger and use the brush on the nozzle to agitate cleaning area by scrubbing.

8) To lift away the stain, tilt the nozzle to make contact with surface and pull the tool backward slowly to vacuum up excess dirty liquids. Repeat as necessary (Fig. 12).

NOTE: Ensure the nozzle is in contact with the surface, over or under tilting may result in poor pick up.

9) Once you have completed cleaning, press the power button and unplug the power cord.

3. Emptying The Dirty Water Tank



WARNING: Always unplug power cord from electrical outlet before performing any service on carpet cleaner.

Empty the dirty water tank when the dirty liquid reaches the "Max Fill" line and there is a loss in suction. During normal use, debris may accumulate in the dirty water tank. To keep the carpet cleaner functioning properly, rinse the dirty water tank with clean water after each use and leave to air dry before refitting.

1) Remove the dirty water tank from the side of the unit. A security latch (④) is positioned to keep the dirty water tank in position to avoid unintentional release. The latch will automatically release when the tank is pulled upwards (Fig. 13).

2) Remove the dirty water tank cover by releasing the dirty water tank cover tab (Fig. 14).

3) Empty the tank into a sink or toilet. Rinse the tank thoroughly with clean water. Allow the tank to air dry before reinstalling (Fig. 15).

4) Insert the locking tabs into the slots of the dirty water tank first and then secure the dirty water tank cover back into place until a click is heard (Fig. 16).

5) Reinstall the dirty water tank back onto the unit. The security latch will automatically secure the dirty water tank in position. A click will be heard when correctly installed (Fig. 17).



WARNING: The motor noise changes to a higher pitch when the dirty water tank is full or blocked. Stop the carpet cleaner immediately and empty the dirty water tank.

MAINTENANCE



WARNING: Remove the power cord from the power supply before carrying out any maintenance.

1. Cleaning Exterior

- 1) Turn off and unplug carpet cleaner.
- 2) To clean exterior, or to reduce static electricity and dust build-up, wipe outer surface with a clean, damp and soft cloth. Wipe dry after cleaning.

2. Cleaning The Tough Stain Nozzle

It is recommended to clean the tough stain nozzle with water after each use.

- 1) Press the tool release button to remove the attachment from the suction hose (Fig. 18).
- 2) Pry open the cover release tab (Ⓢ) on the nozzle to remove the cover (Fig. 19).
- 3) Rinse thoroughly with clean water. Allow the parts to dry before reinstalling.
- 4) Reinstall the nozzle cover back into place until a click is heard.

3. Hose Cleaning Tool

- 1) Remove the clean water tank and fill with warm water (Max 40°C).
- 2) Attach the hose cleaning tool to the suction hose (Fig. 20). Ensure any tools or attachments are removed.
- 3) Make sure both the clean water and dirty water tanks are secured on the unit.
- 4) Press the power button to turn the carpet cleaner on and hold the spray trigger for 30 seconds (Fig. 21). The clean water will rush through the suction hose, effectively cleaning and removing any trapped dirt and debris in the hose which may build up over time. Repeat as needed. Let the machine run for 5-10 seconds before turning off.
- 5) Turn off and unplug carpet cleaner.

4. Cleaning The Filter Grill

- 1) Remove the dirty water tank from the side of the unit.
- 2) Remove any dirt and debris from the filter grill (Ⓣ) as shown (Fig. 22).

5. Storage

WARNING: Wrapping the power cord too tightly puts stress on the cord and could cause damage. A damaged cord is an electrical shock hazard and could cause personal injury or damage.

- 1) Replace suction hose and attachments in storage position.
- 2) Wrap the power cord loosely around the cord hooks. Attach plug retainer clip onto the power cord.
- 3) Empty the clean water tank (if necessary). Rinse it out before replacing on the unit. Open the clean water tank cap to allow it to air dry.
- 4) Empty the dirty water tank then rinse, clean and dry before placing back on the unit.
- 5) Store the carpet cleaner in a dry and cool indoor area.

TROUBLESHOOTING



WARNING: To reduce the risk of electric shock, unplug before troubleshooting.

PROBLEM	POSSIBLE CAUSE	SOLUTION
The carpet cleaner is not operational.	Unplugged at power outlet.	Plug in firmly to suitable power outlet.
	Defective power outlet.	Check with a good appliance. Be sure the power cord plug is fully plugged into an electrical outlet.
	The motor is damaged.	Have the damaged part checked by qualified personnel or contact the after sales team.
Poor pick-up performance.	Dirty water tank is not installed correctly.	Check the dirty water tank for correct installation.
	Dirty water tank is full.	Empty the dirty water tank.
	The suction hose is clogged.	Clean the hose with the provided hose cleaning tool.
	Float valve is activated.	Empty the dirty water tank and ensure the float valve is moving freely.
Water escapes from the carpet cleaner.	Dirty water tank is full.	Empty the dirty water tank.
	Dirty water tank is not installed correctly.	Check the dirty water tank for correct installation.
	Clean water tank is not installed correctly.	Check the clean water tank for correct installation.
No solution spraying out.	Clean water tank is empty.	Fill the clean water tank.
	Clean water tank is not installed correctly.	Check the clean water tank for correct installation. Ensure it is installed in place.

PROBLEM	POSSIBLE CAUSE	SOLUTION
Hose nozzle will not spray after filling the clean water tank.	Air is trapped in the pump and hose.	Turn on the carpet cleaner. If hose does not spray, prime the pump by lowering the hose down to the floor and hold the trigger for up to 1 minute.
Motor noise becomes high-pitched.	Dirty water tank is full.	Empty the dirty water tank.
	The suction hose is clogged.	Clean the hose with the provided hose cleaning tool.
	The float valve in the dirty water tank has been activated.	Empty and clean the dirty water tank.

TECHNICAL DATA

Model Number	SCB0501 01
Motor	220-240V~50Hz
Power Input	500W
Clean Capacity	1.6L
Net Weight	3.5kg

RECYCLING AND DISPOSAL

This marking indicates that this product should not be disposed with other household wastes. The machine must be delivered in rigid packaging to avoid damage during transportation. The packaging and the machine itself are manufactured from recyclable materials and should be disposed of accordingly.

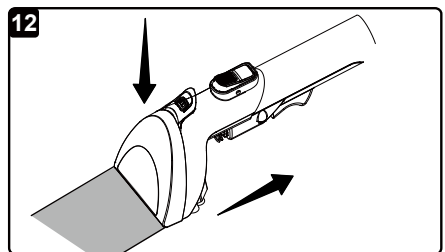
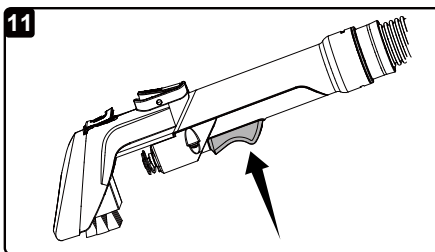
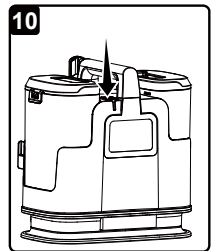
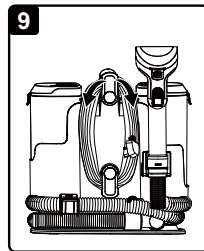
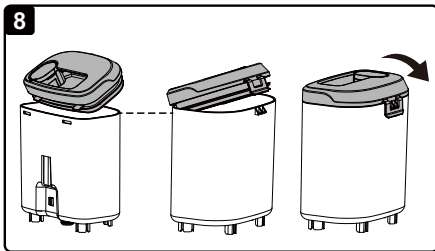
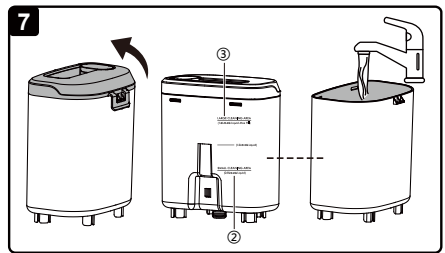
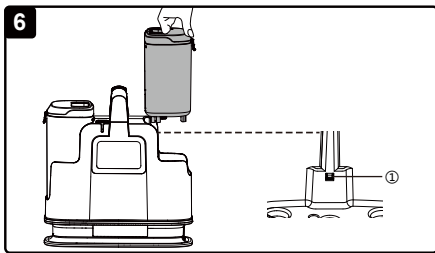
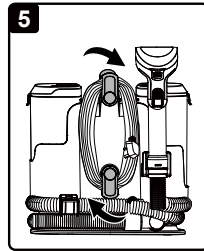
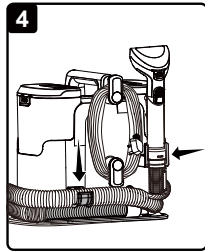
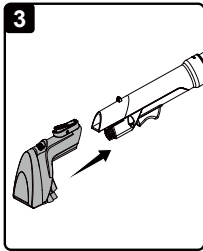
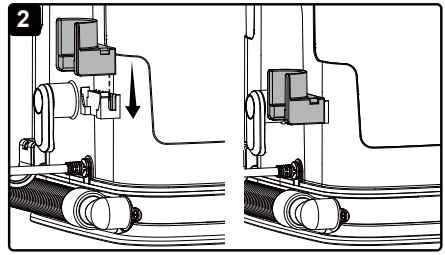
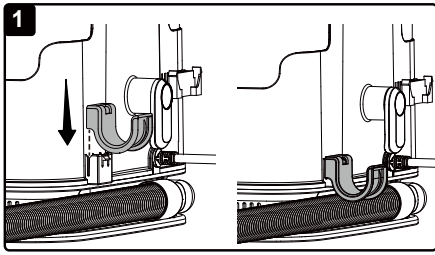

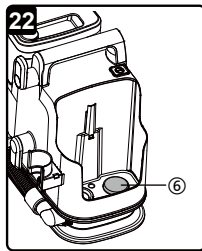
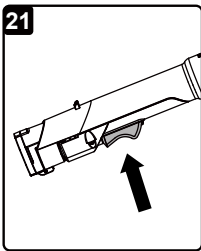
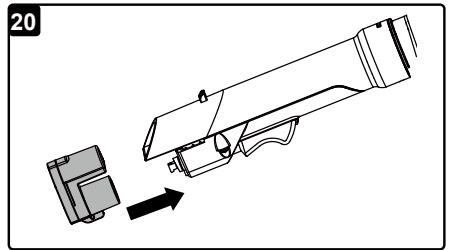
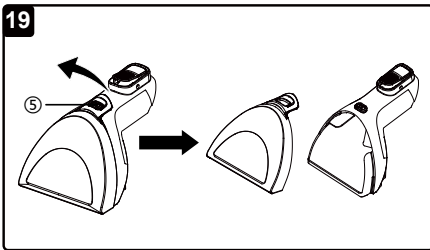
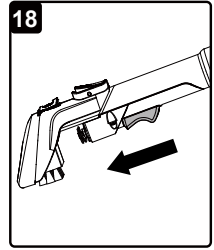
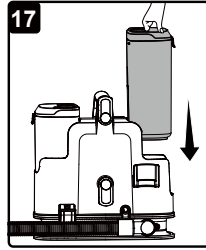
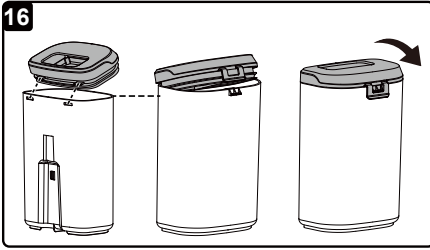
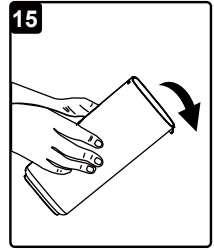
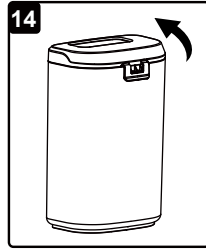
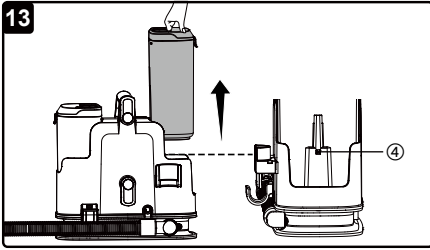



FSC

www.fsc.org

RECYCLED

**Paper made from
recycled material**

FSC® C140878

SCB0501 01
Suzhou Cleva Electric Appliance Co., Ltd.
No.8 Ting Rong Street
Suzhou Industrial Park, Suzhou
Jiangsu Province, China
www.cleva-europe.com
Made in P.R.C