



LED Dimmer 5W-150W

Product Specification

Model: ART-LDM**

Min Load: 5W

Voltage: 220-240V

Max Load: 150W

Warning: Do not overload the LED Lamps. This switch has overload protection; should occur the integrated circuit will automatically trip.

This Dimmer has been developed specially for Dimmable LED Lamps. It's small size allows for installation in 1-4 Gang front plates and is made using the latest technology to ensure that the light will not flicker at the maximum level. Please keep these instructions for your reference, as you may need to refer to them if you change your lights to a different type at a later date.

Loading: Dimmable LED GU10 and dimmable lighting fixtures (non-dimmable LED lights must NOT be used in the same circuit as this will affect the dimming performance).

INSTALLATION

PLEASE READ THESE INSTRUCTIONS CAREFULLY. INCORRECT INSTALLATION MAY DAMAGE THE DIMMER.

1. Switch off the mains power supply before commencing any installation.
2. If removing the existing switch, disconnect the wiring from the switch terminals at the rear and take note of the present wiring of the switch and the marking on the terminals.
3. Ensure that any mounting box is free of plaster lumps or projecting screw heads. Most models can be fitted into a box with a minimum depth of 25mm.
4. Terminate the dimmer switch in accordance with the diagrams in the WIRING section below. Take care that no bare wires project out of the terminals.

Keep wires together in a terminal if they were together in your old switch.

5. After connecting the wires screw dimmer in to the wall box ensuring no wires are trapped between the plates and wall box. Secure with the two screws provided. Do not overtighten the fixing screws.

6. Once installation is complete, turn on the mains supply. When using the dimmer for the first time, you might need to set the min and max brightness as well. Please see **OPERATION** for instructions on how to do this.

trendiswitch.com

OPERATION

Factory Reset

When the dimmer is being used for the first time, or the lights have been replaced, a factory reset action may be required to get the optimal dimming performance.

Resetting the Min. Level:

1. Switch on and set the dimmer knob to the MINIMUM position (turn the knob full anti-clockwise).
2. Push the knob 8 times.
3. The lights will raise and lower the brightness twice, to show that the dimmer is now in configuration mode. It will then either stay at a low brightness or turn off.

Adjust the Min. Level:

1. After the factory reset, slowly adjust the brightness to a level you are satisfied with. Leave the dimmer knob in this position.
2. Push the knob 4 times until the lights raise and lower the brightness once. This will save the setting.

trendiswitch.com

DISPOSAL INFORMATION

Should you want to dispose of this item please **DO NOT** put it with household waste. Used electrical and electronic equipment and batteries must be made available for separate collection. Electrical products may contain toxic materials such as lead or cadmium. Separate collection allows materials to be recovered and recycled. Private households may return their used electrical equipment to designated collection facilities free of charge. Facilities are usually available at the municipal waste site, your electrical retailer or your local authority may provide separate collection from household. By disposing of this product correctly you will be providing positive help to the environment.

SAFETY FIRST

- BEFORE STARTING ANY ELECTRICAL WORK ALWAYS SWITCH OFF AT THE MAINS
- IF IN DOUBT CONSULT A QUALIFIED ELECTRICIAN



TRENDI SWITCH LTD, PO BOX 890, FOREST ROW,
EAST SUSSEX, RH19 9LX, UNITED KINGDOM

Email: sales@trendiswitch.com - Tel +44(0)203 589 9520

trendiswitch.com

WIRING

This dimmer switch is suitable for 1-way or 2-way lighting circuits. There are three terminals per module.

1-way Circuits:

In 1-way lighting circuits, each lamp is controlled by one dimmer switch. Follow the wiring in Figure 1. COM live supply, L1 Load 2, L2 Load 2.

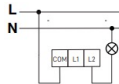

Figure 1

2-way Circuits:

When controlling the load from two positions, it is only possible to have one dimmer switch. The other needs to be a two-way switch. 2-way lighting circuits have two switches turning the same lamps on and off from two different locations (EG. At the top and bottom of the stairs). Follow the wiring in Figure 2.

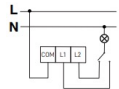
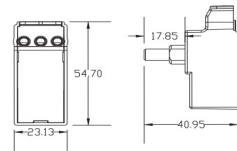
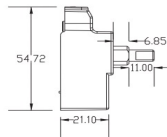

Figure 2

trendiswitch.com

DIMENSION



trendiswitch.com