

Car Roof Bag
AT6117

USA office: Fontana

GBR office: Ipswich

AUS office: Truganina

If you're having difficulty, our friendly customer team is always here to help.



USA:cs.us@costway.com
AUS:cs.au@costway.com
GBR:cs.uk@costway.com

THIS INSTRUCTION BOOKLET CONTAINS **IMPORTANT** SAFETY INFORMATION. PLEASE READ AND KEEP FOR FUTURE REFERENCE.



Before You Start

- ⚠ Please read all instructions carefully.
- ⚠ Retain instructions for future reference.
- ⚠ Separate and count all parts and hardware.
- ⚠ Read through each step carefully and follow the proper order.
- ⚠ We recommend that, where possible, all items are assembled near to the area in which they will be placed in use, to avoid moving the product unnecessarily once assembled.
- ⚠ Always place the product on a flat, steady and stable surface.
- ⚠ Keep all small parts and packaging materials for this product away from babies and children as they potentially pose a serious choking hazard.

PACKAGE DETAILS



CAR ROOF BAG WITH 10 REINFORCED STRAPS *1



DOOR HOOKS *6



NON-SLIP MAT *1



DRAWSTRING STORAGE BAG *1

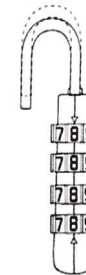

BONUS LOCK *1

USE SCENARIO 1 : Rooftop bag for vehicles without roof racks

- Step 1: Inspect car roof bag for any missing strap or damage
- Step 2: Unfold car roof bag with bottom side facing upward
- Step 3: Attach the grip hooks to your vehicle

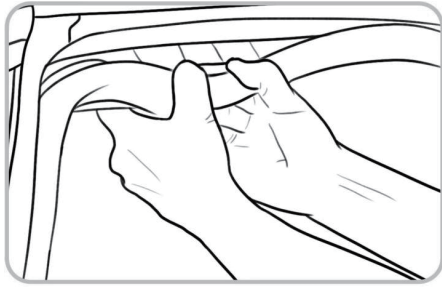

Gently peel back the door frame rubber seal

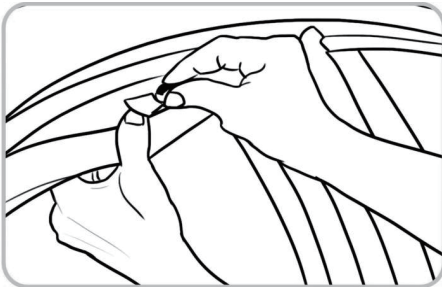

Attach the grip hook directly onto the door frame



Pull the looped strap upward

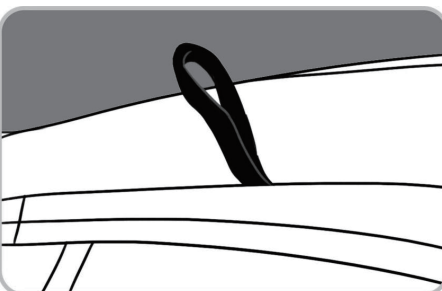

Restore the rubber seal against the door frame

Step 4: Clean the roof of vehicle, place the non-slip mat on roof and make sure the mat in the center of vehicle roof

Step 5: Once the mat in the proper position, carefully place the car roof bag on the top of mat, always face the side with no zipper towards the front of the vehicle

Step 6: Zipper the carrier and load cargo in the bag. Place heavy, large objects in first. This may require partner to help you. Continue loading lighter items on the top creating compact load

Step 7: Close the zipper and fold the flap to completely cover the entire zipper and secure

Step 8: Straps placement

Step 9: Run one end of the strap through hook and back to buckle. Tighten the straps equally on all six hooks

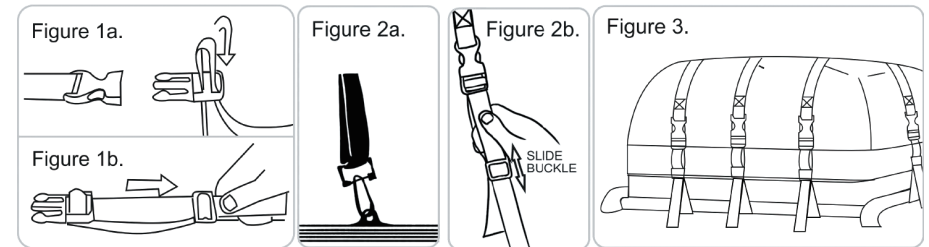

Step 10: Check that the carrier is secure

Once all buckles have been secured, check it by moving it forward and back and side to side. If car roof bag is able to move on the side, then tighten the straps from the pack to the side. If items in cargo are moving excessively, tighten the straps buckles until movement has minimized.

USE SCENARIO 2: Rooftop bag for vehicles with roof racks

Step 1: Inspect car roof bag for any missing strap or damage

Step 2: Unfold car roof bag with bottom side facing upward

Step 3: Determine what type of roof rack your vehicle has, the top of vehicle matches the image (Side Rails/ Crossbars / Basket).

Side Rails

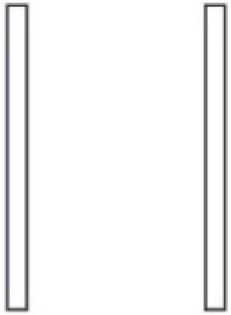

Crossbars

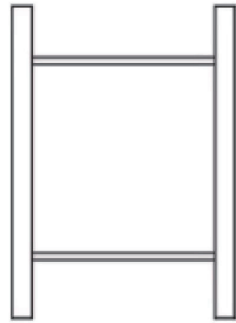

Basket

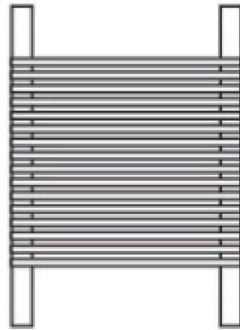

Step 4: Clean the roof of vehicle, place the non-slip mat on roof and make sure the mat in the center of side rails, crossbars or basket

Step 5: Once the mat in the proper position, carefully place the car roof bag on the top of mat, always face the side with no zipper towards the front of the vehicle

Step 6: Zipper the carrier and load cargo in the bag. Place heavy, large objects in first. This may require partner to help you. Continue loading lighter items on the top creating compact load .

Step 7: Close the zipper and fold the flap to completely cover the entire zipper and secure

Step 8: Straps placement

Step 9: Run one end of the strap through hook and back to buckle. Tighten the straps equally on all six hooks

Step 10: Check that the carrier is secure

Once all buckles have been secured, check it by moving it forward and back and side to side. If car roof bag is able to move on the side, then tighten the straps from the pack to the side. If items in cargo are moving excessively, tighten the straps buckles until movement has minimized.

NOTICE

- DO NOT use if any damage or wear is showing on bag, straps or latches.
- DO NOT machine wash or dry. To clean, use mild soap and water, dry by open air.
- DO NOT exceed vehicle manufacturer's roof rack rating.
- DO NOT exceed speed limit. If you hear a flapping noise when driving, immediately pull over and check to make sure all straps are secure and tight.
- DO NOT attempt to remove the bag from the roof of your vehicle when something in the bag.
- This product will NOT prevent dents resulting from improper loading, securing, or driving.
- If bag is damp, air dry before folding or storing to prevent mildew. Do not store in direct sunlight for long periods of time.
- Zipper is NOT to face the front of the vehicle, this will reduce water resistance.
- Minimum of six straps must be used at all times! Use six straps on all hooks and rest four straps to secure the bag after cargo is loaded.

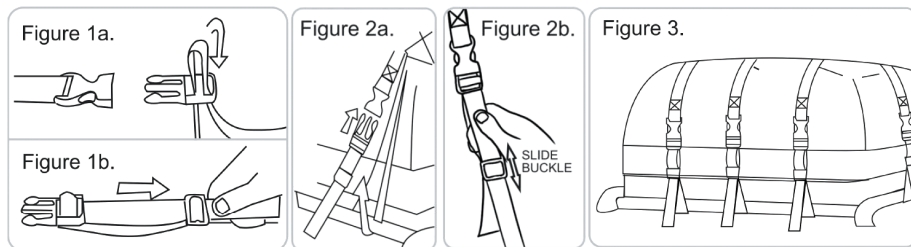

RESETTING PASSWORD FOR BONUS LOCK

How to reset password?
(NOTE: The initial password is 0000)

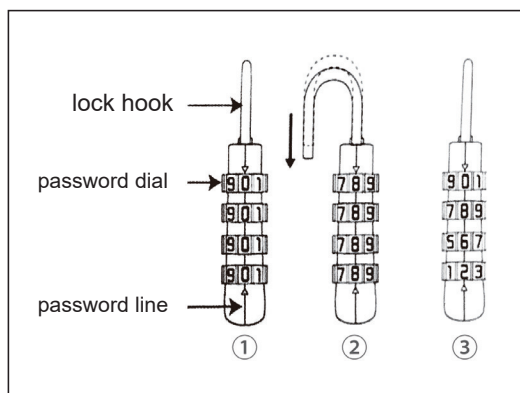

1. Adjust the password to the initial password 0-0-0-0 and align the password line.
2. Lift the lock hook, turn it 90 degrees counterclockwise, press the lock hook firmly and dial the code wheel to select the four-digit number password you need, and align the numbers towards two small triangles on each side.
3. Lift the lock hook back, lock it normally, dial the password, and the new password is set successfully.



Return / Damage Claim Instructions

- ⚠ **DO NOT discard the box / original packaging.**
In case a return is required, the item must be returned in original box. Without this your return will not be accepted.
- ⚠ **Take a photo of the box markings.**
A photo of the markings (text) on the side of the box is required in case a part is needed for replacement. This helps our staff identify your product number to ensure you receive the correct parts.
- ⚠ **Take a photo of the damaged part (if applicable).**
A photo of the damage is always required to file a claim and get your replacement or refund processed quickly. Please make sure you have the box even if it is damaged.
- ⚠ **Send us an email with the images requested.**
Email us directly from marketplace where your item was purchased with the attached images and a description of your claim.