



Inflatable Water Slide

THIS INSTRUCTION BOOKLET CONTAINS IMPORTANT SAFETY INFORMATION. PLEASE READ AND KEEP FOR FUTURE REFERENCE.



OP70640

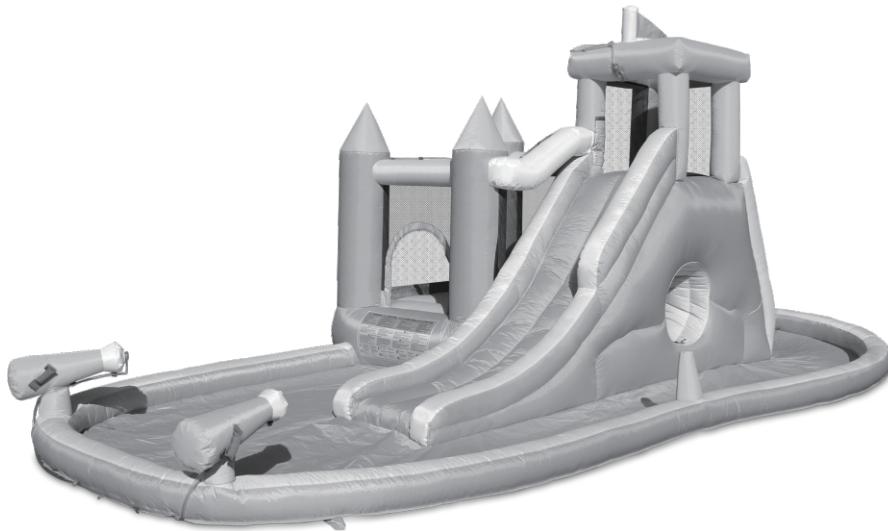

OP70708GB

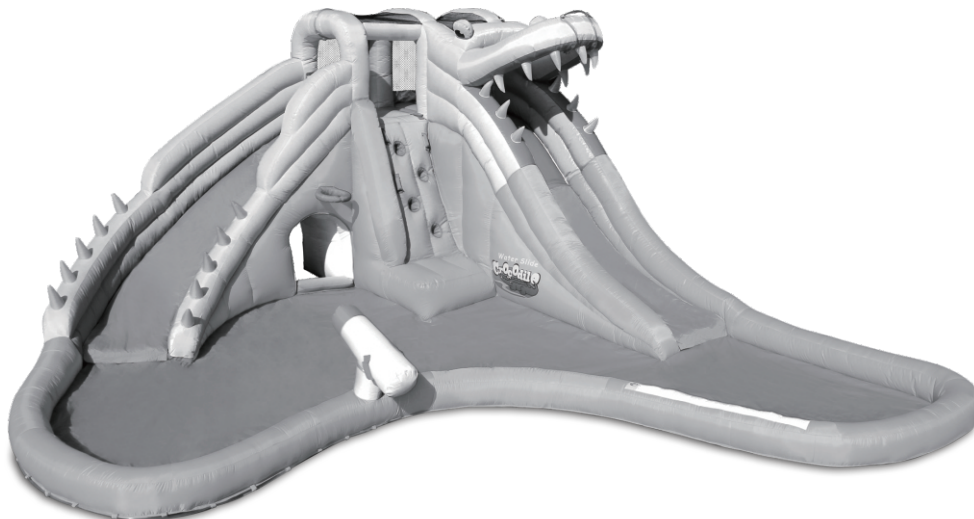

NP10314GB

JAN049-E



Before You Start

Please read all instructions carefully and keep it for future reference.

General Warnings

- ⚠ Danger! Keep all small parts and packaging materials for this product away from babies and children, otherwise they may pose a choking hazard.
 - ⚠ The product must be installed and used under the supervision of an adult.
 - ⚠ Read through each step carefully and follow the proper order.
 - ⚠ Remove all packaging, separate and count all parts and hardware before installation.
 - ⚠ Please ensure that all parts are correctly installed, incorrect installation can lead to a danger.
 - ⚠ We recommend that, where possible, all items are assembled near the area in which they will be placed in use, to avoid moving the product unnecessarily once assembled.
 - ⚠ Ensure a secure surface during installation, and place the product always on a flat, steady and stable surface.
-

• SET-UP

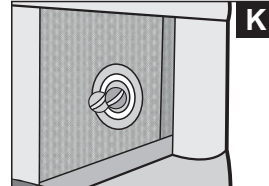
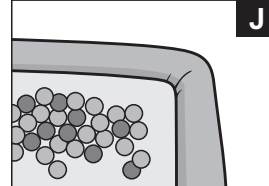
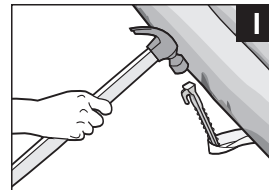
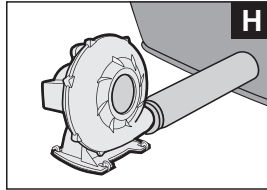
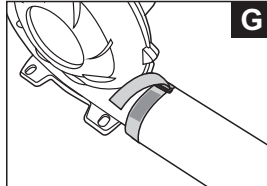
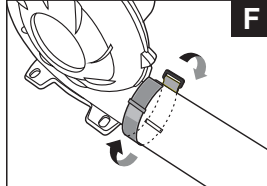
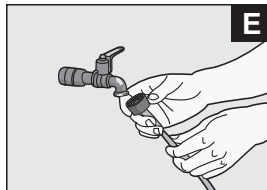
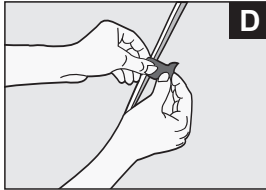
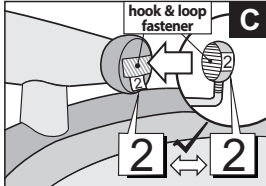
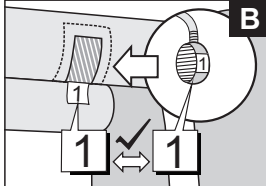
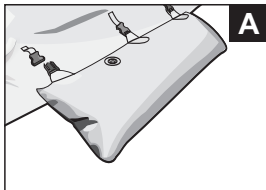

• TAKE DOWN

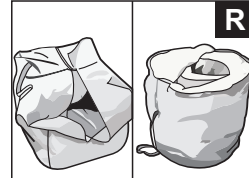
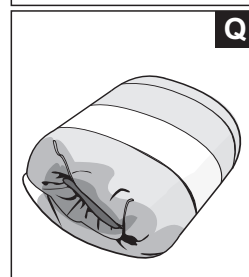
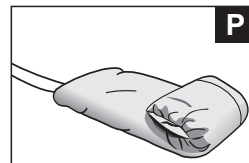
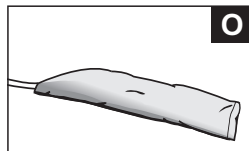
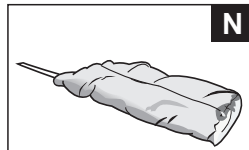
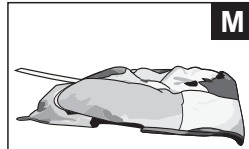
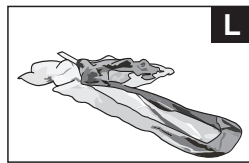

• REPAIR

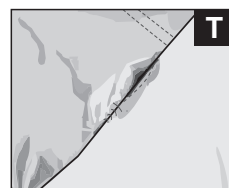

■ WATER SLIDE

KEEP THE INSTALLATION INSTRUCTION FOR FUTURE REFERENCE
 PLEASE READ ALL OF THE SAFETY RULES BEFORE SETTING UP
 WE BELIEVE IN SAFETY FIRST. PLEASE FOLLOW ALL OF THE RULES FOR YOUR
 CHILDREN'S SAFETY

WARNING! ELECTRICALLY OPERATED PRODUCT

ADULT SUPERVISION REQUIRED. OPERATING BLOWER (AIR PUMP) NOT
 RECOMMENDED FOR CHILDREN UNDER 18 YEARS OF AGE. AS WITH ALL
 ELECTRIC PRODUCTS, PRECAUTIONS SHOULD BE OBSERVED DURING
 HANDLING AND USE TO PREVENT ELECTRIC SHOCK.

CAUTION:

- ⚠ NOT SUITABLE FOR ADULTS
- ⚠ ADULTS MUST NOT USE THIS PRODUCT
- ⚠ NOT SUITABLE FOR HIRING OR COMMERCIAL USE
- ⚠ ADULT SET-UP REQUIRED
- ⚠ ADULT SUPERVISION REQUIRED
- ⚠ WARNING! ONLY FOR DOMESTIC USE. OUTDOOR USE
TO BE USED ON SOFT GROUND ONLY
- ⚠ KEEP THIS INFORMATION
- ⚠ WARNING! CHOKING HAZARD. SMALL PARTS.



WARNING!



Not suitable for children
 under 3 years. Small parts
 may be swallowed.

Key information for users

Age range	Maximum number of players at a time for the whole product	Maximum number of players at a time for the inflatable part	Maximum individual weight	Maximum total weight for the inflatable part	Minimum individual height	Maximum individual height	Item No.
3-10 years	4	3	45kg	135kg	90cm	150cm	OP70640
	6	3	45kg	135kg	90cm	150cm	OP70708GB / NP10314GB

SET-UP

- Check the ground where the product will be set up for any sharp objects or debris. Do not install the product over concrete or any hard surface.
- Place the product on a soft level surface at least 2 meters from any structure or obstruction such as a fence, garage, and house; overhanging branches, laundry lines or electrical wires.
- Ensure the play area is free from hazards such as furniture, walls, sharp objects, other hard surfaces, etc.
- Set up the product away from water and any potential fire hazards.
- Keep the blower (air pump) and power cord away from areas of water and moisture. If water contacts the blower (air pump), unplug the blower (air pump) power cord. Do not operate until the blower is completely dry.
- Remove the product from the carry bag. If any, ensure the slide cover coming with the product stretches well from top to end. Be sure to place as close to the power source as possible.
- Stretch the inflation tube and attach it to the end of the blower (air pump). Ensure the inflation tube is securely attached and in good condition. The inflation tube should be straight and untwisted. Reposition the blower (air pump) if necessary.
- If the product comes with water bags, please follow the undermentioned instruction, otherwise, overleap this point. Spread out the product, place and fasten the empty water bags at the two sides of the product. Open the stopple and fill water in the water bags until 80% full (about 22kg), push and close the stopple. make sure water bags are firmly attached on the product and no water leakage before the product is fully inflated, and never allow children to play on the slide without installing water bags. (refer to picture A)
- If the product comes with dry and wet play functions, please follow the below steps:
 - * For dry play, skip the following mentioned point and go to the point under the picture A, B, C, D, E to continue the set-up.
 - * For wet play, note the number on the sprayer nozzle, and affix the sprayer nozzle to the corresponding number of hook & loop fastener on the product. (refer to picture B, C). Attach the hose to water supply, turn on the water supply when the product is fully inflated. (refer to picture D, E)
- Push ground stakes through blower base holes. You may need to use a hammer for proper placement.
- Make sure the blower (air pump) power switch is in the OFF position. Ensure the power connections are safely sited and tripping hazard is minimized.
- Place the inflation tube onto the blower (air pump) and place the long end of the strap through the loops. Wrap the strap around the inflation tube and feed it through the black loop. (refer to picture F). Pull the strap tightly and secure the reverse side to the black loop and affix it to the hook & loop fastener. Adjusting the direction of the inflation tube to prevent bends or distortion that may impede the flow of air. (refer to picture G).
- The blower (air pump) should be securely sited and affixed to the ground before use. Plug the blower (air pump) into an approved grounded outlet.
- Ensure the blower (air pump) is free from debris and securely sited to avoid tripping.
- Turn the blower (air pump) power switch to ON. The continual air-flow blower (air pump) must be left ON at all time while the product is being used. (refer to picture H)
- The product should be fully inflated.
- Ground support stakes are used for lawn ground surfaces. Hook and fit each provided ground stake through each loop in the bouncer. To prevent overturn or lift during playing, push stakes firmly into the soil. Make sure the hooked end of the stake is over the loop. The stakes should be placed level with or under the ground in order to reduce tripping hazards. (refer to picture I)
- Please check the age recommendation and user weights (printed on the product). You must not exceed the total weight for the product.
- Put the included play accessories if any for playing into the product. (refer to picture J, K)
- If the product comes with support cushions at the sides, do not stand or sit on the cushions.
- Make sure the water slide is fully inflated before children enter to play.
 - Hint: Air leak from the seams is necessary because the product is inflated by constant air flow and this leakage is required to stop the product becoming over-inflated.
 - Hint: It is drawn user's attention to the orientation of the inflatable equipment installation in relation to the sun. The sliding surface of the product shall not face to the sun as sunshine can glare the children's eyes when they are sliding down along the slide.
- It is normal that some water leaks from the edge of splashing pool.

TAKE DOWN

- Make sure all children exit the product.
- Make sure the product is free from foreign objects.
- If the product comes with water bags, please follow the undermentioned instruction, otherwise, overleap this point.

Detach the water bags from the product. Remove the product and blower before opening the stopple for draining.
Empty water in the water bags and dry them in cool place for next time's use.

- Turn off the water supply, and empty water in the pool at the end.
- Turn the blower (air pump) power switch to OFF.
- Unplug the blower (air pump) power cord.
- Loosen the hook & loop fastener and detach the inflation tube from the blower.
- The product should deflate on its own within 5 minutes. Make sure the product is entirely deflated. (refer to picture L)
- Remove ground support stakes.
- Fold the product in half from both ends, and then fold it in half 2 more times from both sides, vertically to the first fold. (refer to picture M, N, O)
- Roll it up tightly from the end opposite the inflation tube. (refer to picture P, Q)
- Slip the carry bag over the folded product and stakes (plastic balls or water bags). Zip the bag. (refer to picture R)

MAINTENANCE

- ▶ Checks and maintenance of the main parts of the toys should be carried out at regular intervals, if these checks are not carried out, the toys could overturn or otherwise become a hazard. Whenever practical, the instructions shall also be affixed to the toy.
- ▶ The seasonal inspection and maintenance should be conducted for any damage or leakage of the product.
- ▶ The product can be wiped clean with a mild detergent. Keep water away from the blower (air pump) at all times.
- ▶ Do not store the product when wet. Store the product and the blower indoors in dry conditions when not in use.

REPAIR

In case of any breakage of product, please patch up through hand sewing. Each type of product is provided with a repair kit which includes six pieces of cloth (in three colors; each color has two pieces) and three 20-meter long threads of different colors. Sewing needles are not provided and you should purchase by yourself (3# sewing needle is suggested).

- Turn off air blower and deflate the product.
- Thread a needle with a spare thread and tie a knot at its end.
- Close up the broken cloth and sew along the gap. Tie a knot after sewing to avoid loose thread.
- * In case of cloth breakage (as shown in picture S), please cover the breakage with a piece of patching cloth of proper size. Then sew up the patching cloth along its sides. While repairing, you should take notice that the sewing should only occur on the surface layer of the original cloth rather than reaching its underlayer.
- * In case of breakage in the seam position (as shown in picture T), the sewing should only occur between the two split cloth rather than reaching the underlayer or any other cloth.
- * In case of large-size breakage or internal structural damage, please change product or have professionals do the repairing. Air leakage is normal in the repaired position and air pressure of the repair product maybe lower than the original. But it will not affect the normal use of the product.
- Patching in one position for more than twice is not suggested.
- Needles should be taken good care of and not be left on the product after sewing.
- It is suggested that persons with sewing technique should do the repairing work.

WARNING

- Failure to follow the specified instructions could result in serious injury.
- Keep the product a safe distance (at least 2 m) from fire, walls and other obstructions.
- The product may not be used outside in rainy and/or lightning conditions or if winds exceed 40km/h (25 MPH). Sudden gusts of wind may lift the product off the ground.
- The product must be fully inflated before any children are allowed inside. The product must stay fully inflated until everyone is out.
- If the product begins to deflate, remove all children and check for disconnection of power cord or for power outage.
- Do not drag on concrete or other rough surfaces.
- Unauthorized modification of the product is not allowed.
- Product should be checked regularly for potentially unsafe conditions such as damaged cord, plug, housing, or parts.

If such damage is found, the product should not be used until properly repaired.

- To reduce the risk of fire or electric shock, do not use the blower with any solid-state speed control device.
- Check stakes regularly during playing to ensure they remain secure in the ground.
- The carry bag is not a TOY, but for storage use only.
- Adult set-up and dismantling are required. Adult supervision is required at all times while the product is in use.
- Ages and sizes of children playing in the product at the same time should be comparable. Not suitable for children under 3 years. Small parts may be swallowed. Never leave your child unattended-drowning hazard.
- Keep children and pets away from the blower (air pump).
- Individuals with head, neck, back or other muscular-skeletal injuries or disabilities, small infants, pregnant women and others who may be susceptible to injury from falls, bumps or bouncing are not permitted in the product.
- Shoes, eyeglasses, jewelry and any hard or sharp objects that may cause injury must be removed before entering the product. Loose or baggy clothing or clothing containing long cords should not be worn whilst playing on this product. If the product comes with the slide, wearing socks, long sleeves, and long trousers is needed to guarantee SAFETY.
- To prevent choking, children may not enter the product while eating, drinking, or chewing anything in their mouth.
- Never slide down head first to avoid the risk of serious injury or death. Keep arms away from the two sides of the slide when sliding down to avoid a risk of skin injuries.
- Remove all packaging materials before giving to children.



Do not touch the two sides of the slide



Never slide down head first

- Children are required to slide down with proper posture (refer to the following pictures) when playing on the product with slide.



1
Sit on the platform
Do not stand up



2
Cross your hands over
chest before sliding down

or



Slide with arms UP
on this slide



3
Sliding finish

- No flipping, wrestling, running, or pushing is allowed inside the product.
- Do not bounce on the edges, steps. Climbing or hanging on the walls, netting or exterior of the product is not allowed.
- Children can drown in very small amounts of water. Empty the pool when not in use. Do not install the paddling pool over concrete, asphalt or any other hard surface.
- Any modifications of the original toy whether by making an addition to the apparatus or replacing part of it must adhere to the instructions provided by the retailer of the original toy.
- Checks and maintenance operations must be made on the principal parts of the toy (transversal bars, hangers, ground fastenings..) at regular intervals. In absence of these checks, the toy might flop over or become a danger.
- Changes to the original toy shall be carried out according to the instructions of the retailer of the original toy.
- Change the water of paddling pool frequently (particularly in hot weather) or when noticeably contaminated.
- Install the fastenings on the ground and follow the instructions carefully in order to avoid risks of knocking over or the raising of parts of the structure that might occur during normal use or foreseeable wrong use.
- The fastenings to the ground must be placed at ground level or under ground in order to avoid risks of stumbling according to instructions supplied on the assembly notice.
- Replace defective components in accordance with the manufacturer's instructions.
- Do not position the toy facing the sun.
- In case of injury, contact a physician immediately.



WARNING!

⚠ CHILDREN HAVE DROWNED IN PORTABLE SWIMMING POOLS.

⚠ ENSURE ACTIVE ADULT SUPERVISION AT ALL TIMES.

⚠ DO NOT LEAVE CHILDREN UNSUPERVISED IN OR AROUND THE POOL - KEEP THEM WITHIN ARMS' REACH.

⚠ EMPTY AND STORE SAFELY AFTER USE.

Warning! Never leave your child unattended – drowning hazard”

EN: Colors, measurements and details may vary from packaging. The product measurements shown on the packaging may vary up to ± 10 cm due to the products' being hand made. Ft and inch measurements are calculated from the metric sizes and are only an approximate calculation.

FDS Corporation Limited
Unit 4, Blackacre Road, Great Blakenham
Ipswich, Ip6 0FL
United Kingdom

Made in P.R.C.



Return / Damage Claim Instructions



DO NOT discard the box / original packaging.

In case a return is required, the item must be returned in original box. Without this your return will not be accepted.



Take a photo of the box markings.

A photo of the markings (text) on the side of the box is required in case a part is needed for replacement. This helps our staff identify your product number to ensure you receive the correct parts.



Take a photo of the damaged part (if applicable).

A photo of the damage is always required to file a claim and get your replacement or refund processed quickly. Please make sure you have the box even if it is damaged.



Send us an email with the images requested.

Email us directly from marketplace where your item was purchased with the attached images and a description of your claim.

USA office: Fontana

GBR office: Ipswich

AUS office: Truganina

If you're having difficulty, our friendly customer team is always here to help.



USA:cs.us@costway.com

AUS:cs.au@costway.com

GBR:cs.uk@costway.com