

USA office: Fontana      AUS office: Truganina

GBR office: FDS Corporation Limited, Unit 4, Blackacre Road, Great Blakenham, Ipswich, Ip6 0FL, United Kingdom

If you're having difficulty, our friendly customer team is always here to help.



USA: [cs.us@costway.com](mailto:cs.us@costway.com)  
AUS: [cs.au@costway.com](mailto:cs.au@costway.com)  
GBR: [cs.uk@costway.com](mailto:cs.uk@costway.com)

Movable Laundry Cart

**JZ10267WH**

THIS INSTRUCTION BOOKLET CONTAINS **IMPORTANT** SAFETY INFORMATION.  
PLEASE READ AND KEEP FOR FUTURE REFERENCE.



## Before You Start

- ⚠ Please read all instructions carefully.
- ⚠ Retain instructions for future reference.
- ⚠ Separate and count all parts and hardware.
- ⚠ Read through each step carefully and follow the proper order.
- ⚠ We recommend that, where possible, all items are assembled near to the area in which they will be placed in use, to avoid moving the product unnecessarily once assembled.
- ⚠ Always place the product on a flat, steady and stable surface.
- ⚠ Keep all small parts and packaging materials for this product away from babies and children as they potentially pose a serious choking hazard.

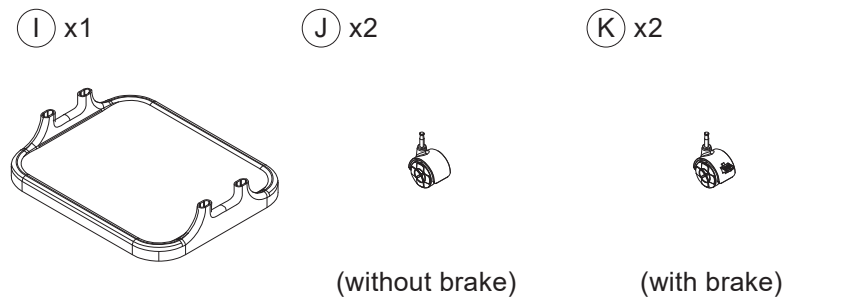
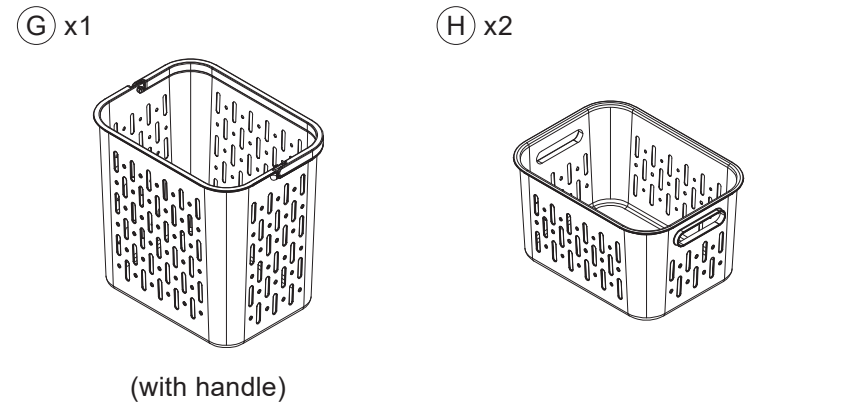
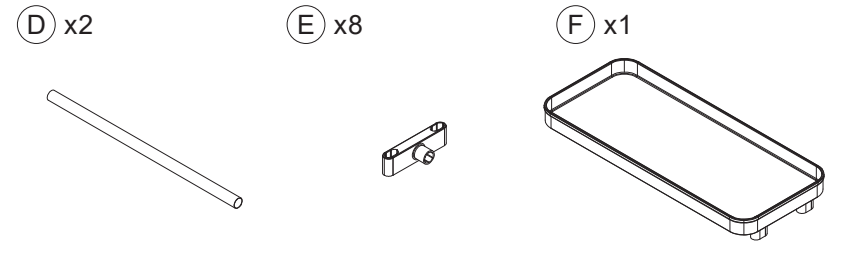
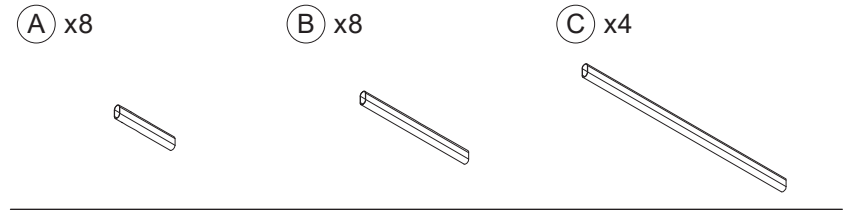

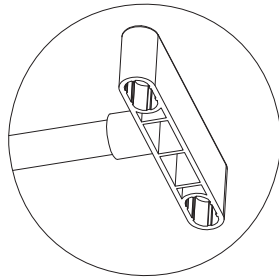
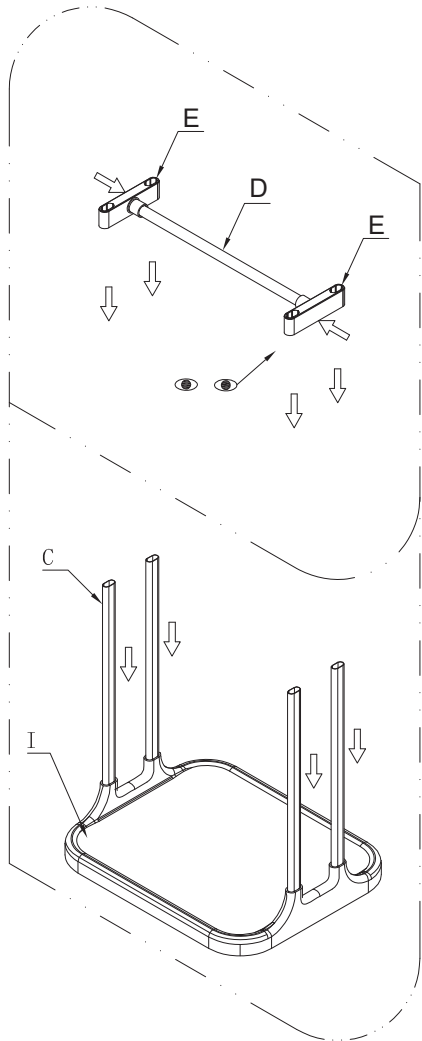
**1**

Looking up (groove downwards)

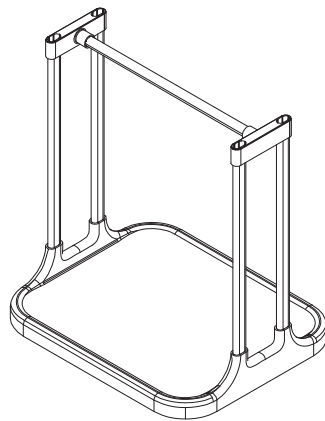
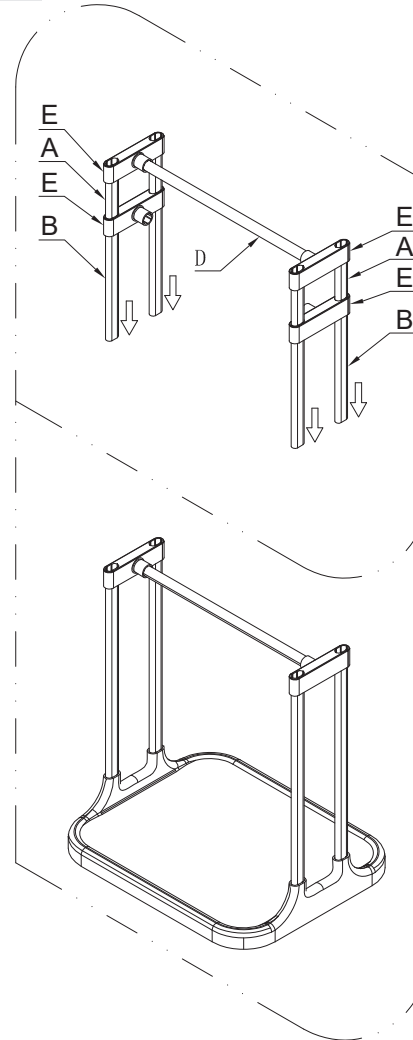
**2**

Connect 2 connectors E with horizontal tube D, and then insert 4 elliptical tubes A into connectors E up and down. Next, insert 4 elliptical tubes B into connectors E, and finally connect the whole into the main frame of STEP1. (Note: the groove of the connector E is facing downwards)

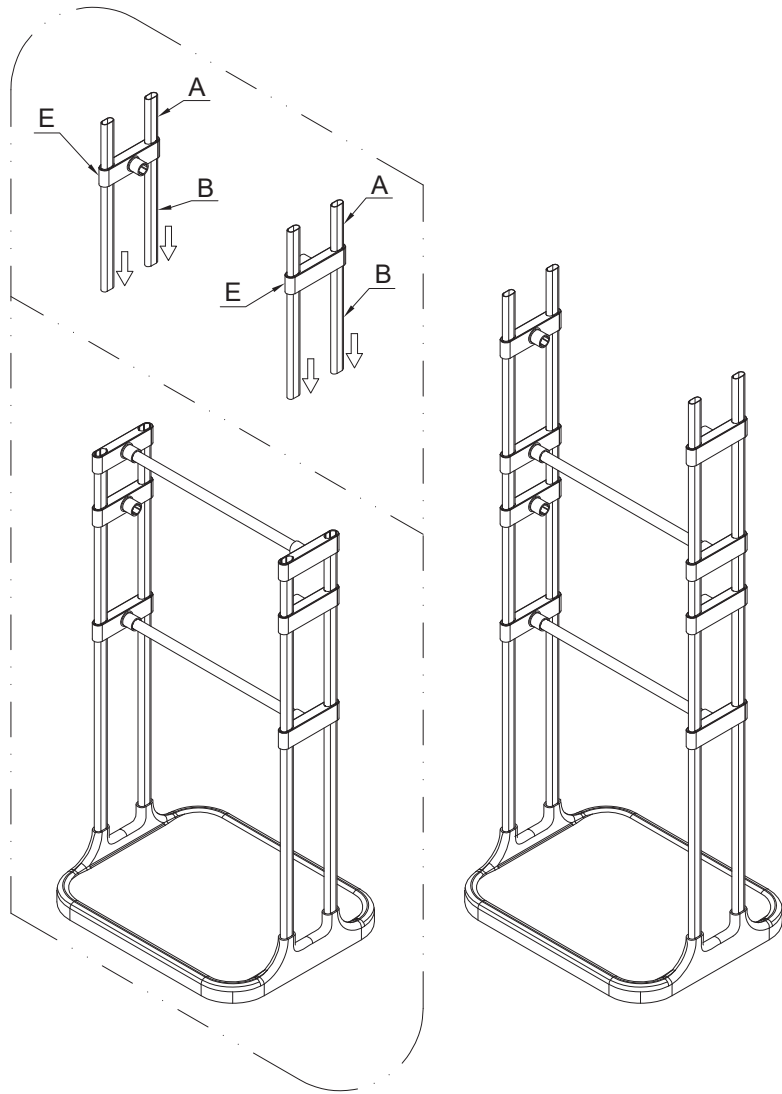
**3**

Connect 2 elliptical tubes A and 2 elliptical tubes B up and down with connectors E (Note: the groove of the connector E is facing downwards), and then align it with the whole part of STEP2.

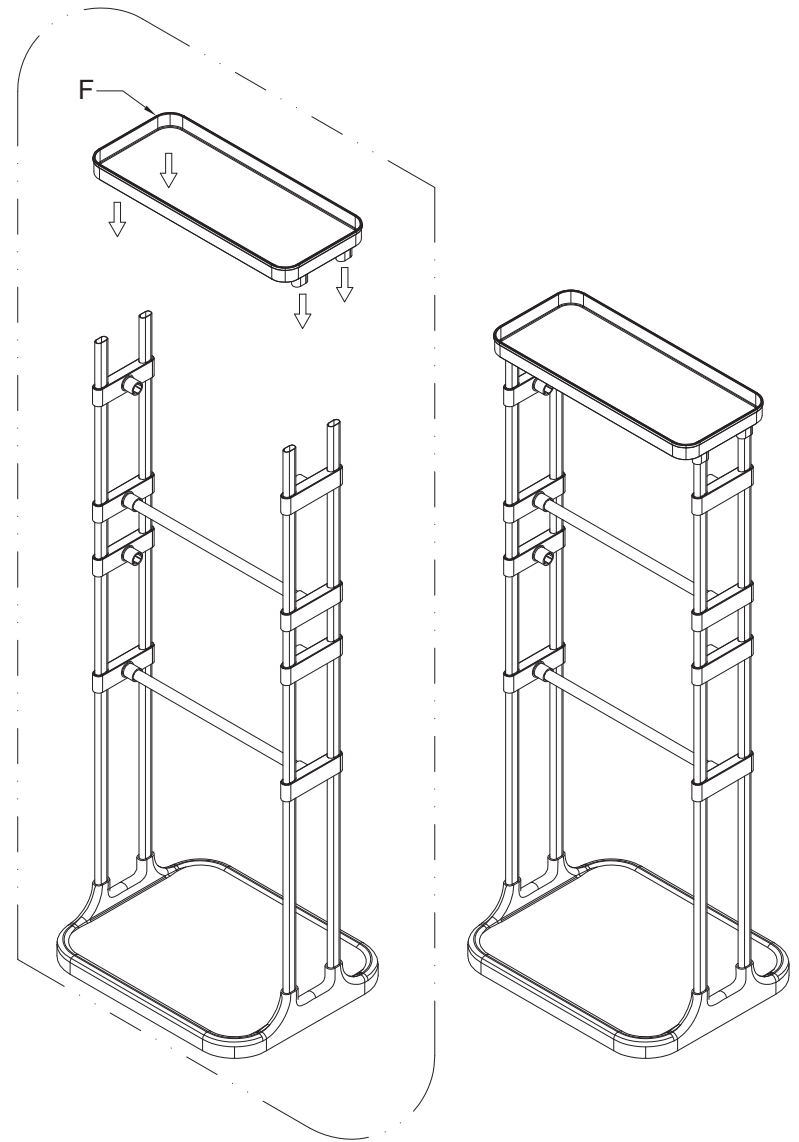
**4**

Align the top basket F with the whole part of STEP3

5

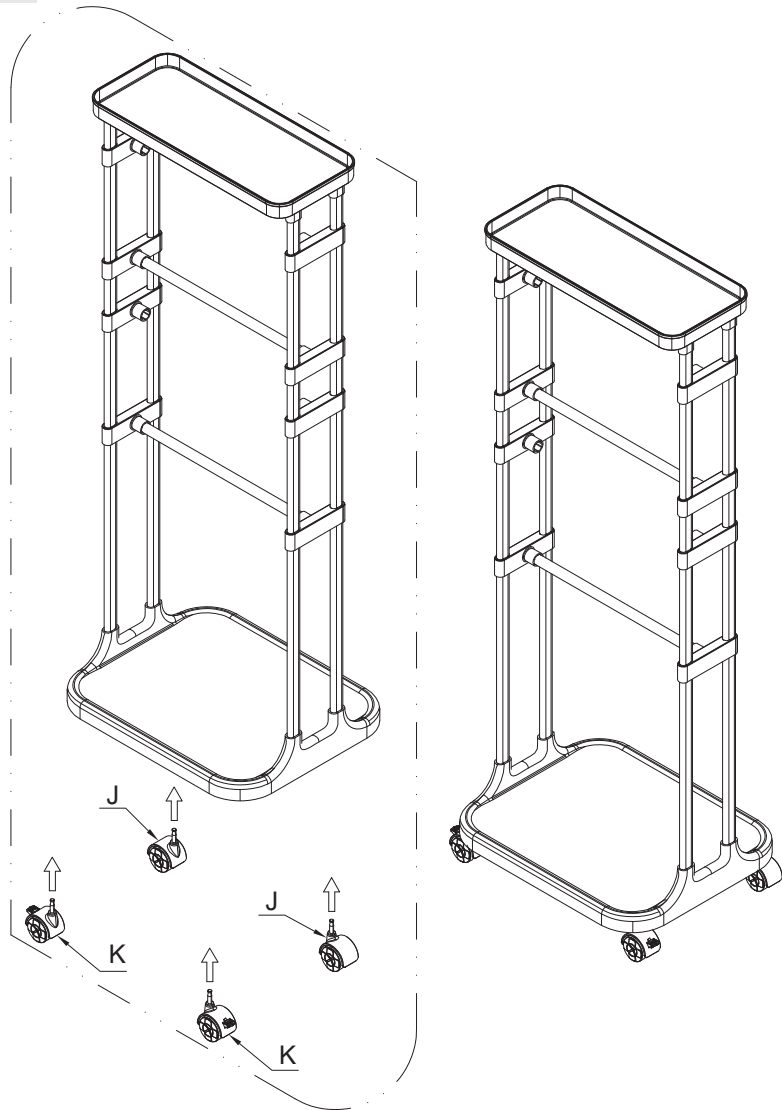

Install the 2 brake wheels K and the 2 non brake wheels J with the base. It is recommended that the 2 brake wheels be in the front (long side) and the 2 non brake wheels be in the back (it is recommended that two people cooperate in installation here)

6

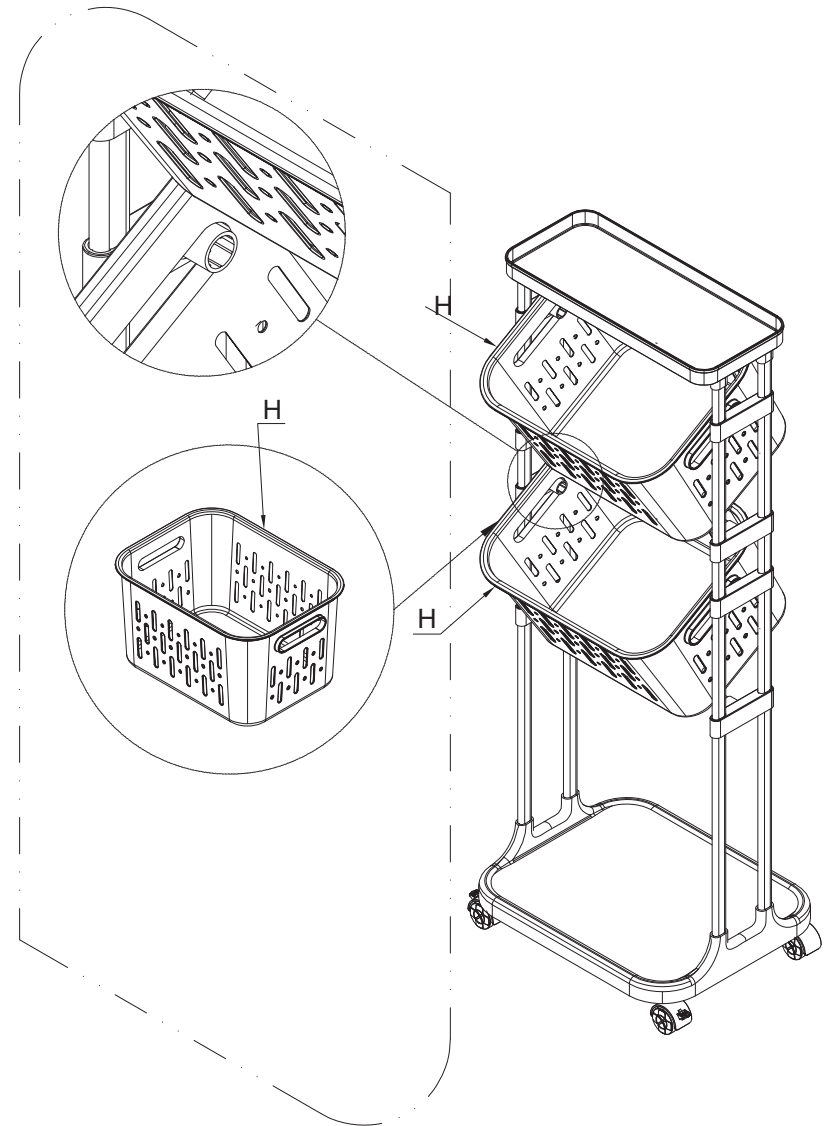

Insert the 2 small baskets H into the connector. (Insert the circular groove at the handle of the small basket into the protrusion of the connector, as shown in the enlarged image)

7

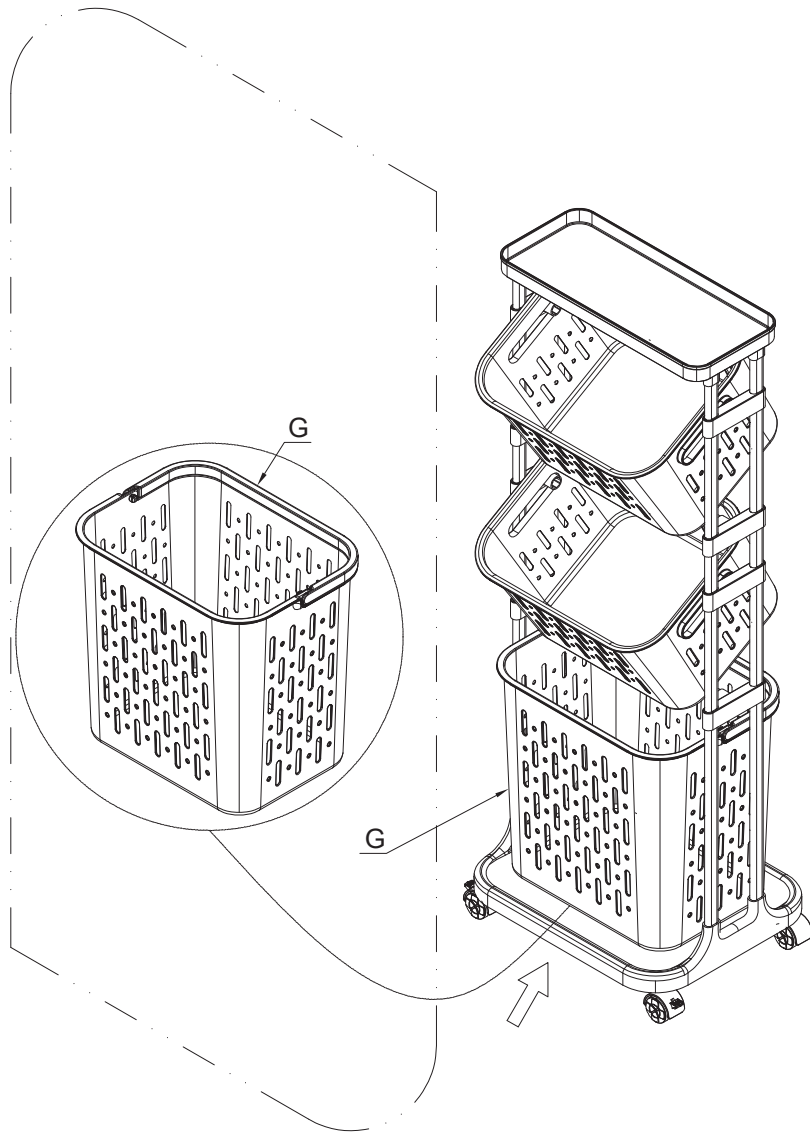

Place the large basket G on the base and complete the installation.



## Return / Damage Claim Instructions

- ⚠ **DO NOT discard the box / original packaging.**  
In case a return is required, the item must be returned in original box. Without this your return will not be accepted.
- ⚠ **Take a photo of the box markings.**  
A photo of the markings (text) on the side of the box is required in case a part is needed for replacement. This helps our staff identify your product number to ensure you receive the correct parts.
- ⚠ **Take a photo of the damaged part (if applicable).**  
A photo of the damage is always required to file a claim and get your replacement or refund processed quickly. Please make sure you have the box even if it is damaged.
- ⚠ **Send us an email with the images requested.**  
Email us directly from marketplace where your item was purchased with the attached images and a description of your claim.