

★★★ TRISTAR

EN User manual



Air Conditioner



AC-5737BS

AC-5739BS

A



B

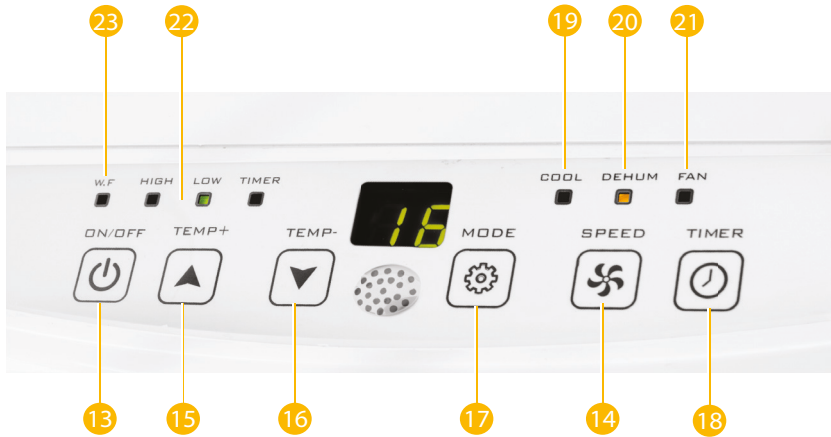

C

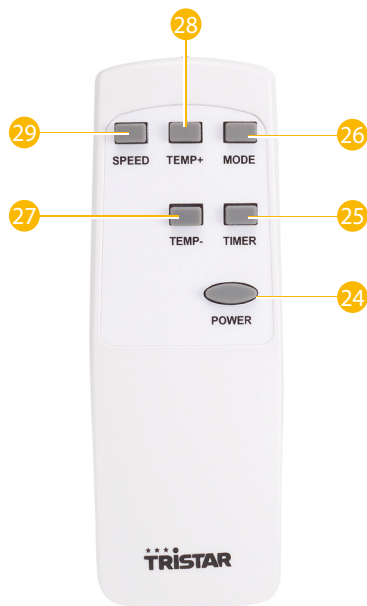

Air Conditioner

Main parts (see image A)

- | | | |
|-----------------|-------------------------------|---|
| 1 Air inlet | 6 Castor | 10 Hose connector (Air conditioner end) |
| 2 Air filter | 7 Drainage hole | 11 Window kit |
| 3 Control panel | 8 Hose connector (window end) | 12 Remote control |
| 4 Power cord | 9 Hot-air exhaust hose | |

Control Panel (see image B)

- | | | |
|---------------------|----------------------------|----------------------------------|
| 13 Power on/off | 18 Timer on/off | 22 High/ Low fan speed indicator |
| 14 Fan speed | 19 Cooling indicator | 23 Water full indicator |
| 15 Temperature up | 20 Dehumidifying indicator | |
| 16 Temperature down | 21 Fan indicator | |
| 17 Mode button | | |

Remote Control (see image C)

- | | |
|-----------------|---------------------|
| 24 Power on/off | 27 Temperature down |
| 25 Timer on/off | 28 Temperature up |
| 26 Mode | 29 Fan speed |

SAFETY

Safety precautions

- Please read this user's manual carefully to ensure proper use, maintenance and installation.
- By ignoring the safety instructions the manufacturer cannot be held responsible for the damage.
- The appliance is for indoor use only.
- Do not use the unit on a socket that is damaged or that has not been installed correctly.
- Do not use the unit:
 - near a source of fire.
 - in an area where oil is likely to splash.
 - in an area exposed to direct sunlight.
 - In an area where water is likely to splash
 - near a bath, a shower or a swimming pool.
- Never insert your fingers or objects into the air outlet. Take special care to warn children of these dangers.
- Keep the unit upright during transport and storage.
- Before cleaning the unit, always turn off or disconnect the power supply.
- Always turn off and disconnect the power supply before moving the unit.

- All the unit sockets must comply with the local electric safety requirements. If necessary please check.
- This appliance can be used by children aged from 8 years and above and persons with reduced physical, sensory or mental capabilities or lack of experience and knowledge if they have been given supervision or instruction concerning use of the appliance in a safe way and understand the hazards involved. Children shall not play with the appliance. Cleaning and user maintenance shall not be made by children without supervision.
- If the supply cord is damaged, it must be replaced by the manufacturer, its service agent or similarly qualified persons in order to avoid a hazard.
- This appliance is only to be used for household purposes and only for the purpose it is made for.

NOTES:

- In the case of any damage, please disconnect the power supply and contact the dealer or a designated repair shop.
- In any case, the power cord shall be firmly grounded.
- To avoid the possibility of danger, if the power cord is damaged, please disconnect the power supply. It must be replaced by the dealer or a designated repair shop.
- The appliance shall be installed in accordance with national wiring regulations.

⚠ WARNING

- Please use the recommended defrosting and cleaning process from the manufacturer only. Do not accelerate the defrosting or cleaning process in any other way.
- The appliance shall be stored in a room without continuously operating ignition sources (for example: open flames, an operating gas appliance or an operating electric heater).
- Do not pierce or burn.
- Be aware that refrigerants may not contain an odor.
- The appliance should be installed, operated and stored in a room with a floor area larger than $X \text{ m}^2$. $X=4$ for 7000Btu/h, $X=7.7$ for 9000Btu/h.
- Only contact an authorized service technician for repair or maintenance of this unit.
- Do not pull, deform or modify the power supply cord or immerse in water . Pulling or misuse of the power supply cord could result in damage to the unit and cause an

electrical shock.

- Compliance with national gas regulations should be observed.
- Keep ventilation openings clear of obstructions.
- Any person who is involved with working on or opening a refrigerant circuit should hold a current valid certificate from an industry accredited assessment authority which authorizes their competence to handle refrigerants safely in accordance with an industry recognized assessment specification.
- Do not stop the unit by pulling out the power plug whilst in operation as this may cause an electric shock or fire due to heat generation unless strange sounds are heard or if strange smells or smoke appear from the unit.

Specific information regarding appliances with R 290 refrigerant gas.

- Thoroughly read all of the warnings.
- When defrosting and cleaning the appliance , do not use any tools other than those recommended by the manufacturing company.
- The appliance should not be stored in a room with continuously operating ignition sources (for example: open flames , an operating gas appliance or an operating electric heater).
- Do not puncture and do not burn.
- This appliance contains Y g (see rating label back of unit) of R290 refrigerant gas.
- R290 is a refrigerant gas that complies with the European directives on the environment. Do not puncture any part of the refrigerant circuit.
- If the appliance is installed, operated or stored in a non-ventilated area, the room must be designed to prevent to the accumulation of refrigerant leaks that could result in a fire risk or explosion due to ignition of the refrigerant caused by electric heaters, stoves, or other sources of ignition.
- The appliance must be stored in such a way as to prevent mechanical failure.
- Individuals who operate or work on the refrigerant circuit must have the appropriate certification issued by an accredited organization that ensures competence in handling

refrigerants according to a specific evaluation recognized by associations in the industry.

- Repairs must be performed based on the recommendation from the manufacturing company. Maintenance and repairs that require the assistance of other qualified personnel must be performed under the supervision of an individual specified in the use of flammable refrigerants.

Batteries

- Do not expose the battery to high temperatures or direct sunlight. Never throw batteries into the fire. There is a danger of explosion!
- Keep batteries away from children. Batteries are not a toy!
- Do not open the batteries by force.
- Avoid contact with metallic objects. (Rings, nails, screws et cetera) there is a danger of short-circuiting!
- As a result of a short-circuit batteries may heat up considerably or even catch fire. this may result in burns.
- For your safety the battery poles should be covered with adhesive strips during transport.
- Do not touch a ruptured and/or leaking battery. If the liquid from the battery gets into your eyes, rinse your eyes as soon as possible with clean water, without rubbing your eyes. Immediately go to the hospital. If it is not treated properly, it can cause eye problems.

FOREWORD

About this document

This user manual contains all the information for correct, safe, and efficient use of the appliance. Ensure you have fully read and understood the instructions in this user manual before you use the appliance.

Always store this user manual in a safe place near the appliance for future reference.

Original instructions







This manual is originally written in English. All other languages are translated documents.

Support

For spare parts and more information about the appliance, please visit www.tristar.eu

General symbols

Symbol	Description
	This product complies with conformity requirements of the applicable European regulations or directives.

Symbol	Description
	The Green Dot is the registered trademark of Der Grüne Punkt – Duales System Deutschland GmbH and is protected as a trademark worldwide. The logo may only be used by customers of DSD GmbH holding a valid trademark usage contract or by engaged waste management companies within the Federal Republic of Germany. This also applies to reproduction of the logo by third parties in a dictionary, an encyclopaedia or an electronic database containing a reference manual.
	The universal recycling symbol, logo, or icon is an internationally recognized symbol used to designate recyclable materials. The recycling symbol is in the public domain and is not a trademark.
	Applicable in France: The product or packaging can be recycled and components must be disposed of separately. Follow the local regulations.
	Applicable in Italy: The product or packaging can be recycled and components must be disposed of separately. Follow the local regulations.
	Indicates that the product complies with UK regulations for safety, health, and environmental protection.
	FSC® logo indicates the paper used is from responsible forestry.

APPLIANCE DESCRIPTION

About this appliance

The Tristar Air Conditioner is a stylishly designed mobile air conditioner.

Control the air conditioner with the included remote and use the convenient timer function to shut off the device automatically.

Intended use

This appliance is intended for indoor use only.

This appliance is intended exclusively for domestic, non-commercial use.

This appliance is intended to be used in household and similar applications such as:

- staff kitchen areas in shops, offices and other working environments;
- farm houses;
- by clients in hotels, motels, and other residential type environments;
- bed and breakfast type environments.

The appliance is not intended to be operated by means of an external timer or a separate remote-control system.

Any use of the appliance other than described in this user manual is regarded as misuse and may cause injury or damage to the appliance and void the warranty.

TABLE AC-5737BS

Information requirements for single and double duct air conditioners			P
Information to identify the model(s) to which the information relates to: AC-5737BS			
Description	Symbol	Value	Unit
Rated capacity for cooling	Prated	2,05	kW
Rated capacity for heating	Prated	N/A	kW
Rated power input for cooling	Peer	0,785	kW
Rated power input for heating	Pcop	N/A	kW

Power consumption in standby mode	EERd	0,5	W
OFF mode power consumption	Poff	N/A	W
Crankcase heater mode power consumption	Pck	N/A	W
Information to identify the model(s) to which the information relates to: AC-5737BS			
Description	Symbol	Value	Unit
Rated Energy efficiency ratio	EERrated	2,61	
Rated Coefficient of performance	COPrated	N/A	
Electricity consumption of single/double duct appliances (indicate for cooling and heating separately)	Qsd	SD: 0,785 (cooling)	kWh/h
Electricity consumption of double ducts appliance	Qdd	N/A	kWh/h
Sound power level	Lwa	65	dB(A)

TABLE AC-5739BS

Information requirements for single and double duct air conditioners			P
Information to identify the model(s) to which the information relates to: AC-5739BS			
Description	Symbol	Value	Unit
Rated capacity for cooling	Prated	2,600	kW
Rated capacity for heating	Prated	N/A	kW
Rated power input for cooling	Peer	1,000	kW
Rated power input for heating	Pcop	N/A	kW
Power consumption in standby mode	EERd	0,5	W
OFF mode power consumption	Poff	N/A	W
Crankcase heater mode power consumption	Pck	N/A	W
Information to identify the model(s) to which the information relates to: AC-5739BS			
Description	Symbol	Value	Unit
Rated Energy efficiency ratio	EERrated	2,60	
Rated Coefficient of performance	COPrated	N/A	
Electricity consumption of single/double duct appliances (indicate for cooling and heating separately)	Qsd	SD: 1,000 (Cooling)	kWh/h
Electricity consumption of double ducts appliance	Qdd	N/A	kWh/h
Sound power level	Lwa	65	dB(A)

The product or equipment contains fluorinated greenhouse gas

Art.nr.	AC-5737BS
Coolant:	R290
Quantity in kg:	0,14
Global warming potential:	3
Art.nr.	AC-5739BS
Coolant:	R290
Quantity in kg:	0,16
Global warming potential:	3

INSTALLATION

- The air-conditioner should be installed on a flat and stable surface. Do not block the air outlet and allow at least 30cm around the unit.
- Socket wiring should be in accordance with the local electric safety requirements.

Exhaust Hose Installation

- Twist both ends of the hot-air exhaust hose **A 9** into the hose connector (window end) **A 8** and the hose connector (air conditioner end) **A 10**.
- Insert the hose connector (air conditioner end) **A 10** into the openings at the back of the air conditioner.
- Fix the hose connector (window end) **A 8** to the nearest windowsill.

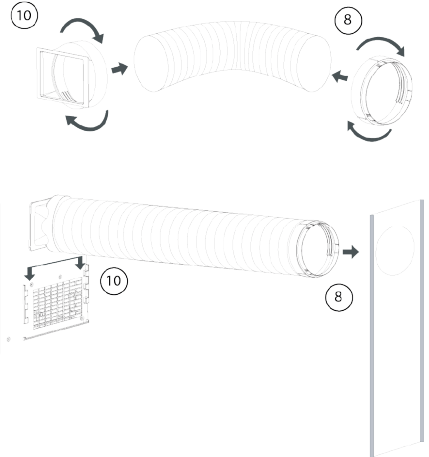

Window Slider Kit Installation

- Adjust the width or height of the window slider to fit the window opening and fixate the position of the window slider with the fixing plugs .
- Slide the window up to the slider.

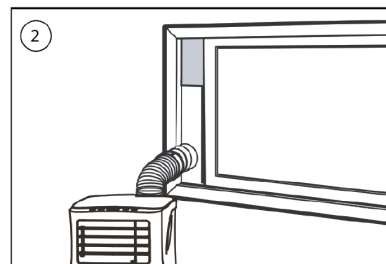
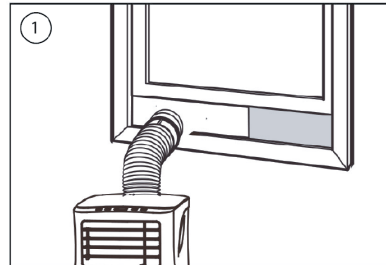

BEFORE FIRST USE

Before starting operations in this section:

- Find a place where there is power supply nearby.

- Install the exhaust hose and adjust the window position well.
- Insert the power cord into a grounded AC220~240V/50Hz socket.
- Press the power button to turn on the air-conditioner.
- Check whether the exhaust hose has been mounted properly.
- Set the temperature range: 16°C-31°C.
- When using functions on cooling and dehumidifying, allow at least 3 minutes between powering off and powering on.

Remote control (see image C)

- 2xAAA size batteries are required.
- Ensure the batteries are inserted in the correct direction.
- When replacing, ensure both batteries are changed simultaneously.
- Press the corresponding buttons as explained in the control panel part to operate the fan.

USE

Manual use

Cooling operation

- Press the "Mode" button till the "Cool" icon appears.
- Press the + or - button to select a desired room temperature.
- Allow around 5 minutes for the cooling to start.
- Press the "Fan speed" button to adjust airflow speed.

Dehumidifying operation

- Press the "Mode" button until the "Dehumidify" icon appears.
- The temperature will automatically be selected.
- The fan speed will automatically be selected.

Timer operation

Timer ON setting

- When the air-conditioner is OFF, press the "Timer" button and select a desired ON time and adjust by using the **15** and **16** buttons.
- The ON time can be adjusted to anytime in 0-24 hours.

Timer OFF setting

- When the air-conditioner is ON, press the "Timer" button and select a desired OFF time and adjust by using the **15** and **16** buttons.
- The OFF time can be adjusted to anytime in 0-24 hours.

Drainage

- After a lengthy operation and before storage, you will need to drain the water that has been collected. Please prepare a suitable location or tray to collect the water and remove the rubber stop from the drainage hole at the bottom of the unit. The water will then begin to drain. After this has stopped, you can insert the drain stop.

Internal Tank Water Full Alarm Function

- The inner water tank in the air-conditioner has one water level safety switch that controls the water level. When the water level reaches an anticipated height, the water full indicator lamp lights up. Follow previous steps to drain the water.

CLEANING AND MAINTENANCE

- Before cleaning, disconnect the unit from any electric supply outlet.
- First clean the surface with a neutral detergent and wet cloth, and then wipe it with a dry cloth.
- Do not use gasoline or other chemicals to clean the unit.
- Do not wash the unit directly.

Air filter

- The air filter should be cleaned once every two weeks.
- Open the air inlet grille and take off air filter.
- Clean the air filter with neutral detergent in lukewarm 40°C water and allow to dry (not in direct sunlight).
- Re-install the air filter into the inlet grille.

EU DECLARATION OF CONFORMITY

The full text of the EU declaration of conformity is available at the following internet address: www.tristar.eu/en-gb.

TROUBLESHOOTING

Problem	Possible cause	Possible solution
The unit does not start when pressing power button.	Water full indicator lamp blinks and water tank is full.	Drain the water out of the water tank.
	Room temperature is higher than the setting temperature. (Electric heating mode)	Adjust the temperature.
	Room temperature is lower than the setting temperature. (Cooling mode)	
The unit doesn't cool enough.	The doors or windows are not closed.	Make sure all the windows and doors are closed.
	There are heat sources inside the room.	Remove the heat sources if possible.
	Hot air exhaust hose is not connected or blocked.	Connect or clean the hot air exhaust hose.
	Temperature setting is too high.	Reset the temperature.
	Air inlet is blocked.	Clean the air inlet.
Noisy.	The ground is not level or not flat enough.	Place unit on a flat, level ground if possible.
	The sound comes from the flowing of the refrigerant inside the air conditioner.	
E0 Code	Room temperature sensor failed.	Replace room temperature sensor.
E1 Code	Condenser temperature sensor failed.	Replace condenser temperature sensor.
E2 Code	Water tray full when cooling.	Take off rubber stopper and empty the watertank.
E3 Code	Pipe temperature sensor failed.	Replace pipe temperature sensor.
E4 Code	Water tank full.	Please empty the water tank .

DISPOSAL



This appliance should not be put into the domestic garbage at the end of its durability, but must be offered at a central point for the recycling of electric and electronic domestic appliances. This symbol on the appliance, instruction manual and packaging puts your attention to this important issue. The materials used in this appliance can be recycled. By recycling of used domestic appliances you contribute an important push to the protection of our environment. Ask your local authorities for information regarding the point of recollection.

SUPPORT

For spare parts and more information about the appliance, please visit www.tristar.eu/en-gb.



WWW.TRISTAR.EU

Tristar Europe B.V. | Swaardvenstraat 65 | 5048 AV Tilburg | The Netherlands

Smartwares S&L Ltd. West Point | Mucklow Office Park | Mucklow Hill | Halesowen | West Midlands | B62 8DY | United Kingdom | www.tristar.eu